



NEW STYLE

WHITES



COLORS



UNISEX BAGS  
**SXI48 - LIGHT TOTE BAG**



**Light Woven tote bag**

- Top edge double folded for strength and clean finish
- Long handles with reinforced cross stitch

Combo options

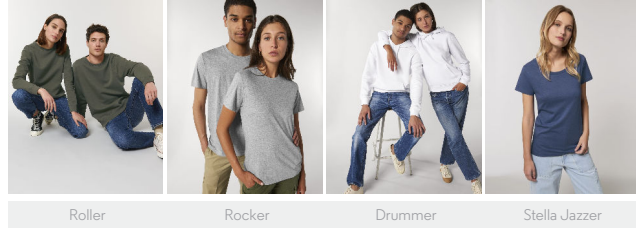

Shell : Plain Weave , 100% Organic ring-spun combed cotton , Fabric washed , 160 GSM

Printing Specifications

For suitable print techniques, please download our printing guide

Certifications & memberships



Wash Instructions

Wash similar colours together, no ironing on print, wash and iron inside out.



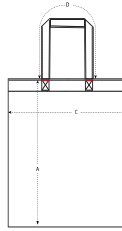

SIZES		OS
A	Height	42
C	Width	37
D	Strap Length	65