

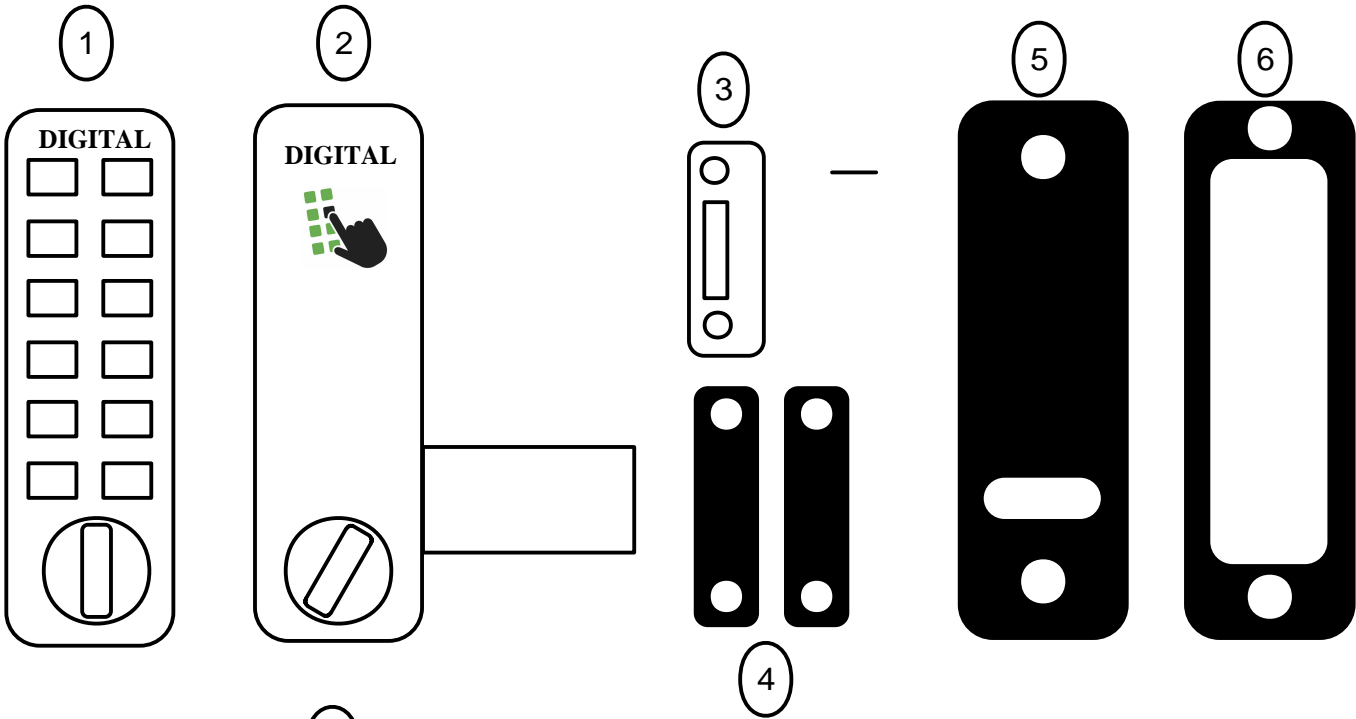

L220& LC150 Instructions

Parts list for your Digital Door Lock L220& LC150



Before fitting your lock

- Check you have all the parts listed
- Change the code to your own chosen code (optional) see code change instructions
- Check the hand of opening, your lock is factory set to right hand opening you may need to change it to left, see check the hand of opening

- 1) Lock front
- 2) Lock back
- 3) Surface strike
- 4) Packing out pieces for surface strike
- 5) Protection seals for front and back
- 6) packing out pieces for lock back
- 7) Pack containing
  - Spindles
  - fixing bolts
  - Wood screws
  - Tweezers
  - Spare code tumblers
  - Code card (factory code in your lock)
- 8) Installation instructions, code change instructions & template for drilling

1. Check hand of opening Your lock is factory set to right hand opening

To determine if your lock needs to be right or left hand opening stand on the side you want the front of the lock to go

If the door is hinged on the right as per diagram, it is already right hand as per the factory setting, so move on to installing your lock

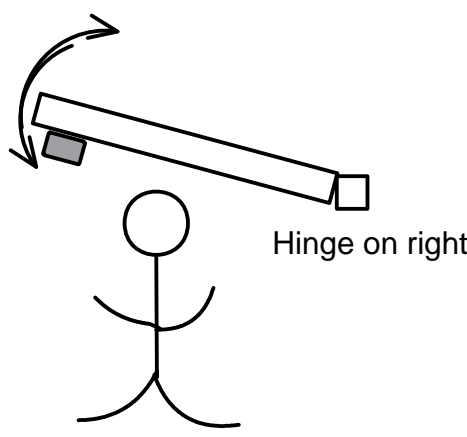

If your door is hinged on the left go to change the hand

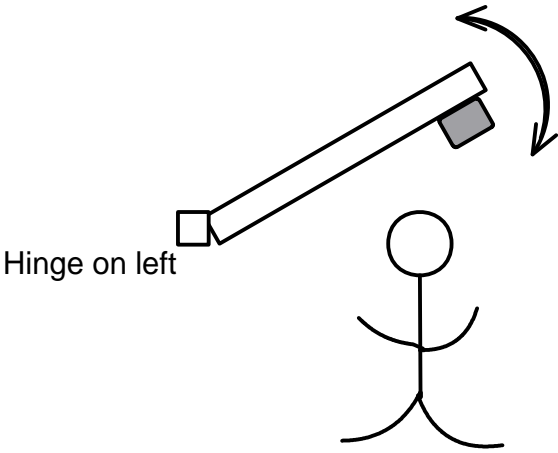

2. Changing the hand

Remove the 2 x blue screws, from reverse of lock front, lift plate off, using the tweezers move the pin to the opposite side, replace plate.

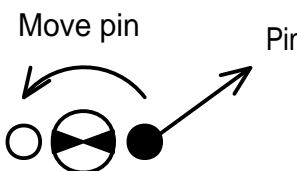

Code change instructions

Take the lock front (if after fitting remove by undoing the 2 x fixing bolts from the lock back)

1) Turn the lock upside down

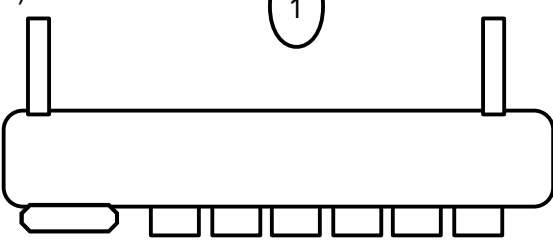

2) Remove the 2 x red screws from the plate and lift the plate off carefully

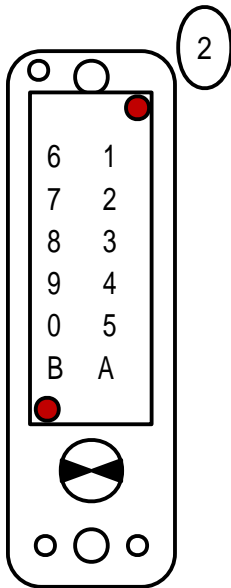

Your code group can consist of from 4 to 6 digits i.e.690AB or 1508 although your code group is not sequential there are still over 4,000 different codes

- The code is determined by the number of red tumblers used, blue are non-code
- To increase your code add more red tumblers, to decrease add more blue
- Turn the knob to allow the tumblers to slide in & out easily

3) Using the tweezers provided move the red & blue tumblers to set your own code

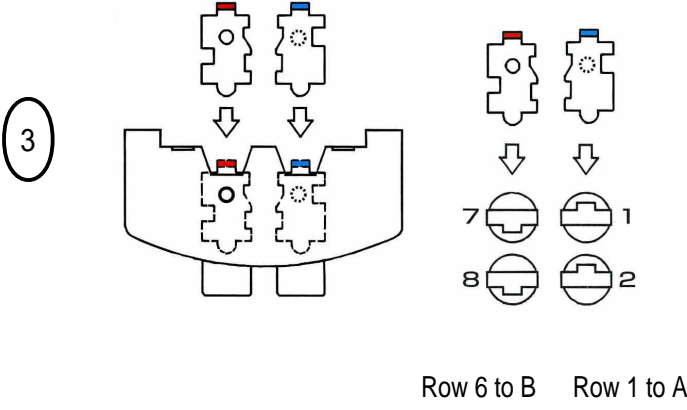

The tumblers are shaped to fit into the slots

- All the tumblers in row 6 to B must be replaced this way
- All the tumblers in row 1 to A must be replaced this way
- The coloured tip must be facing upward and the square cut out on the side facing the outside edge

**DO NOT** force the tumblers back in, **SIMPLY** turn the front knob and they will drop in if one or more does not drop in make sure they are all in correctly, as per above and diagram 3

Replace the plate and test your code prior to fitting on the door. If refitting to an existing installation ensure you reposition the spindle at the correct angle as per 'Fitting your lock'

3. Changing the hand can't L220 only (NOT REQUIRED FOR THE LC150)

If you had to change the hand of opening on the front of the lock to left, you will also need to change it on the back of the lock. Remove the 5 x silver screws and remove the plate.

- 1) Lift out the bar
- 2) Whilst holding the spring down turn the knob so the cam is vertical
- 3) Turn the bar over so that the longest length is now facing the opposite way and fit over the cam. replace the plate.

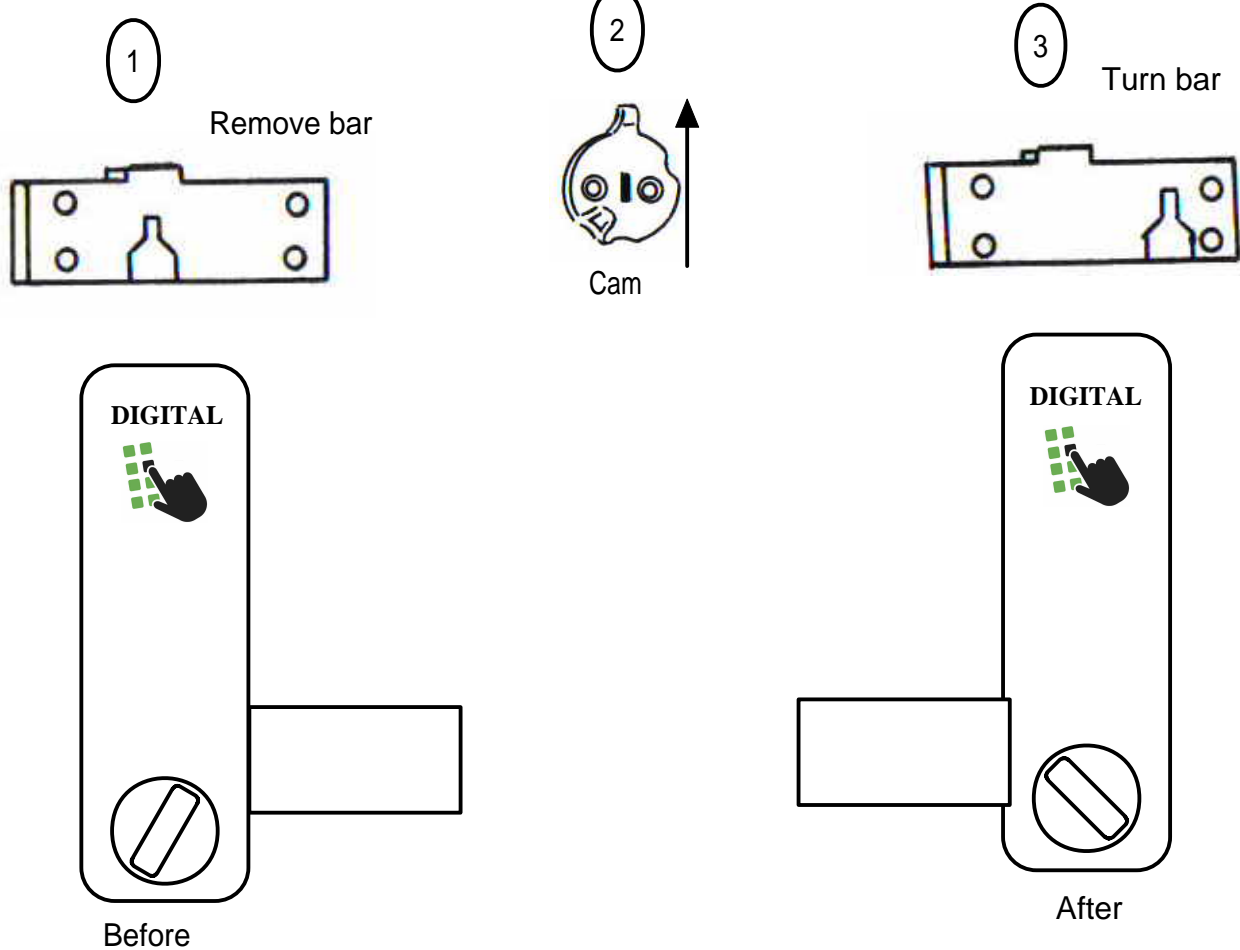

4. Fitting your lock

1) Position the template at the correct height and position

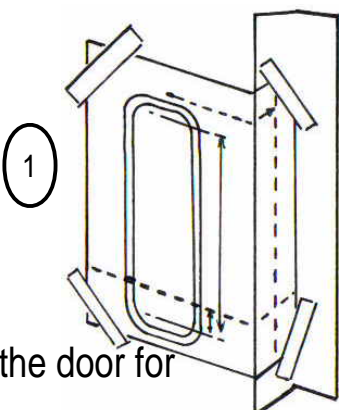

- 2) Select the strike and mark its position on the frame before drilling the door for the lock
- 3) Drill the lock holes as per the template to ensure trouble free operation the holes should be accurate
- 4) Place the protection seals on the lock front & lock back ONLY use the packing pieces for the lock back & strike plates if needed to level on or the other, so the bar slides smoothly to lock
- 5) Choose the correct length spindle (cut to size if necessary) ensure the spindle length is long enough to fit into both the front and back of the lock
- 6) Place the lock front through the drilled holes, from the back insert the spindle so it lays toward the door edge
- 7) With the lock back in the closed position place over spindle and bolt together (cut the bolts to correct length if necessary)

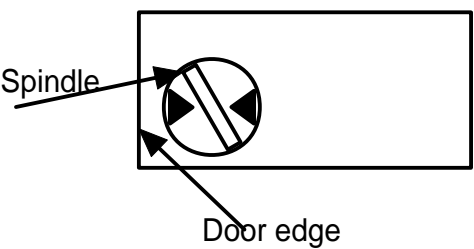

For right hand opening door, hinged on the right from the outside

Or

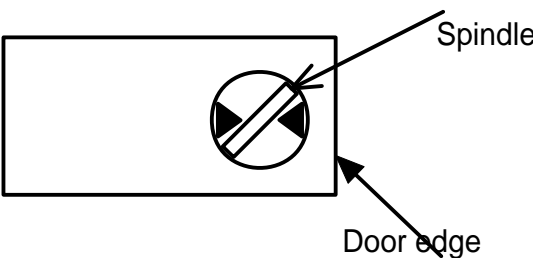

For left hand opening door, hinged on left from the outside

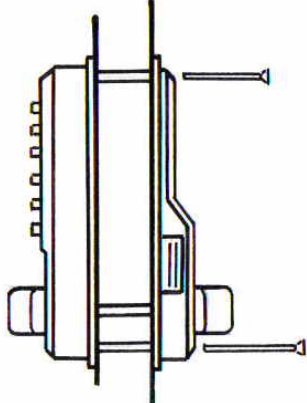

BEFORE CLOSING THE DOOR check the operation of your lock front & back\*

\* PLEASE NOTE: The L220& LC150 do not have a C to clear button like many other Digital locks, but the code chamber will still need to be cleared prior to entering your code every time. To do this simply turn the front knob: " if set to right hand opening turn to left to clear" then your code " if set to left hand opening turn to right to clear" then your code

5. Fitting the strike

- 1) Position the strike on the frame so it lines up with the lock surface bolt
- 2) Fix into/onto the frame

Trouble shooting guide:

Problem	Possible cause	To resolve
Will not operate after changing the code	Code tumbler inserted wrong way round or upside down	Check the position of <u>all</u> the code tumblers -refer to the code change instructions. Forcing a code tumbler in the wrong way can damage your lock.
Knob turns in wrong direction or lock opens without using the code	Not handed correctly	Check you have the lock set to the correct hand of opening, refer to installation instructions (handle also with 2430/35 & k series)
	OR	Spindle position
		Spindle must lay at an Angle through the latch, facing towards the latch bolt face/edge of door-refer to 'Fitting your lock'
	OR	Gap between door & frame to wide
		Because latch has not needed to be fully withdrawn before door is opened the code has not cancelled in lock -reduce gap
Latch bolt sticking/tight /not retracting smoothly or all the way/not returning Smoothly or all the way	-do the following	Make sure you have chiselled out enough for the latch Cam refer to 'Fitting your lock'
	OR	The coloured end of spindle (if applicable to the lock type) should be in the front body, RED end for right hand open, BLUE end for left hand Open. The spindle may be to long
		Or call us for advice 01763 245245

For Customer support/Technical/Sales please contact us:

Lockey Digital UK Ltd  
Unit 6 Saxon way  
Melbourn  
Royston  
Herts SG86DN  
United Kingdom  
Tel +44 (0) 1763 245245 Fax +44 (0) 1763 260345  
Email enquires@ lockeydigital.co.uk  
www.lockeydigital.co.uk



Keep these instructions, you may need to change your code in the future.