

INSTALL

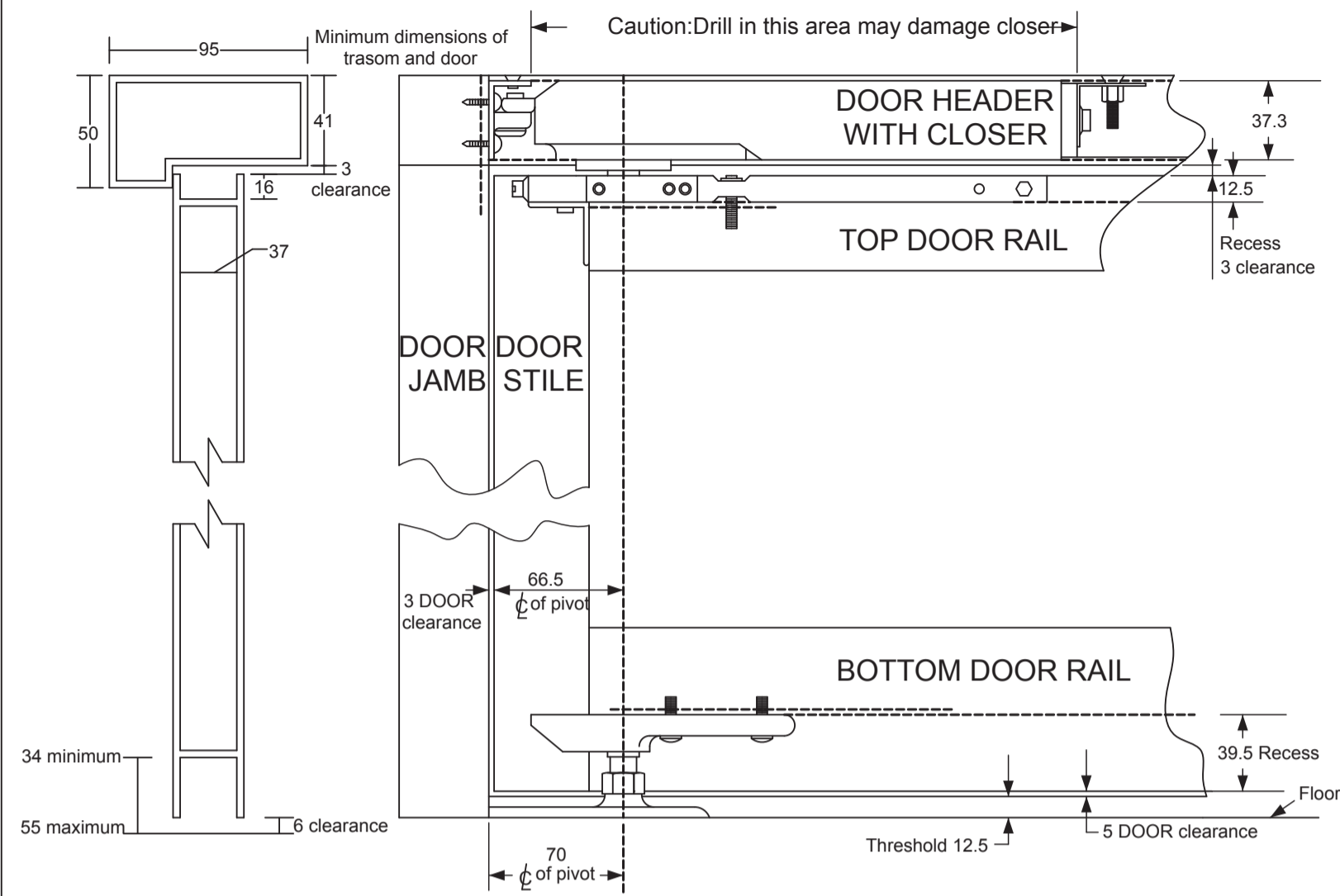

To Adjust The Door Closing Speed

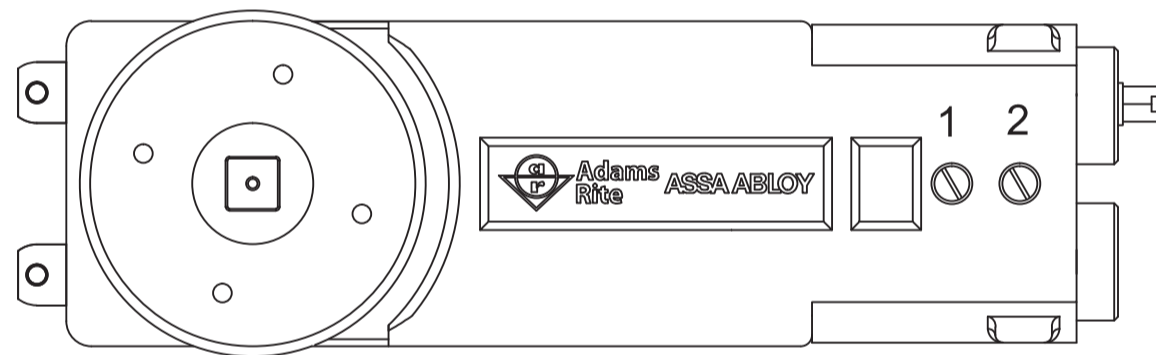

HOLD OPEN OPTIONS

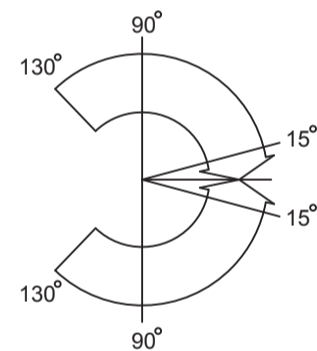

Closing Speed Adjustment

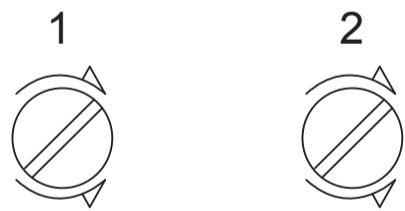

Turn Clockwise for Slower Speed
Anti-Clockwise for Faster Speed

Power Adjustment

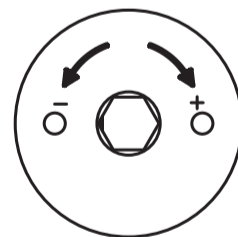

Use 8mm Open end wrenches

Size 1	Size 2	Size 3	Size 4
+0	+1 - +4	+5 - +7	+8

Factory preset to size 1(+0)

CLOSING RANGE

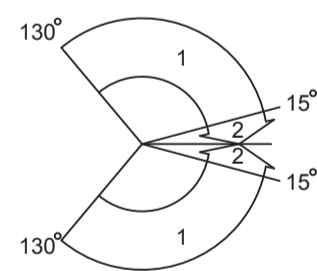

1.CLOSING RANGE
2.LATCHING RANGE

To Erect The Door

As supplied the square pivot of the closer sits in the central (closed)position.Using grips and suitable leverage rotate the square pivot to the 90 degrees position.In the case of an NHO closer wind the closing speed adjuster in fully to give sufficient time to load the door into position.

Holding door at approximately 15 degress position ,lower onto the pivot bolt and swing the door into the vertical position locating the closer spindle into the arm recess.

Note:To ease the hanging of single action doors it may be necessary to temporarily remove the door stop if already fitted. wedge the door in position and fit the arm clamp block with the 2 No. socket head screws and conical lock washers (F).

Use allen key provided to tighten block down securely.

Fit tag plate to top rail cut-out. Align door to jamb and meeting stile by adjusting bolts(C).

Fit final fixing screw in bottom pivot shoe and tighten all fixings securely.

Fitting Instructions

ARC-51N VARIABLE Overhead Door Closer for Centre Pivoted Applications

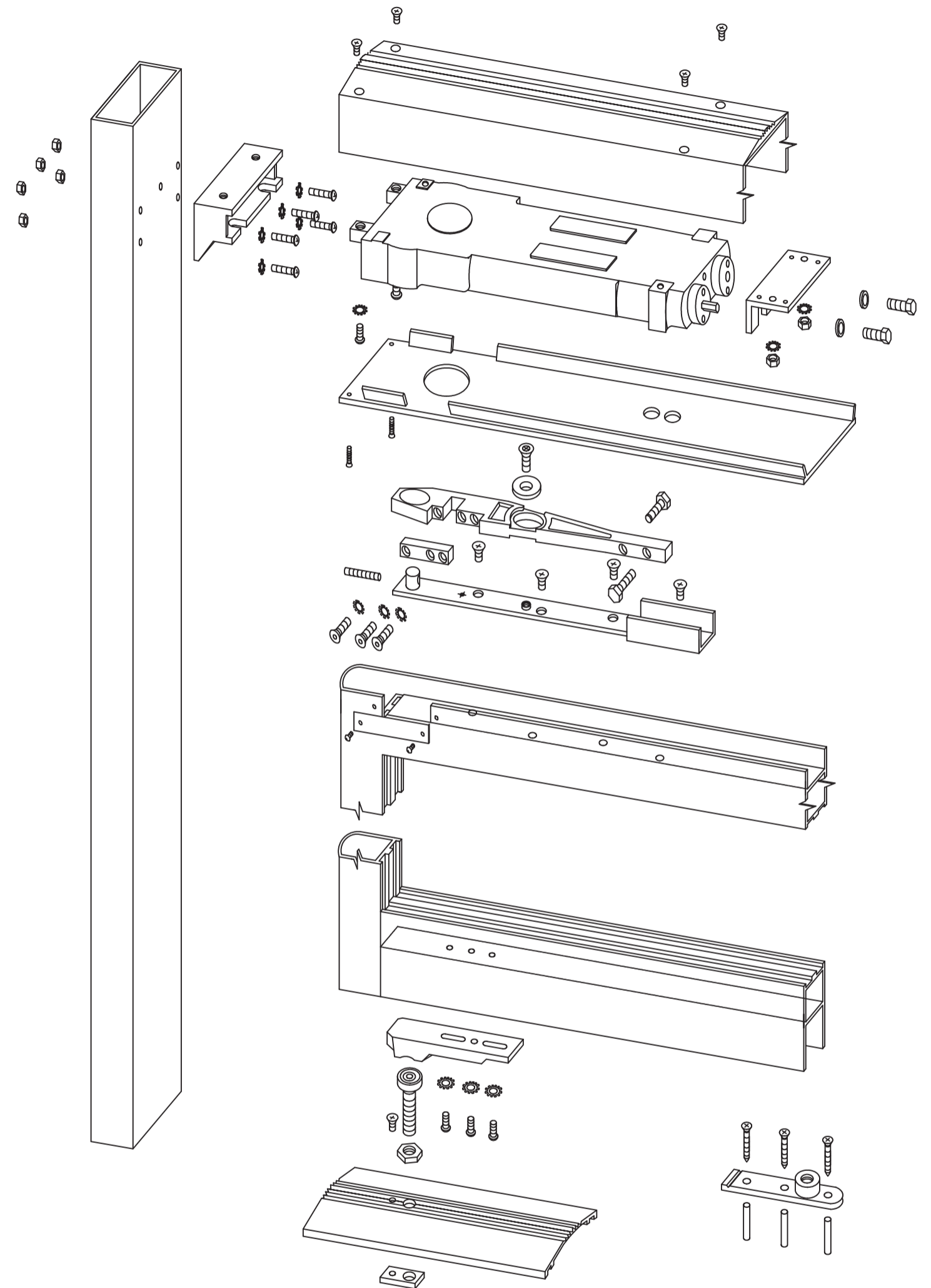

NOTE : 1.For Side-Load & End-Load(AFT)installation,please refer to Page 2.
2.The thread of all fixings should be applied with Loctite 222 or similar and securely fastened.

Contents

Concealed Overhead Door Closer	
Centre Pivoted-Double or Single Acting.....	page 1
Arms & Bottom Pivot installation.....	page 2
Transom / Header Bar, 70mm Pivot Point.....	page 3
Install & To Adjust The Door Closing Speed.....	page 4

ASSA ABLOY Security Solutions
School Street,Willenhall,West Midlands WV13 3PW
Phone: +44(0)845 873 4838

1

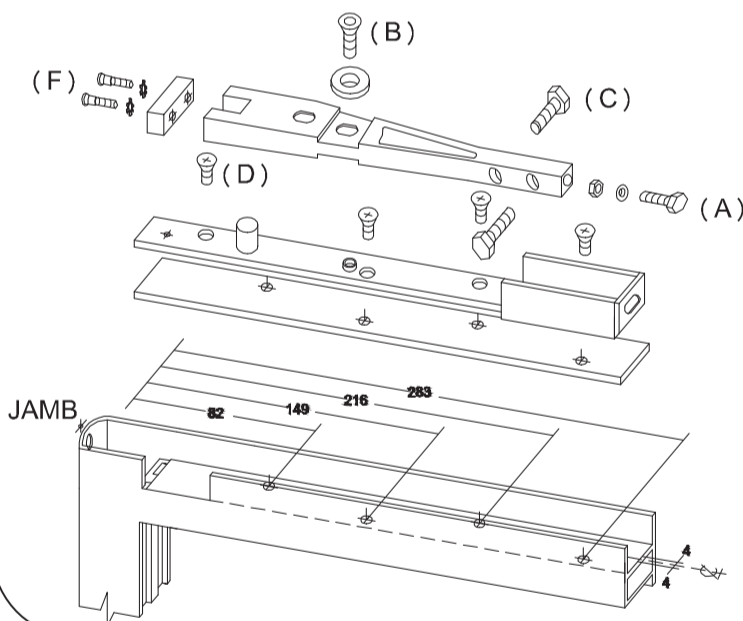
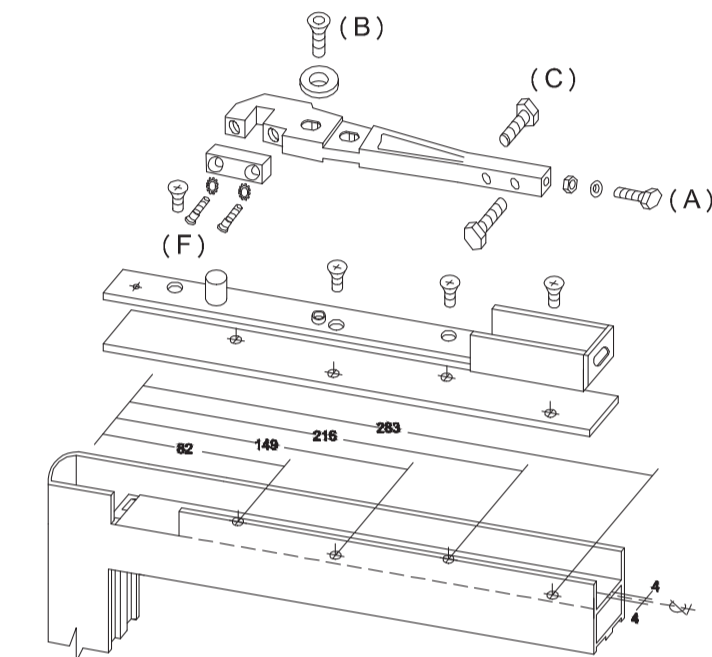

Unwiden alignment bolts (D) equally on the steel channel Upstands.
Tighten all fixings.

Fit the 2No.Allen screws and the conical washers (F) after the door has been hung .Tighten all fixings.

Tighten all fixings.

If the bolt protrudes below the base of the threshold excess must be removed or the floor level drilled accordingly.

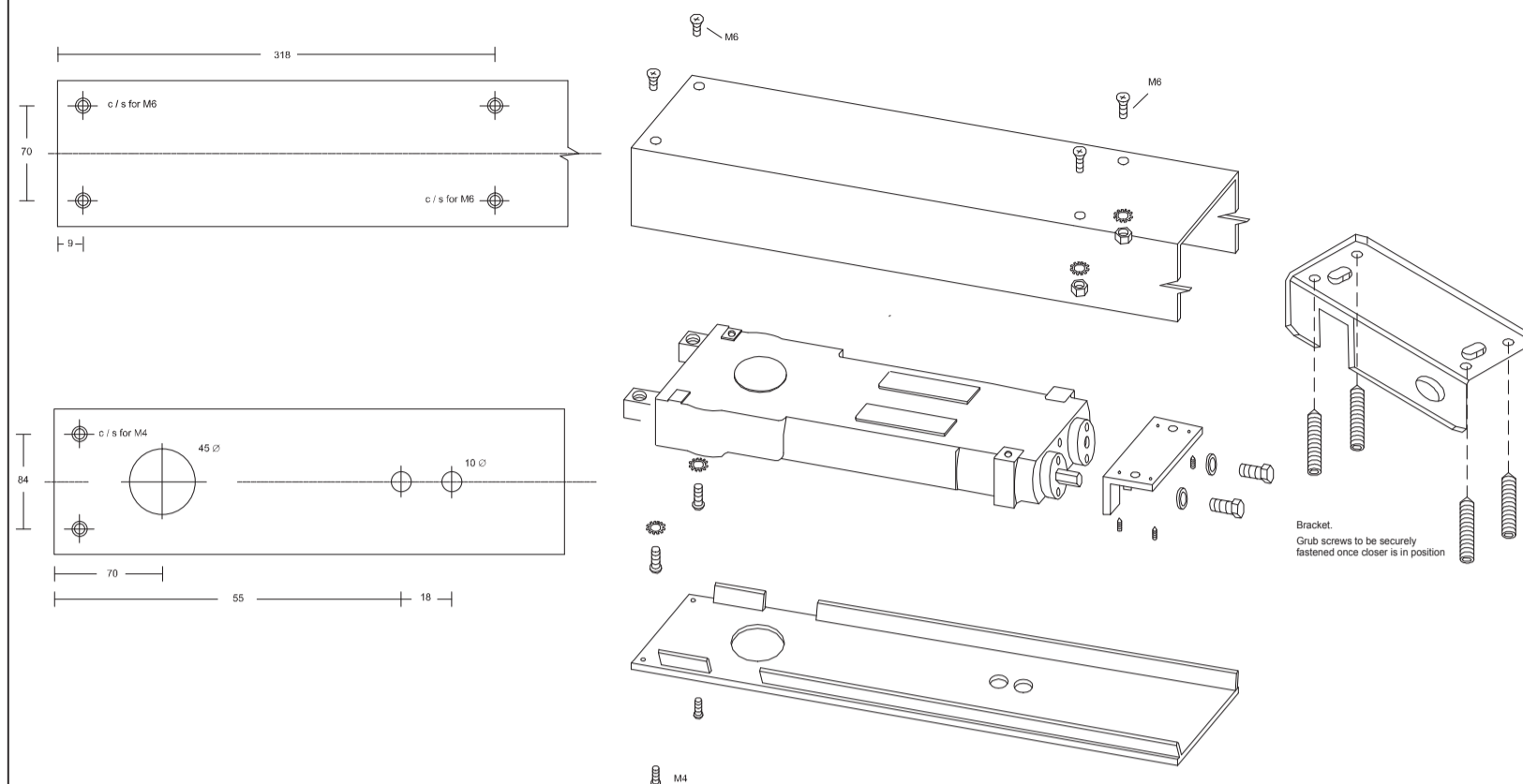

1

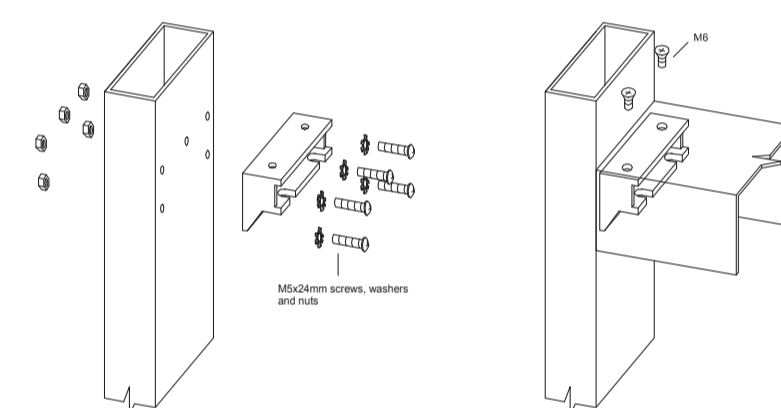
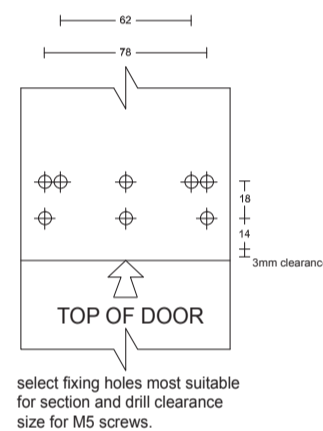

2

For 65mm bracket

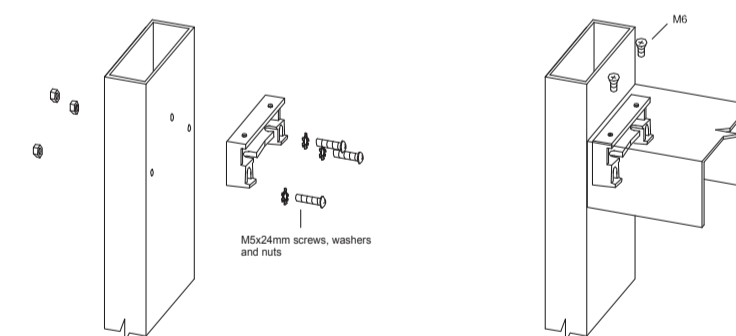
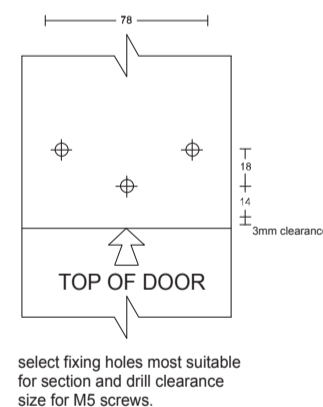

For the front bracket, there are two options ① or ② as shown above depending on the bracket type required.

Once the 70mm pivot centre has been achieved fasten the M6 bolts securely. Centralise the closer.

If the bolt protrudes below the base of the threshold excess must be removed or the floor level drilled accordingly.