

# BOSCH MIC-DCA-WD

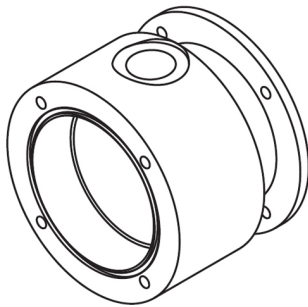

## DESCRIPTION

Deep conduit adapter for 4 in. PCD base, white sand finish (RAL9010).

The MIC deep conduit adapter (MIC-DCA) is designed to allow a weatherproof conduit to be fitted to protect the MIC composite cable. The MIC-DCA has sufficient room to allow the composite cable connector to connect to the MIC camera foot. The MIC-DCA is machined from solid aluminum and provides a 4 in pitched circle diameter (PCD) mounting position for the MIC camera. An O-ring and an optional Nebar gasket provide a watertight seal to protect the electrical connectors on the camera base and the composite cable connector. The MIC-DCA has two 25 mm holes for conduit or cable glands to be fitted, one in the base and one side entry. A plug with O-ring is provided to seal the unused hole.

## TECHNICAL CHARACTERISTICS

Brand : BOSCH

Part number : MIC-DCA-WD

Depth : 120 mm

Height : 90 mm

Material : Aluminium

Product colour : White

Weight : 1.45 kg