

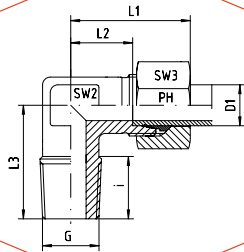

PRODUKTE / PRODUCTS

ERLÄUTERUNG / EXPLANATION



Winkel-Einschraubverschraubungen  
LL- und L-Reihe  
Einschraubgewinde: Whitworth-Rohrgewinde - Kegelig

**Stud Elbows**  
LL- and L-Series  
Thread: BSP - Taper

Reihe Series	Druck Pressure PN	Rohr A.D. Tube O.D. D1	Gewinde Thread G	Ca. Maße Approx. Dimensions						Bestellzeichen Order-Code Standard
				L1	L2	L3	i	SW2	SW3	
L	315	6	R 1/8" keg	27,0	12,0	20	8	12	14	WE6L-2RT
L	315	6	R 1/4" keg	27,0	12,0	26	12	12	14	WE6L-4RT
L	315	6	R 3/8" keg	30,0	15,0	27	12	14	14	WE6L-6RT
L	315	6	R 1/2" keg	30,5	15,5	30	14	17	14	WE6L-8RT
L	315	8	R 1/8" keg	29,0	14,0	26	8	12	17	WE8L-2RT
L	315	8	R 1/4" keg	29,0	14,0	26	12	12	17	WE8L-4RT
L	315	8	R 3/8" keg	32,0	17,0	28	12	14	17	WE8L-6RT
L	315	8	R 1/2" keg	34,5	19,5	30	14	17	17	WE8L-8RT
L	315	10	R 1/8" keg	31,5	15,0	27	8	14	19	WE10L-2RT
L	315	10	R 1/4" keg	30,0	15,0	27	12	14	19	WE10L-4RT
L	315	10	R 3/8" keg	30,0	15,0	28	12	14	19	WE10L-6RT
L	315	10	R 1/2" keg	37,0	21,0	33	14	17	19	WE10L-8RT
L	315	12	R 1/8" keg	32,0	17,5	27	8	17	22	WE12L-2RT
L	315	12	R 1/4" keg	32,0	17,5	27	12	17	22	WE12L-4RT
L	315	12	R 3/8" keg	32,0	17,5	28	12	17	22	WE12L-6RT
L	315	12	R 1/2" keg	32,0	17,5	34	14	17	22	WE12L-8RT
L	315	15	R 1/4" keg	36,0	21,0	32	12	19	27	WE15L-4RT
L	315	15	R 3/8" keg	36,0	21,0		12	19	27	WE15L-6RT
L	315	15	R 1/2" keg	36,0	21,0	34	14	19	27	WE15L-8RT
L	160	15	R 3/4" keg				16	24	27	WE15L-12RT
L	315	18	R 3/8" keg	40,0	23,5		12	24	32	WE18L-6RT
L	315	18	R 1/2" keg	40,0	23,5	36	14	24	32	WE18L-8RT
L	160	18	R 3/4" keg	38,5	22,0	41	16	24	32	WE18L-12RT
L	160	22	R 1/2" keg	44,0	27,5	41	14	27	36	WE22L-8RT
L	160	22	R 3/4" keg	44,0	27,5	41	16	27	36	WE22L-12RT
L	160	28	R 1" keg	51,5	30,5	47	20	36	41	WE28L-16RT
L	160	35	R 1 1/4" keg	59,5	33,0	56	26	41	50	WE35L-20RT

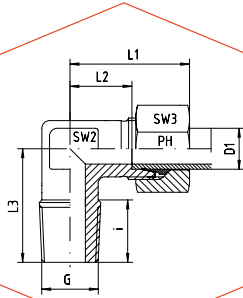

Winkel-Einschraubverschraubungen  
S-Reihe  
Einschraubgewinde: Whitworth-Rohrgewinde - Kegelig

Stud Elbows  
S-Series  
Thread: BSP - Taper

Reihe Series	Druck Pressure PN <sup>(1)</sup>	Rohr A.D. Tube O.D. D1	Gewinde Thread G	Ca. Maße Approx. Dimensions						Bestellzeichen Order-Code Standard
				L1	L2	L3	i	SW2	SW3	
S	630	6	R 1/8" keg	29,5	15,0	25	8	12	17	WE6S-2RT
S	630	6	R 1/4" keg	31,0	16,5	26	12	12	17	WE6S-4RT
S	630	6	R 3/8" keg	32,0	17,5	27	12	14	17	WE6S-6RT
S	630	6	R 1/2" keg	34,0	19,0	33	14	17	17	WE6S-8RT
S	630	8	R 1/8" keg				8	14	19	WE8S-2RT
S	630	8	R 1/4" keg	32,0	17,0	27	12	14	19	WE8S-4RT
S	630	8	R 3/8" keg	33,0	18,0	28	12	14	19	WE8S-6RT
S	630	8	R 1/2" keg	38,0	23,0	33	14	17	19	WE8S-8RT
S	630	10	R 1/8" keg				8	17	22	WE10S-2RT
S	630	10	R 1/4" keg	34,0	17,5	28	12	17	22	WE10S-4RT
S	630	10	R 3/8" keg	34,0	17,5	28	12	17	22	WE10S-6RT
S	630	10	R 1/2" keg	39,0	22,5	32	14	17	22	WE10S-8RT
S	630	12	R 1/4" keg	38,0	21,5	27	12	17	24	WE12S-4RT
S	630	12	R 3/8" keg	38,0	21,5	28	12	17	24	WE12S-6RT
S	630	12	R 1/2" keg	39,0	22,5	32	14	17	24	WE12S-8RT
S	630	14	R 3/8" keg	40,0	22,0	30	12	19	27	WE14S-6RT
S	630	14	R 1/2" keg	40,0	22,0	32	14	19	27	WE14S-8RT
S	400	16	R 3/8" keg	43,0	24,5	32	12	24	30	WE16S-6RT
S	400	16	R 1/2" keg	43,0	24,5	32	14	24	30	WE16S-8RT
S	160	16	R 3/4" keg	43,0	24,5	41	16	24	30	WE16S-12RT
S	400	20	R 1/2" keg	48,0	26,5	42	14	27	36	WE20S-8RT
S	400	20	R 3/4" keg	48,0	26,5	42	16	27	36	WE20S-12RT

<sup>(1)</sup> Die angegebenen Druckstufen sind nur gültig, wenn die Einschraublöcher mit kegeligem Gewinde vorhanden sind.

<sup>(1)</sup> The pressure rates are only valid, if the female parts are with tapered threads, too.