

Safety Coupling with Push Button 022S.06



Working Temperature:
-20°C up to +100°C (-4°F +212°F)

Flow capacity:
NW-5.5

Working Pressure:
0-12 bar (0-508 PSI)

Material:

- Inner part: Aluminium
- Back part: Brass Nickel Plated
- Valve: Steel Chrome Plated
- Spring: Stainless Steel
- Coupler Body: Steel Chrome Plated
- Seals: Nitrile (Ni) NBR
- Balls: AISI 420 Hardened
- Push Button: AISI 420 Hardened Steel Chrome Plated

Interchangeability:

- TST 014 & 022
- ARO 210
- Rectus 14 & 22
- Industrial Interchange 1/4"
- Orion 44510
- JWL 522 & 532
- DynaQuip DM-2
- Aerequip FD41
- Gromelle G-16600

Couplers and Plugs

Connection

Order No

SW

L

øD

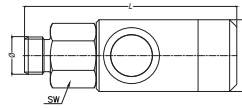

Male Thread Coupling
Kupplung mit Aussengewinde

BSP 1/4"	022.S06 EG 13	20	67.7	25
BSP 3/8"	022.S06 EG 17	20	70.7	25
BSP 1/2"	022.S06 EG 21	24	70.7	25

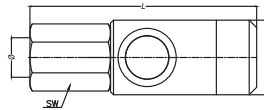

Female Thread Coupling
Kupplung mit Innengewinde

BSP 1/4"	022.S06 DG 13	20	69.7	25
BSP 3/8"	022.S06 DG 17	20	71.7	25
BSP 1/2"	022.S06 DG 21	24	75.7	25

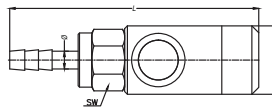

Standard Hose Barb Coupling
Kupplung mit Schlauchtülle

ø 6 - 1/4"	022.S06 HG 06	20	84.7	25
ø 8 - 5/16"	022.S06 HG 08	20	84.7	25
ø 10 - 3/8"	022.S06 HG 10	20	84.7	25