

Anti-vibration Mounts

Bobbins

Mounts can be fixed in numerous ways with either internal, external or combination threads. These can be used in compression or shear. This range can accommodate loads from 8kg to 650kg, although we can offer from 2kg to 1,020kg on request.

- Natural rubber, zinc plated in accordance with CE standards, chrome VI free, white
- Stiffness tolerance: +/- 20%

Applications: measurement equipment, instruments, small machinery, engines, pumps and radiators.

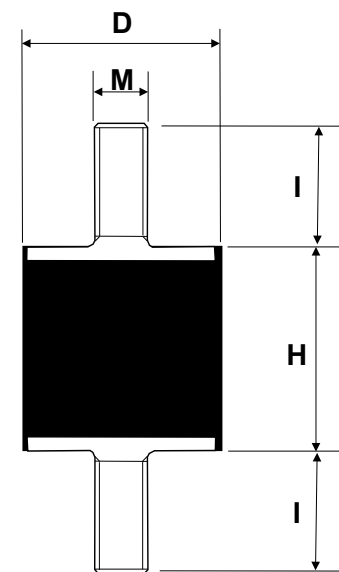

MALE/MALE						
PART CODE	DIAMETER (D) mm	HEIGHT (H) mm	THREAD (M x I) mm	Compression Stiffness Rate Kg/mm	Max Static Deflection mm	Max. Operating Load Kg
MMB-161510	16	15	M4 x 10	8.4	3	25.1
MMB-202018	20	20	M6 x 18	8.3	4	33
MMB-302020	30	20	M8 x 20	24.3	4	97.1
MMB-303020	30	30	M8 x 20	11	6	66.1
MMB-404025	40	40	M10 x 25	15.3	8	122.4
MMB-504025	50	40	M10 x 25	26.5	8	212.1
MMB-505025	50	50	M10 x 25	17.2	8	137.9
MMB-755037	75	50	M12 x 37	62.1	10	621