

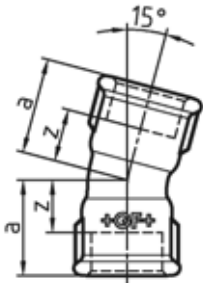

## 54 Bend 15°



EN		Dim. [inch]	Code	a [mm]	z [mm]
-	G	½	770 054 204	28	15
-	G	¾	770 054 205	33	18
-	G	1	770 054 206	37	20
-	G	1 ¼	770 054 207	45	26
-	G	1 ½	770 054 208	47	28
-	G	2	770 054 209	51	27



## 60 Return bend

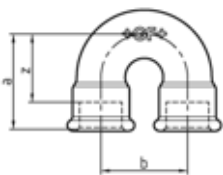

EN		Dim. [inch]	Code	a [mm]	b [mm]	z [mm]
-	B	½	770 060 104	45	38	32
-	G	½	770 060 204	45	38	32
-	B	¾	770 060 105	52	50	37
-	G	¾	770 060 205	52	50	37
-	B	1	770 060 106	64	64	47
-	G	1	770 060 206	64	64	47
-	B	1 ¼	770 060 107	73	76	54
-	G	1 ¼	770 060 207	73	76	54
-	B	1 ½	770 060 108	80	89	61
-	G	1 ½	770 060 208	80	89	61
-	B	2	770 060 109	90	102	66
-	G	2	770 060 209	90	102	66



## 85 Crossover

\* D=¾

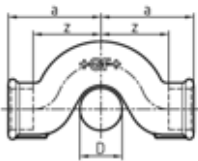

EN		Dim. [inch]	Code	a [mm]	D [inch]	z [mm]
-	B	¾	770 085 103	38	¾	28
-	G	¾	770 085 203	38	¾	28
-	B	½	770 085 104	47	½	34
-	G	½	770 085 204	47	½	34
*-	B	½	770 085 115	49	¾	36
*-	G	½	770 085 215	49	¾	36
-	B	¾	770 085 105	55	¾	40
-	G	¾	770 085 205	55	¾	40
-	B	1	770 085 106	70	1	53
-	G	1	770 085 206	70	1	53
-	B	1 ¼	770 085 107	85	1 ¼	66
-	G	1 ¼	770 085 207	85	1 ¼	66