

Straight Flanges

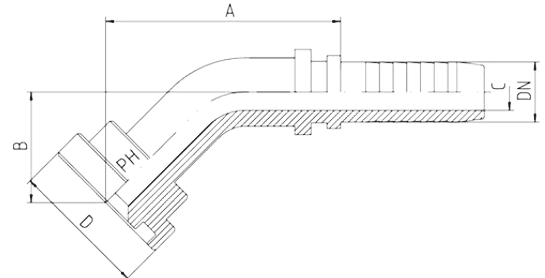

- SAE J 518 / ISO 6162
- SFL 3 = 3000 psi, 45°
- SFS 6 = 6000 psi, 45°



3000 psi

Hose DN	Bore	Flange Dimensions		Approx. Dimensions			Order Code
DN		D		A	B	C	
12	1/2"	30.2	1/2"	60.0	30.0	9.5	SFL3-1/2-45-DN12
16	5/8"	30.2	1/2"	90.5	34.0	12.0	SFL3-1/2-45-DN16
12	1/2"	38.1	3/4"	90.5	34.0	12.0	SFL3-3/4-45-DN12
16	5/8"	38.1	3/4"	90.5	34.0	12.0	SFL3-3/4-45-DN16
19	3/4"	38.1	3/4"	85.0	36.0	14.5	SFL3-3/4-45-DN19
19	3/4"	44.5	1"	91.0	31.0	14.5	SFL3-1-45-DN19
25	1"	44.5	1"	90.0	39.0	20.0	SFL3-1-45-DN25
25	1"	50.8	1.1/4"	118.0	43.0	20.0	SFL3-11/4-45-DN25
31	1.1/4"	50.8	1.1/4"	111.0	44.0	25.0	SFL3-11/4-45-DN31
31	1.1/4"	60.3	1.1/2"	138.0	36.0	25.0	SFL3-11/2-45-DN31
38	1.1/2"	60.3	1.1/2"	134.0	45.0	31.0	SFL3-11/2-45-DN38
38	1.1/2"	71.4	2"	142.0	58.0	31.0	SFL3-2-45-DN38
51	2"	71.4	2"	162.0	57.0	42.0	SFL3-2-45-DN51

6000 psi

Hose DN	Bore	Flange Dimensions		Approx. Dimensions			Order Code
DN		D		A	B	C	
12	1/2"	31.7	1/2"	62.0	32.0	9.5	SFS6-1/2-45-DN12
16	5/8"	31.7	1/2"	91.5	35.0	12.0	SFS6-1/2-45-DN16
12	1/2"	41.3	3/4"	91.5	35.0	12.0	SFS6-3/4-45-DN12
16	5/8"	41.3	3/4"	91.5	35.0	12.0	SFS6-3/4-45-DN16
19	3/4"	41.3	3/4"	85.0	40.0	14.5	SFS6-3/4-45-DN19
19	3/4"	47.6	1"	94.0	31.0	14.5	SFS6-1-45-DN19
25	1"	47.6	1"	92.5	38.5	20.0	SFS6-1-45-DN25
25	1"	54.0	1.1/4"	119.0	47.5	20.0	SFS6-11/4-45-DN25
31	1.1/4"	54.0	1.1/4"	112.0	47.0	25.0	SFS6-11/4-45-DN31
31	1.1/4"	63.5	1.1/2"	141.5	43.0	25.0	SFS6-11/2-45-DN31
38	1.1/2"	63.5	1.1/2"	134.0	48.0	31.0	SFS6-11/2-45-DN38
38	1.1/2"	79.4	2"	143.0	64.0	31.0	SFS6-2-45-DN38
51	2"	79.4	2"	165.5	60.0	42.0	SFS6-2-45-DN51