

ESH-SERIES



Shown from left to right:
ESH-302, ESH-120

ESH-SERIES SINGLE ACTING HOLLOW CENTER CYLINDERS

► Features

- ◆ Hollow piston design allows for both pull and push forces.
- ◆ Complies with ASME B30.1. High strength steel for durability and increased safety.
- ◆ Single-acting, spring return.
- ◆ High quality EAB-201 quick couplers.
- ◆ Collar threads, piston threads for easy fixturing.
- ◆ Environmentally friendly painting process provides a durable anti-corrosion finish.

Cylinder Capacity @700bar ton	Stroke in	Model	Cylinder Effective Area in ²	Oil Capacity in ³	Collapsed Height	Extended Height	Collar Thread	Outside Diameter	Piston Rod Diam.
					A in	B in	C in	D in	F in
13	0.31	ESH-120	2.85	0.90	2.17	2.48	2 3/4"-16	2.72	1.38
	1.65	ESH-121	2.85	4.72	4.72	6.38	2 3/4"-16	2.72	1.38
	2.99	ESH-123	2.85	8.54	7.24	10.24	2 3/4"-16	2.72	1.38
20	1.93	ESH-202	5.08	9.82	6.38	8.31	3 7/8"-12	3.90	2.13
	6.10	ESH-206	5.08	30.99	12.05	18.15	3 7/8"-12	3.90	2.13
30	2.52	ESH-302	7.44	18.73	7.05	9.57	4 1/2"-12	4.49	2.48
	6.10	ESH-306	7.44	45.38	12.99	19.09	4 1/2"-12	4.49	2.48
60	2.99	ESH-603	13.55	40.50	9.72	12.72	6 1/4"-12	6.26	3.58
	6.02	ESH-606	13.55	81.56	12.72	18.74	6 1/4"-12	6.26	3.58
95	2.99	ESH-1003	20.96	62.71	10.00	12.99	8 3/8"-12	8.35	4.96

ESH-SERIES

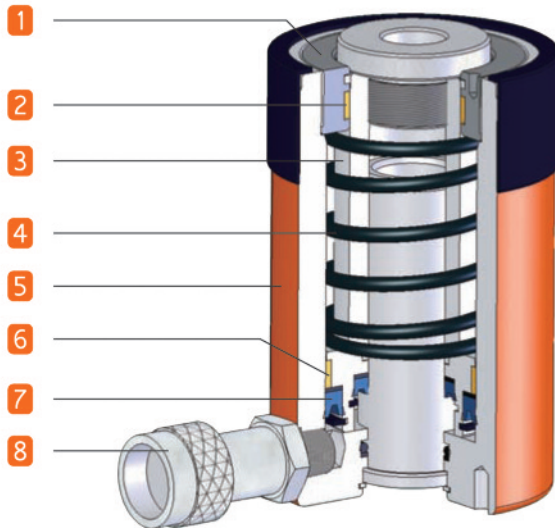

1. Steel Guide ring eliminates over travel, and provides support to reduce wear from off center loads.
2. Bearing ring provides additional support to reduce wear from off center loads.
3. Hardened and chromed piston increase durability and reduces wear.
4. High strength return spring.
5. All steel body with baked enamel finish for durability.
6. Industrial bearing ring provides additional support to reduce wear from off center loads.
7. Industrial seal ring assembly prevent costly leaks.
8. Standard coupler on all cylinders provided with heavy duty dust cover.



4 EAGLE PRO ESH-306 pulling threaded bar in a the largest heat exchanger in SONDEX's factory in Ningbo China.

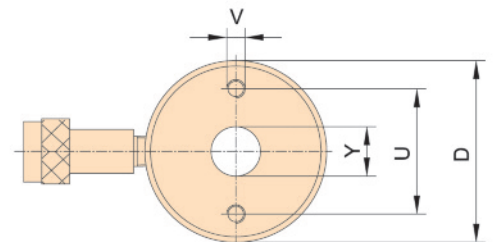

Base Fix Holes		Center Hole Diameter	Weight	Model
Thread	Bolt Circle			
V	U	Y	lbs	
UNC	in	in		
5/16"-18	2.00	0.77	3.3	ESH-120
-	-	0.77	6.16	ESH-121
5/16"-18	2.00	0.77	9.68	ESH-123
3/8"-16	3.25	1.06	16.94	ESH-202
3/8"-16	3.25	1.06	31.02	ESH-206
3/8"-16	3.63	1.31	23.98	ESH-302
3/8"-16	3.63	1.31	47.96	ESH-306
1/2"-13	5.13	2.12	61.82	ESH-603
1/2"-13	5.13	2.12	77.88	ESH-606
5/8"-11	7.00	3.11	131.78	ESH-1003

