

# Silencers

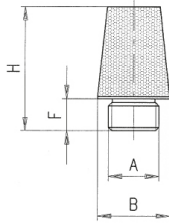

## Coned Brass & Sintered Bronze Silencers



### Technical Characteristics

**Maximum pressure:** 10 bar  
**Minimum temperature:** -10°C  
**Maximum temperature:** +80°C  
**Filtration threshold:** 50 µm

**dB = Noise level in (dB) at 6 bar**

Code	A	F	B	H	dB
7000-1/8	1/8"	4.5	12.5	21	81
7000-1/4	1/4"	6	15	25	83
7000-3/8	3/8"	8.5	19	34.5	87
7000-1/2	1/2"	8	23	43	90
7000-3/4	3/4"	9	30	50	92 @ 4 bar
7000-1	1"	11	37	60.5	92 @ 4 bar

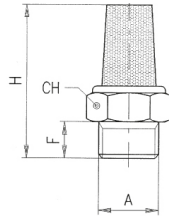

### Technical Characteristics

**Maximum pressure:** 10 bar  
**Minimum temperature:** -10°C  
**Maximum temperature:** +80°C  
**Filtration threshold:** 50 µm

**dB = Noise level in (dB) at 6 bar**

Code	A	F	H	CH
7030-M5	M5	4	17	8
7030-1/8	1/8"	6	22	13
7030-1/4	1/4"	7	32	16
7030-3/8	3/8"	8	40	19
7030-1/2	1/2"	9	45	24
7030-3/4	3/4"	10	56	30
7030-1	1"	12	66	36

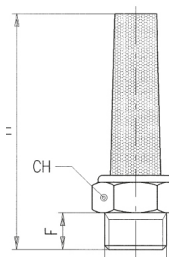

### Technical Characteristics

**Maximum pressure:** 12 bar  
**Minimum temperature:** -10°C  
**Maximum temperature:** +80°C  
**Filtration threshold:** 36 µm

**dB = Noise level in (dB) at 6 bar**

Code	A	F	H	CH	dB
7040-1/8	1/8"	6	44	13	76
7040-1/4	1/4"	7	50	16	75
7040-3/8	3/8"	8	54	19	88
7040-1/2	1/2"	9	67	24	89
7040-3/4	3/4"	9	65	30	

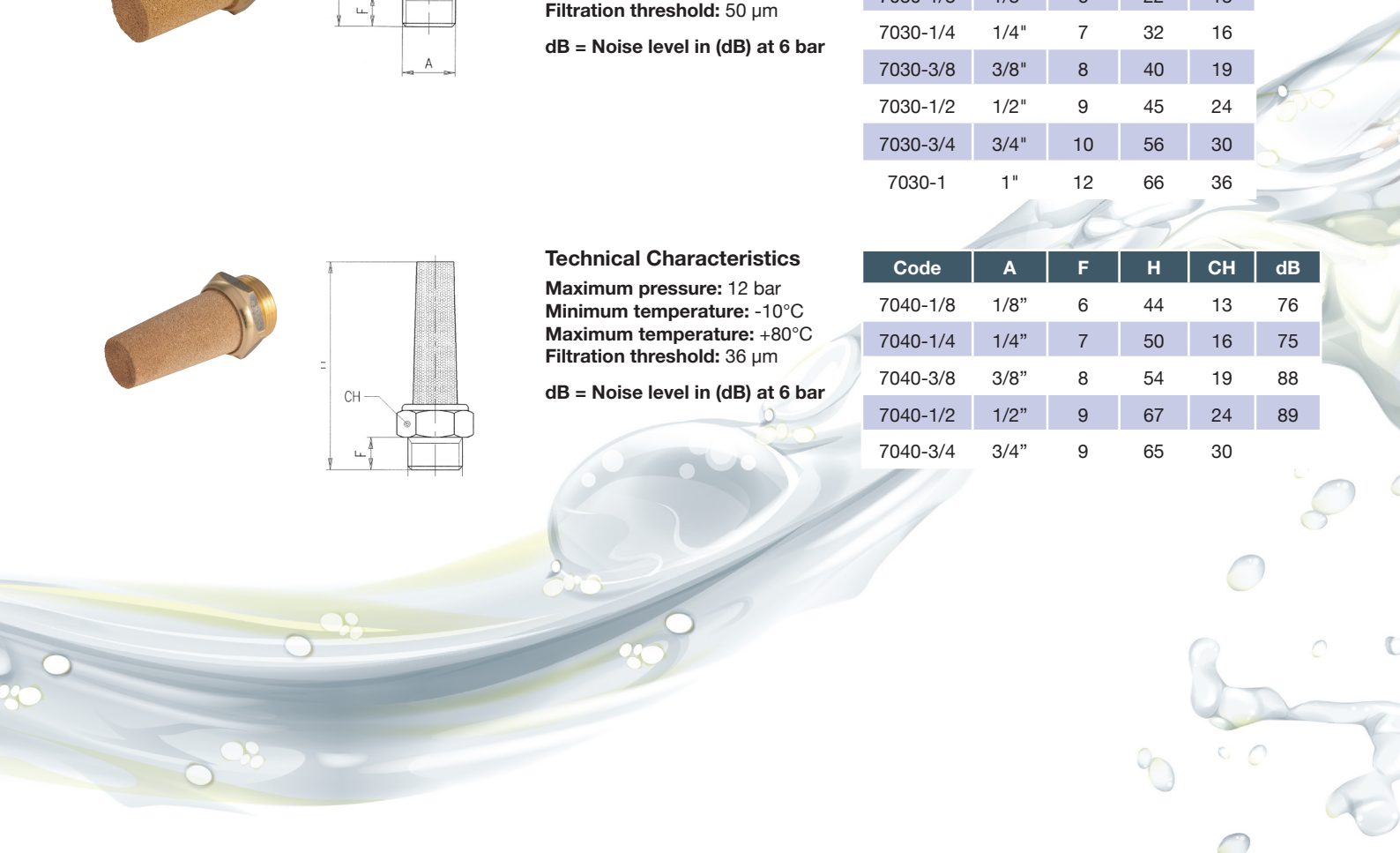

## Flat Brass & Sintered Bronze Silencers

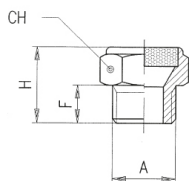

### Technical Characteristics

**Maximum pressure:** 12 bar  
**Minimum temperature:** -10°C  
**Maximum temperature:** +80°C  
**Filtration threshold:** 100 µm

**dB = Noise level in (dB) at 6 bar**

Code	A	F	H	CH	dB
7010-1/8	1/8"	6	14	13	73
7010-1/4	1/4"	7	17	16	74
7010-3/8	3/8"	8	18	19	85
7010-1/2	1/2"	10	20	24	89
7010-3/4	3/4"	10	23	30	90

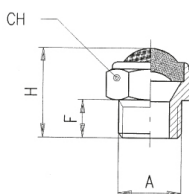

### Technical Characteristics

**Maximum pressure:** 12 bar  
**Minimum temperature:** -10°C  
**Maximum temperature:** +80°C  
**Filtration threshold:** 100 µm

**dB = Noise level in (dB) at 6 bar**

Code	A	F	H	CH	dB
7020-M5	M5	4	9	8	
7020-1/8	1/8"	6	15	13	74
7020-1/4	1/4"	7	18	16	72
7020-3/8	3/8"	8	20	19	88
7020-1/2	1/2"	10	22	24	90
7020-3/4	3/4"	10	26	30	90

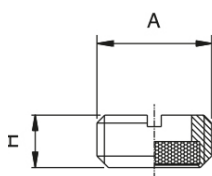

### Technical Characteristics

**Maximum pressure:** 12 bar  
**Minimum temperature:** -10°C  
**Maximum temperature:** +80°C  
**Filtration threshold:** 120 µm

**dB = Noise level in (dB) at 6 bar**

Code	A	H
7120-1/8	1/8"	4
7120-1/4	1/4"	6
7120-3/8	3/8"	6
7120-1/2	1/2"	9
7120-3/4	3/4"	10
7120-1	1"	10