

ISO 5676 Trailer Brake, Interchange Couplings & Plugs

High Pressure Screw-on Coupling (Carbon Steel), 65 Series, ISO 5676

Applications: Trailer Brake Couplings are used to connect the hydraulic braking system of tractors to their trailers. The male coupling is normally panel mounted on the tractor and is available with metric and BSP threads.

Used to connect the hydraulic braking system of tractors to their trailers.

Working Temperature:
-20°C to +100°C

Maximum Working Pressure:
150 bar

Part. No.	Size	Body Size	Ls	D	H2	T
HFSFC6518	06	3/8"	59	45	27	M18x1.5
HFSFC6522	06	3/8"	59	45	27	M22x1.5
HFSFC6538	06	3/8"	57	45	27	3/8" BSPP
HFSFC6512	06	3/8"	57	45	27	1/2" BSPP

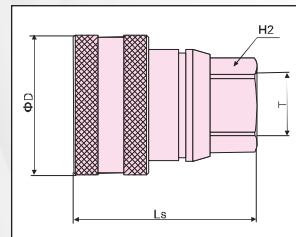

Part. No.	Size	Body Size	Lp	B	G	C	H1	H2	T
HFSFP6518	06	3/8"	51	23	30	6	27	32	M18x1.5
HFSFP6522	06	3/8"	51	23	30	7	30	32	M22x1.5
HFSFP6538	06	3/8"	62	34	30	8	30	32	1/2" BSPP
HFSFP6512	06	3/8"	62	34	30	8	30	32	3/8" BSPP

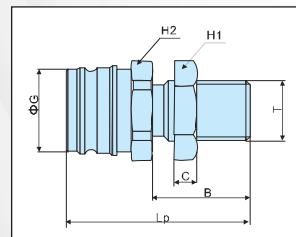

Performance:

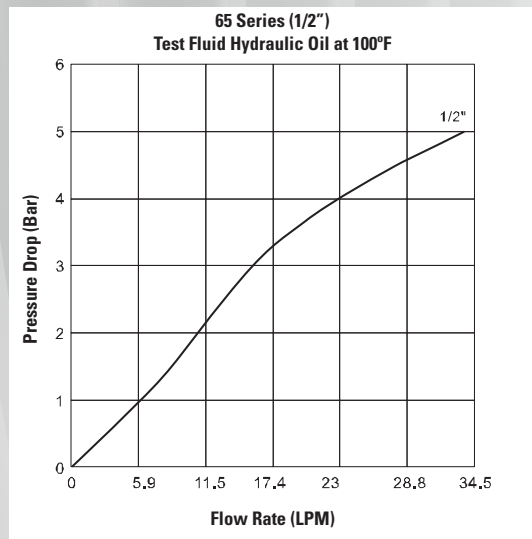

Interchange:

Faster VF (VFB) Series, Voswinkel BP Series Stucchi IFR Series, DNP PFT Series. Gromelle 609-Aseries, Holmbury TB Series

Material:

Coupler Body: Steel, Trivalent Plated
 Valve: Steel, Poppet Type
 Springs: 55CrSi
 Locking O-Ring : C98
 Balls: GCr15
 Seals: Buna-N (Nitrile)
 Back-Up Ring: PTFE
 Surface treatment: Zinc plating and Cr 3+ Passivation or Yellow Passivation

Attention:

Only plug and socket with the same thread fit together.

° Temperature Range:

-20°C to +100°C / -4°F to +212°F
 With standard seals: Buna-N (Nitrile)
 On request seals: Viton, Neoprene, EPDM or other seals.

Maximum Working Pressure:

150 Bar