

# Backnut, Recessed (312)



### Black

Part Code	Thread	a mm	s mm
GF312-14N*	1/4"	7.5	22
GF312-12N	1/2"	9.0	32
GF312-34N	3/4"	10.0	37
GF312-1N	1"	12.0	46
GF312-114N	1.1/4"	13.0	55
GF312-112N	1.1/2"	14.0	60
GF312-2N	2"	16.0	73

### Galvanised

Part Code	Thread	a mm	s mm
GF312-38*	3/8"	8.0	27
GF312-12	1/2"	9.0	32
GF312-34	3/4"	10.0	37
GF312-1	1"	12.0	46
GF312-114	1.1/4"	13.0	55
GF312-112	1.1/2"	14.0	60
GF312-2	2"	16.0	73

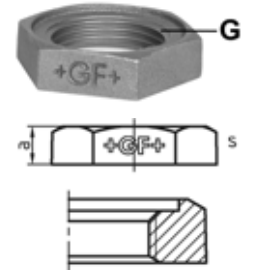

\*Stainless Steel

# Flange, Undrilled (321)

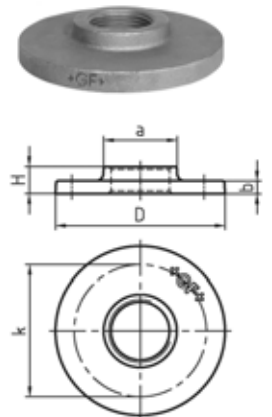

### Black

Part Code	Thread	a mm	b mm	k mm	H mm	D mm
GF321-12N	1/2"	28	5	55	13	80
GF321-34N	3/4"	38	6	65	14	90
GF321-1N	1"	47	9	75	17	100
GF321-114N	1.1/4"	51	10	90	21	120
GF321-112N	1.1/2"	56	10	100	21	130
GF321-2N	2"	68	11	110	22	140

### Galvanised

Part Code	Thread	a mm	b mm	k mm	H mm	D mm
GF321-12	1/2"	28	5	55	13	80
GF321-34	3/4"	38	6	65	14	90
GF321-1	1"	47	9	75	17	100
GF321-114	1.1/4"	51	10	90	21	120
GF321-112	1.1/2"	56	10	100	21	130
GF321-2	2"	68	11	110	22	140