



37-8000 - (2500-FG)

JIC Male x JIC Male 90 Deg Forged Compact Elbow



BRENNAN INDUSTRIES, EXTRAORDINARY FITTINGS

In business for over 60 years, Brennan supplies more than 50,000 types of hydraulic fittings and adaptors in sizes ranging from 1/16 to 3 inches.

Learn More at Brennan University:

[Fittings 101](#)

[Tube Fittings Resources](#)

[Literature and Certifications](#)

Tech Data Sheet: 71399

37-8000 - (2500-FG)

DESCRIPTION:

JIC MALE X JIC MALE 90 DEG FORGED
COMPACT ELBOW

UK PART NUMBER:

37-8000

US PART NUMBER:

2500-FG

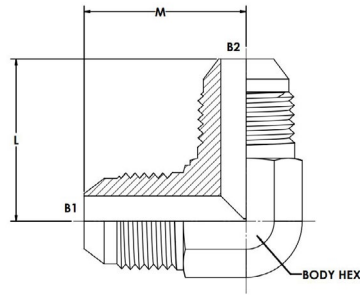

Item	B1 TUBE O.D.	B2 TUBE O.D.	B1 SAE 37 Deg	B2 SAE 37 Deg	B1 DRILL	B2 DRILL	M1 LGTH	M2 LGTH	Y FLATS	Material
37-8000-02-02	1/8	1/8	5/16-24	5/16-24	0.062	0.062	0.770	0.770	0.438	STEEL
37-8000-03-03	3/16	3/16	3/8-24	3/8-24	0.125	0.125	0.830	0.830	0.438	STEEL
37-8000-04-04	1/4	1/4	7/16-20	7/16-20	0.172	0.172	0.890	0.890	0.438	STEEL
37-8000-05-04	5/16	1/4	1/2-20	7/16-20	0.234	0.172	0.95	0.95	0.562	STEEL
37-8000-05-05	5/16	5/16	1/2-20	1/2-20	0.234	0.234	0.950	0.950	0.562	STEEL
37-8000-06-04	3/8	1/4	9/16-18	7/16-20	0.297	0.172	1.06	1.05	0.562	STEEL
37-8000-06-05	3/8	5/16	9/16-18	1/2-20	0.297	0.234	1.060	1.050	0.562	STEEL
37-8000-06-06	3/8	3/8	9/16-18	9/16-18	0.297	0.297	1.06	1.06	0.562	STEEL
37-8000-08-04	1/2	1/4	3/4-16	7/16-20	0.391	0.172	1.25	1.12	0.750	STEEL
37-8000-08-06	1/2	3/8	3/4-16	9/16-18	0.391	0.297	1.25	1.14	0.750	STEEL
37-8000-08-08	1/2	1/2	3/4-16	3/4-16	0.391	0.391	1.25	1.25	0.750	STEEL
37-8000-10-08	5/8	1/2	7/8-14	3/4-16	0.484	0.391	1.450	1.330	0.875	STEEL
37-8000-10-10	5/8	5/8	7/8-14	7/8-14	0.484	0.484	1.45	1.45	0.875	STEEL
37-8000-12-08	3/4	1/2	1-1/16-12	3/4-16	0.609	0.391	1.660	1.420	1.062	STEEL
37-8000-12-10	3/4	5/8	1-1/16-12	7/8-14	0.609	0.484	1.66	1.54	1.062	STEEL
37-8000-12-12	3/4	3/4	1-1/16-12	1-1/16-12	0.609	0.609	1.66	1.66	1.062	STEEL
37-8000-14-14	7/8	7/8	1-3/16-12	1-3/16-12	0.719	0.719	1.80	1.80	1.312	STEEL
37-8000-16-12	1	3/4	1-5/16-12	1-1/16-12	0.844	0.609	1.810	1.760	1.312	STEEL
37-8000-16-16	1	1	1-5/16-12	1-5/16-12	0.844	0.844	1.81	1.81	1.312	STEEL
37-8000-20-20	1 1/4	1 1/4	1-5/8-12	1-5/8-12	1.078	1.078	2.06	2.06	1.625	STEEL
37-8000-24-24	1 1/2	1 1/2	1-7/8-12	1-7/8-12	1.312	1.312	2.33	2.33	1.875	STEEL
37-8000-32-32	2	2	2-1/2-12	2-1/2-12	1.781	1.781	3.060	3.060	2.500	STEEL