

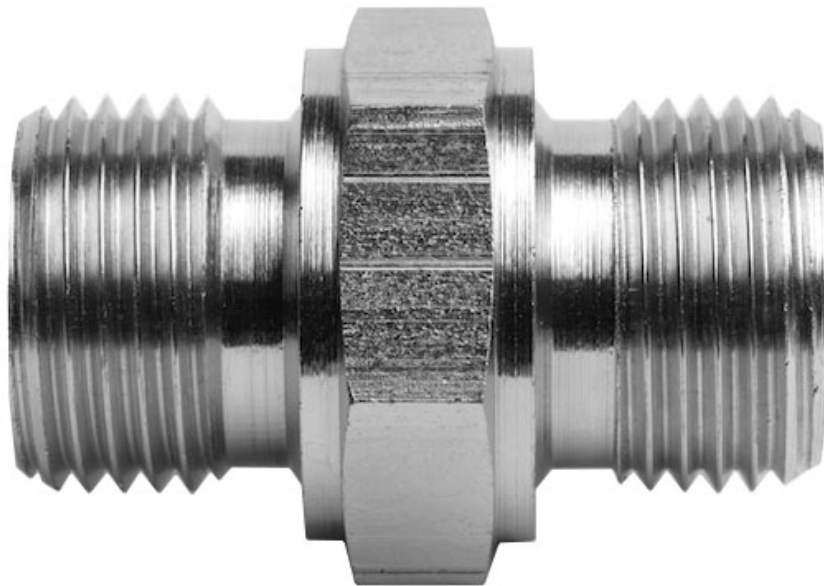

60-6015-X1 Series (9025)

Metric Male x BSPP Male 60 Deg Cone



BRENNAN INDUSTRIES, EXTRAORDINARY FITTINGS

In business for over 60 years, Brennan supplies more than 50,000 types of hydraulic fittings and adaptors in sizes ranging from 1/16 to 3 inches.

Learn More at Brennan University:

[Fittings 101](#)

[Tube Fittings Resources](#)

[Literature and Certifications](#)

Tech Data Sheet: 71450

60-6015-X1 SERIES (9025)

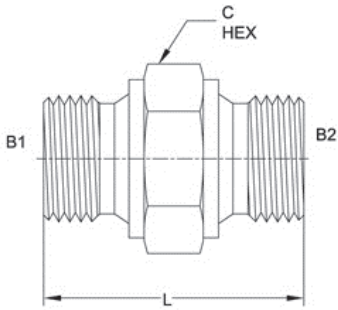
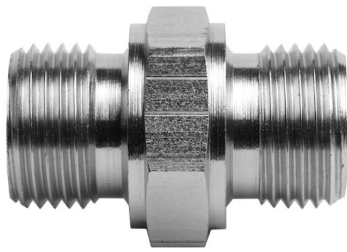

DESCRIPTION:

Metric Male x BSPP Male 60 Deg Cone

UK SERIES:

60-6015-X1

US SERIES:

9025

THREAD TYPE B1:

MALE BSPP WITH 60 DEGREE SEAT

THREAD SPECIFICATION B1:

60 DEG SEAT SWIVEL CONNECTION

THREAD TYPE B2:

MALE METRIC WITH 60 DEG SEAT

THREAD SPECIFICATION B2:

ISO 9974

BODY MATERIAL:

STEEL

Item	THREAD SIZE B1	THREAD DRILL B1 (MM)	THREAD SIZE B2	THREAD DRILL B2 (MM)
60-6015-02-08x1	1/8-28		M08X1.0	
60-6015-02-14	1/8-28		M14X1.5	
60-6015-04-10x1	1/4-19		M10X1.0	
60-6015-04-10	1/4-19		M10X1.5	
60-6015-04-12	1/4-19	6.0	M12X1.5	5.0
60-6015-04-14	1/4-19	4.7	M14X1.5	4.7
60-6015-04-16	1/4-19		M16X1.5	
60-6015-04-18	1/4-19	4.7	M18X1.5	11.0
60-6015-04-20	1/4-19		M20X1.5	
60-6015-04-22	1/4-19		M22X1.5	
60-6015-06-10x1	3/8-19		M10X1.0	
60-6015-06-12	3/8-19	9.5	M12X1.5	5.0
60-6015-06-14	3/8-19		M14X1.5	
60-6015-06-16	3/8-19	7.9	M16X1.5	7.9
60-6015-06-18	3/8-19	9.5	M18X1.5	11.1
60-6015-06-20	3/8-19	7.9	M20X1.5	12.3
60-6015-06-22	3/8-19		M22X1.5	
60-6015-08-12	1/2-14		M12X1.5	
60-6015-08-14	1/2-14		M14X1.5	
60-6015-08-16	1/2-14		M16X1.5	
60-6015-08-18	1/2-14	11.1	M18X1.5	11.1
60-6015-08-20	1/2-14		M20X1.5	
60-6015-08-22	1/2-14	12.0	M22X1.5	14.0
60-6015-08-24	1/2-14		M24X1.5	
60-6015-08-26	1/2-14		M26X1.5	
60-6015-12-16	3/4-14		M16X1.5	
60-6015-12-18	3/4-14	16.7	M18X1.5	11.0
60-6015-12-20	3/4-14	16.7	M20X1.5	12.5
60-6015-12-22	3/4-14	16.7	M22X1.5	14.0
60-6015-12-24	3/4-14		M24X1.5	
60-6015-12-26	3/4-14	16.7	M26X1.5	18.0
60-6015-12-30	3/4-14	14.6	M30X1.5	21.2
60-6015-16-22	1-11		M22X1.5	
60-6015-16-26	1-11		M26X1.5	
60-6015-16-30	1-11		M30X1.5	

