



## 50-5500 - (5500-FG)

NPT Male x NPT Male 90 Deg Compact Elbow



### **BRENNAN INDUSTRIES, EXTRAORDINARY FITTINGS**

In business for over 60 years, Brennan supplies more than 50,000 types of hydraulic fittings and adaptors in sizes ranging from 1/16 to 3 inches.

#### **Learn More at Brennan University:**

[Fittings 101](#)

[Tube Fittings Resources](#)

[Literature and Certifications](#)

**Tech Data Sheet: 71511**

# 50-5500 - (5500-FG)

## DESCRIPTION:

NPT MALE X NPT MALE 90 DEG COMPACT  
ELBOW

## UK PART NUMBER:

50-5500

## US PART NUMBER:

5500-FG

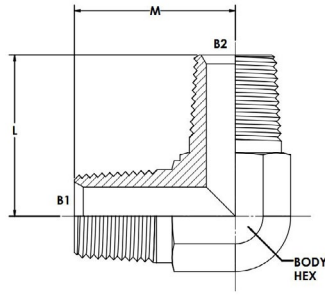

Item	A1 NPTF	A2 NPTF	A1 DRILL	A2 DRILL	N1 LGTH	N LGTH	Y FLATS	Material
50-5500-02-02	1/8-27	1/8-27	0.188	0.188	0.780	0.780	0.438	STEEL
50-5500-04-02	1/4-18	1/8-27	0.281	0.188	1.09	0.90	0.562	STEEL
50-5500-04-04	1/4-18	1/4-18	0.281	0.281	1.09	1.09	0.562	STEEL
50-5500-06-02	3/8-18	1/8-27	0.406	0.188	1.220	1.030	0.750	STEEL
50-5500-06-04	3/8-18	1/4-18	0.406	0.281	1.22	1.22	0.750	STEEL
50-5500-06-06	3/8-18	3/8-18	0.406	0.406	1.22	1.22	0.750	STEEL
50-5500-08-04	1/2-14	1/4-18	0.531	0.281	1.470	1.280	0.875	STEEL
50-5500-08-06	1/2-14	3/8-18	0.531	0.406	1.47	1.28	0.875	STEEL
50-5500-08-08	1/2-14	1/2-14	0.531	0.531	1.47	1.47	0.875	STEEL
50-5500-12-06	3/4-14	3/8-18	0.719	0.406	1.590	1.400	1.062	STEEL
50-5500-12-08	3/4-14	1/2-14	0.719	0.531	1.59	1.59	1.062	STEEL
50-5500-12-12	3/4-14	3/4-14	0.719	0.719	1.59	1.59	1.062	STEEL
50-5500-16-08	1-11-1/2	1/2-14	0.938	0.531	1.970	1.780	1.312	STEEL
50-5500-16-12	1-11-1/2	3/4-14	0.938	0.719	1.97	1.78	1.312	STEEL
50-5500-16-16	1-11-1/2	1-11-1/2	0.938	0.938	1.97	1.97	1.312	STEEL
50-5500-20-16	1-1/4-11-1/2	1-11-1/2	1.250	0.938	2.382	2.350	1.625	STEEL
50-5500-20-20	1 1/4-11 1/2	1 1/4-11 1/2	1.250	1.250	2.380	2.380	1.625	STEEL
50-5500-24-24	1-1/2-11-1/2	1-1/2-11-1/2	1.500	1.500	2.640	2.640	1.875	STEEL
50-5500-32-32	2-11 1/2	2-11 1/2	1.938	1.938	3.00	3.00	2.500	STEEL