

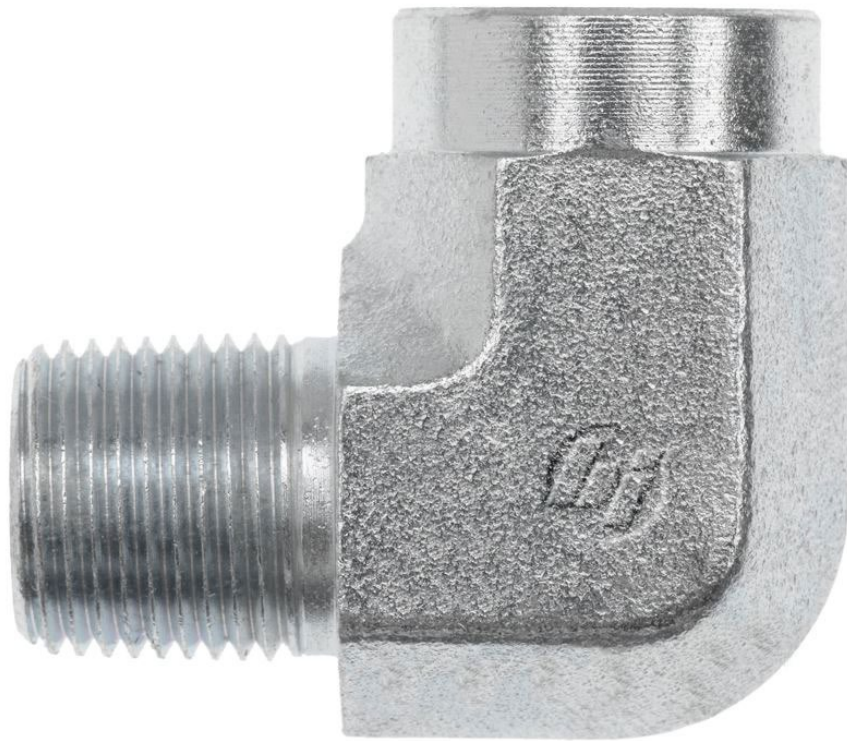

50-5502 - (5502-FG)

NPT Male x NPT Fixed Female 90 Deg Compact Elbow



BRENNAN INDUSTRIES, EXTRAORDINARY FITTINGS

In business for over 60 years, Brennan supplies more than 50,000 types of hydraulic fittings and adaptors in sizes ranging from 1/16 to 3 inches.

Learn More at Brennan University:

[Fittings 101](#)

[Tube Fittings Resources](#)

[Literature and Certifications](#)

Tech Data Sheet: 71512

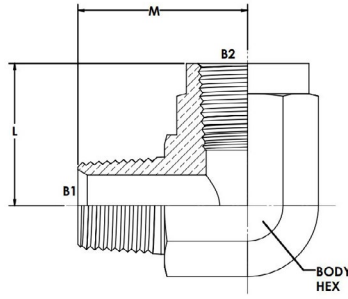
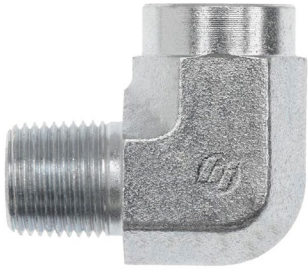

50-5502 - (5502-FG)

DESCRIPTION:

**NPT MALE X NPT FIXED FEMALE 90 DEG
COMPACT ELBOW**

UK PART NUMBER:

50-5502

US PART NUMBER:

5502-FG

Item	A1 NPTF	A2 NPTF	A1 DRILL	N LGTH	N1 LGTH	Y FLATS	Material
50-5502-01-02	1/16-27	1/8-27	0.117	0.780	0.660	0.562	STEEL
50-5502-02-02	1/8-27	1/8-27	0.188	0.780	0.660	0.562	STEEL
50-5502-02-04	1/8-27	1/4-18	0.188	0.900	0.880	0.750	STEEL
50-5502-02-06	1/8-27	3/8-18	0.188	1.030	1.020	0.875	STEEL
50-5502-04-02	1/4-18	1/8-27	0.281	1.090	0.660	0.562	STEEL
50-5502-04-04	1/4-18	1/4-18	0.281	1.090	0.880	0.750	STEEL
50-5502-04-06	1/4-18	3/8-18	0.281	1.220	1.020	0.875	STEEL
50-5502-06-04	3/8-18	1/4-18	0.406	1.220	1.010	0.875	STEEL
50-5502-06-06	3/8-18	3/8-18	0.406	1.220	1.020	0.875	STEEL
50-5502-06-08	3/8-18	1/2-14	0.406	1.280	1.230	1.062	STEEL
50-5502-08-04	1/2-14	1/4-18	0.531	1.470	1.010	0.875	STEEL
50-5502-08-06	1/2-14	3/8-18	0.531	1.470	1.020	0.875	STEEL
50-5502-08-08	1/2-14	1/2-14	0.531	1.470	1.230	1.062	STEEL
50-5502-08-12	1/2-14	3/4-14	0.531	1.590	1.360	1.312	STEEL
50-5502-12-06	3/4-14	3/8-18	0.719	1.590	1.040	1.062	STEEL
50-5502-12-08	3/4-14	1/2-14	0.719	1.590	1.230	1.062	STEEL
50-5502-12-12	3/4-14	3/4-14	0.719	1.590	1.360	1.312	STEEL
50-5502-12-16	3/4-14	1-11-1/2	0.719	1.770	1.620	1.625	STEEL
50-5502-16-12	1-11-1/2	3/4-14	0.938	1.970	1.360	1.312	STEEL
50-5502-16-16	1-11-1/2	1-11-1/2	0.938	1.970	1.620	1.625	STEEL
50-5502-16-20	1-11-1/2	1-1/4-11-1/2	0.938	2.350	1.700	1.875	STEEL
50-5502-20-16	1-1/4-11-1/2	1-11-1/2	1.250	2.380	1.620	1.625	STEEL
50-5502-20-20	1-1/4-11-1/2	1-1/4-11-1/2	1.250	2.380	1.700	1.875	STEEL
50-5502-20-24	1-1/4-11-1/2	1-1/2-11-1/2	1.250	2.610	2.080	2.562	STEEL
50-5502-24-20	1-1/2-11-1/2	1-1/4-11-1/2	1.500	2.64	1.70	1.875	STEEL
50-5502-24-24	1-1/2-11-1/2	1-1/2-11-1/2	1.500	2.640	2.080	2.562	STEEL
50-5502-32-32	2-11-1/2	2-11-1/2	1.938	3.000	2.390	2.812	STEEL