

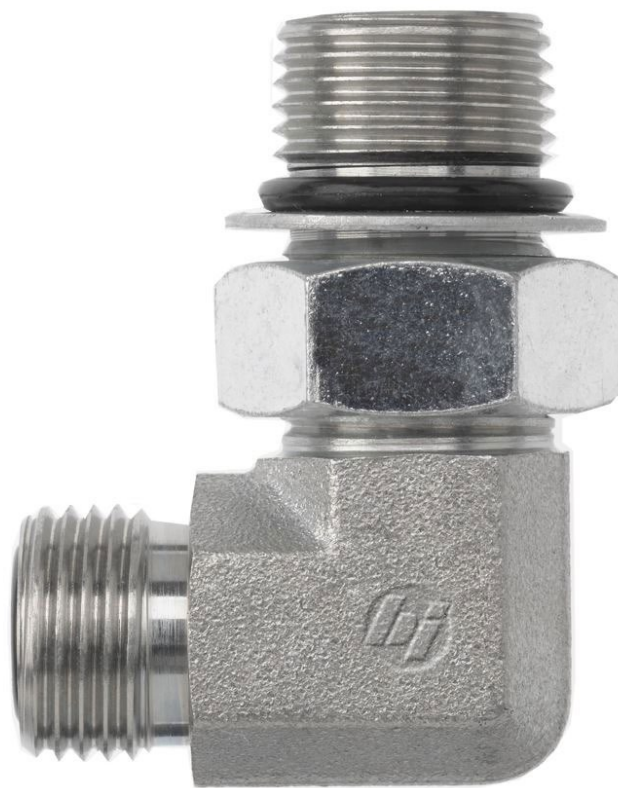

OR-8050 - (FS6801-NW0-FG)

Male x UNF Male 90 Deg Positional Forged Elbow with O-Ring



BRENNAN INDUSTRIES, EXTRAORDINARY FITTINGS

In business for over 60 years, Brennan supplies more than 50,000 types of hydraulic fittings and adaptors in sizes ranging from 1/16 to 3 inches.

Learn More at Brennan University:

[Fittings 101](#)

[Tube Fittings Resources](#)

[Literature and Certifications](#)

Tech Data Sheet: 71366

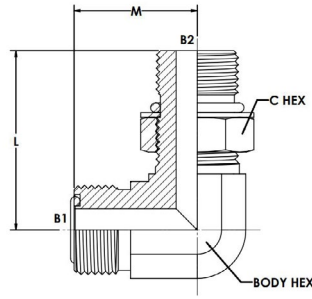

OR-8050 - (FS6801-NWO-FG)

DESCRIPTION:

MALE X UNF MALE 90 DEG POSITIONAL
FORGED ELBOW WITH O-RING

UK PART NUMBER:

OR-8050

US PART NUMBER:

FS6801-NWO-FG

Item	TUBE O.D.	A THREAD	B THREAD	A DRILL	B DRILL	M LGTH	N LGTH	C HEX	JJ FLATS	Material
OR-8050-04-04	1/4	9/16-18	7/16-20	0.172	0.172	0.85	1.29	0.625	0.562	STEEL
OR-8050-04-05	1/4	9/16-18	1/2-20	0.172	0.234	0.85	1.29	0.687	0.562	STEEL
OR-8050-04-06	1/4	9/16-18	9/16-18	0.172	0.264	0.92	1.45	0.750	0.750	STEEL
OR-8050-04-08	1/4	9/16-18	3/4-16	0.172	0.378	0.970	1.600	0.938	0.750	STEEL
OR-8050-06-04	3/8	11/16-16	7/16-20	0.264	0.172	0.980	1.370	0.625	0.750	STEEL
OR-8050-06-05	3/8	11/16-16	1/2-20	0.264	0.236	0.98	1.45	0.687	0.750	STEEL
OR-8050-06-06	3/8	11/16-16	9/16-18	0.264	0.264	0.980	1.450	0.750	0.750	STEEL
OR-8050-06-08	3/8	11/16-16	3/4-16	0.264	0.378	1.04	1.60	0.938	0.750	STEEL
OR-8050-06-10	3/8	11/16-16	7/8-14	0.264	0.484	1.150	1.970	1.062	1.062	STEEL
OR-8050-06-12	3/8	11/16-16	1-1/16-12	0.264	0.609	1.250	2.170	1.375	1.188	STEEL
OR-8050-08-04	1/2	13/16-16	7/16-20	0.378	0.172	1.100	1.360	0.625	0.750	STEEL
OR-8050-08-06	1/2	13/16-16	9/16-18	0.378	0.264	1.10	1.44	0.750	0.750	STEEL
OR-8050-08-08	1/2	13/16-16	3/4-16	0.378	0.378	1.10	1.60	0.938	0.750	STEEL
OR-8050-08-10	1/2	13/16-16	7/8-14	0.378	0.484	1.21	1.97	1.062	1.062	STEEL
OR-8050-08-12	1/2	13/16-16	1-1/16-12	0.378	0.609	1.320	2.170	1.375	1.188	STEEL
OR-8050-10-08	5/8	1-14	3/4-16	0.484	0.378	1.31	1.80	0.938	1.062	STEEL
OR-8050-10-10	5/8	1-14	7/8-14	0.484	0.484	1.31	1.97	1.062	1.062	STEEL
OR-8050-10-12	5/8	1-14	1-1/16-12	0.484	0.609	1.410	2.170	1.375	1.188	STEEL
OR-8050-12-08	3/4	1-3/16-12	3/4-16	0.609	0.378	1.470	1.840	0.938	1.188	STEEL
OR-8050-12-10	3/4	1-3/16-12	7/8-14	0.609	0.484	1.47	2.01	1.062	1.188	STEEL
OR-8050-12-12	3/4	1-3/16-12	1-1/16-12	0.609	0.609	1.47	2.17	1.375	1.188	STEEL
OR-8050-12-16	3/4	1-3/16-12	1-5/16-12	0.609	0.811	1.62	2.35	1.625	1.438	STEEL
OR-8050-16-12	1	1-7/16-12	1-1/16-12	0.811	0.609	1.640	2.320	1.375	1.438	STEEL
OR-8050-16-16	1	1-7/16-12	1-5/16-12	0.811	0.811	1.64	2.35	1.625	1.438	STEEL
OR-8050-16-20	1	1-7/16-12	1-5/8-12	0.811	1.024	1.760	2.450	1.875	1.625	STEEL
OR-8050-16-24	1	1-7/16-12	1-7/8-12	0.811	1.260	1.920	2.590	2.125	1.875	STEEL
OR-8050-20-12	1-1/4	1-11/16-12	1-1/16-12	1.024	0.609	1.760	2.420	1.375	1.625	STEEL
OR-8050-20-16	1-1/4	1-11/16-12	1-5/16-12	1.024	0.811	1.76	2.45	1.625	1.625	STEEL
OR-8050-20-20	1-1/4	1-11/16-12	1-5/8-12	1.024	1.024	1.760	2.450	1.875	1.625	STEEL
OR-8050-20-24	1-1/4	1-11/16-12	1-7/8-12	1.024	1.260	1.92	2.59	2.125	1.875	STEEL
OR-8050-24-20	1-1/2	2-12	1-5/8-12	1.260	1.024	1.920	2.590	1.875	1.875	STEEL
OR-8050-24-24	1-1/2	2-12	1-7/8-12	1.260	1.260	1.920	2.590	2.125	1.875	STEEL