

60-6000-DIN - (9022-DIN)

BSPP Male x BSPP Male 60 Deg Cone DIN 3852 Form A

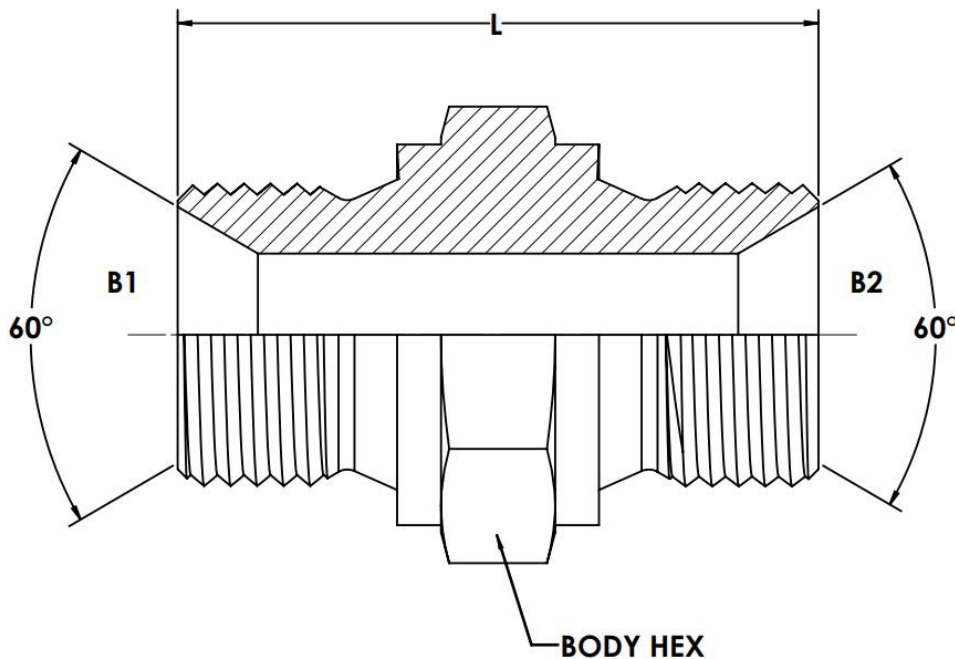

BRENNAN INDUSTRIES, EXTRAORDINARY FITTINGS

In business for over 60 years, Brennan supplies more than 50,000 types of hydraulic fittings and adaptors in sizes ranging from 1/16 to 3 inches.

Learn More at Brennan University:

[Fittings 101](#)

[Tube Fittings Resources](#)

[Literature and Certifications](#)

Tech Data Sheet: 71434

60-6000-DIN - (9022-DIN)

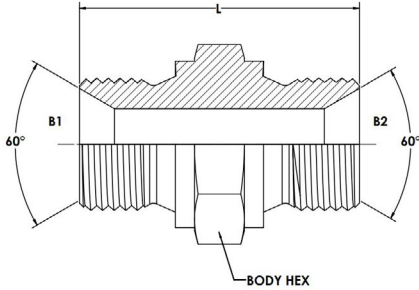
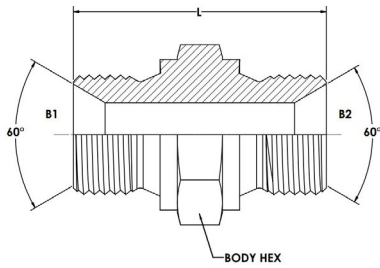

DESCRIPTION:

BSPP Male x BSPP Male 60 Deg
Cone DIN 3852 Form A

UK SERIES:

60-6000-DIN

US SERIES:

9022-DIN

THREAD TYPE B1:

MALE BSPP DIN 3852 FORM A

THREAD SPECIFICATION B1:

DIN 3852 FORM A

THREAD TYPE B2:

MALE BSPP DIN 3852 FORM A

THREAD SPECIFICATION B2:

DIN 3852 FORM A

BODY MATERIAL:

STEEL

Item	THREAD SIZE B1	THREAD DRILL B1 (MM)	THREAD SIZE B2	THREAD DRILL B2 (MM)
60-6000-DIN-02-02	1/8-28	3.5	1/8-28	3.5
60-6000-DIN-04-02	1/4-19	4.7	1/8-28	3.5
60-6000-DIN-04-04	1/4-19	4.7	1/4-19	4.7
60-6000-DIN-06-02	3/8-19	7.9	1/8-28	3.5
60-6000-DIN-06-04	3/8-19	7.9	1/4-19	4.7
60-6000-DIN-06-06	3/8-19	7.9	3/8-19	7.9
60-6000-DIN-08-02	1/2-14	11.1	1/8-28	3.5
60-6000-DIN-08-04	1/2-14	11.1	1/4-19	4.7
60-6000-DIN-08-06	1/2-14	11.1	3/8-19	7.9
60-6000-DIN-08-08	1/2-14	11.1	1/2-14	11.1
60-6000-DIN-10-04	5/8-14	14.3	1/4-19	4.7
60-6000-DIN-10-06	5/8-14	14.3	3/8-19	7.9
60-6000-DIN-10-08	5/8-14	14.3	1/2-14	11.1
60-6000-DIN-10-10	5/8-14	14.3	5/8-14	14.3
60-6000-DIN-12-02	3/4-14		1/8-28	
60-6000-DIN-12-04	3/4-14	16.7	1/4-19	4.7
60-6000-DIN-12-06	3/4-14	16.7	3/8-19	7.9
60-6000-DIN-12-08	3/4-14	16.7	1/2-14	11.1
60-6000-DIN-12-10	3/4-14	16.7	5/8-14	14.3
60-6000-DIN-12-12	3/4-14	16.7	3/4-14	16.7
60-6000-DIN-16-04	1-11	22.2	1/4-19	4.7
60-6000-DIN-16-06	1-11	22.2	3/8-19	7.9
60-6000-DIN-16-08	1-11	22.2	1/2-14	11.1
60-6000-DIN-16-10	1-11	22.2	5/8-14	14.3
60-6000-DIN-16-12	1-11	22.2	3/4-14	16.7
60-6000-DIN-16-16	1-11	22.2	1-11	22.2
60-6000-DIN-20-04	1-1/4-11	28.6	1/4-19	4.7
60-6000-DIN-20-06	1-1/4-11	28.6	3/8-19	7.9
60-6000-DIN-20-08	1-1/4-11	28.6	1/2-14	11.1
60-6000-DIN-20-10	1-1/4-11		5/8-14	
60-6000-DIN-20-12	1-1/4-11	28.6	3/4-14	16.7
60-6000-DIN-20-16	1-1/4-11	28.6	1-11	22.2
60-6000-DIN-20-20	1-1/4-11	28.6	1-1/4-11	28.6
60-6000-DIN-24-04	1-1/2-11	33.3	1/4-19	4.7
60-6000-DIN-24-06	1-1/2-11	33.3	3/8-19	7.9
60-6000-DIN-24-08	1-1/2-11	33.3	1/2-14	11.1
60-6000-DIN-24-10	1-1/2-11		5/8-14	
60-6000-DIN-24-12	1-1/2-11	33.3	3/4-14	16.7
60-6000-DIN-24-16	1-1/2-11	33.3	1-11	22.2

Continued...

Item	THREAD SIZE B1	THREAD DRILL B1 (MM)	THREAD SIZE B2	THREAD DRILL B2 (MM)
60-6000-DIN-24-20	1-1/2-11	33.3	1-1/4-11	28.6
60-6000-DIN-24-24	1-1/2-11	33.3	1-1/2-11	33.3
60-6000-DIN-32-04	2-11	46.0	1/4-19	4.7
60-6000-DIN-32-06	2-11	46.0	3/8-19	7.9
60-6000-DIN-32-08	2-11	46.0	1/2-14	11.1
60-6000-DIN-32-10	2-11		5/8-14	
60-6000-DIN-32-12	2-11	46.0	3/4-14	16.7
60-6000-DIN-32-16	2-11	46.0	1-11	22.2
60-6000-DIN-32-20	2-11	46.0	1-1/4-11	28.6
60-6000-DIN-32-24	2-11	46.0	1-1/2-11	33.3
60-6000-DIN-32-32	2-11	46.0	2-11	46.0
60-6000-DIN-40-24	2-1/2-11	54.0	1-1/2-11	33.3
60-6000-DIN-40-32	2-1/2-11	54	2-11	46