

ULTRASHRINK™ 3012

AUTOMATIC HOT WATER SHOWER SHRINK TUNNEL

Our UltraShrink 3012 Inline Shrink Tunnel Features:

- All stainless steel construction
- Easy sanitation, removable transport conveyor
- Emergency stop switches
- Electric or steam heating
- Automatic water level control
- Digital water temperature control
- Easy access drainage spout
- Conforms to UL 963 and CSA 22.2 Standards
- Electrical enclosure ventilation kit P/N 922185 (standard on #922151-001) must be used on any unit that will be used in a room with an ambient temperature above 50°F

Available with Steam or Electric Heating

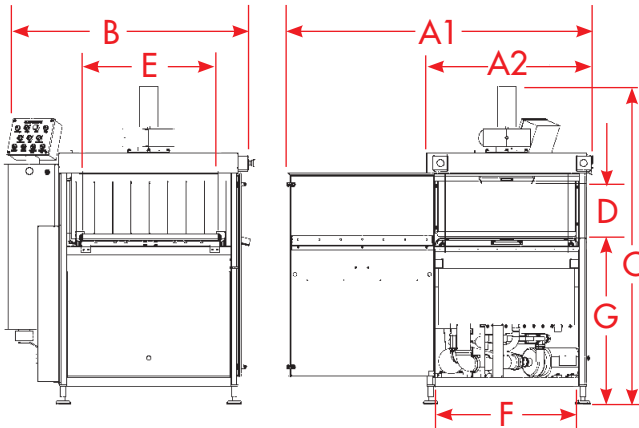

UltraSource LLC
1414 West 29th Street
Kansas City, MO 64108-3604 USA

800.777.5624

Office: 816.753.2150
Fax: 816.753.4976
info@UltraSourceUSA.com
UltraSourceUSA.com



UltraSource®

THE NEW STANDARD FOR INNOVATION

© Copyright 2018 UltraSource LLC

PRODUCT SPECIFICATIONS

A1. Width (door open)	64.5-in. (1,664mm)
A2. Width (door closed)	34.9-in. (887mm)
B. Length	52.26-in. (1,328mm)
C. Maximum Height	70-in. (1,778mm)
D. Maximum Product Height	12-in. (305mm)
E. Conveyor Width	30-in. (762mm)
F. Conveyor Length	31.14-in. (790mm)
G. Conveyor Height	36-in. (914mm)
Product Opening	28.75-in. W x 14-in. H (730 x 356mm)
Maximum Belt Speed	37 feet per minute
Net Weight	980-lbs. (445kg)
Electrical (3-phase)	208, 240, 380, 480, 575 volt