

# Programación

## 1 Menú sistema

Es necesario pasar por LOGIN (⌘ prolongado y código. 1-2-3-4 por defecto)

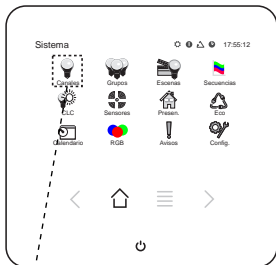

Canales

## 2 Menú Canales

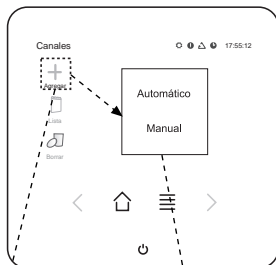

Dar de alta canal BOTONERA

Búsqueda automática (no es posible direccionamiento manual)

## 3 General botonera

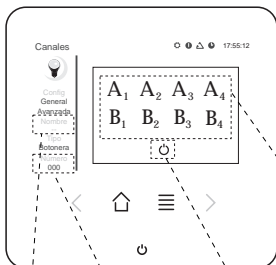

Nombre

Nº dirección DMX  
Asignado automáticamente

Apagado total

## 4 Edición botonera

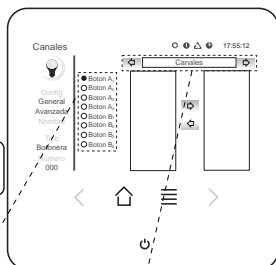

Acciones programadas a realizar

Botones asignables

Permite seleccionar  
- Canales  
- Grupos  
- Escenas  
- Secuencias

Es necesario crearlos previamente.

Puede obtener más información y descargar el manual ampliado en: [www.simon.es/scena](http://www.simon.es/scena)

Scena  
simon

SIMON, S.A. Diputación, 390-392 / 08013 Barcelona  
Servicio de asesoramiento Técnico - Technical advise service: Tel:902109700 E-mail: [sal@simon.es](mailto:sal@simon.es) <http://www.simon.es>

## Touch Lightkeypad

8900015...r

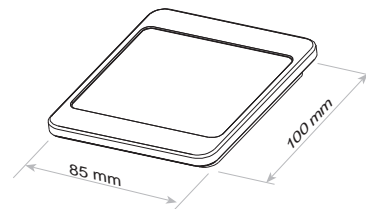

## ESPECIFICACIONES

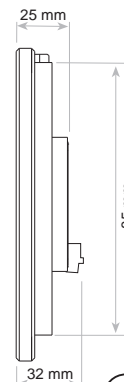
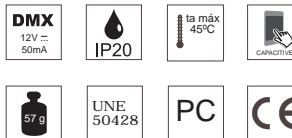

## ACABADO

**IMPORTANTE**  
Para su uso es necesario  
Touch LightManager

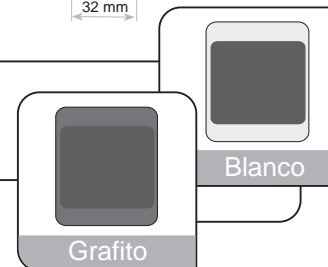

1

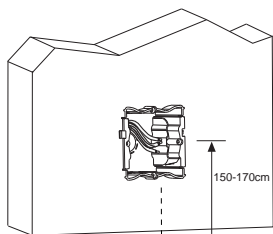

Caja de empotrar universal  
Ref.3171061

2

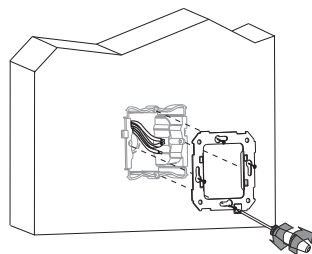

3

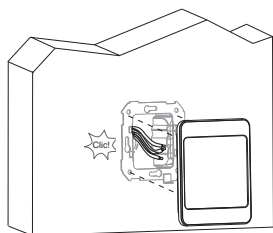

4

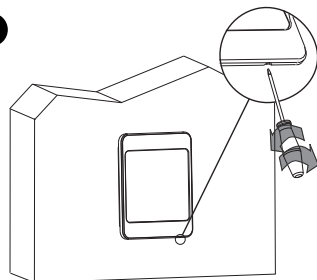

## Modelos

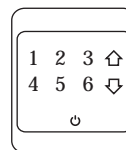

Ref 89000150-...

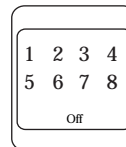

Ref 89000151-...

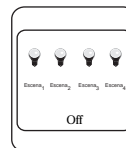

Ref 89000152-...

## ¡Advertencias!

- Desconecte la tensión antes de comenzar la instalación.
- Para el bus DMX, se recomienda preferentemente usar Cable multifilar AWG 24 de 2 pares trenzados con impedancia de 120  $\Omega$  y apantallado.
- Se debe utilizar una resistencia final de línea de 120  $\Omega$  en el elemento final del bus DMX.
- Distancia máxima de los cables de las entradas auxiliares 100 m.
- Tabla de distancia máxima con módulos alimentados desde TouchLightManager:

Nº de módulos	Distancia (m)
1	550
5	115
10	55
16	33

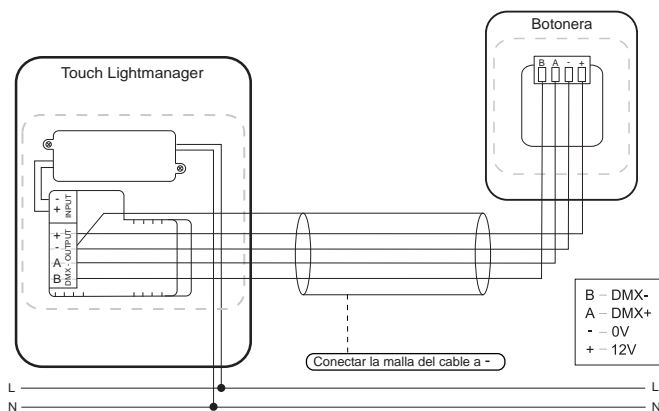

# Programming

## 1 System Menu

It is necessary to perform LOGIN  
(Ⓞ prolonged press and code. 1-2-3-4 by default)

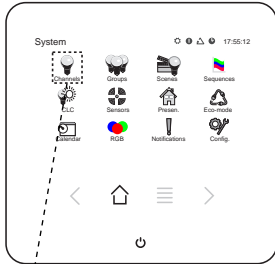

Canales

## 2 Channel menu

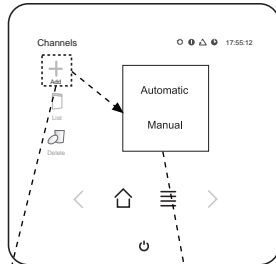

Register the KEYPAD channel

Automatic Search (manual addressing is not possible)

## 3 General Keypad

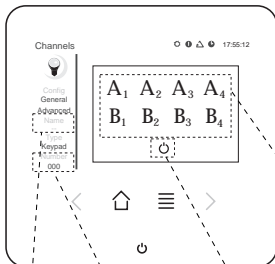

Name

DMX Address  
Nº automatically assigned

Total Shut-off

Programmed actions to be performed

Assignable buttons

## 4 Keypad edition

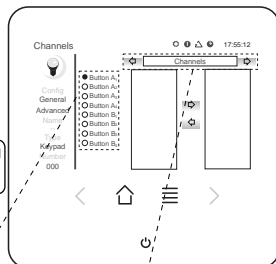

Permits Selection of  
- Channels  
- Groups  
- Scenes  
- Sequences

It is necessary to previously create them.

You may obtain additional information and download the complete manual in: [www.simon.es/scena](http://www.simon.es/scena)

## Touch Lightkeypad

8900015...r..

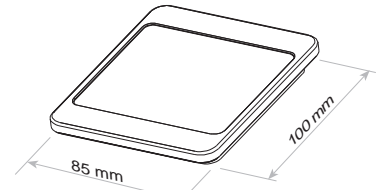

### SPECIFICATIONS

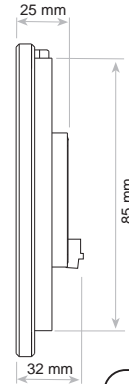
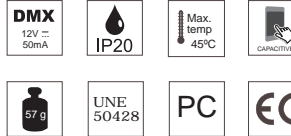

### FINISH

**IMPORTANT**  
Its use requires  
Touch LightManager

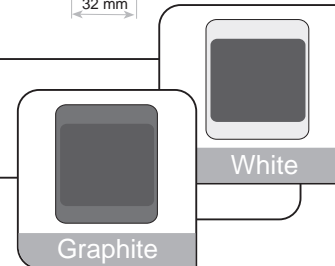

1

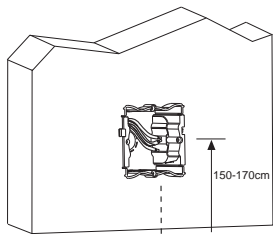

universal embedding box  
Ref.3171061

2

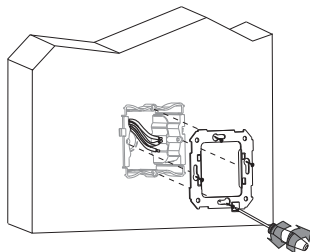

3

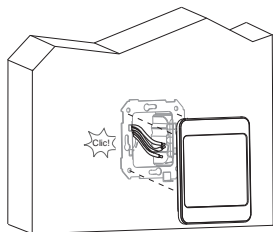

4

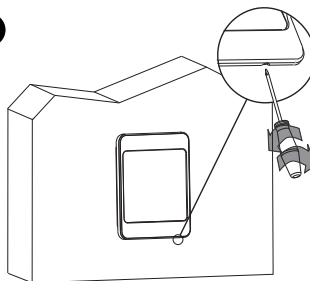

## Models

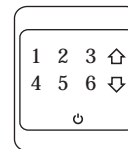

Ref 89000150-...

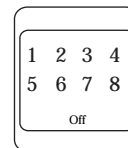

Ref 89000151-...

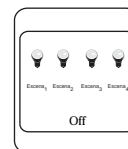

Ref 89000152-...

## Warnings!

- Disconnect the voltage prior to starting the installation.
- For the DMX bus, it is recommended preferable use of Multi-wire cable AWG 24 with 2 braided pairs with impedance of  $120\Omega$  and screened.
- A final line resistance of  $120\Omega$  must be used in the final DMX bus element.
- Maximum distance of the cables of the auxiliary inputs: 100 m.
- Maximum Distance Table with the modules with power supply from TouchLightManager:

Nº of modules	Distance (m)
1	550
5	115
10	55
16	33

