

Disposable Fold Flat Respirator – FFP2V, FFP2, FFP3V, FFP3

The 4500 Series is the newest addition to Skytec's range of premium respirators. Featuring premium UK Made filter media across valved and unvalved variants, the 4500 Series range provides low breathing resistance and excellent fit factor.

Features

- Premium disposable fold flat respirator for easy storage, donning and doffing
- Secure, metal free harness system with colour coded textile elastic for easy identification of FFP level
- Soft, flexible and adjustable nose bridge for increased fit factor and comfort
- Multilayer electrostatic filter media for high performing filtration with low breathing resistance
- Full width internal faceseal, made from soft touch PVC for high comfort
- Ergonomic design for a secure fit on a wide range of face shapes
- High flow exhalation valve for low breathing resistance, colour coded for easy identification of FFP level
- Contoured nose seal for high compatibility with other types of PPE
- Unvalved variant compliant to EN 14683:2019 for use in healthcare
- Latex free and low-linting for use in a wide range of environments
- UK designed, developed and manufactured.



UK
CA

CE

MD
Medical Device

Single use

LATEX

MANUFACTURED
IN THE UK

*Unvalved variants only



Certifications

- MDD (UK) 93/42/EEC & 2007/47/EC*
- MDR (EU) 2017/745*
- CLASS 1*
- EN 14683:2019*
- EN 149:2001+A1:2009
- FFP2NR & FFP3NR
- CAT III
- *unvalved variants only

Fitting Instructions

Donning and doffing guide

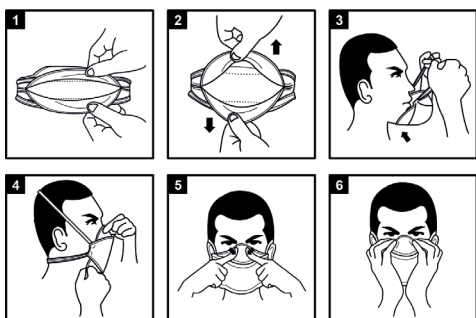

NOTE: Change respirator immediately if breathing becomes difficult or respirator becomes damaged or distorted, or a proper face fit can not be maintained. Respiratory protection is only effective if it is correctly selected, fitted, and worn throughout the time when the wearer is exposed to hazards.

Suitable Applications

- Hospital
- Laboratory and Disease Control
- Pharmaceutical Industry
- Iron and Steel Industry
- Welding work
- Woodworking
- Underground Civil Engineering
- Mining
- Manufacture of Batteries (Ni-Cad)
- Disposal of Toxic Waste
- Cutting and Casting of Metals
- Craft Work

Ordering Information

Part Number(s): 4530V/4530/4520V/4520

Packaging: Valved – 10 singles per box/12 boxes per case
Unvalved – 20 singles per box/12 boxes per case

Technical Information

Materials

Component	Material
Outer Cover:	Polypropylene
Inner Cover:	Polypropylene
Filter Media:	Meltblown
Nosefoam:	PVC Foam
Headstrap:	Woven Elastic (Latex-Free Rubber)
Valve:	Polypropylene

Dimensions

Item	Length (MM)	Width (MM)	Height (MM)
Respirator:	210	85	20

User Instructions

Use only in accordance with these instructions, as incorrect use could result in danger to life or health. Fit according to instructions BEFORE entering the contaminated area.

Discard safely after use or replace with a new respirator if:

- Excessive clogging of the respirator causes breathing difficulty or discomfort
- If the respirator becomes damaged
- The respirator has been worn for 8 hours.

Do not use in oxygen deficient, (less than 19%), explosive atmospheres or confined spaces where gases or aerosols may accumulate and the concentration of contaminant is immediately dangerous to life or health, (over the IDLH value).

Leave the contaminated area if:

- The respirator is damaged
- You become dizzy or have difficulty breathing
- You become irritated or other distress occurs
- You become uncertain of the nature and/or concentration of contaminant.

WARNING:

- As facial hair reduces the protection offered it is recommended that these respirators are used by clean shaven personnel only
- Do not use for protection against gases
- Single shift use only
- Do not remove whilst in contaminated area.

Compliance Statement EU (CE)/UK (UKCA)

Economic Operator [EU]: Globus EMEA Ltd., 51 Dawson Street, Dublin, D02 AN25, Ireland.

Product conforms to the requirement of: UK Regulation 2016/425 on PPE, brought into UK Law and amended & Regulation (EU) 2016/425 of the European Parliament and of the Council as Personal Protective Equipment (PPE).

Type-Examination, (Module B), Certificates issued by:

UK – CCQS UK Limited, 25 Wilton Rd, Pimlico, London, SW1V 1LW, United Kingdom. [A.B. No. 1105].

EU – CCQS Certification Services Ltd., Block 1 Blanchardstown Corporate Park, Ballycoolin Road, Blanchardstown, Dublin D155 AKK1, Ireland. [N.B. No. 2834].

PPE is subject to the conformity assessment procedure, conformity to type based on Quality Assurances of the production process, (Module D), under the surveillance of the Approved/Notified Body(ies):

UK – SGS UK Ltd., Rossmore Business Park, Ellesmere Port, Cheshire, CH65 3EN, UK. [A.B. No. 0120].

EU – SGS Fimko Oy, Takomtie 8, FI-00380, Helsinki, Finland. [N.B. No. 0598].

Product Selector Guidance Chart

Product Code	Apf (Assigned Protection Factor) (X Wel)	Oil/Water Based Particulates	Non-Toxic Dusts	Fine Toxic Dusts/Mists/Fumes	Very Fine Toxic Dusts/Mists/Fumes	Metal Fume
FFP2	10	■	■	■		
FFP2V	10	■	■	■		
FFP3	20	■	○	○	■	■
FFP3V	20	■	○	○	■	■

■ = Recommended; ○ = Alternative; ▲ = Full inner face seal

CAUTION: This chart is for guidance only. Care should be taken when choosing the correct model to establish the type and concentration of hazard involved.

WEL = Workplace Exposure Limit A level of contamination (set by HSE) of the concentration of an airborne substance, above which level precautions must be taken if exposure takes place.

Alpha Solway is a leading manufacturer of above-the-neck personal protective equipment and protective clothing.

Our expertise, commitment and investment in product development has led to the introduction of many innovative products designed to keep people safe and comfortable in hazardous working environments.

ALPHA SOLWAY LTD

Factory 1, Queensberry Street, Annan, Dumfriesshire, Scotland. DG12 5BL. UK.
www.alphasolway.com | T: +44 (0) 1461 202452 | E: alphasolway.sales@globusgroup.com

SKY-DS-4500-SERIES-1123_1