

Installation and operation instruction

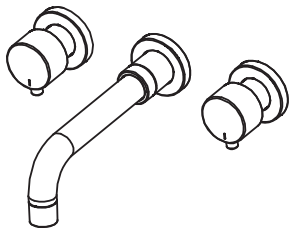

Guarantee & Aftercare

When installing or using tools, extra care must be taken to avoid damaging the finish or fitting. To maintain the appearance, please ensure it is cleaned regularly using a clean soft damp cloth only. Abrasive cleaners or detergents must not be used as they may cause surface deterioration. The company provides a guarantee against faulty material or manufacture excluding serviceable parts, providing they have been installed, cared for and used in accordance with our instructions.

INSTALLATION PROCEDURE

1. Prior to installation please ensure all the supply pipes have been through to remove any debris, avoid cartridge damage and blocking.
2. As Fig. 3 shows, Unscrew two No. 18 lock screw on left and right handle by hand, use No. 17 Allen Key to loose No. 16 M5 screw, take off No. 15 Handle and No. 5 Cartridge sleeve. Then screw out No. 13 Plastic plug, wind PTFE tape, screw back.
3. Per to Figure I, ① Valve Body connect to two inlet pipes in the wall (Notice cold and hot pipe connect to correct position and height. If the inlet pipe with male G3/4, wind PTFE tape or glue G1/2 thread on No. 2 exchange adaptor, then screw on No. 1 valve body, last, connect inlet pipe to No. 2 exchange adaptor.
4. Adjust height and position of Tap Body. Use electrical drill to punch hole on the wall, push in two No.3 Rawl plug, and then tighten screw two No. 4 Self-tapping screw, fix ① Valve Body on the wall (Notice level of Valve Body).
5. Open the inlet valve, to check if any leaks on Valve body.
6. Cover two 5 Plastic sleeves on tap.
7. Decorate wall (Notice height of Valve Body is 0-17mm).
8. Screw out No. 13 Plastic plug, loose No. 10 Round screw nut, take off No. 11 Adapter connector. Then wind PTFE on No. 11 G1/2 thread, use hexagon wrench tighten screw on ① Valve Body. Last push in No. 12 Flange and No. 9 Outlet pipe.
9. Pull two No.5 Plastic sleeves out, then push No. 8 Flange into No. 6 Cartridge sleeve.

● Figure I

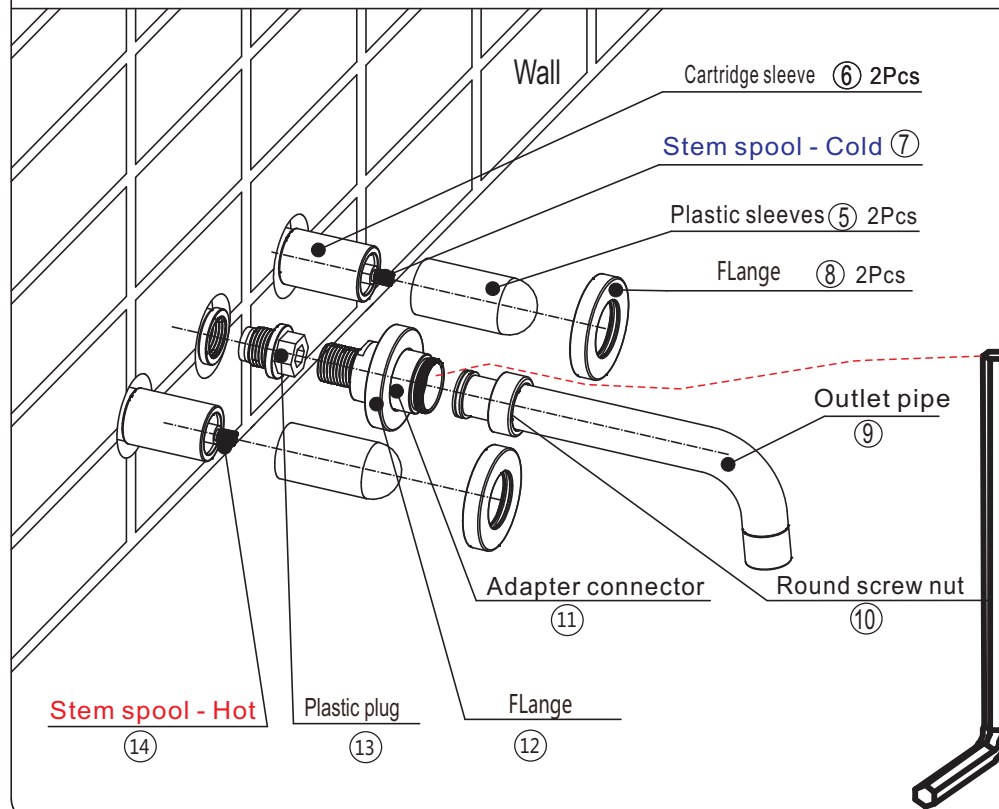
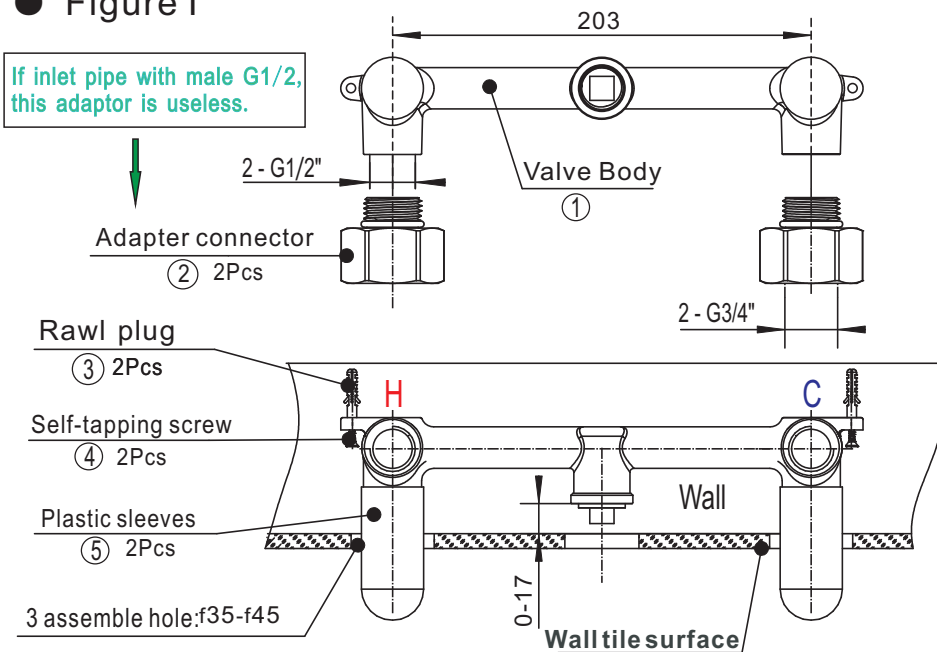

Installation and operation instruction

10. Per to Fig. 3, turn No. 7 clockwise to the end, and turn No. 14 anticlockwise to the end. (in this situation, cartridges are closed.) Put on cold and hot handle respective on No. 7 & No. 14, adjust direction, last use Allen key to tighten screw M5 screw.
11. After check no direction problem, screw on No. 18 handle spindle.
12. Connect cold and hot water, and check all water feed connections to ensure there are no leaks.

Use and maintenance Figure III

1. After using for a period of time, if the handle is found to be loose or shaking, the maintenance can be carried out according to the following methods:

1. 1. Screw off the handle spindle by hand, and then tighten the M5 screw with S 2.5 Allen Key.
1. 2. Turn the handle to check whether the handle still shakes. If not, install the handle spindle.

2. After a period of using, if the outlet water become smaller, turn out No. 21 spout, flush No. 19, 20, 21.

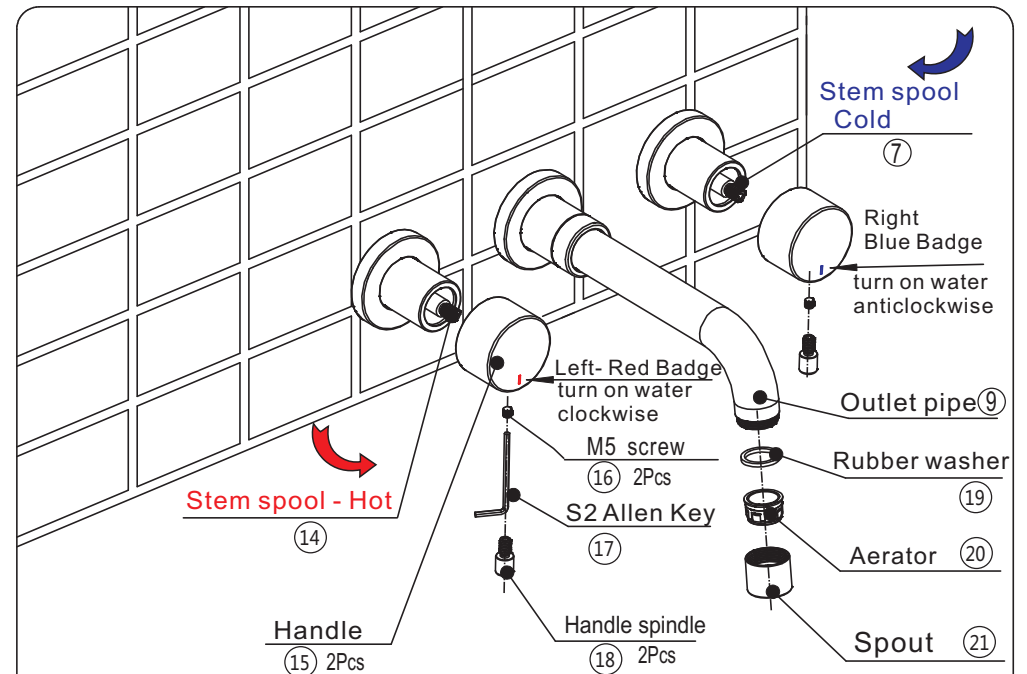

● Figure III

Below figure shows turn off

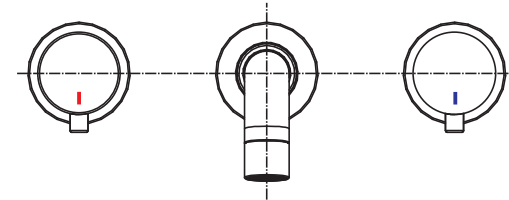

Below figure shows turn on

