

# INSTALLATION OF 2 IN 1 WC & BASIN

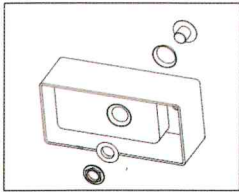

**Step 1:** Place and fix the waste and washer.

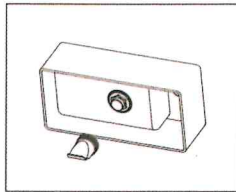

**Step 2:** Fit the Silicone sleeve on the bottom of the waste.

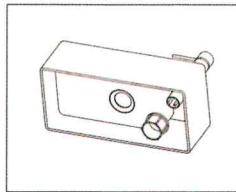

**Step 3:** Place the tap and tightly screw the fixing nut.

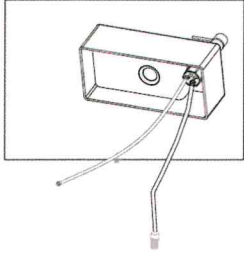

**Step 4:** Connect hot & cold water hose to the tap and connect the other end to outlet of the cistern.



## INSTALLATION OF WASH BASIN

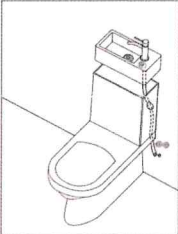

**Note:** During installation, please ensure there is enough distance between the float of the inlet valve and the hoses, make sure there is no resistance to the normal operation of the inlet valve.

# Metro



## Basin waste installation instruction



1, Fixed with one of flexi pipe

2, Fixed fix 2nd pipe with the film and lap at the bottom

3, Tigtlen the lap and back nut



4, Tigtlen the cover



5, Finished



1, Fixed the film first and put in the hole

2, Fixed another film at the bottom

3, Tighten the screw and finished