

INSTALLATION MANUAL

Eastbrook Code	Adjustment	Eastbrook Code	Adjustment
69.0025	870-900	69.0022	770-800
69.0024	770-800		

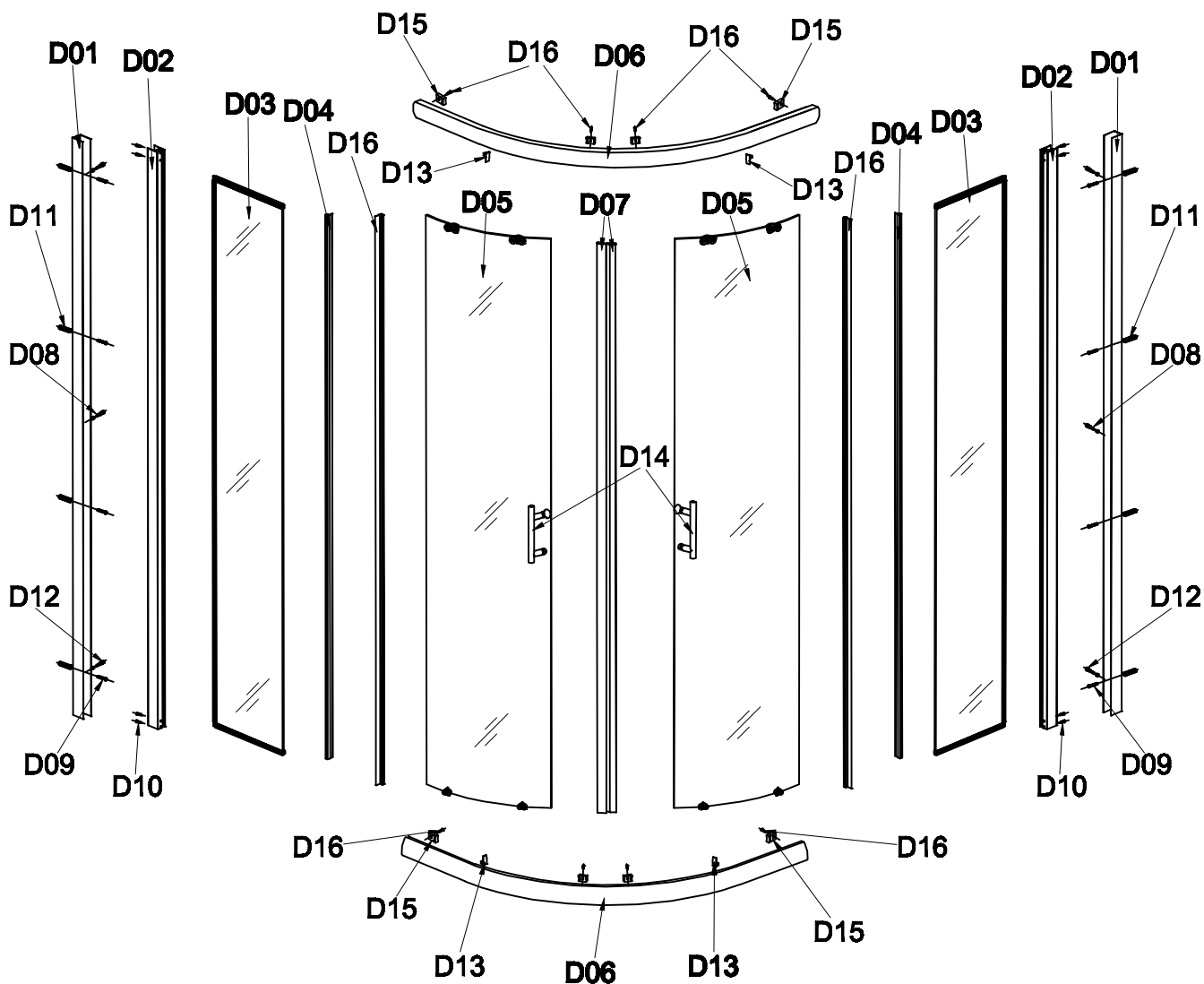



This product should only be fixed by a fully qualified installer

D08 10 ST4 6X	D09 30 ST4 8X	D10 30 ST4 8X	D11 8X	D12 6X
D13 4X	D14 2X	D15 8X	D16 16 ST4 8X	

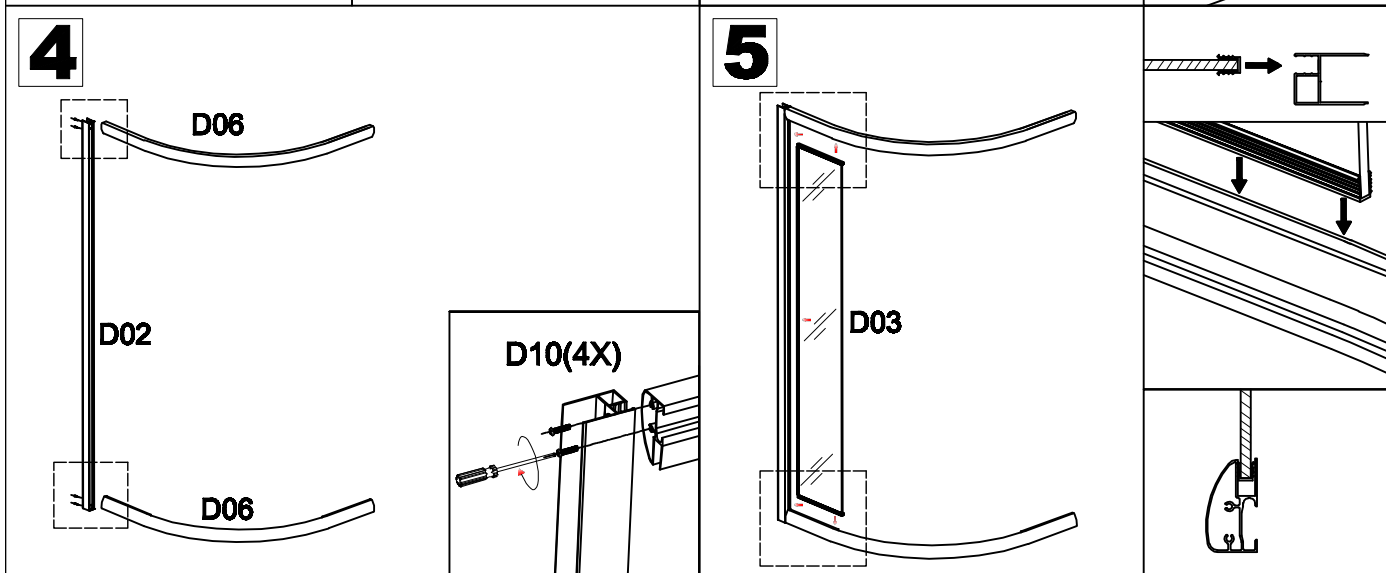
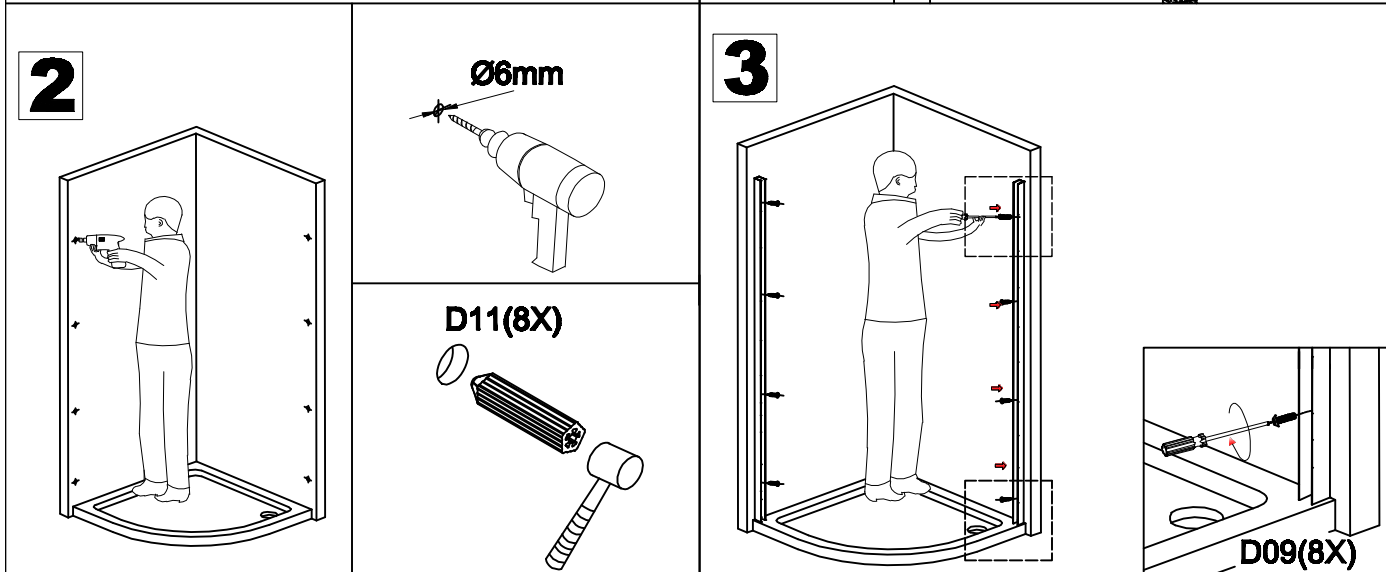
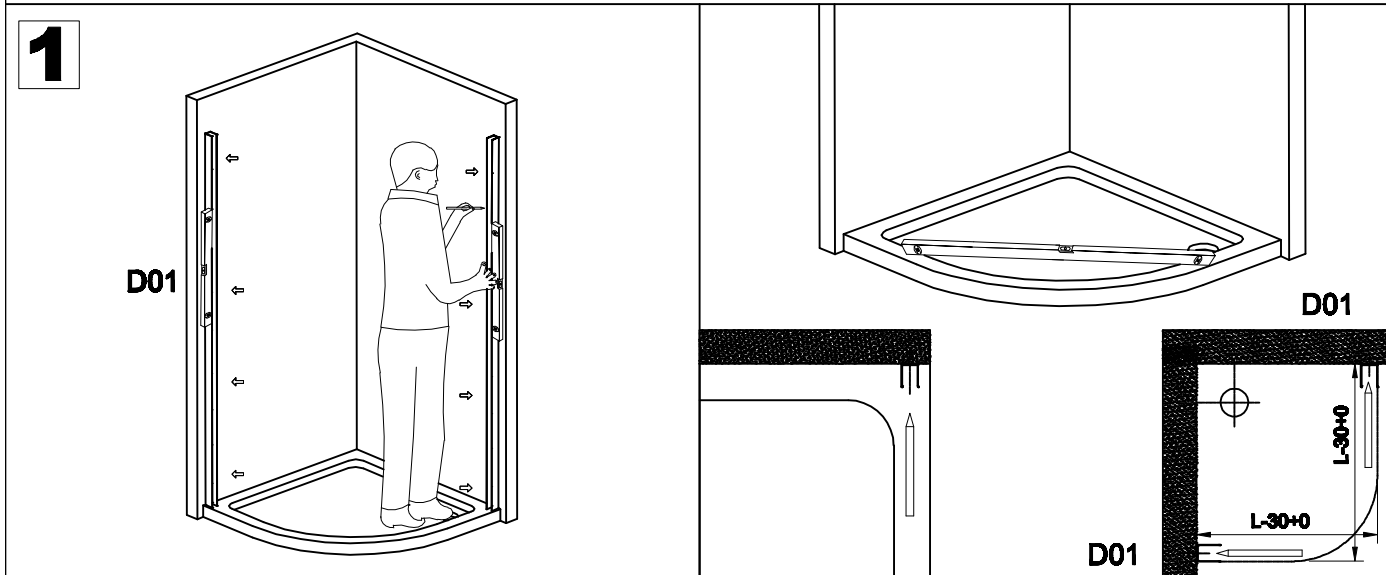
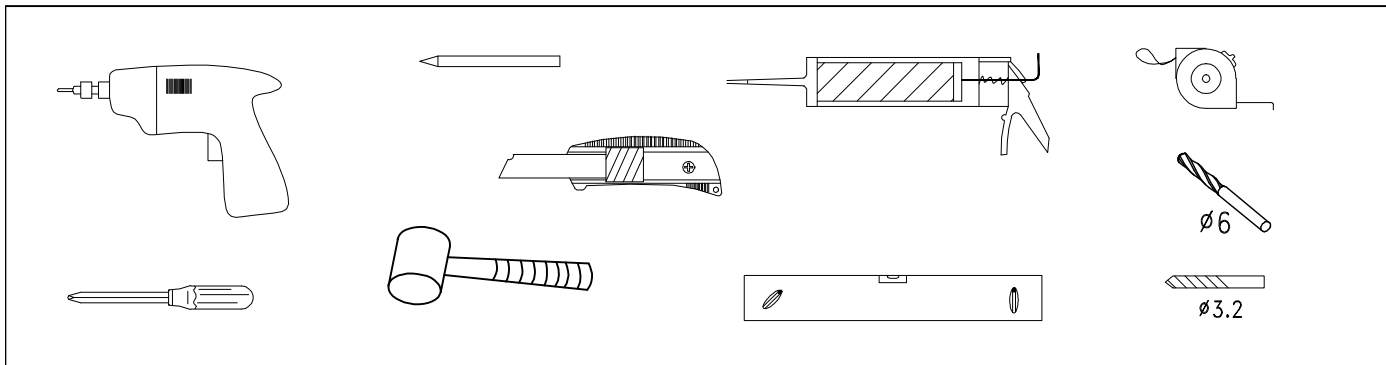

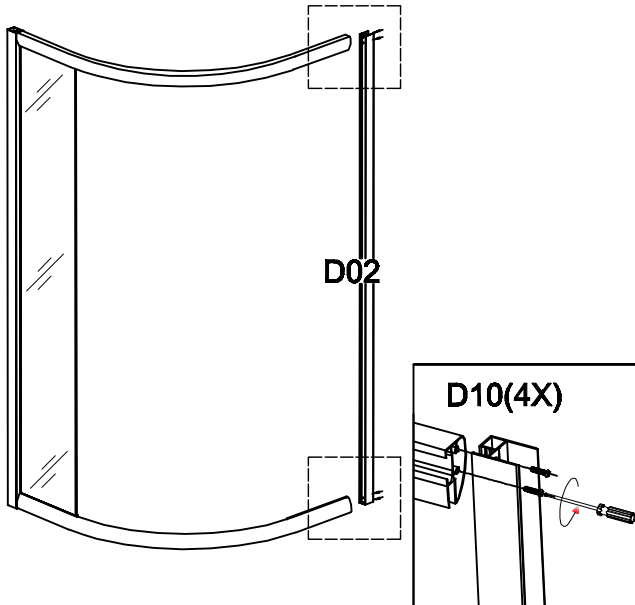
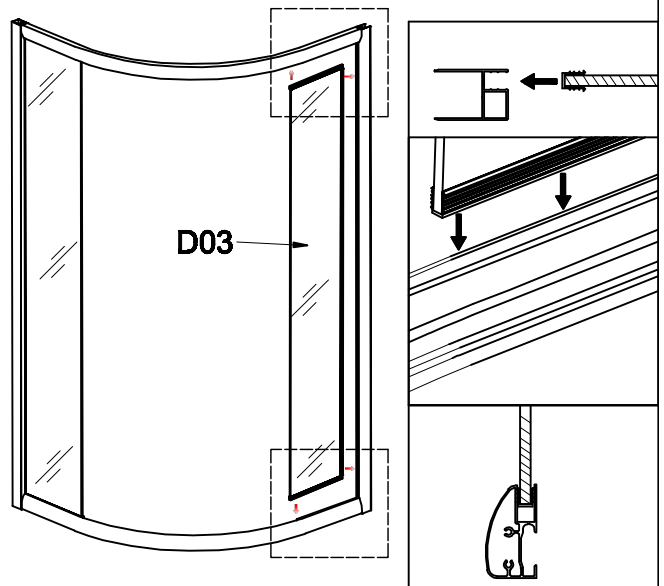
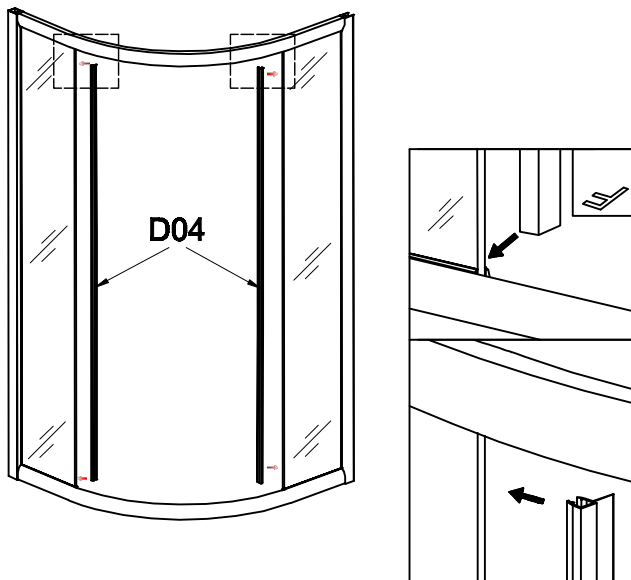
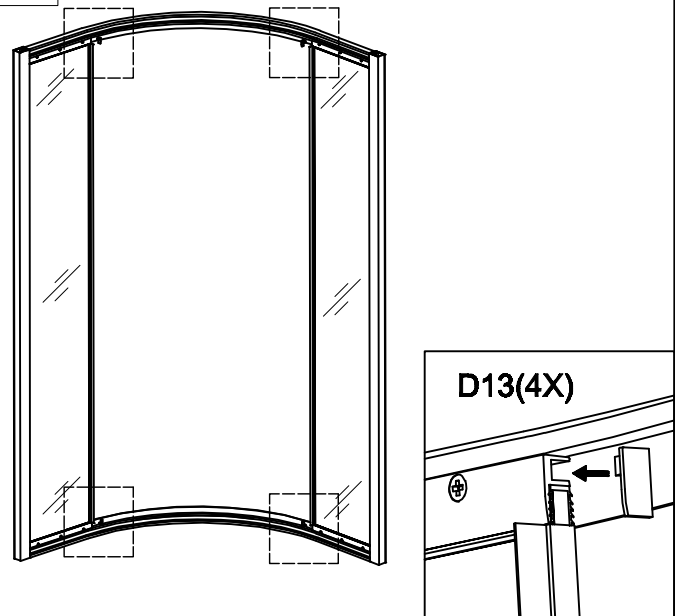
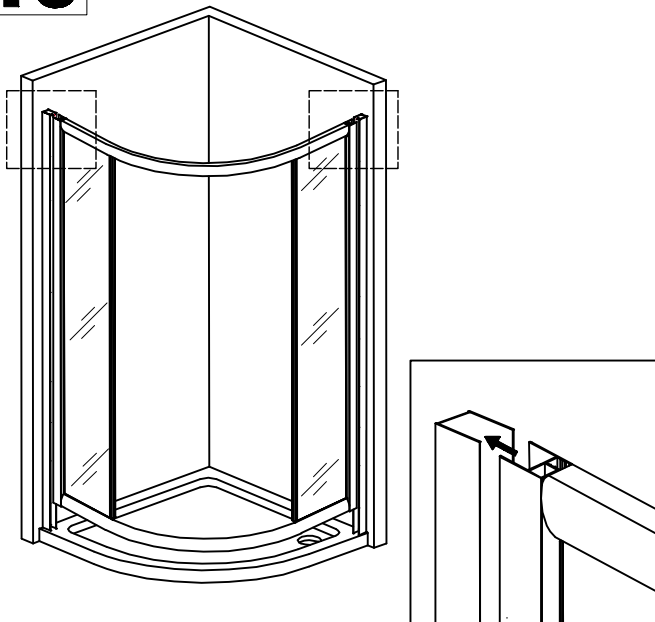
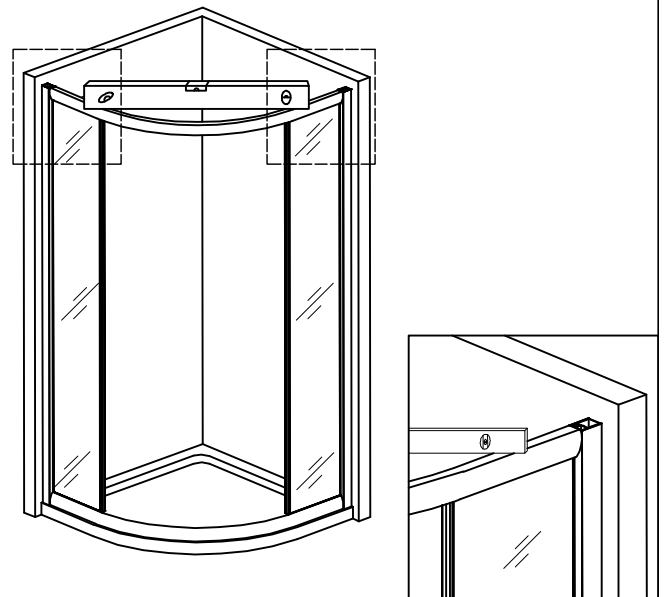
6**7****8****9****10****11**

12

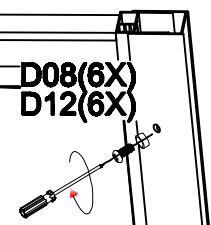
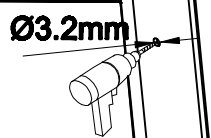
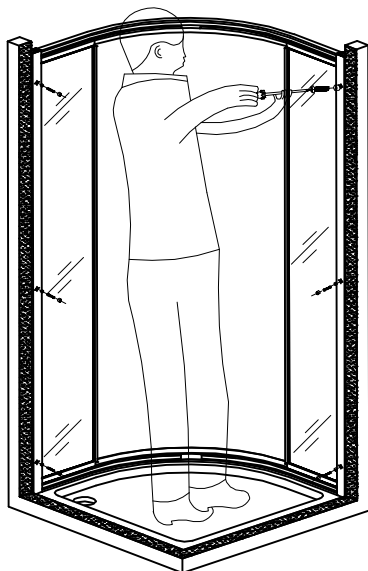

D12(6X)

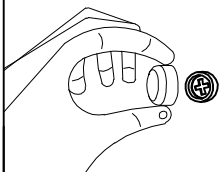

13

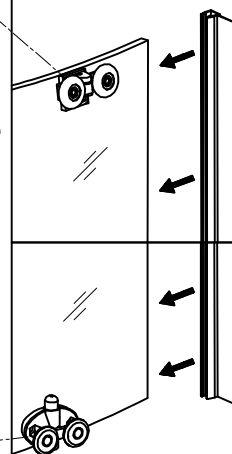
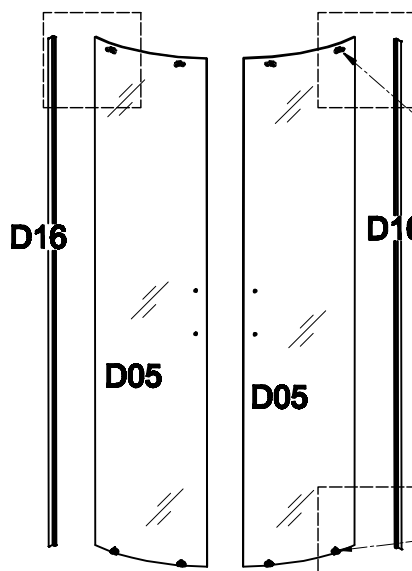

14

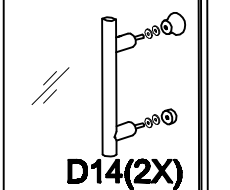
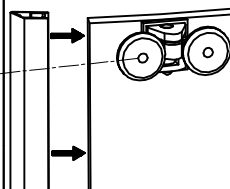
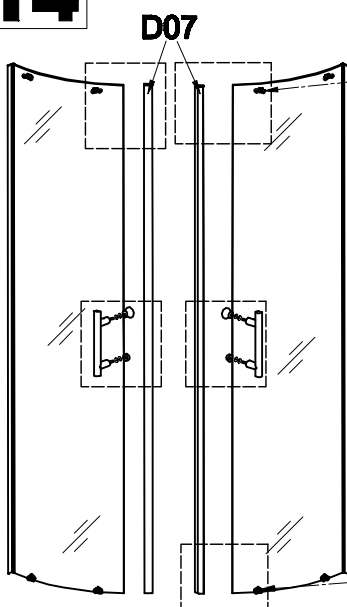

D14(2X)

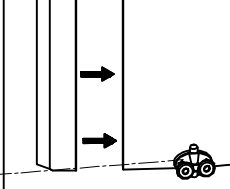

15

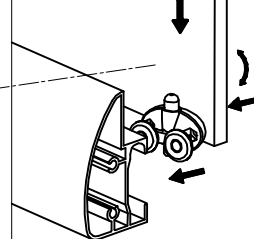
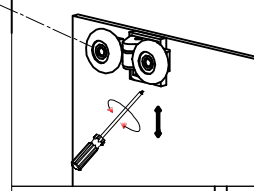
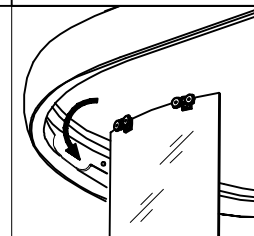
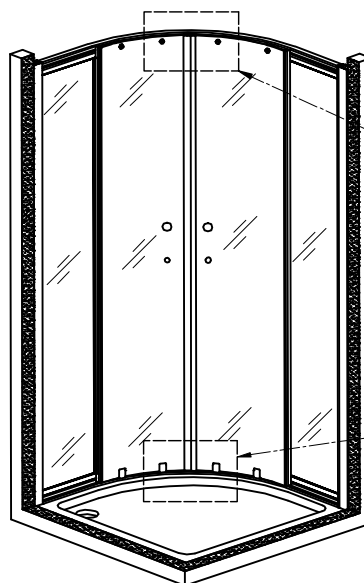

16

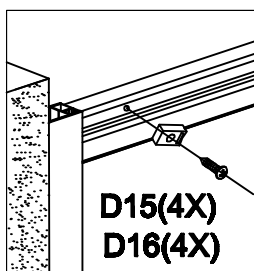
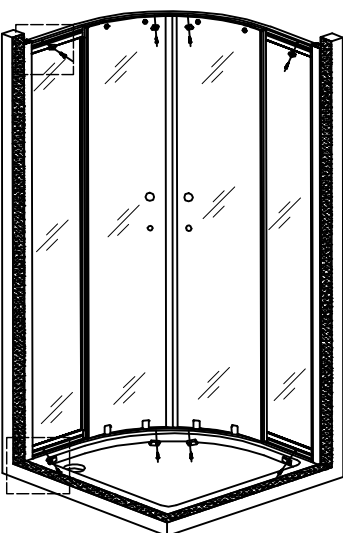

D15(4X)
D16(4X)

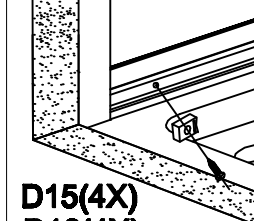

D15(4X)
D16(4X)

Silicone on the outside of the screen only

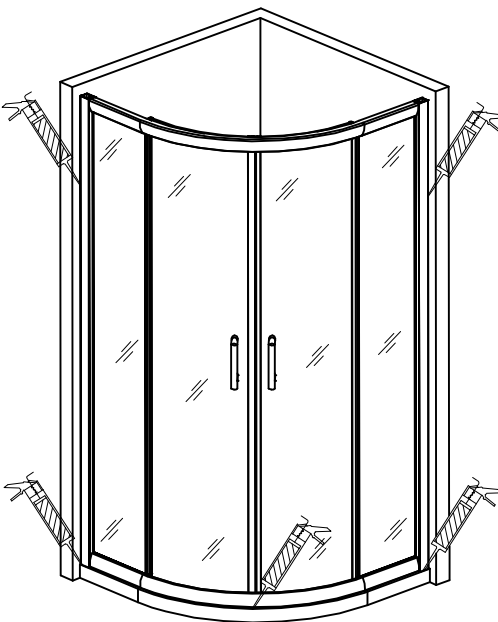

Cleaning & Maintenance

Don't clean the shower enclosure with irritant detergent such as alcohol,bleach or other chemical cleaners.

Only clean with warm soapy water.

After the installation is completed,should you find that there is notable noise when the glass door moves,you may add a small quantity of lubricant onto the roller wheel,slipping hook and the track.

Helpline: 01452 317890