

DATASHEET

Image



General Information

Product:	89:1568
Description:	Corinium Round 1200 x 500 Towel Rail
Website Link:	(Click Here)
Product Type:	Towel Rail
Brand:	Eastbrook Company
Colour:	Chrome
Material:	Mild Steel
Height (mm):	1200mm
Width (mm):	500mm
Net Weight (kg):	6.9kg
Product Range:	Corinium Round

Product Specifications

Warranty:	5 Year(s)
Supplied with fixings:	Yes
BTU $\Delta T50^{\circ}\text{C}$:	560
BTU $\Delta T60^{\circ}\text{C}$:	1071
Watts $\Delta T50^{\circ}\text{C}$:	314
Watts $\Delta T60^{\circ}\text{C}$:	396

Drawing

Corinium Round 1200 x 500mm.
Technical Drawing

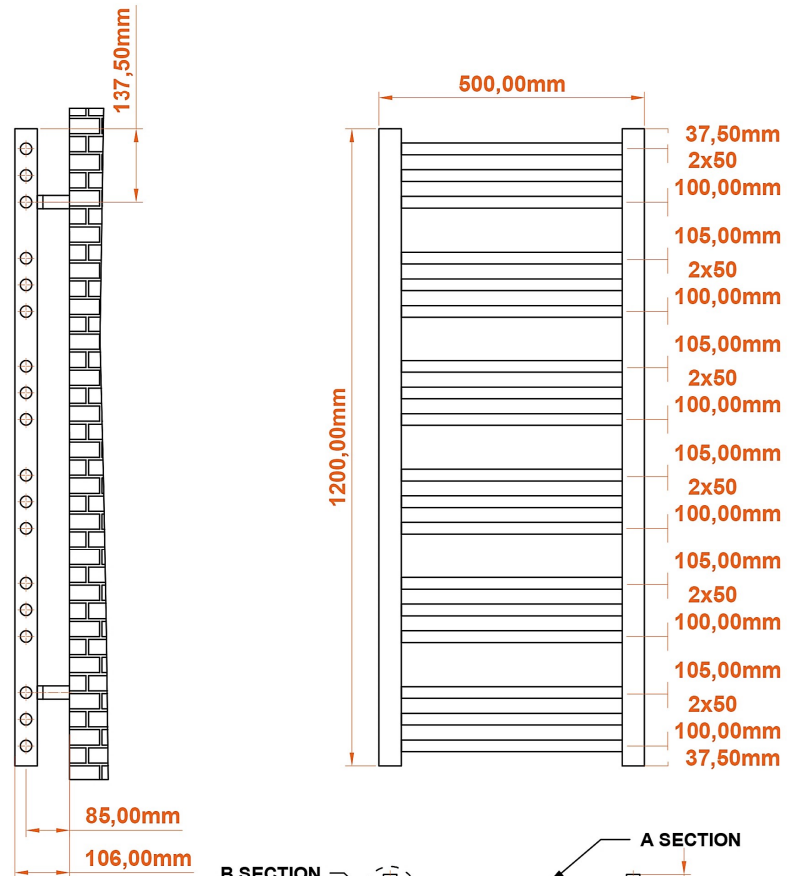

A SECTION

B SECTION

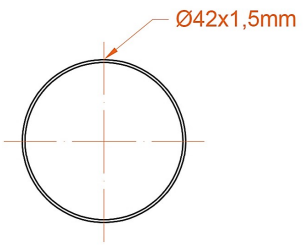
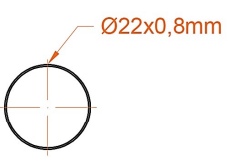

scale : 1/1

Eastbrook 
 Eastbrook Road, Gloucester GL4 3DB
 Technical Helpline : 01452 317890
 Mon - Fri / 8am - 5pm
 Email : technical@eastbrookco.com