

Critical Dimension Most important dimensions	Perspective drawing	Tolerance grade not noted	Basic size Tol Value	B				Note the Angle tolerance
				$0 < a \leq 6$	$6 < a \leq 30$	$30 < a \leq 120$	$120 < a$	
				± 0.1	± 0.3	± 0.5	± 1	$\pm 1^\circ$

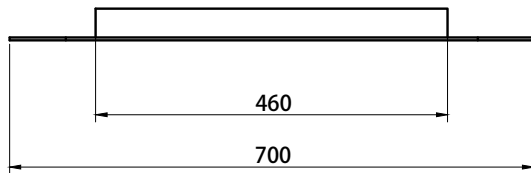
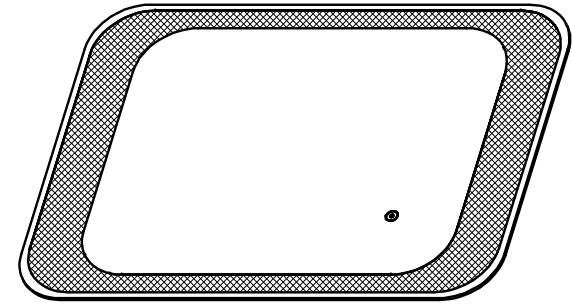
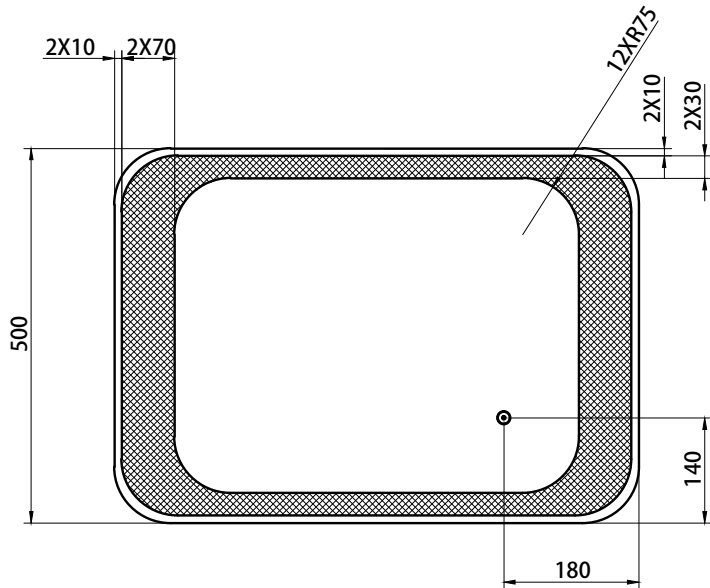

Technical requirements:

- 1、 Size: 700 * 500 * 45mm .
- 2、 4MM copper free silver mirror.
- 3、 Sensor touch control .
- 4、 LED 2835 lighting temperature of blue.
- 5、 Watt: 25W, Lumen specification : 1840 lumen.
- 6、 Input: 220~240V, output: DC12V.

					Trade name		Material	
					Drawing NO.		Page 1/A total of 1 page	
					Design		Auditor	
					Proofread		Ratify	
					Date			
Version	Quantity	ECN number	Modificator	Date	Theoretical weight[g]	Client Version		
					Theoretical volume[cm ³]	Version NO.		
					Theoretical area[cm ²]	Drawing Units	mm	
					Superficial area[cm ²]	Proportion		

Statement: This the graph is confidential, copyright owned by ORI, without the written permission of the company shall not use, copy, or show other people

Orient Resource Corporation Limited
 #8 of Xinling Road, Xiaolong village, Shiji Town, Panyu district, Guangzhou city, Guangdong Province, China.