

58. 706

INSTALLATION MANUAL

This product should only be fitted by a fully qualified installer.

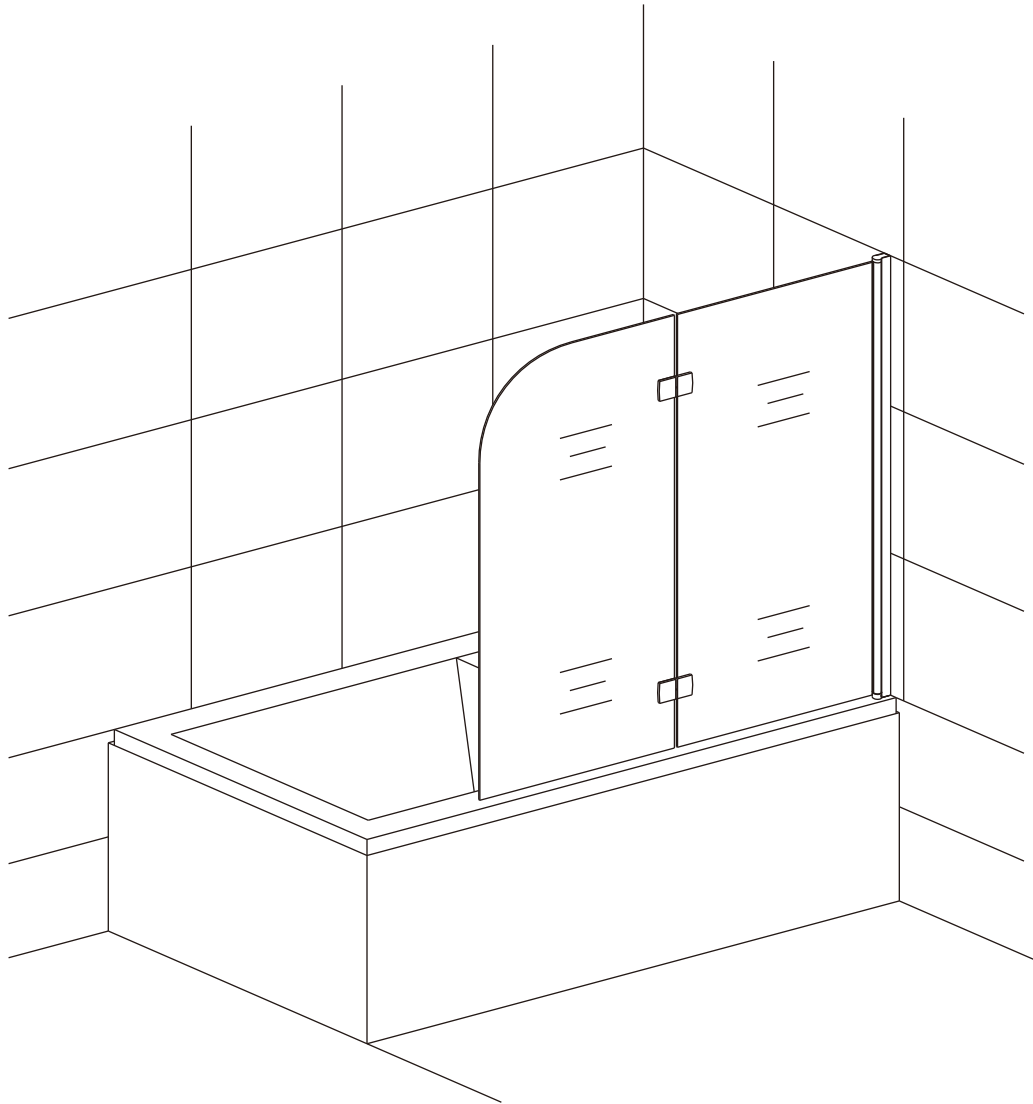

*This product must be unpacked and checked for quality prior to installation.
*Any missing parts or damage must be reported to your supplier within
10 days of purchase and before install.
No claims can be enforced outside of these terms



TOOLS REQUIRED



Pencil



($\varnothing 6, \varnothing 3, 2$) bit drill



Silicone gun

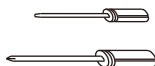

Flat and cross
screwdriver



Tap measure



Spirit level

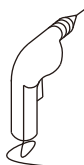

Electric drill

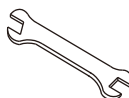

Spanner



Rubber hammer



Torque wrench

PACKING LIST

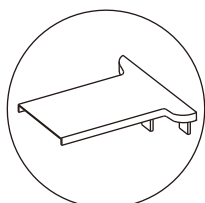

① x1

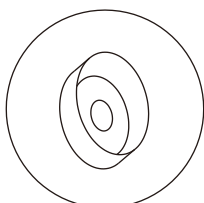

② x2

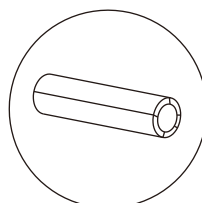

③ x3

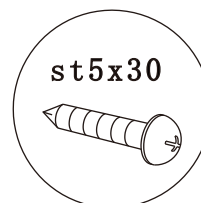

④ x3

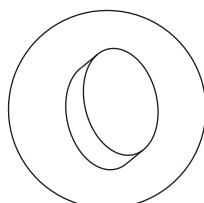

⑤ x2

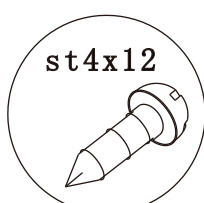

⑥ x2

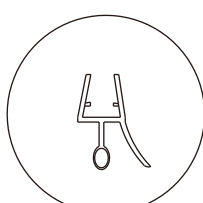

⑦ x2

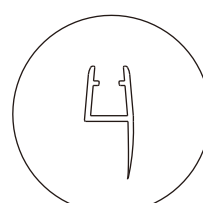

⑧ x1

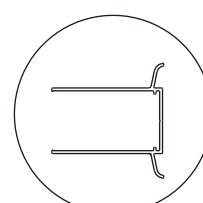

⑧ x1

Please make the following checks before connecting the installation:

*The product supplied is the required size and the adjustment is compatible with the site situation.

*Check all component parts are present, see packing list and product schematic diagram for reference.

*Make sure you have all the required tools.

PRODUCT SCHEMATIC DIAGRAM

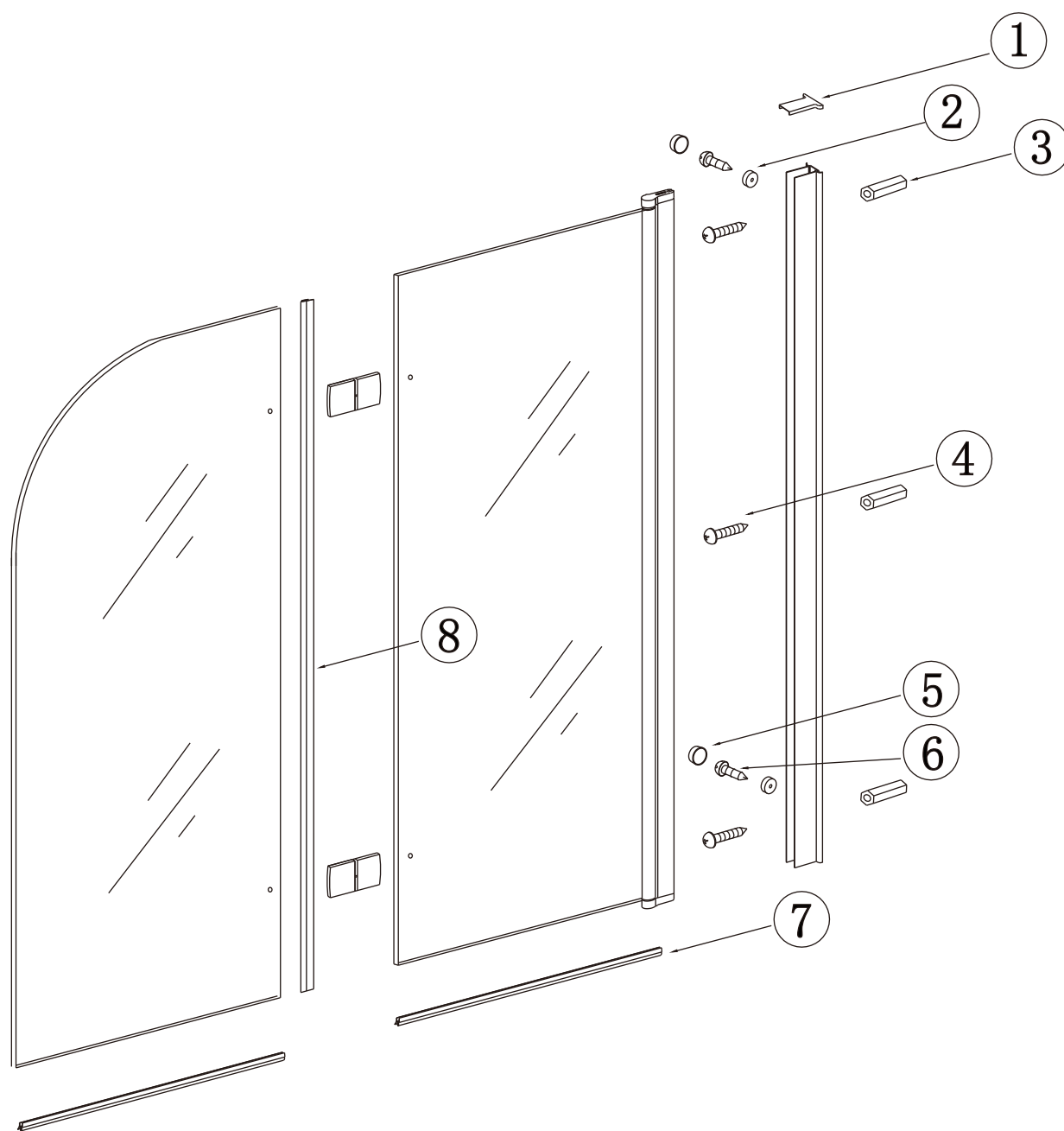

1

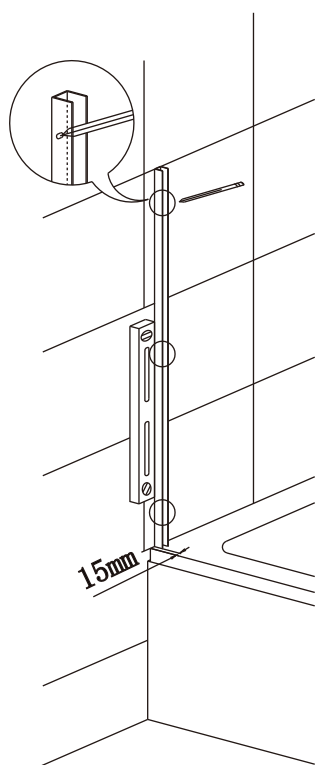

Dry fit required for best position to connect wall profile.

2

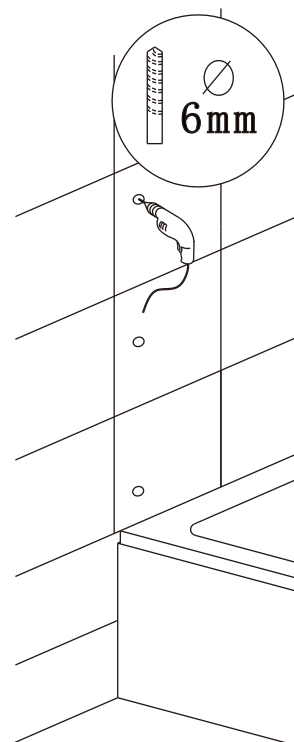

Drill holes in wall.

3

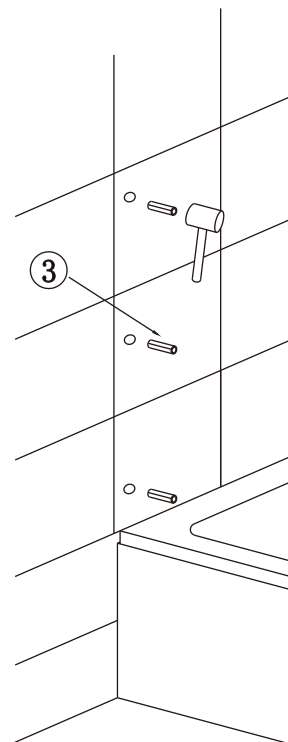

Fit wall profile plugs if a solid wall substitute for hollow wall fixings if necessary(not supplied).

4

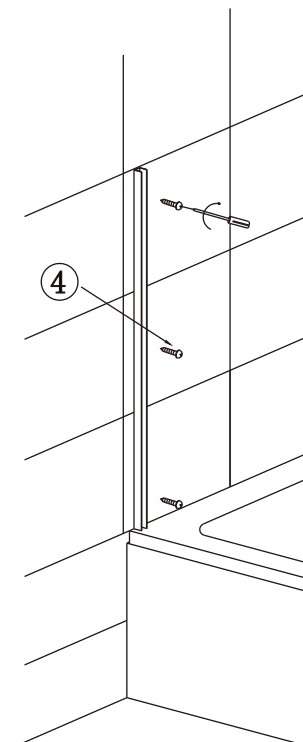

Fix wall profile with ST5*30 screws.

5

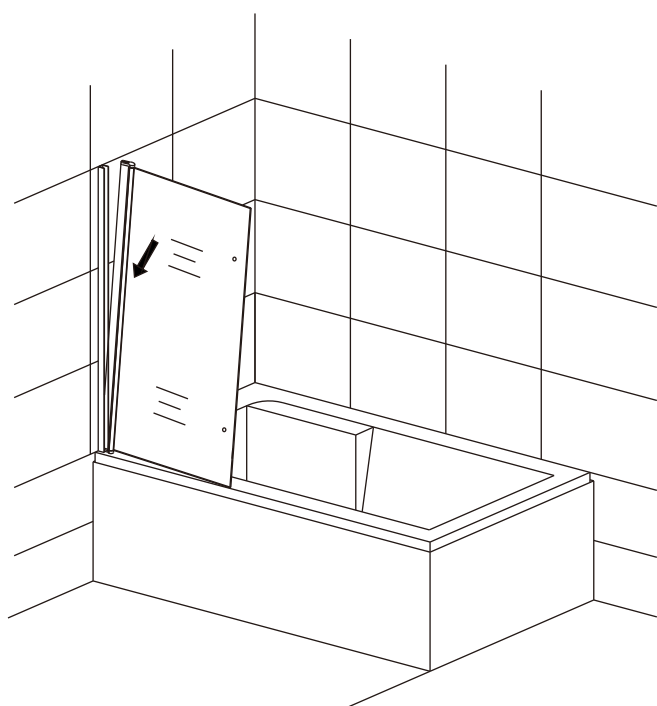

Fit first half of screen into wall profile.

6

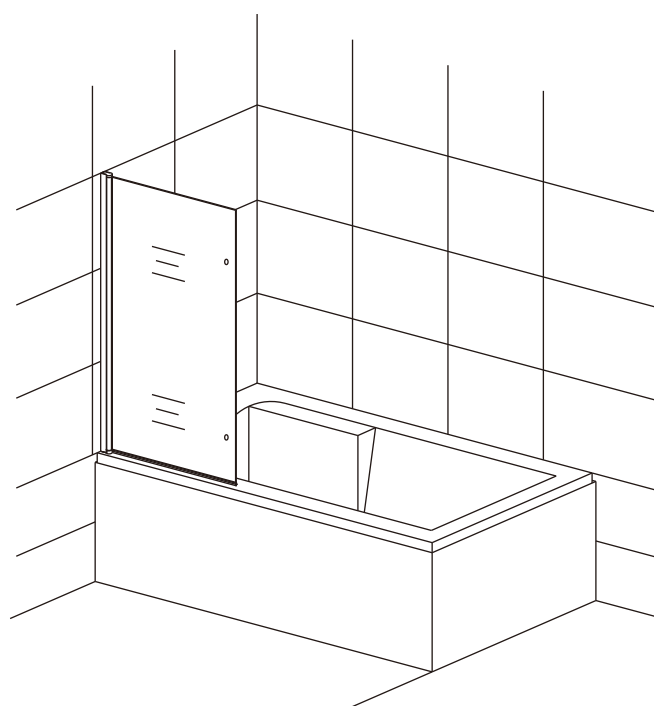

(1)

L

7

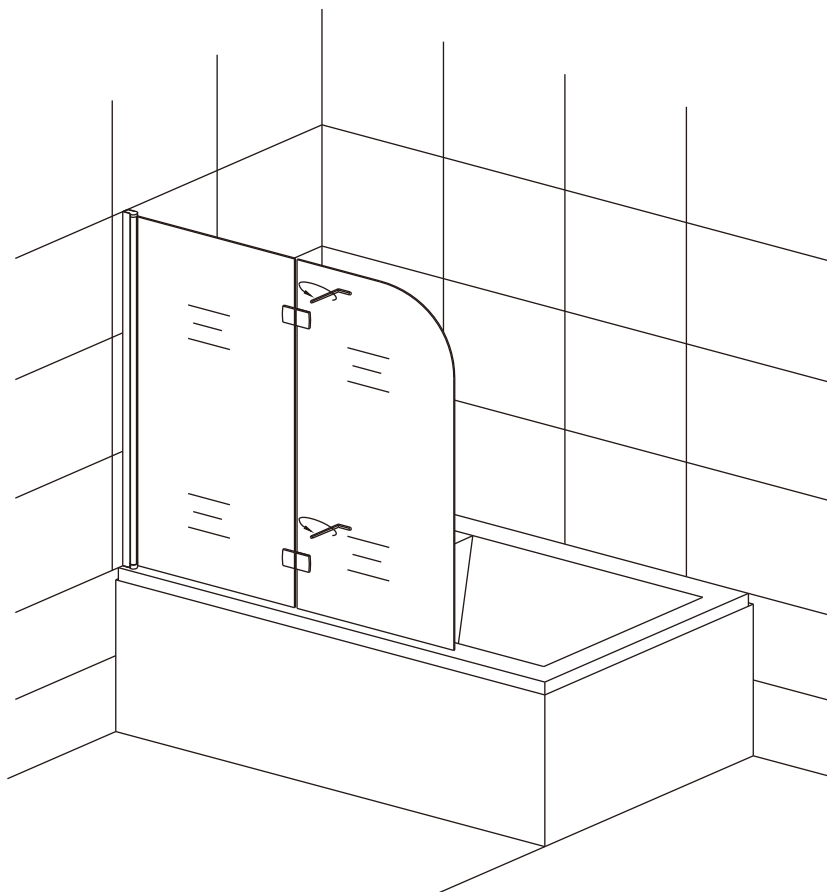

Attach second half of screen onto first with hinges supplied. Use torque wrench to tighten fixings on hinges to 14N•M.

8

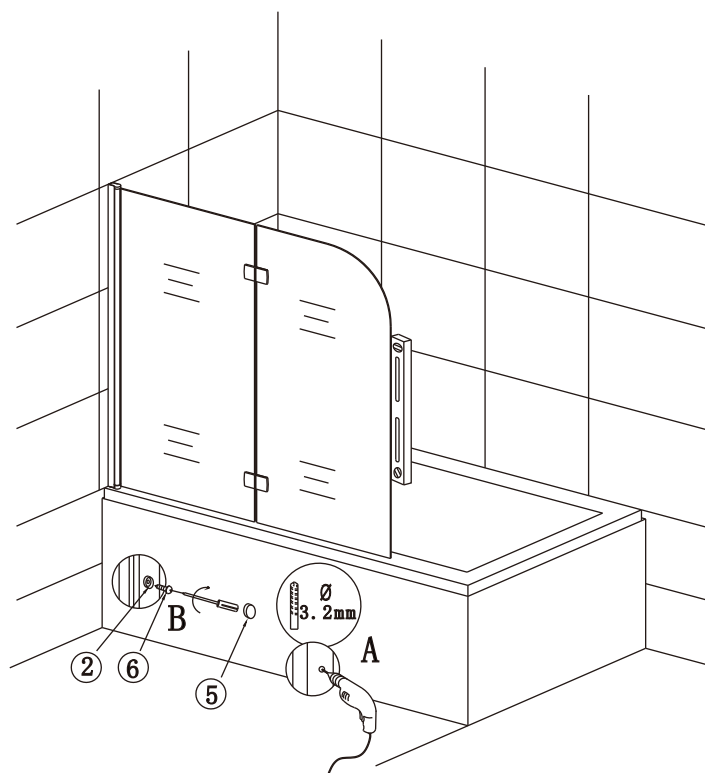

Level screen and fix first part into wall profile with ST4*12 screws with (5) and (2) chrome cover caps.

(2) L

9

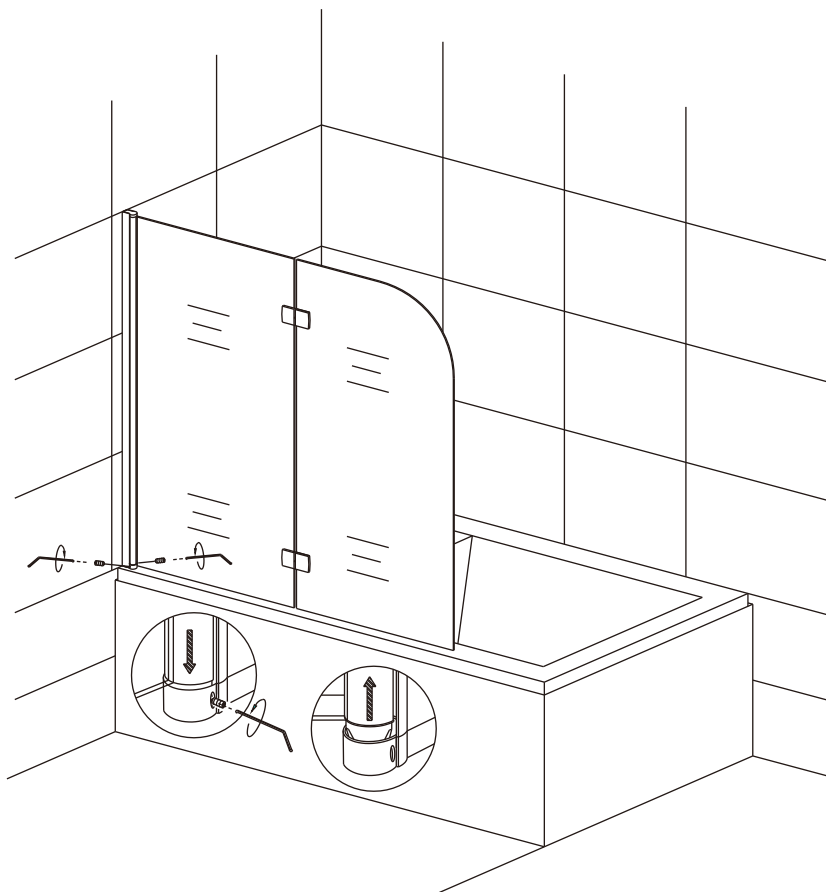

Check rise and fall hinge is operating correctly and adjust accordingly with grub screw provided.

10

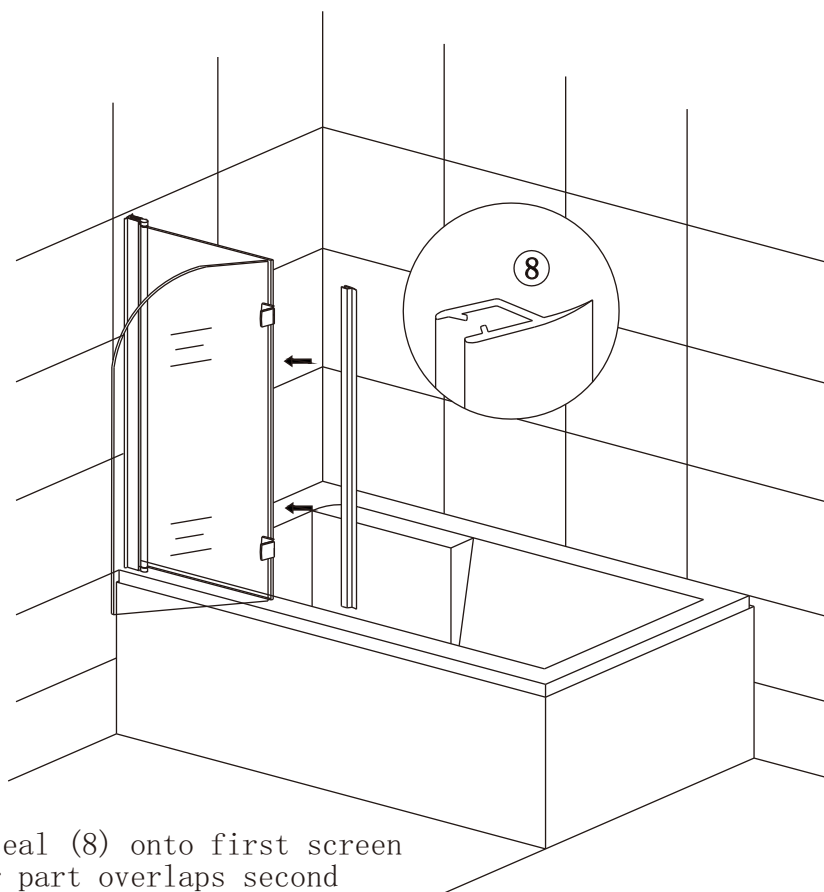

Fit vertical seal (8) onto first screen ensuring wiper part overlaps second screen.

(3) L

11

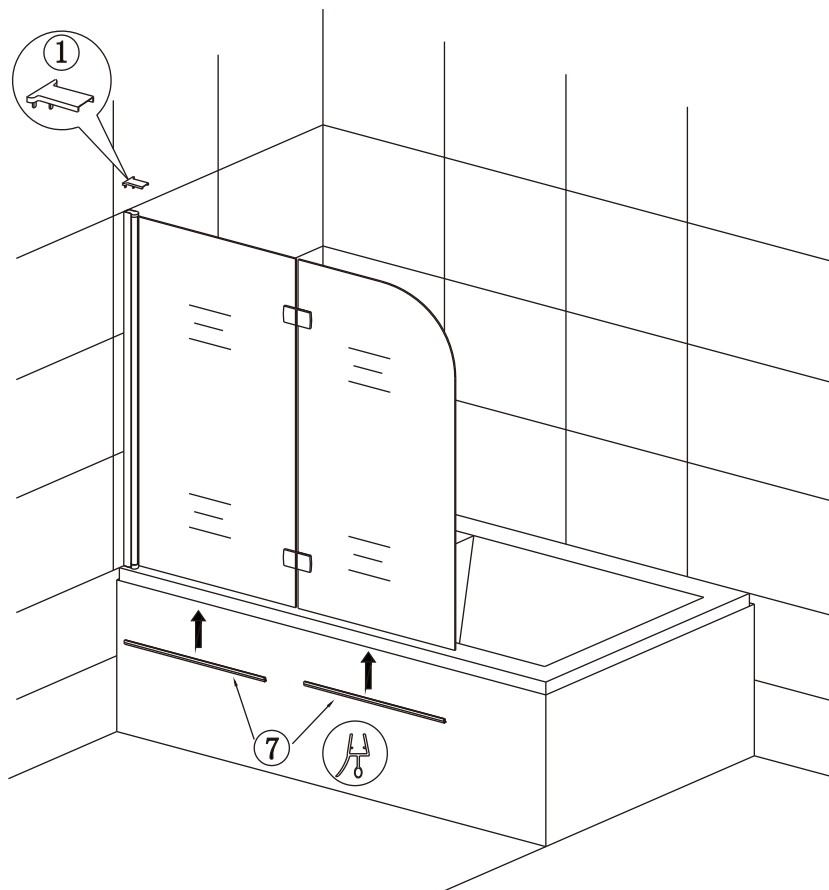

Fit bottom seals (7) as shown.

12

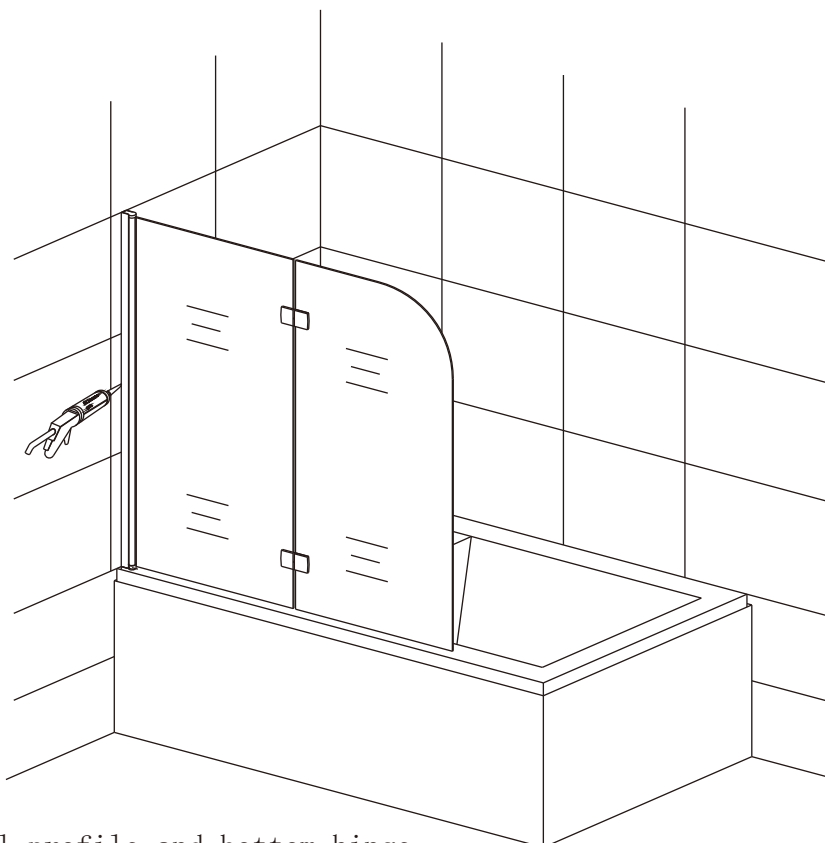

Silicone wall profile and bottom hinge on outside only as illustrated.

(4) L

1

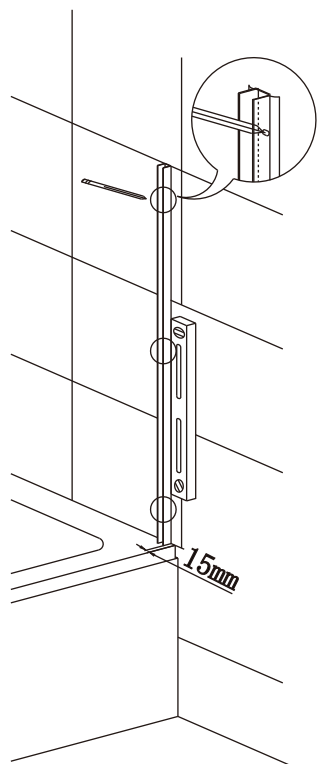

Dry fit required for best position to connect wall profile.

2

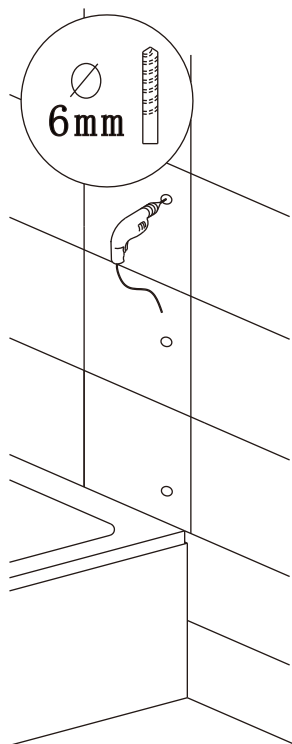

Drill holes in wall.

3

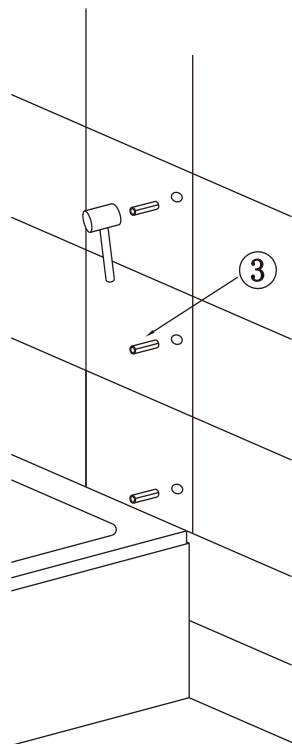

Fit wall profile plugs if a solid wall substitute for hollow wall fixings if necessary(not supplied).

4

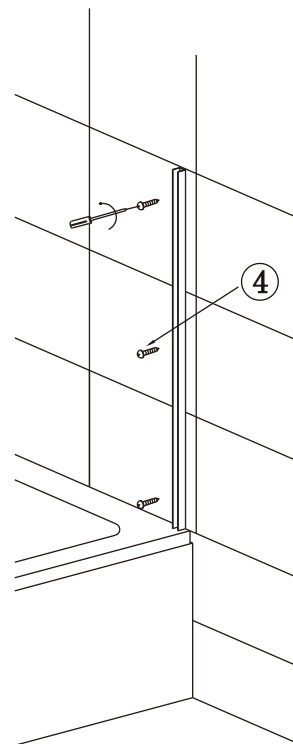

Fix wall profile with ST5*30 screws.

5

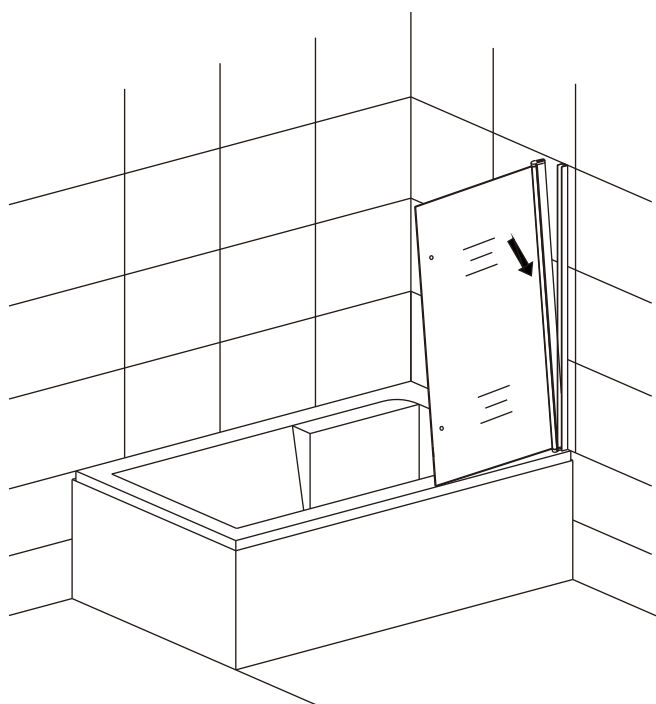

Fit first half of screen into wall profile.

6

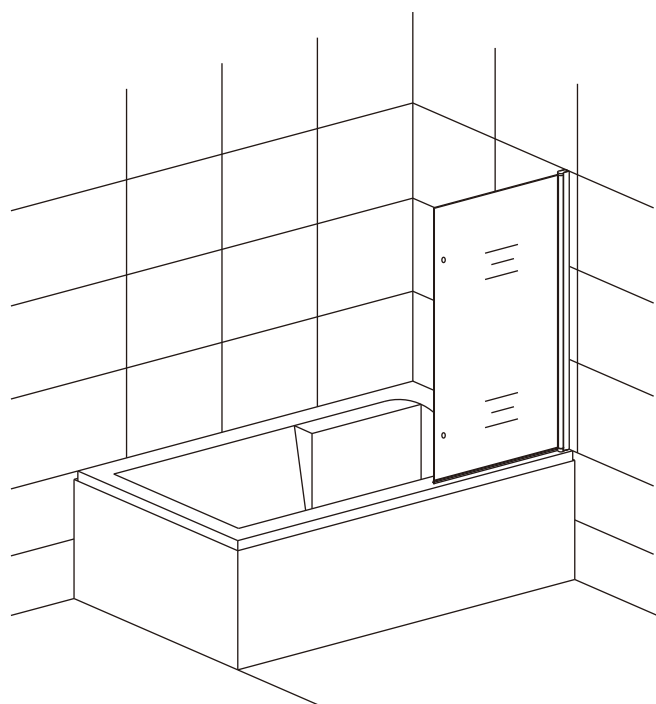

(5)

R

7

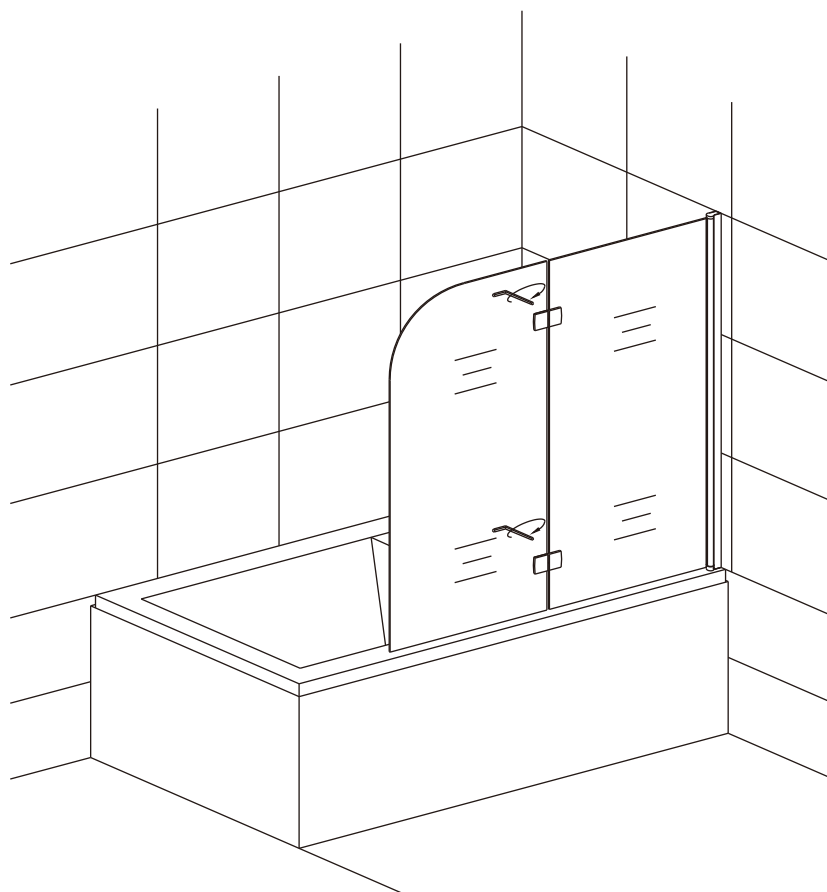

Attach second half of screen onto first with hinges supplied. Use torque wrench to tighten fixings on hinges to 14N•M.

8

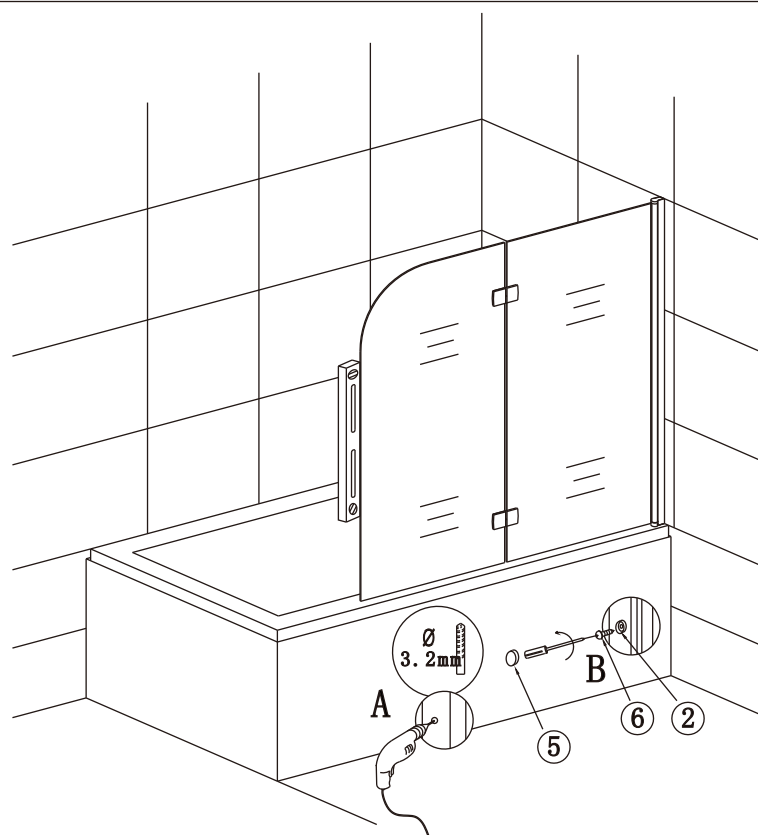

Level screen and fix first part into wall profile with ST4*12 screws with (5) and (2) chrome cover caps.

(6)

R

9

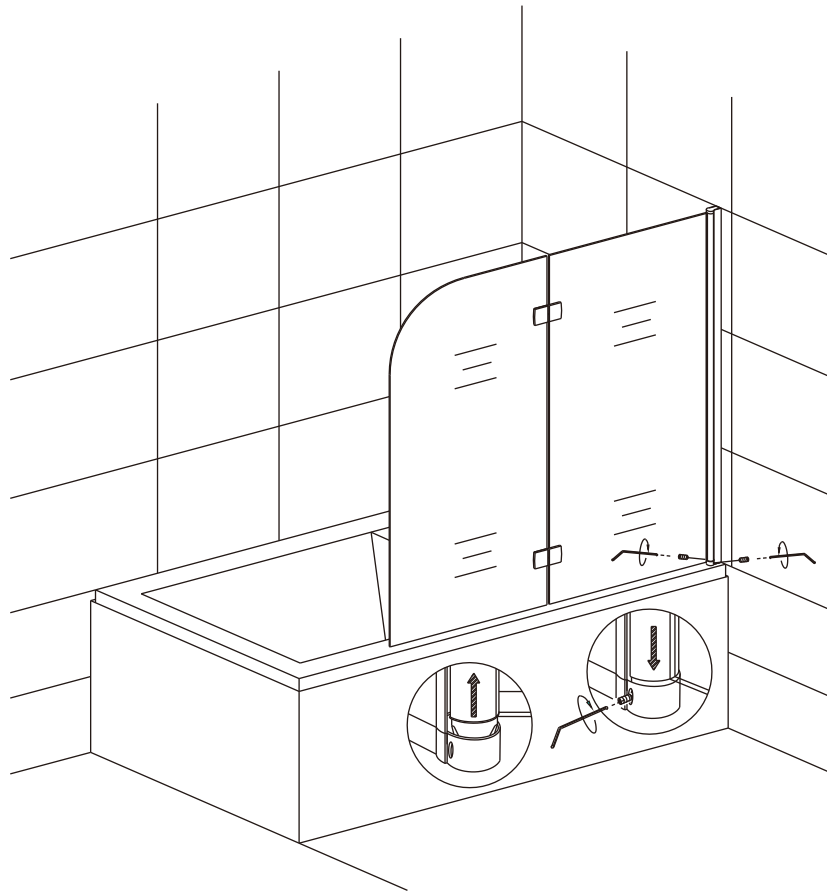

Check rise and fall hinge is operating correctly and adjust accordingly with grub screw provided.

10

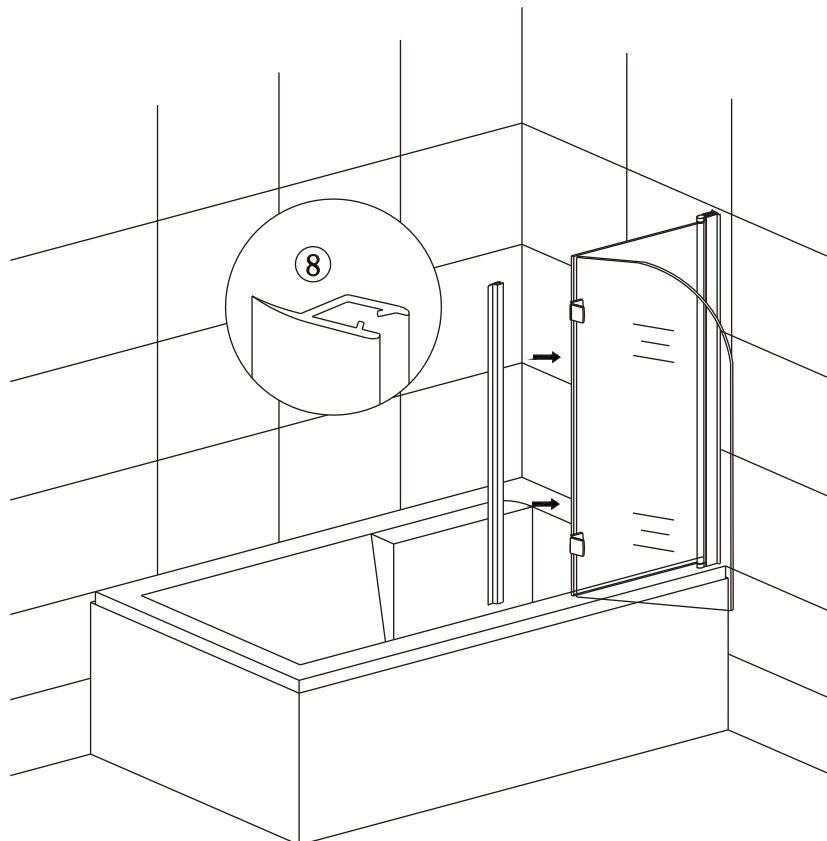

Fit vertical seal (8) onto first screen ensuring wiper part overlaps second screen.

(7)

R

11

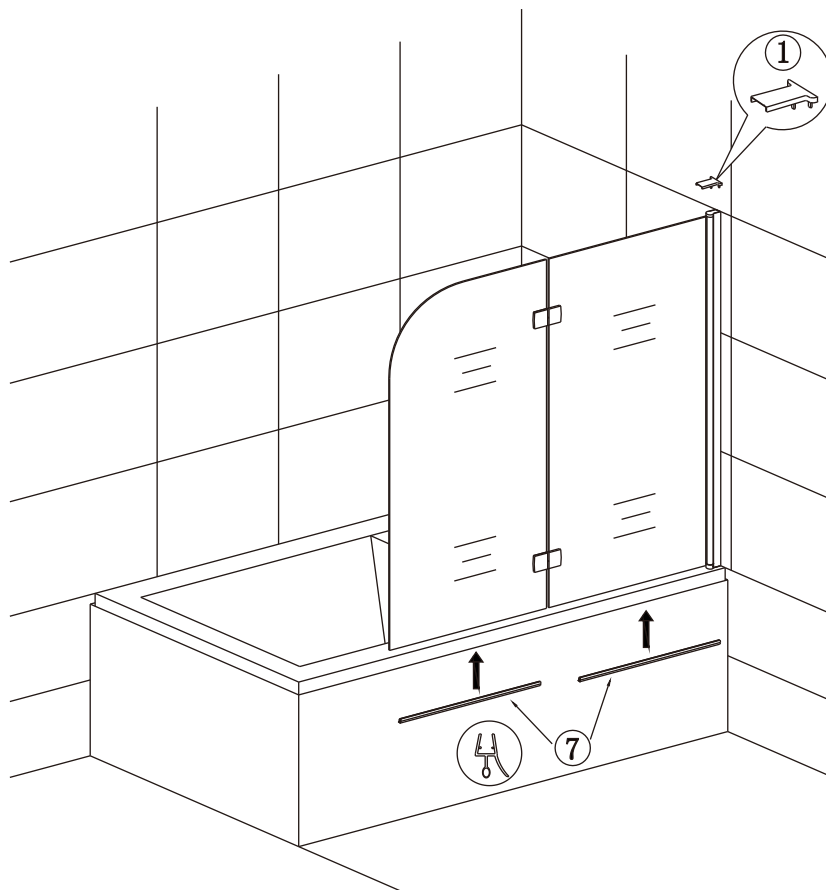

Fit bottom seals (7) as shown.

12

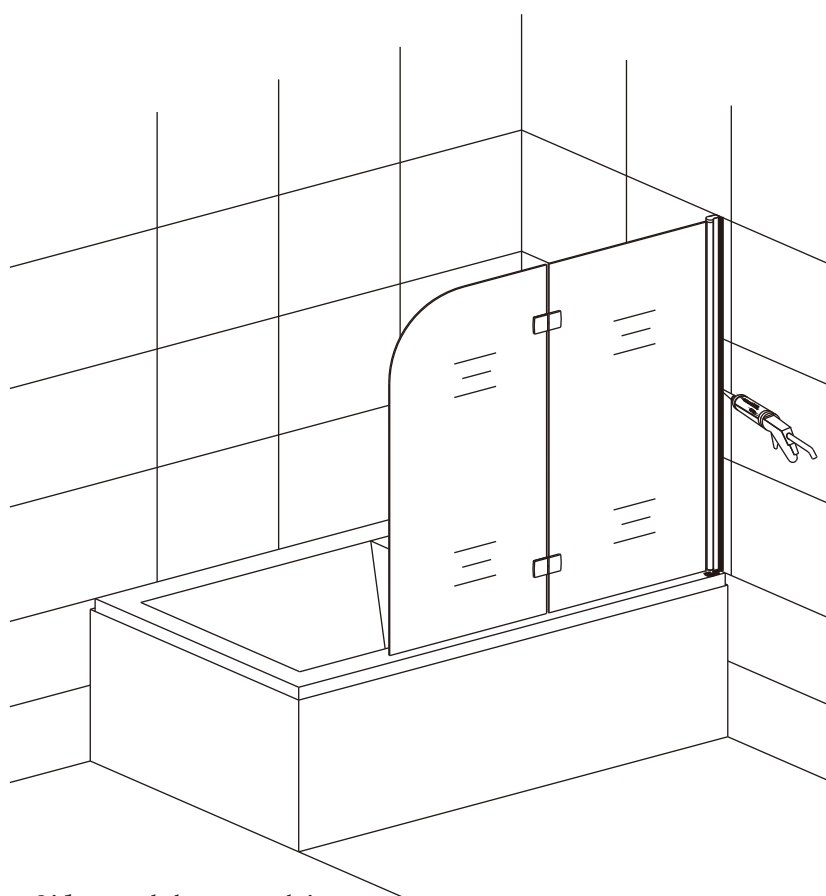

Silicone wall profile and bottom hinge on outside only as illustrated.

(8)

Cleaning & Maintenance

Don't clean the shower enclosure with irritant detergent such as alcohol, bleach or other chemical cleaners.

Only clean with warm soapy water.

Helpline: 01452317890

Monday-Friday: 8:00 a.m.-5:00 p.m.



Eastbrook Road, Gloucester GL4 3DB

Technical Helpline: 01452 317890

email: technical@eastbrookco.com