

78.0016 Curved Mini Slide Rail Kit

INSTALLATION GUIDE

Technical Drawing

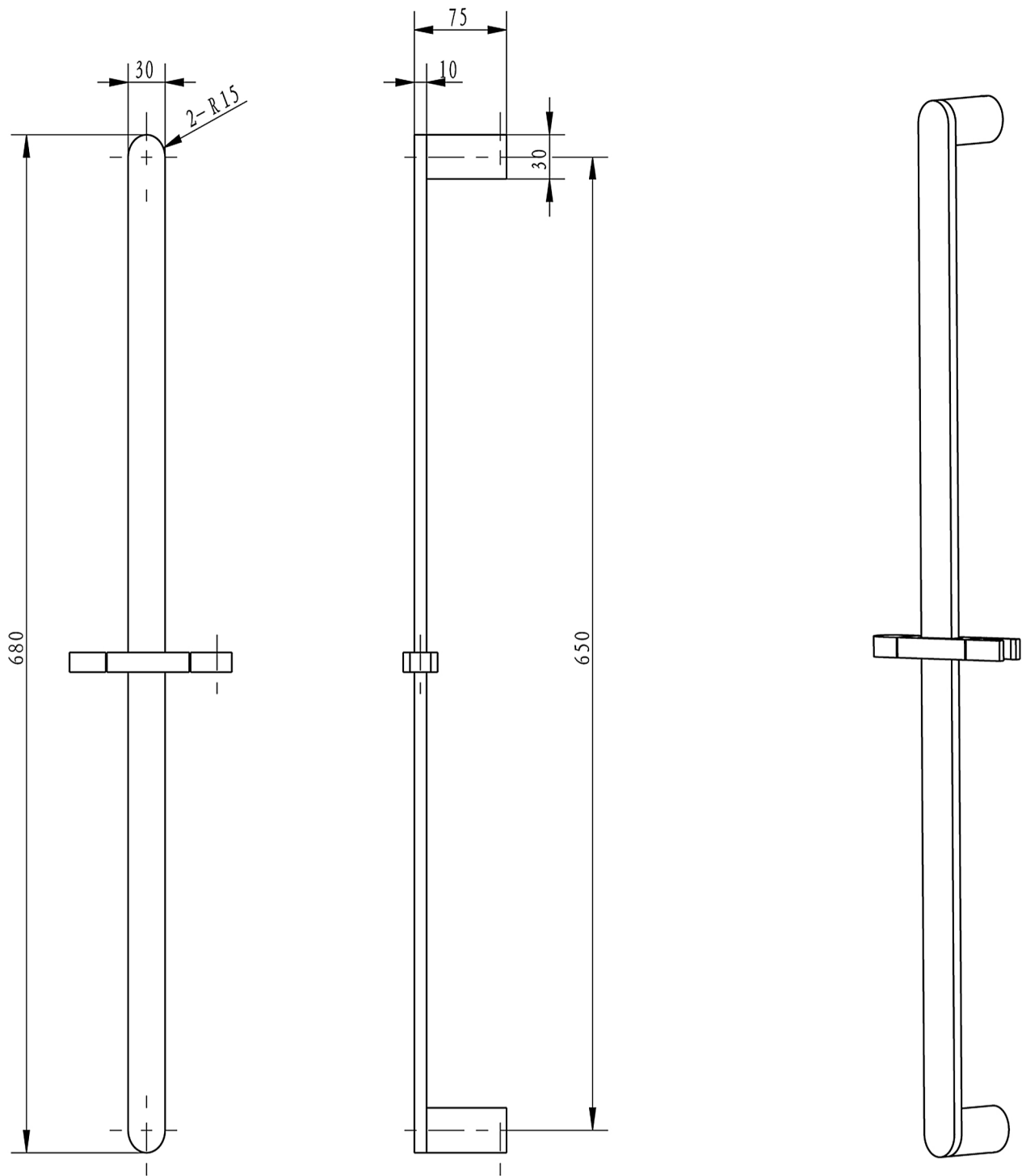

Eastbrook Road, Gloucester GL4 3DB
Technical Helpline : 01452 317890
Mon - Fri / 8am - 5pm
Email : technical@eastbrookco.com

1.

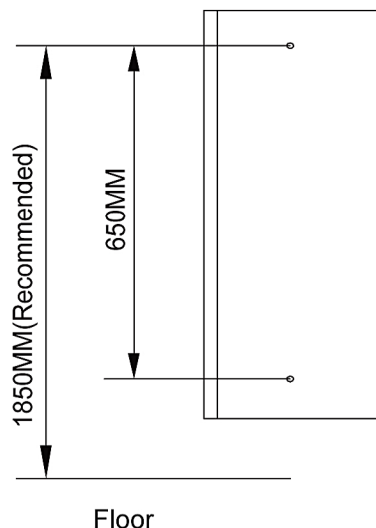

Drill 2 holes (Distance is 650mm) in desired position.

2.

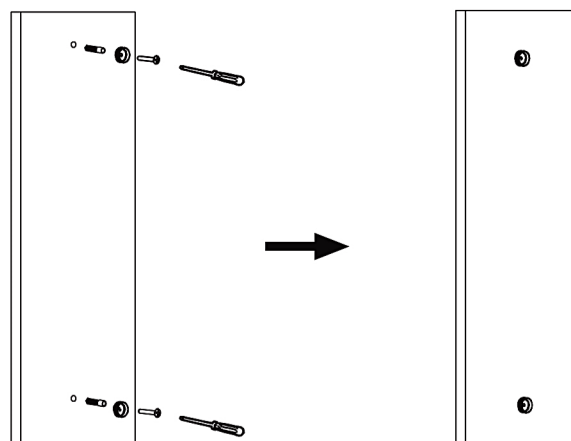

Insert wall plugs as shown and then install the Fixed base 2.

3.

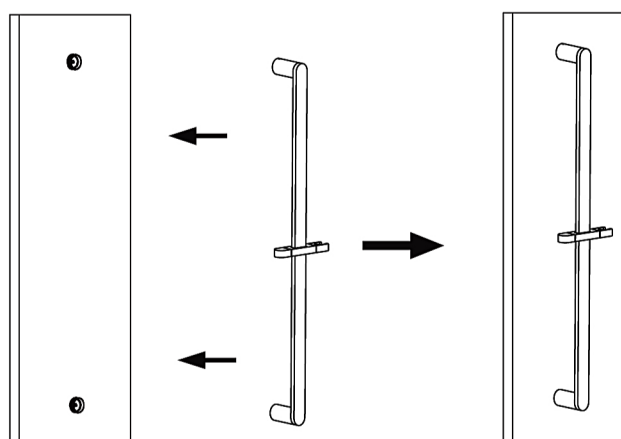

Fit the shower rail onto the Fixed base 2.

4.

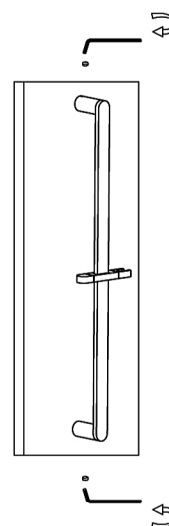

Tighten grub screws to attach the rail to the Fixed base 1.

CLEANING:

Never use abrasives or abrasive cleaning agents to clean this product. Clean regularly with contamination free warm soapy water and a damp soft cloth.

A filter washer should be installed in the hose cone on the water outlet and it should be cleaned periodically.

If shower performance is compromised by the build-up of lime-scale, soak in distilled vinegar for up to 10 minutes. Do not use products containing chlorine bleach or hydrochloric acid as these can damage the shower. Always rinse the shower thoroughly after cleaning to remove cleaning products that can damage the shower.

Never insert objects into the spray slot or attempt to remove limescale with sharp objects or abrasives.



Eastbrook Road, Gloucester GL4 3DB
 Technical Helpline : 01452 317890
 Mon - Fri / 8am - 5pm
 Email : technical@eastbrookco.com

General:

-
- This diagram illustrates the assembly of a mechanical component, likely a hinge or bracket, using nine numbered parts. The main vertical component is labeled 1. At the top, a cylindrical part (2) is shown with a pin (6) and a washer (7) being inserted through it. A separate screw (8) is shown nearby. A small pin (5) is also indicated near the top assembly. On the right side, a bracket (3) is shown being attached to the main component. At the bottom, another cylindrical part (4) is shown with a pin (5) and a washer (7) being inserted through it. A separate screw (9) is shown nearby. The diagram uses simple line art to represent the parts and their assembly sequence.

9	Parts	1
8	M5X10 screw	2
7	Part2	2
6	Part1	2
5	M5x5screw	2
4	Fixed base 2	2
3	Shower holder	1
2	Fixed base 1	2
1	Rail	1
NO.	Part Name	Qty

Eastbrook Road, Gloucester GL4 3DB
 Technical Helpline : 01452 317890
 Mon - Fri / 8am - 5pm
 Email : technical@eastbrookco.com