

# Installation Guide

## Technical Specifications:

### Operating Pressure:

Min: 150kPa/1.5bar

Max: 500kPa/5.0bar\*

Optimum: 150kPa/1.5bar - 500kPa/5bar

Recommended installation of pressure limiting valve if supply exceeds 500kPa

### Operating Temperature:

Hot: Max 80°C\*

Cold: Min 5°C

### Inlet Connections:

All ½" BSP

### NOTE:

- After installation all connections must be checked for leaks
- All installations must be carried out in compliance with relevant water regulations\*.

**This product should be fitted by a fully qualified installer.**

## Technical Drawing

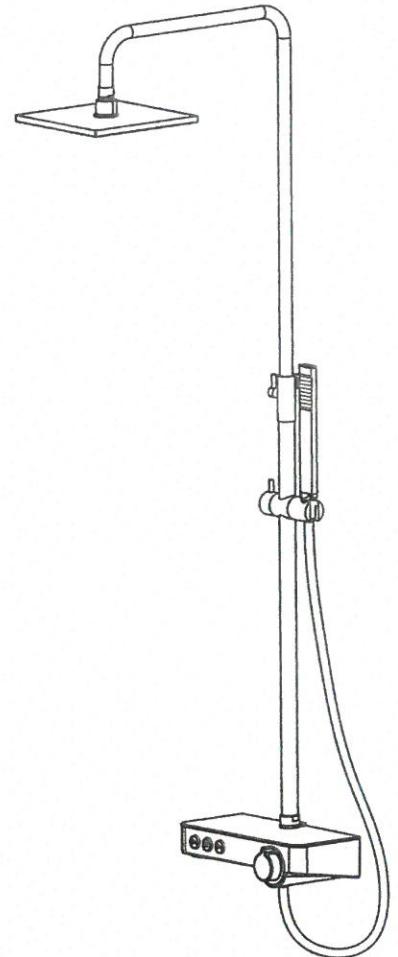
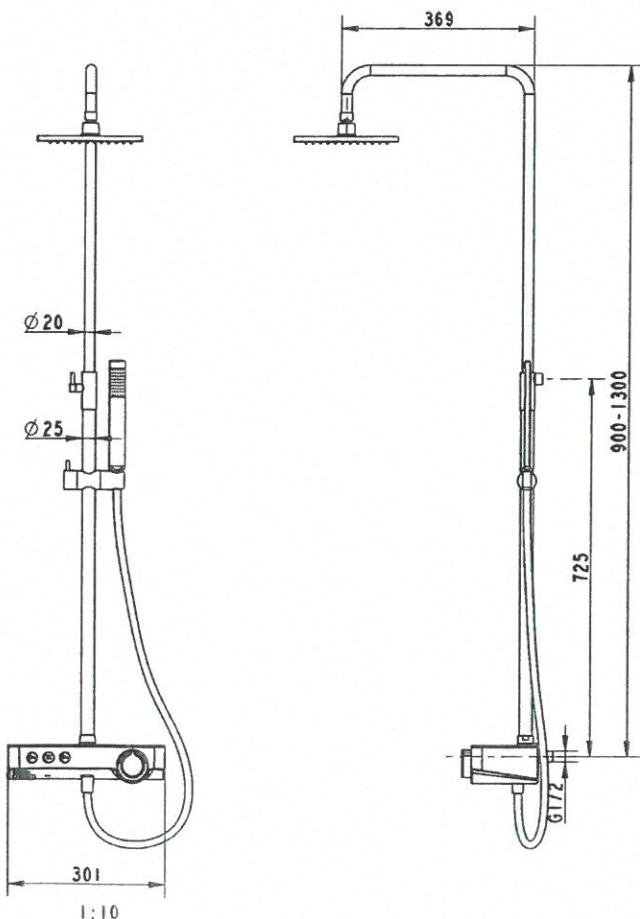

**Eastbrook**

Eastbrook Road, Gloucester GL4 3DB

Technical Helpline : 01452 317890

Mon - Fri / 8am - 5pm

Email : [technical@eastbrookco.com](mailto:technical@eastbrookco.com)

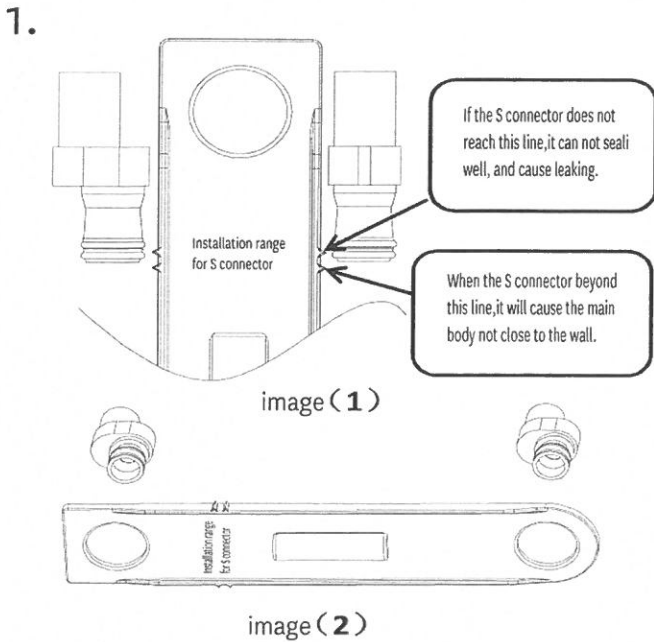

H/C water inlet recommended height of 1200mm from the floor. Wrap PTFE thread seal tape around the S connector and screw it into the hot and cold water pipe. Adjust the distance by using the level ruler on the side of "S connector installation range" (note: you can adjust the S connector scale on two sides of level ruler) like image 1, then set two round holes on level ruler into two S connectors and adjust the 150mm center distance. After reaching the horizontal effect, take out the level ruler. Like image 2.

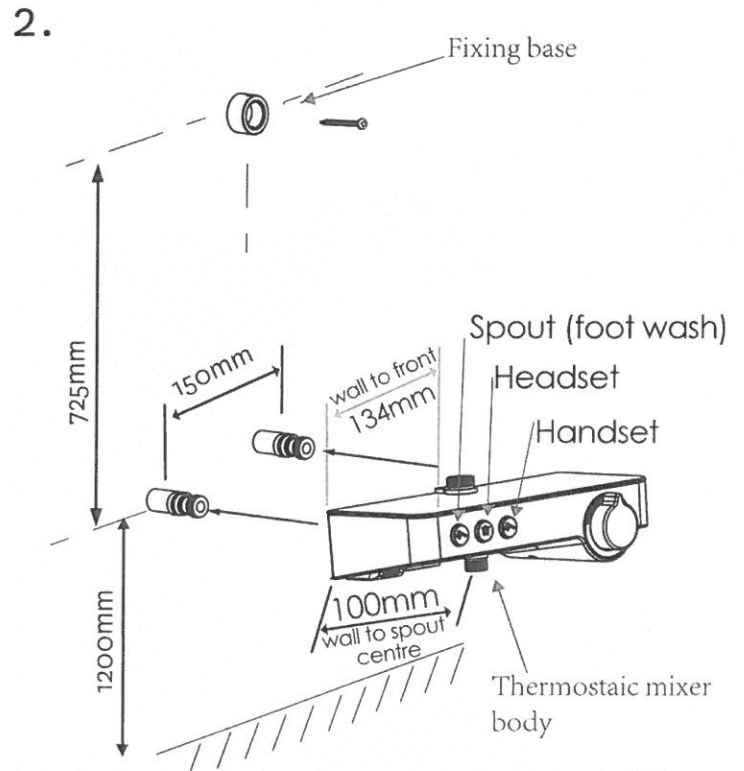

Push the S connector into the two holes in the back of the Thermostatic mixer body to make it close to the wall, and then tighten the screw on the bottom of the main body by allen key. The wall bracket recommended height of 725mm, fixing it with screws.

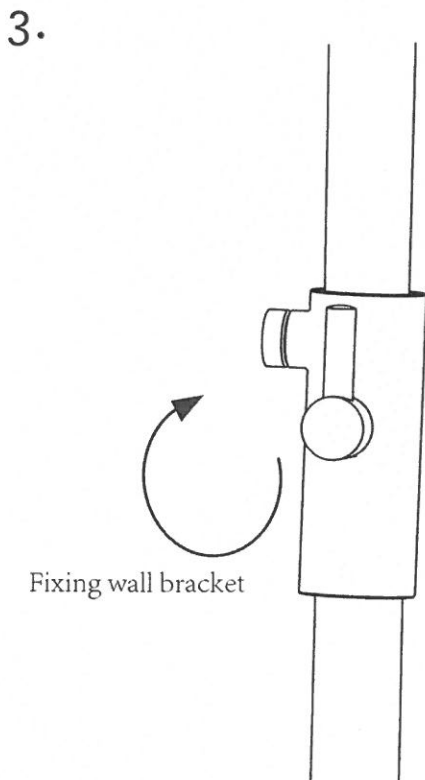

Adjust the location and fixing the wall bracket.

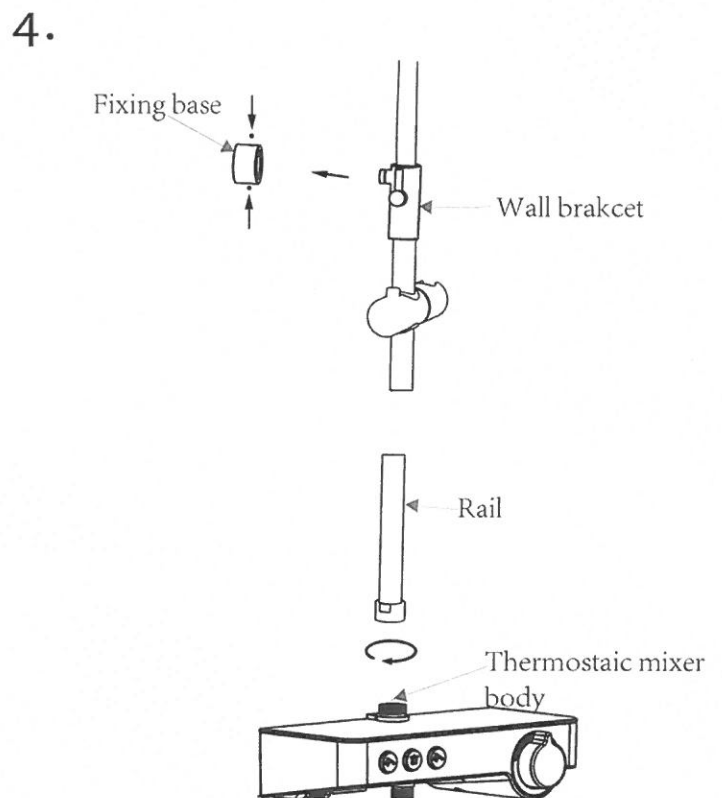

Put the rail into the mixer body and tight them with screw.

**Warranty is conditional with the product being maintained in accordance with the cleaning instructions and ensuring no parts are broken or loose to prevent failure.**

5.

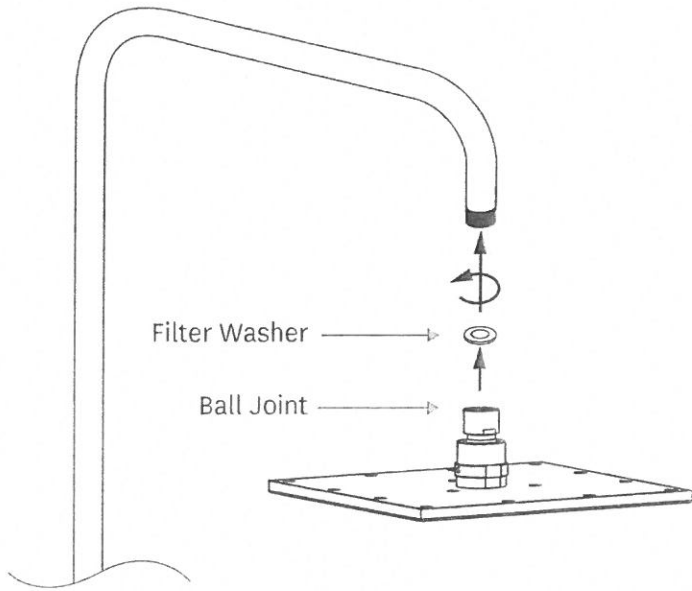

Remove the protective cap from the showerhead ball joint and screw the unit onto the overhead arm ensuring the filter washer is in place. This arm is not adjustable.

6.

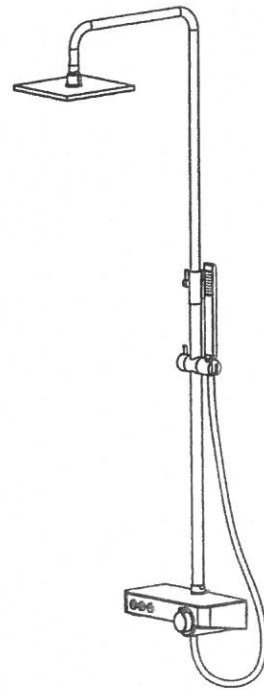

Make sure a washer is in both ends of the hose. Screw hose onto lower outlet on rail, attach handset and place firmly in holder. Tilt and rotate head to the desired position.

## CLEANING

Water contains lime which remains on the surface after the water has evaporated. These lime deposits can be prevented from forming by wiping immediately after use.

To clean the chrome-plated surfaces use a soft cloth, soap and warm water. Never use cleaning agents that contain a corrosive acid or a scouring additive.

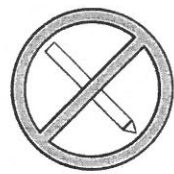
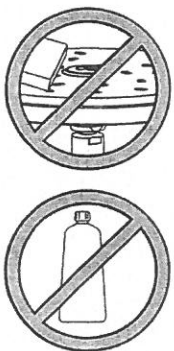

Do not use any sharp objects to clean nozzles

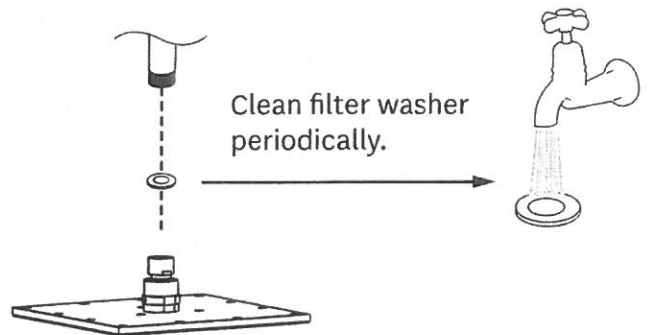
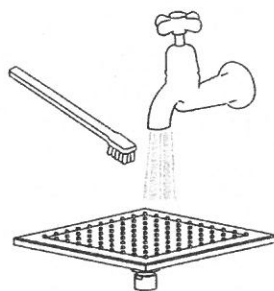

**Warranty is conditional with the product being maintained in accordance with the cleaning instructions and ensuring no parts are broken or loose to prevent failure.**

# PZMF0171-00

## Important Installation Considerations

1. NOTE: Some showers may not provide an effective shower when used with gravity fed heated water systems or where pressures are less than 150kPa at the outlet. Additionally showers with flow rates of less than 9L/min may not allow the following to function correctly:

- \_ some instantaneous water heaters
- \_ some tempering valves
- \_ some thermostatic mixing valves

2. Some shower heads only operate correctly when hot and cold water supplies are both mains pressure and may not be suitable for some instantaneous hot water services.

3. When water pressure is in excess of 500kPa a pressure limiting device is required

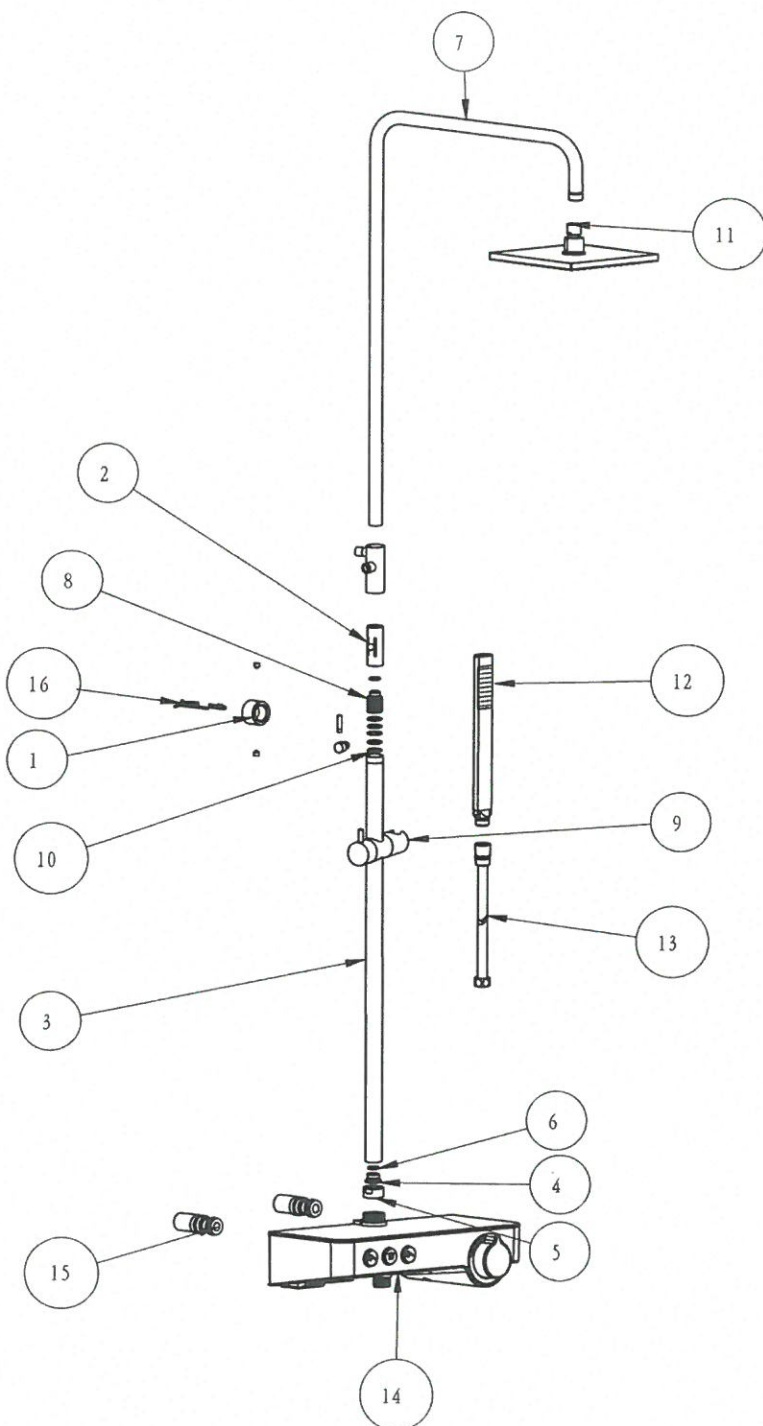

16	Parts	1
15	Gauge	2
14	Thermostatic body	1
13	1.5M SS Hose	1
12	Handset	1
11	Rain Shower	1
10	∅ 22x2mm O Ring	5
9	25mm ABS Slider	1
8	Connector	1
7	Arm	1
6	∅ 17x2mm O Ring	2
5	G3/4 nut	1
4	SS connector	1
3	Rail	1
2	Round welding tight up parts	1
1	Installation parts	1
NO.	Part Name	Qty



Eastbrook Road, Gloucester GL4 3DB  
 Technical Helpline : 01452 317890  
 Mon - Fri / 8am - 5pm  
 Email : technical@eastbrookco.com