

Panel Installation Instructions

Shannon Universal L-Shaped 1700/1500 Panel

1. Please note bath shown without bath supports for illustration purposes.

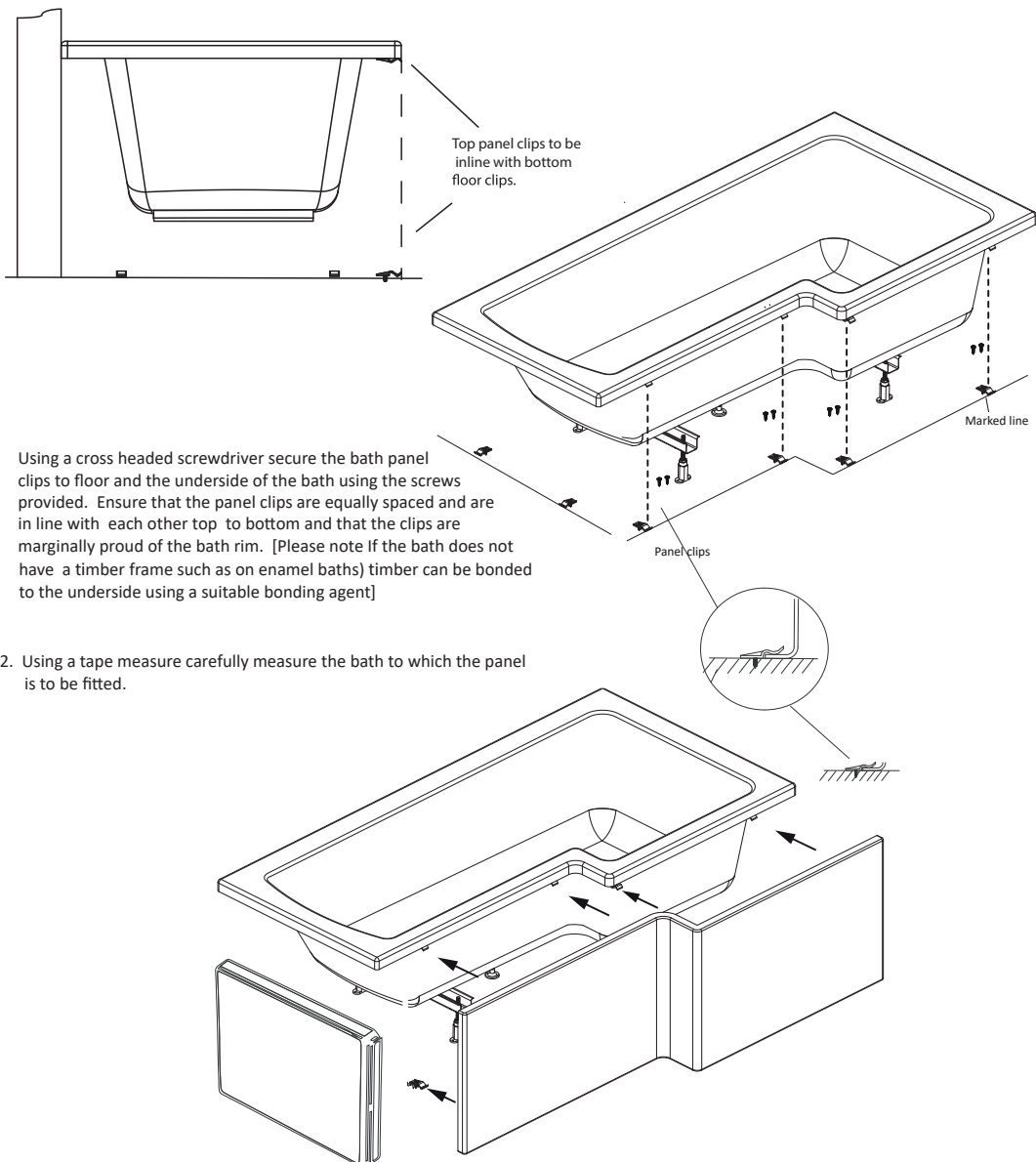

3. Carefully fit the bath panel to the bath by gently pushing the bath panel into place.
Ensure that the bath panel is firmly held in place with the bath panel clips.

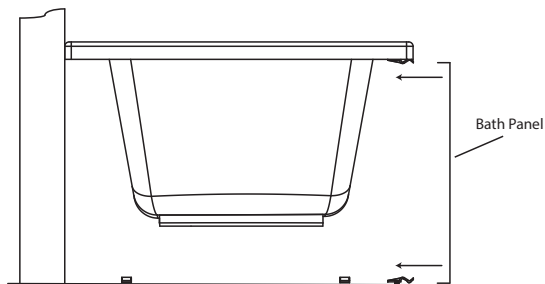

Please note to allow for future access the panel stops/clips are designed to hold the panel not lock it into position.
Additional timbers may be fitted to the walls behind the panel and Velcro strips used to further secure the panel neatly and professionally.

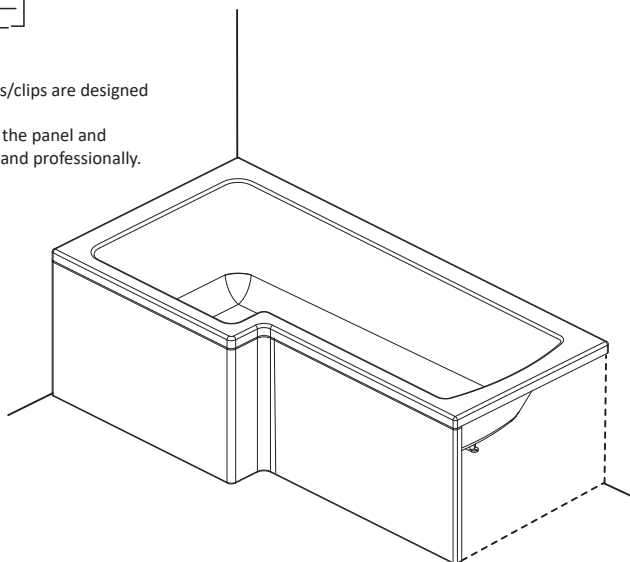

If required silicon down the walls to create a seal

Panel Fixings:

Components shown below are **supplied with the front panel** (quantities dependant on panel type).

