

## DATASHEET

### Image



### General Information

Product:	89.1479
Description:	Wingrave 1200 x 310 Flat Panel Radiator
Website Link:	<a href="#">(Click Here)</a>
Product Type:	Radiator
Brand:	Eastbrook Company
Colour:	Matt Black
Material:	Mild Steel
Height (mm):	1200mm
Width (mm):	310mm
Net Weight (kg):	9.65kg
Product Range:	Wingrave Flat Panel

### Product Specifications

Warranty:	5 Year(s)
Supplied with fixings:	Yes
Orientation:	Vertical
BTU $\Delta T50^{\circ}\text{C}$ :	1253
BTU $\Delta T60^{\circ}\text{C}$ :	1604
Watts $\Delta T50^{\circ}\text{C}$ :	368
Watts $\Delta T60^{\circ}\text{C}$ :	470
Valve Types:	

**Drawing**

**Wingrave Flat Panel 1200 x 310mm.  
 Towel Rail Technical Drawing**

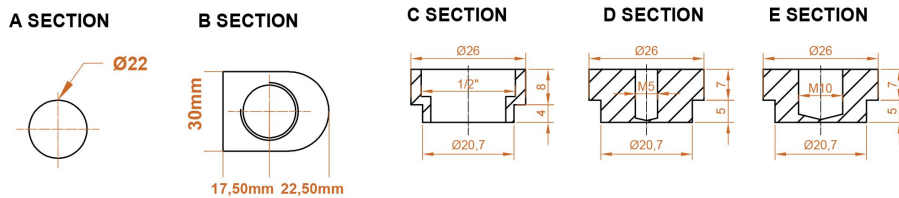
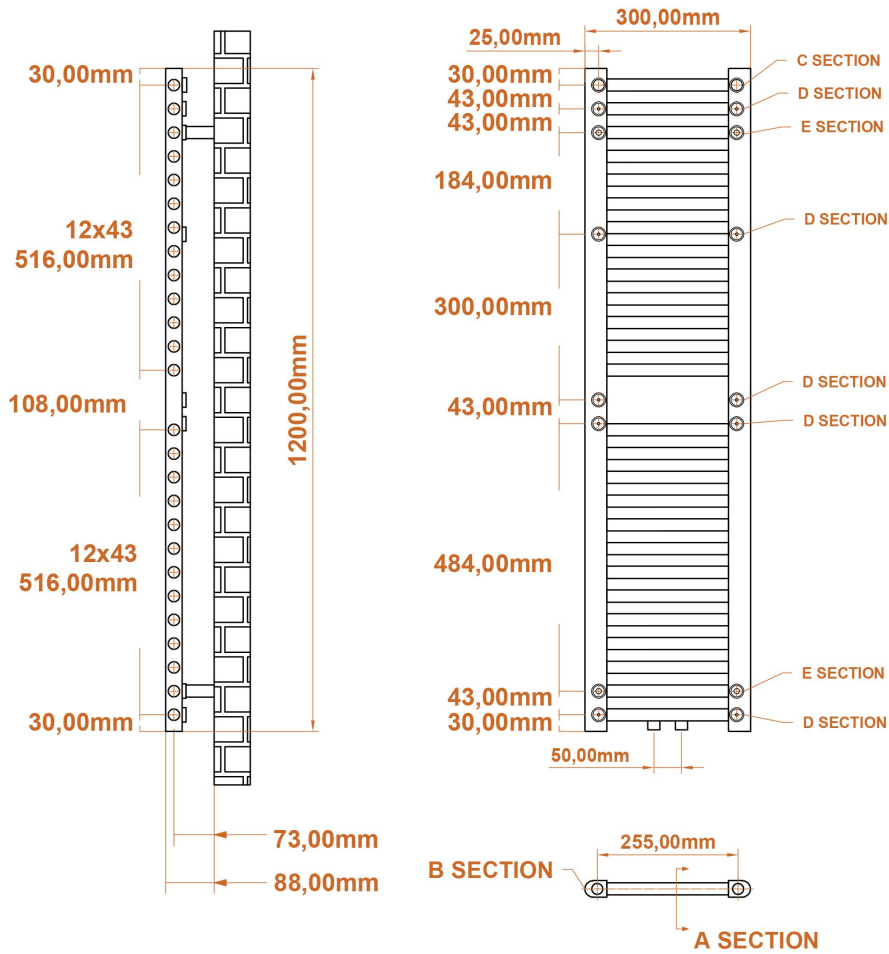

**Eastbrook**   
 Eastbrook Road, Gloucester GL4 3DB  
 Technical Helpline : 01452 317890  
 Mon - Fri / 8am - 5pm  
 Email : technical@eastbrookco.com