

Manual for Right hand installation-Matt black (49. 1094)

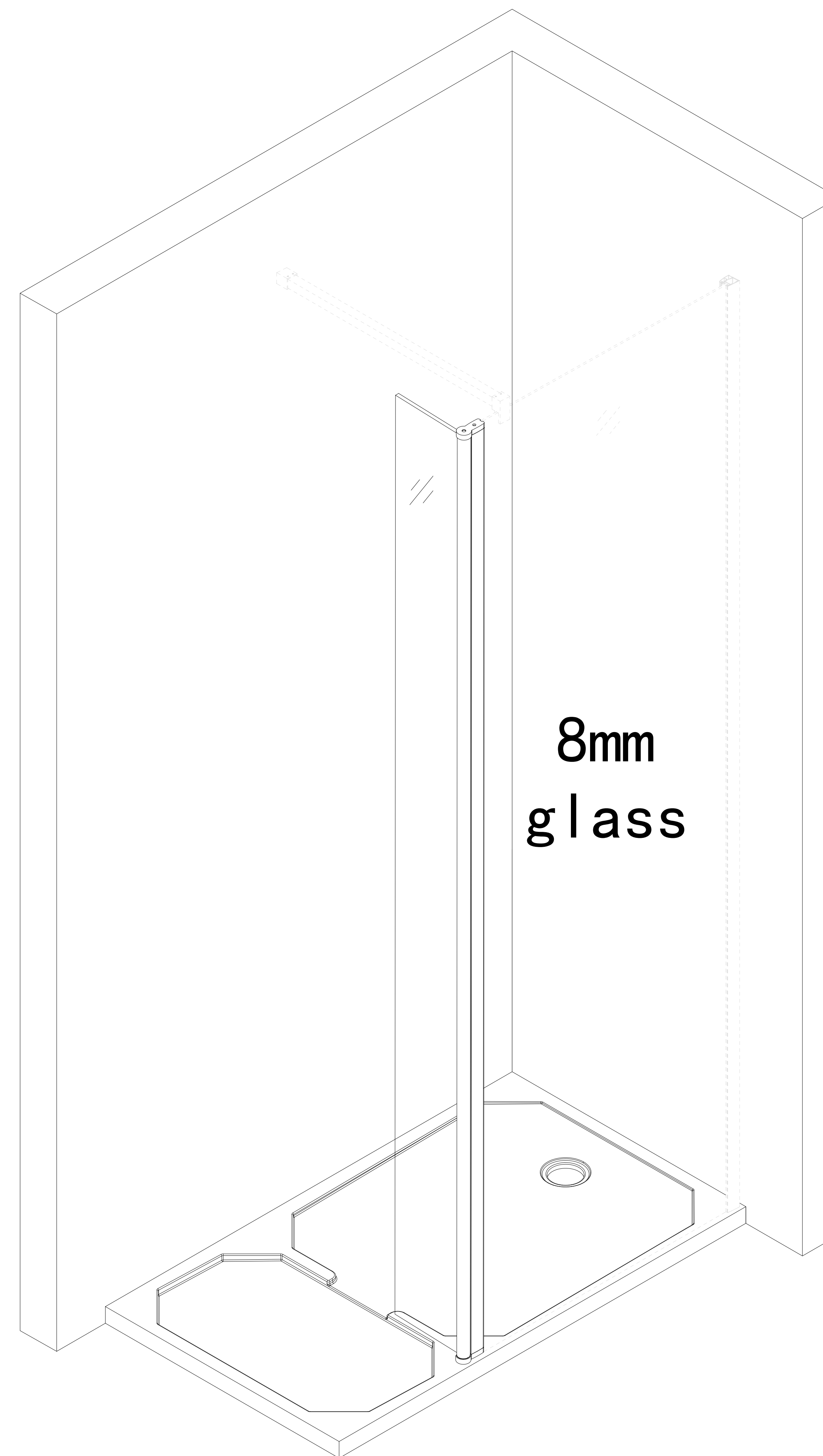

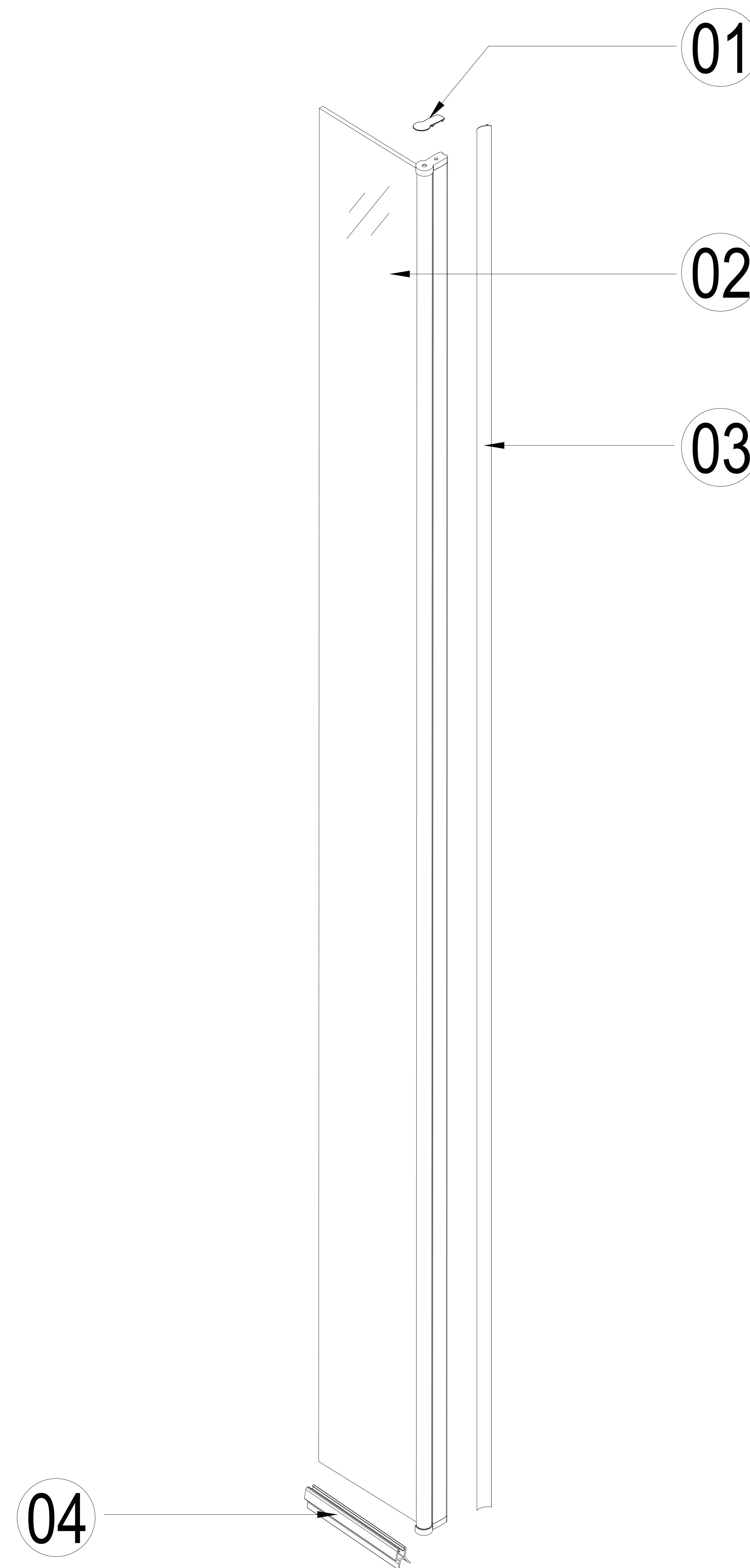

Flipper panel

01

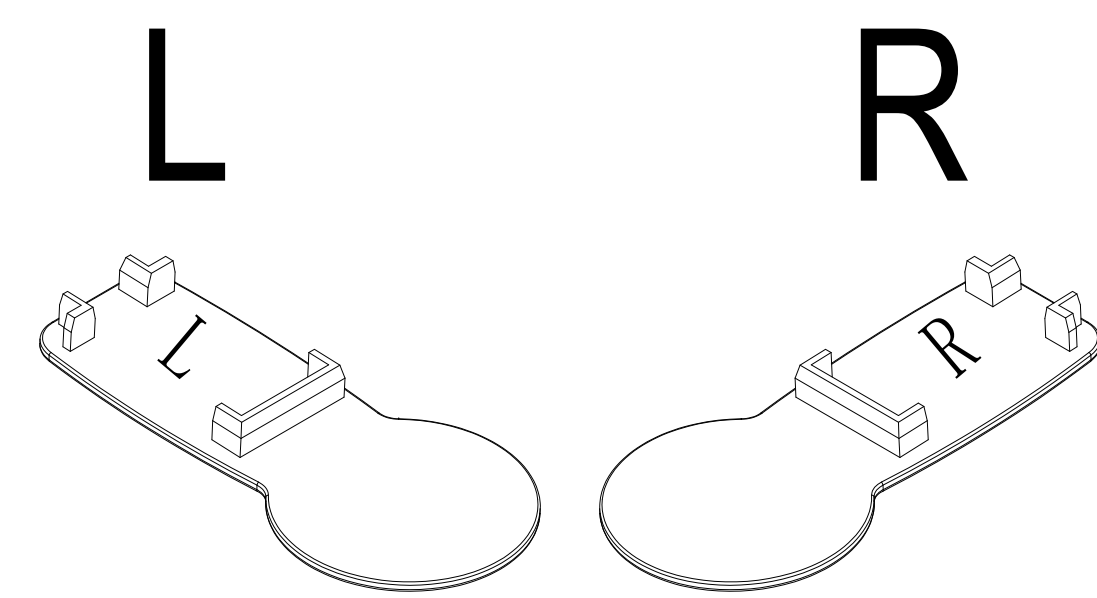

BRSF-S01

2Pc

02

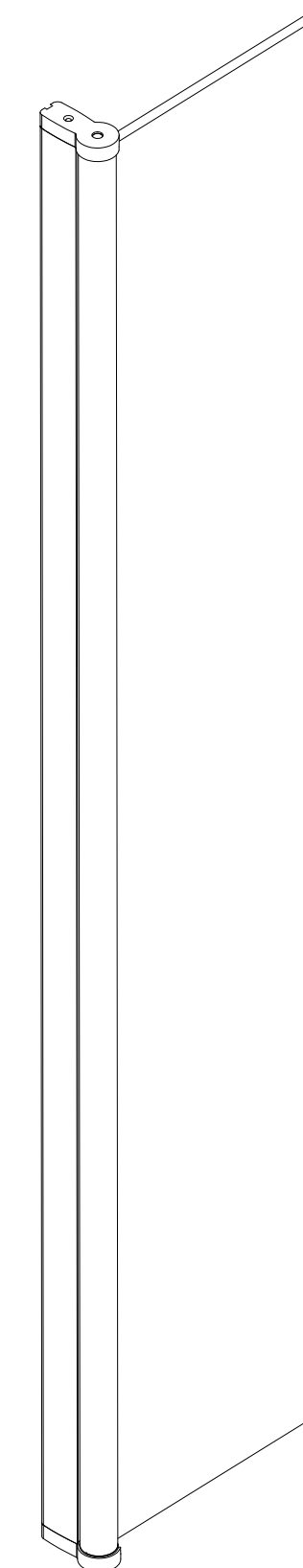

1Pc

03

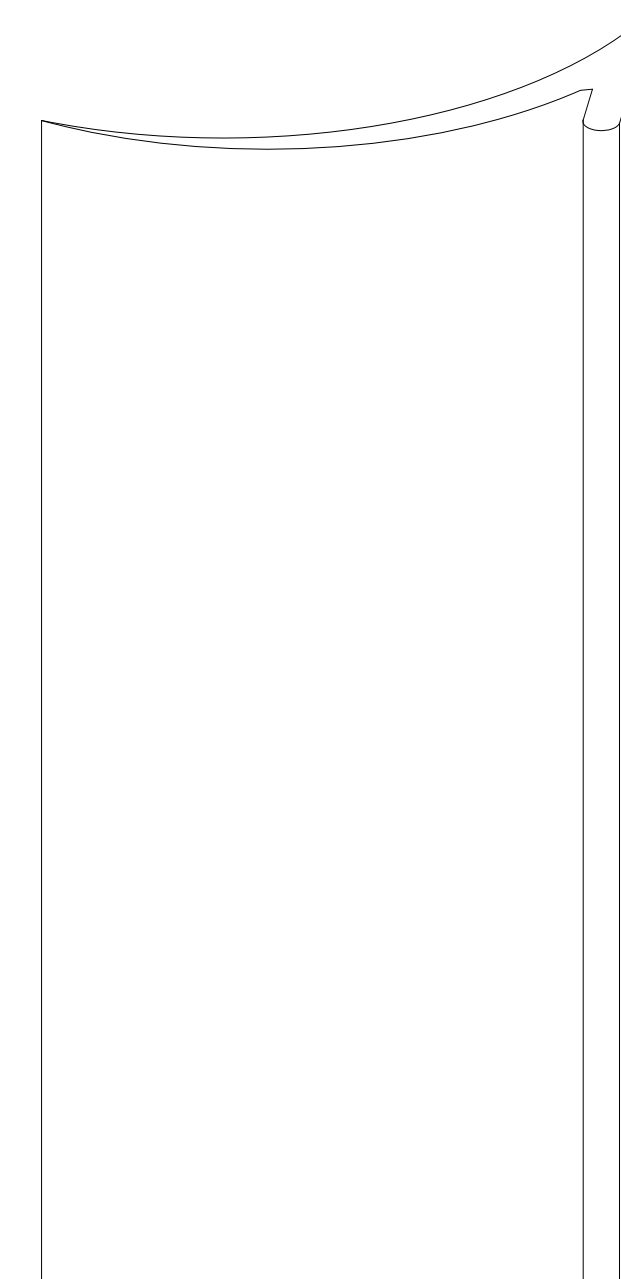

BRSF-Z01

1Pc

04

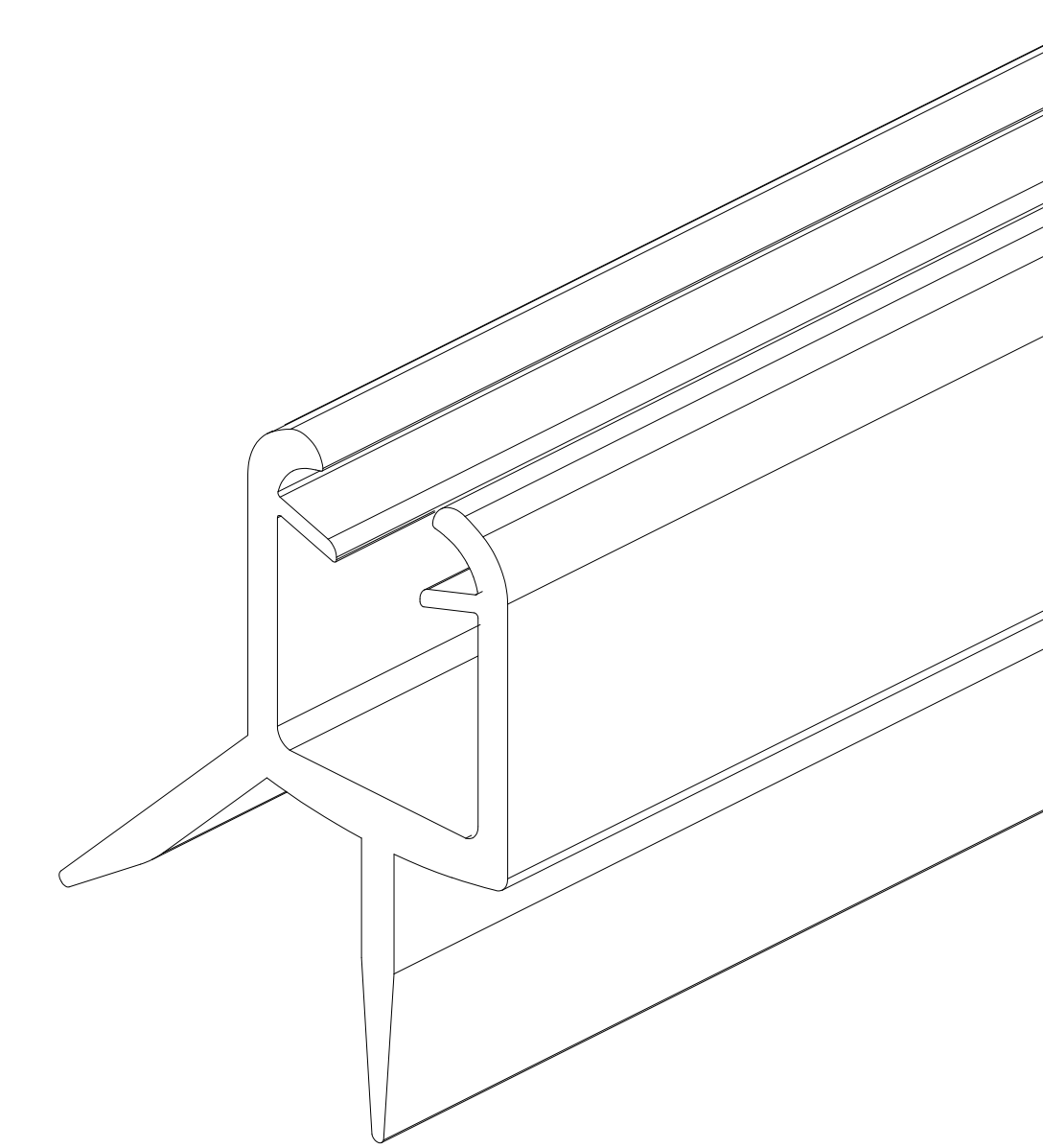

BRSF-Z02

1Pc

Tools:

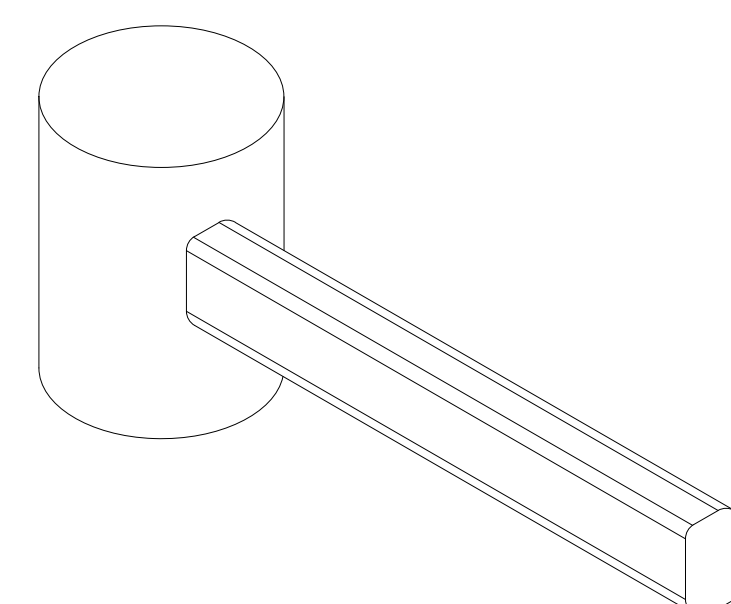
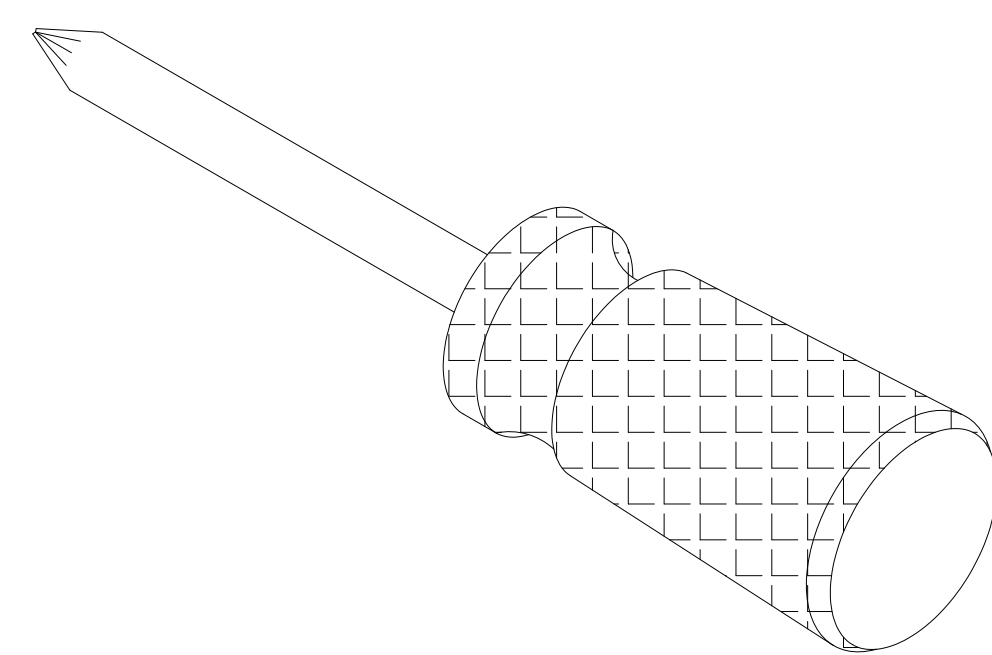
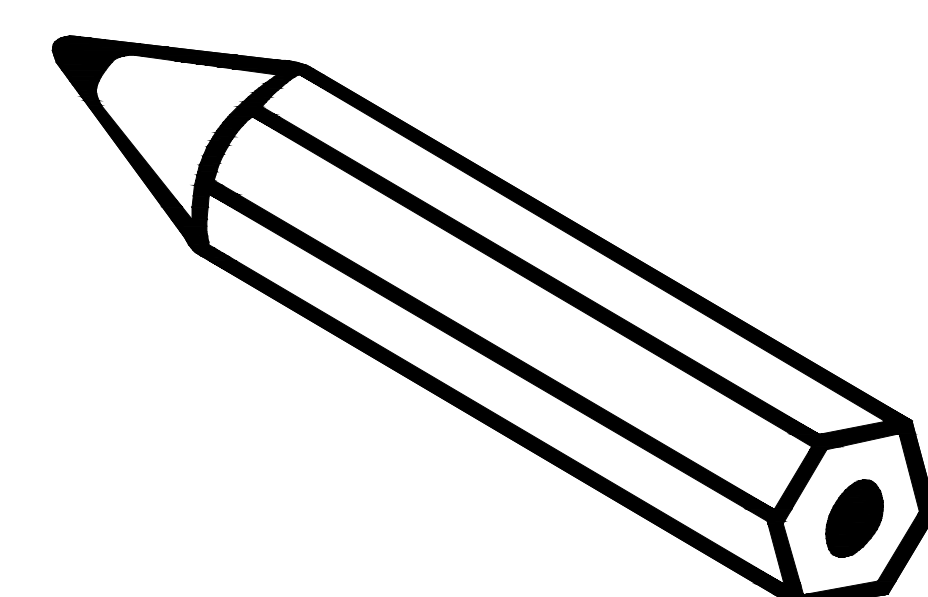
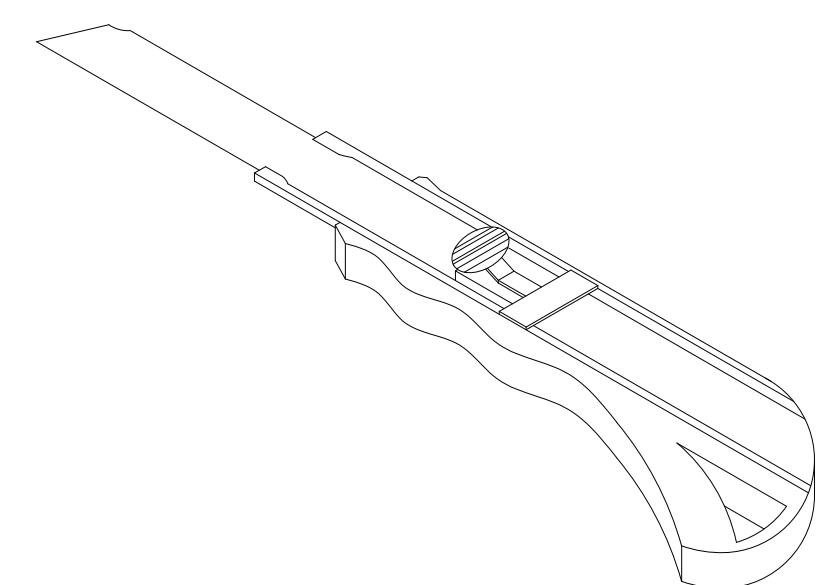

2.5 mm

4 mm

Ø6mm

Ø3.2mm

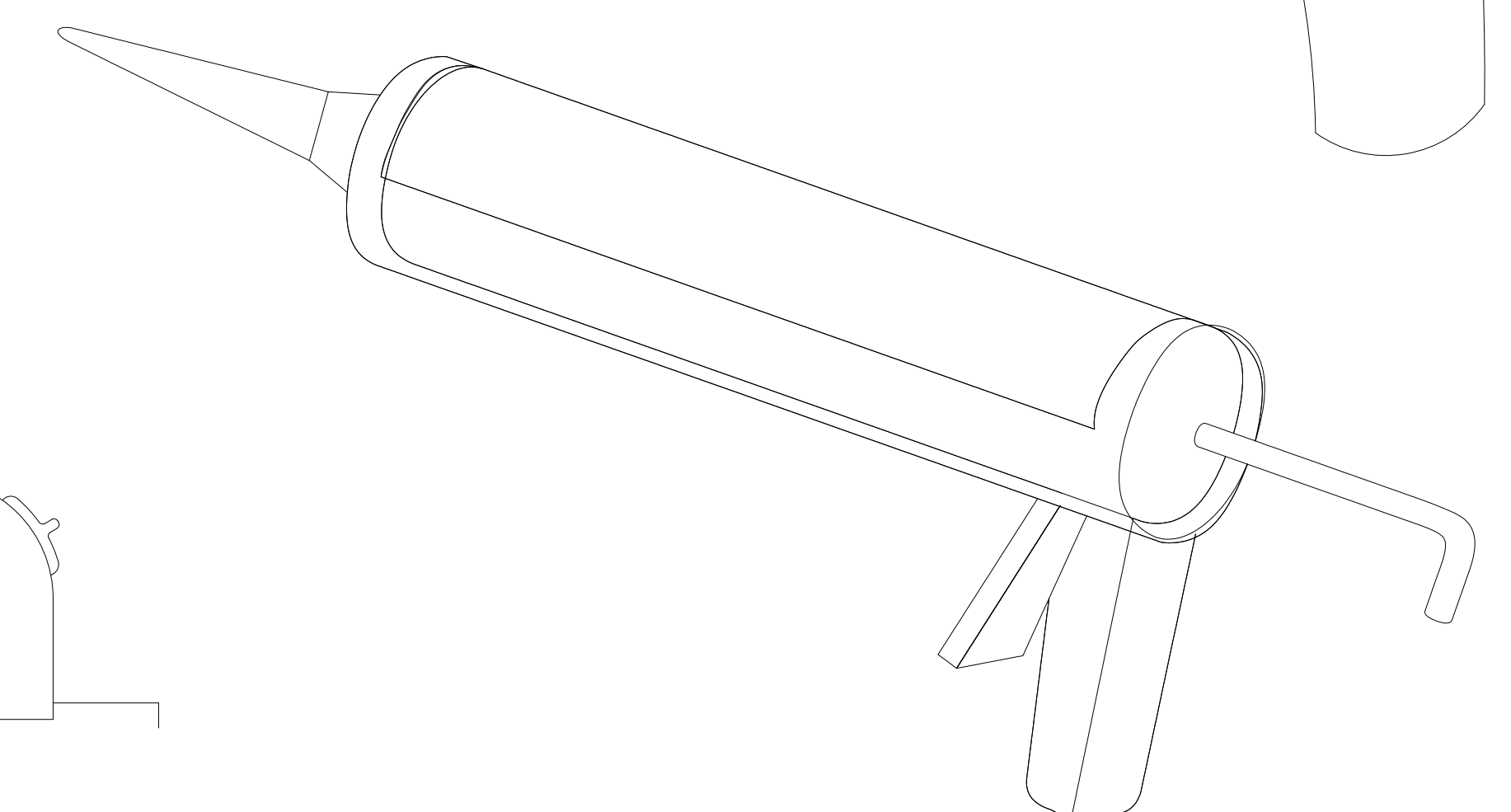
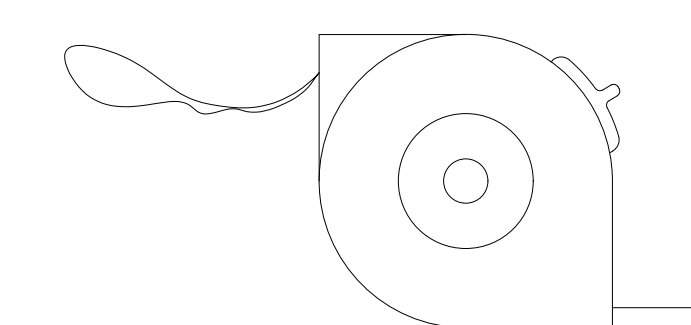
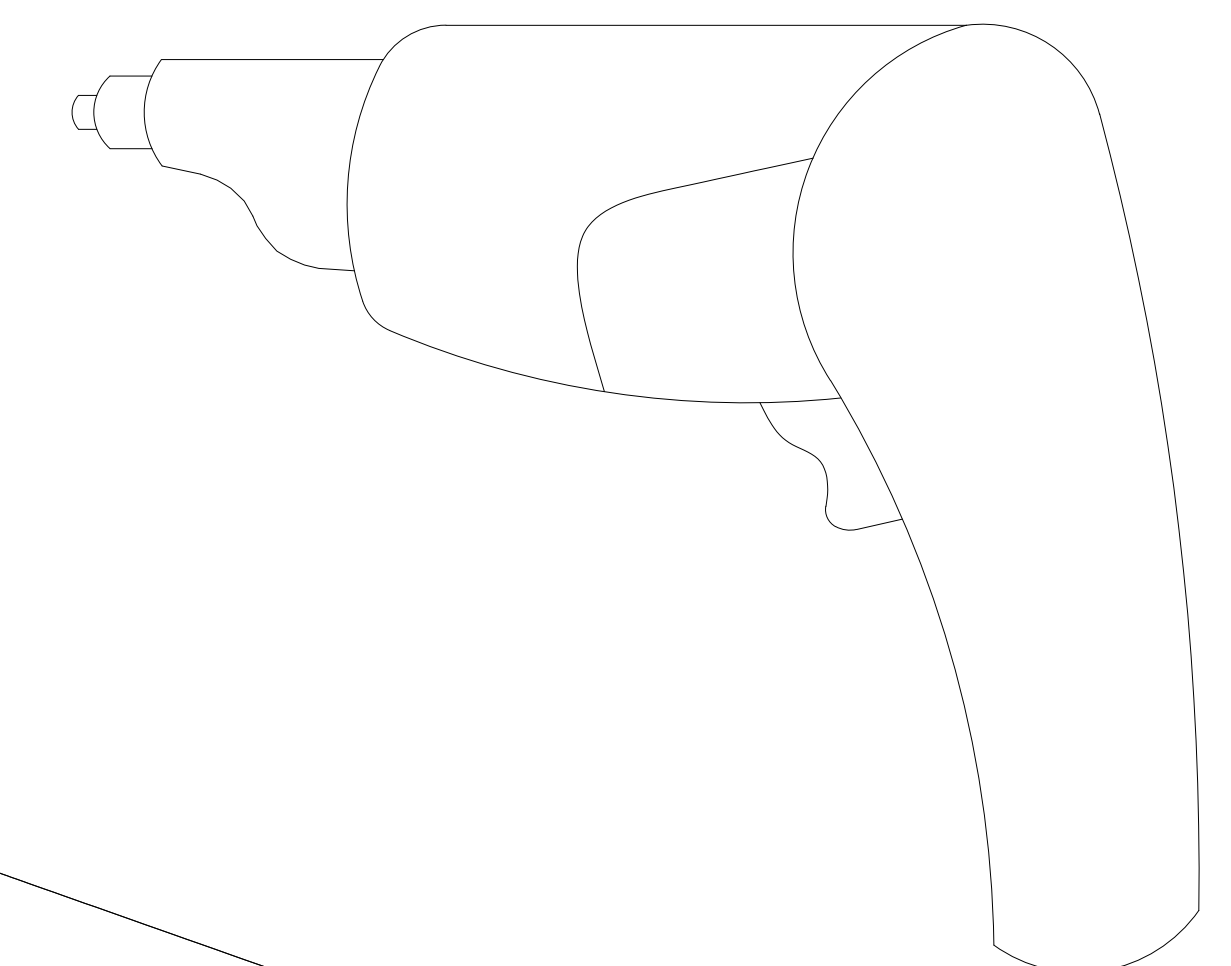
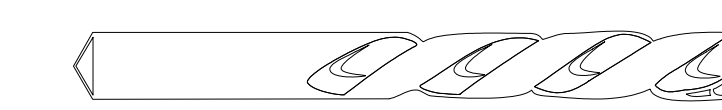

1R

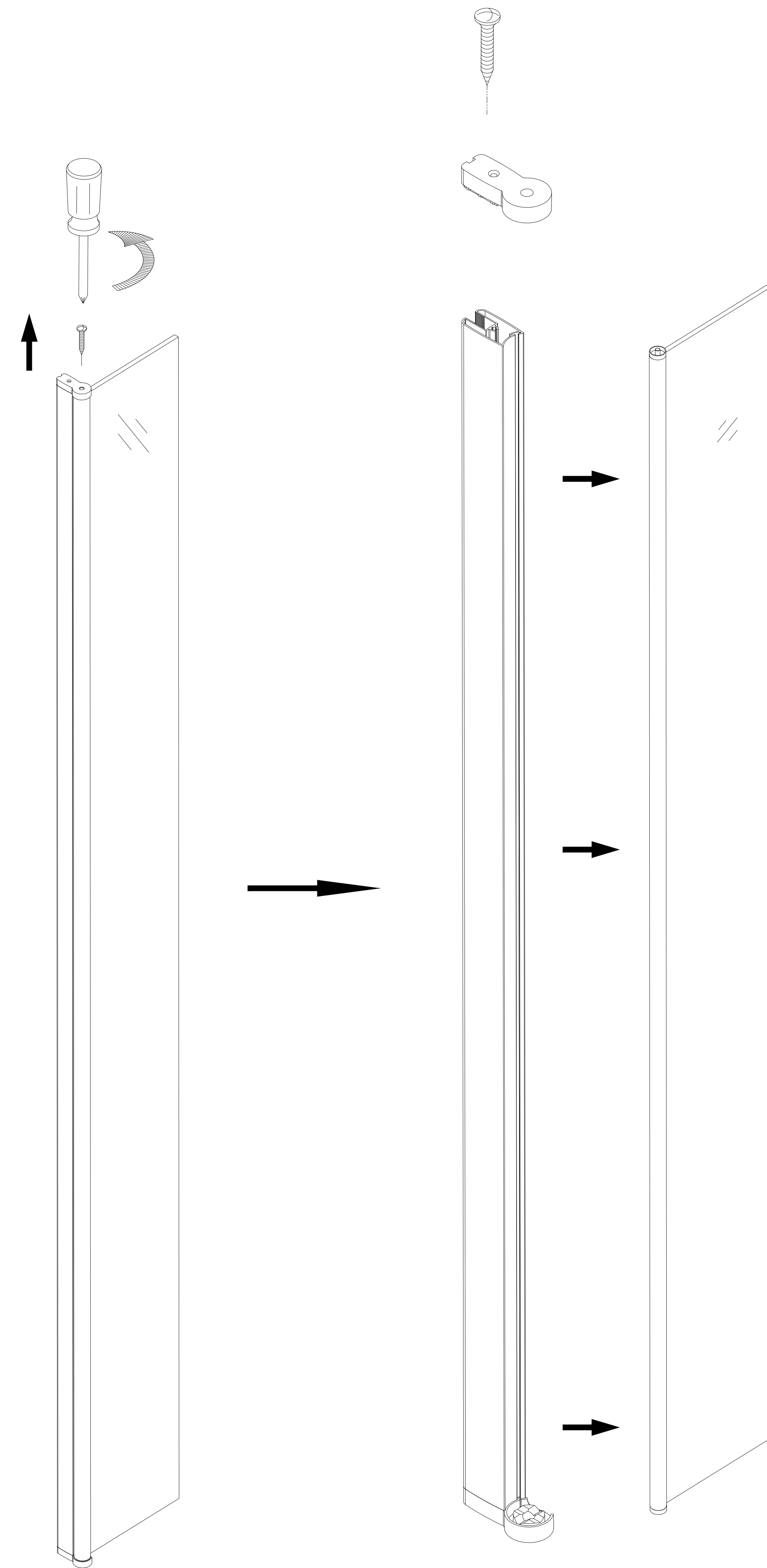

2R

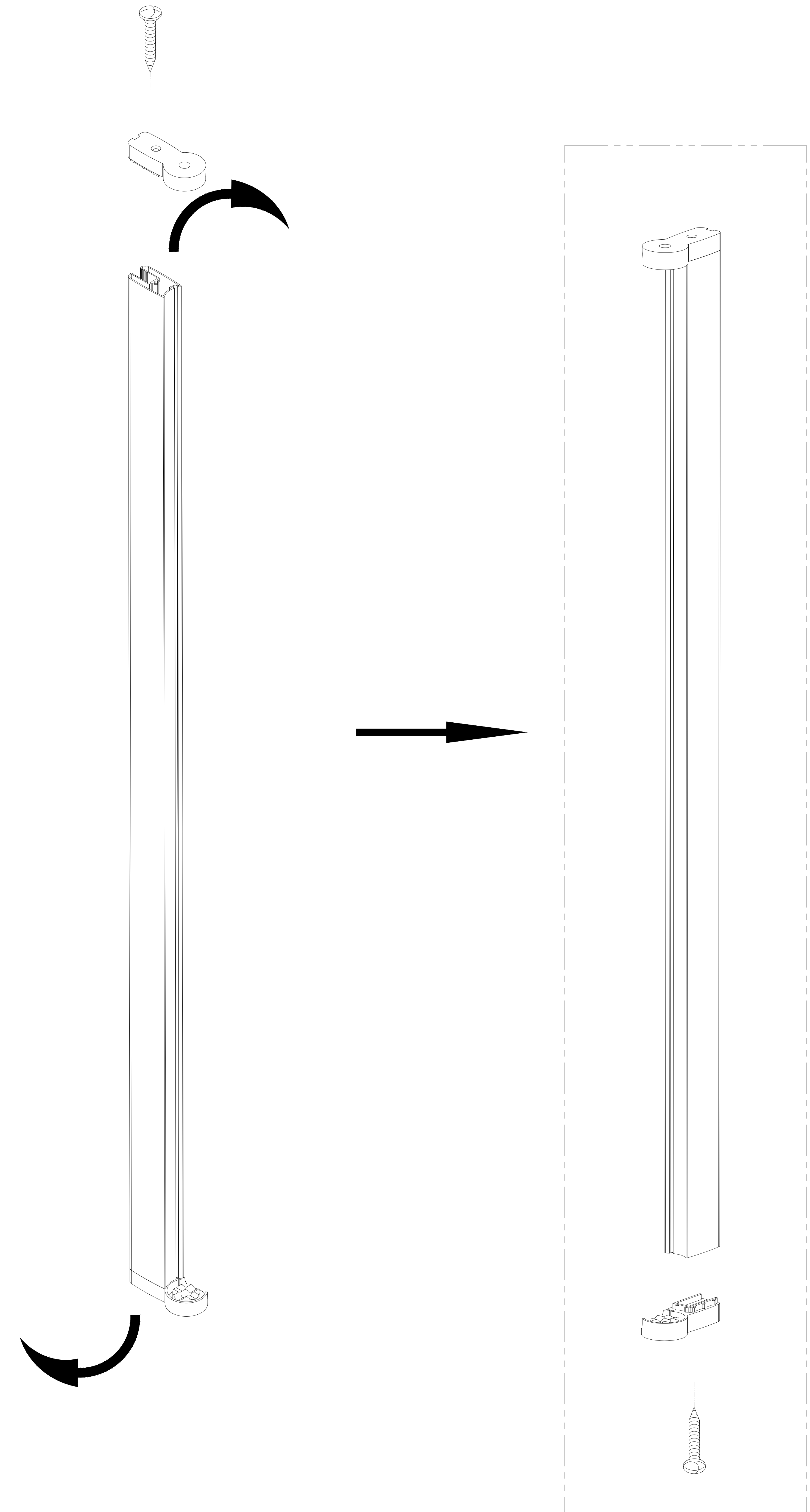

3R

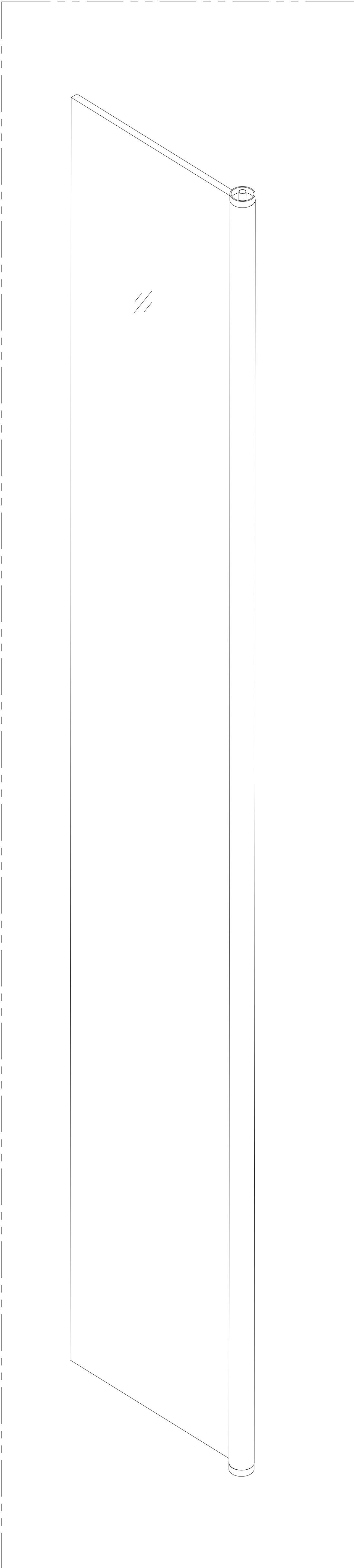
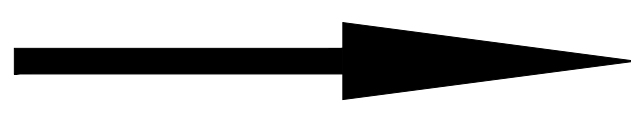
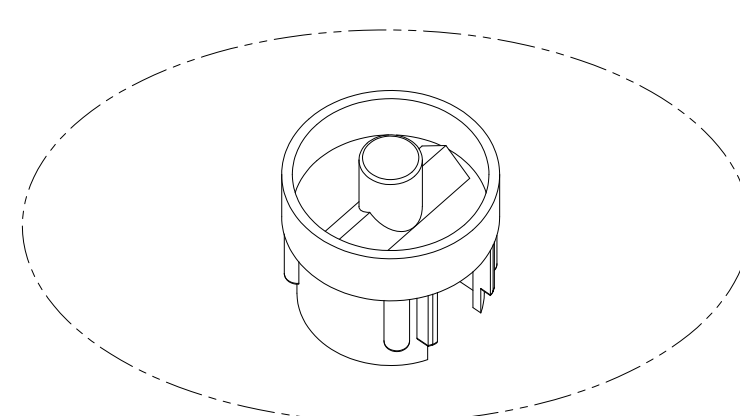
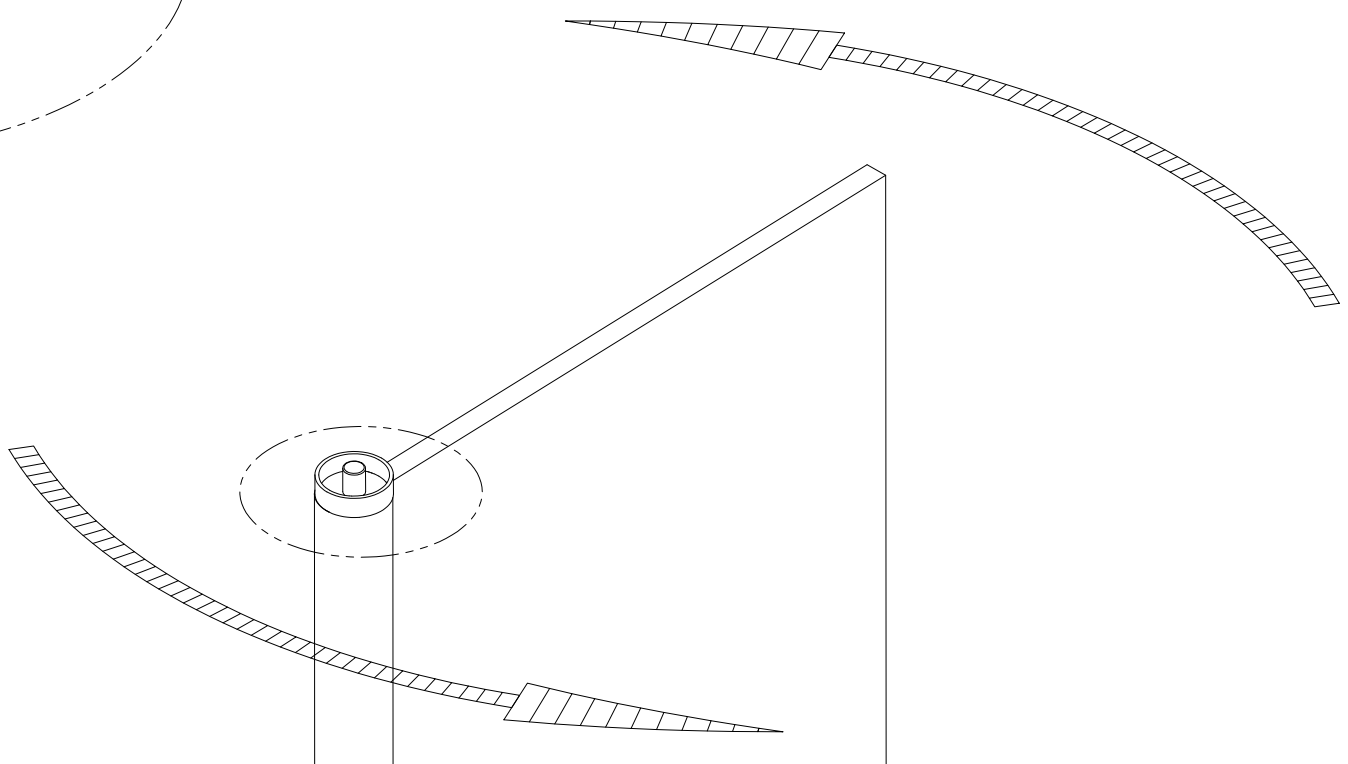
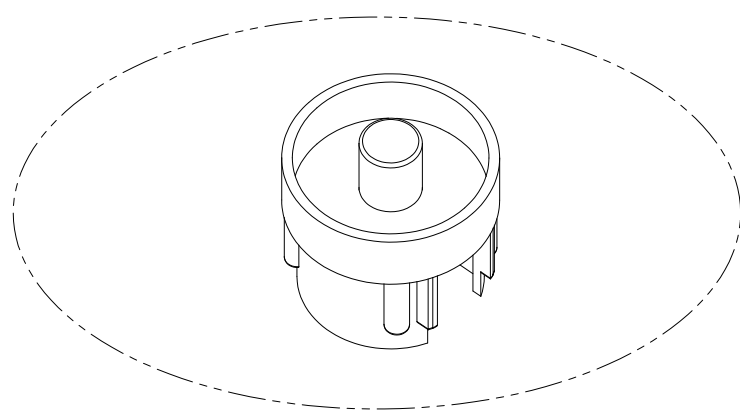

4R

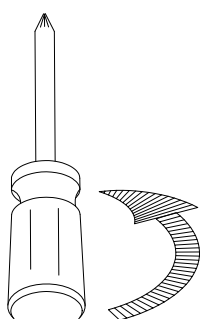
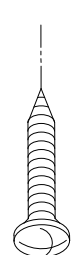
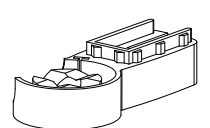
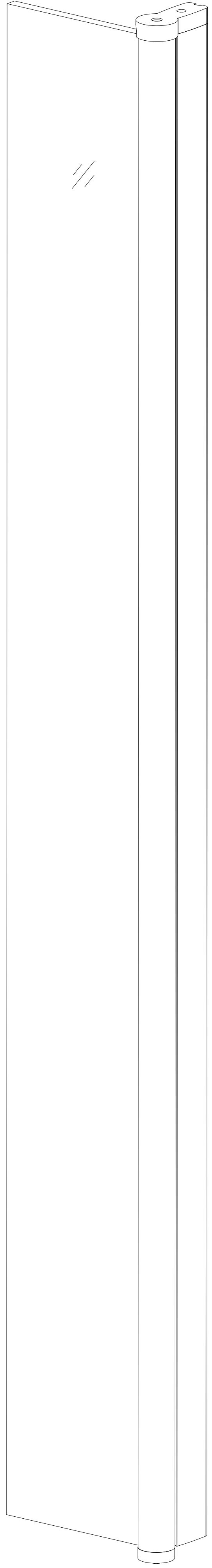
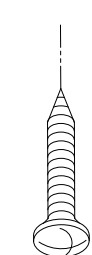
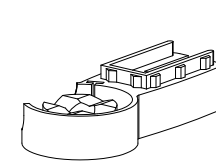
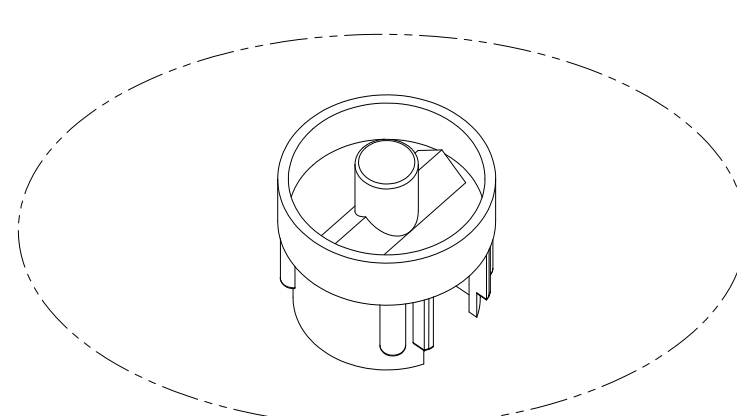
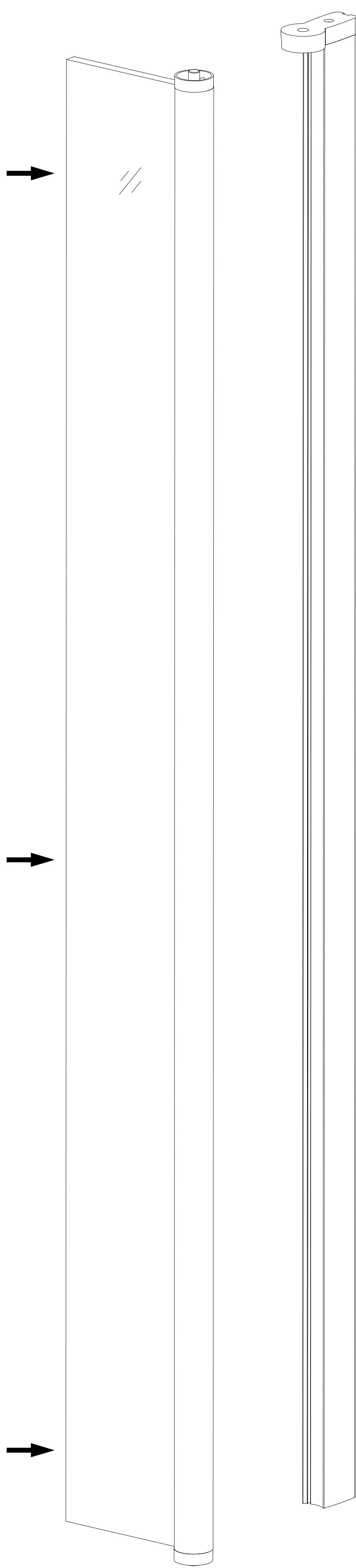
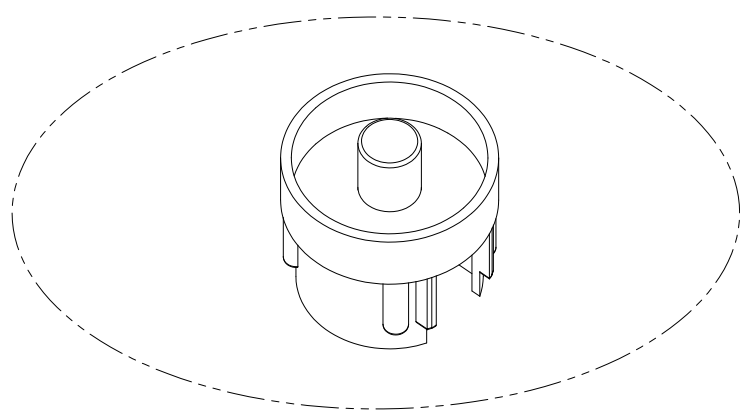

5R

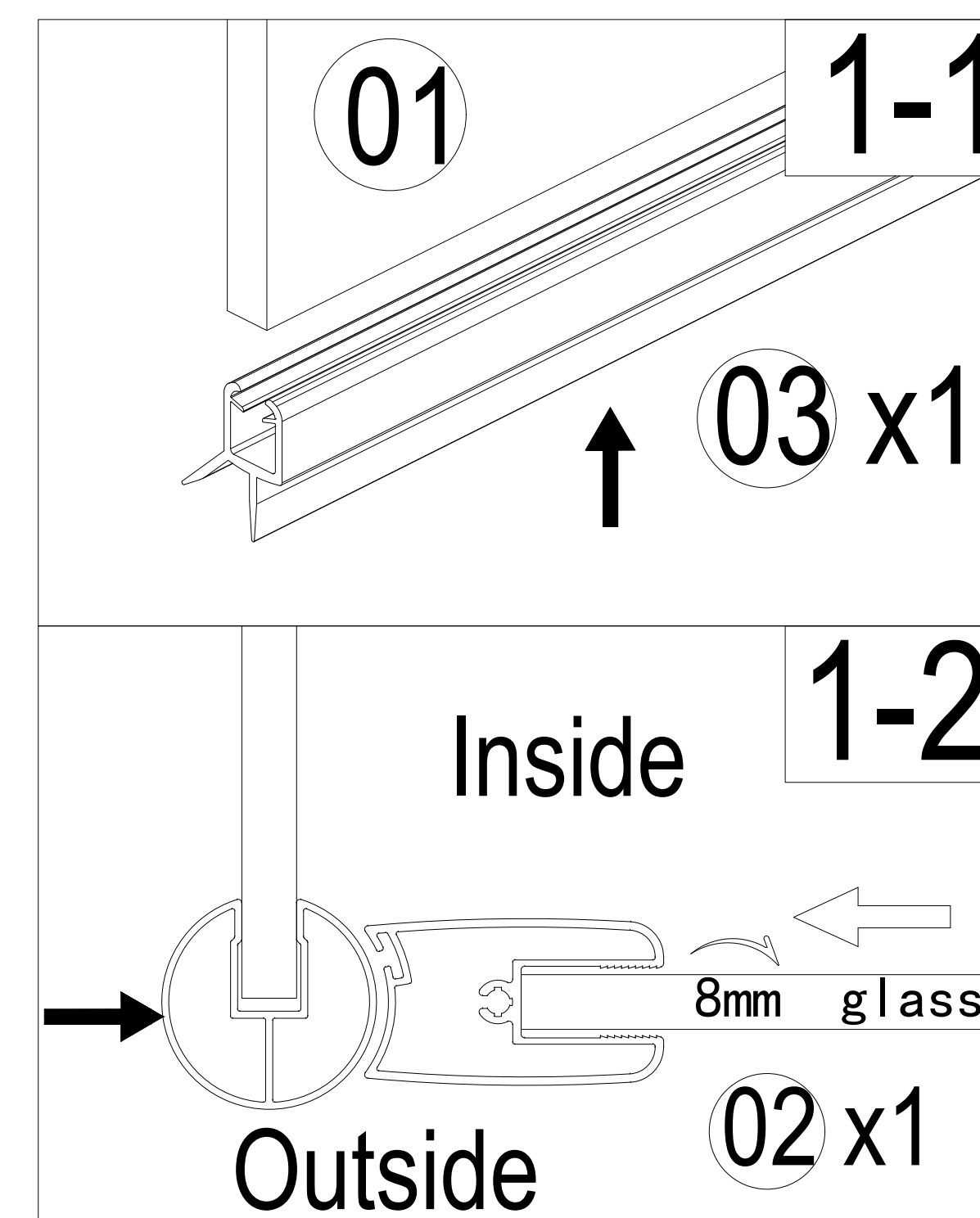
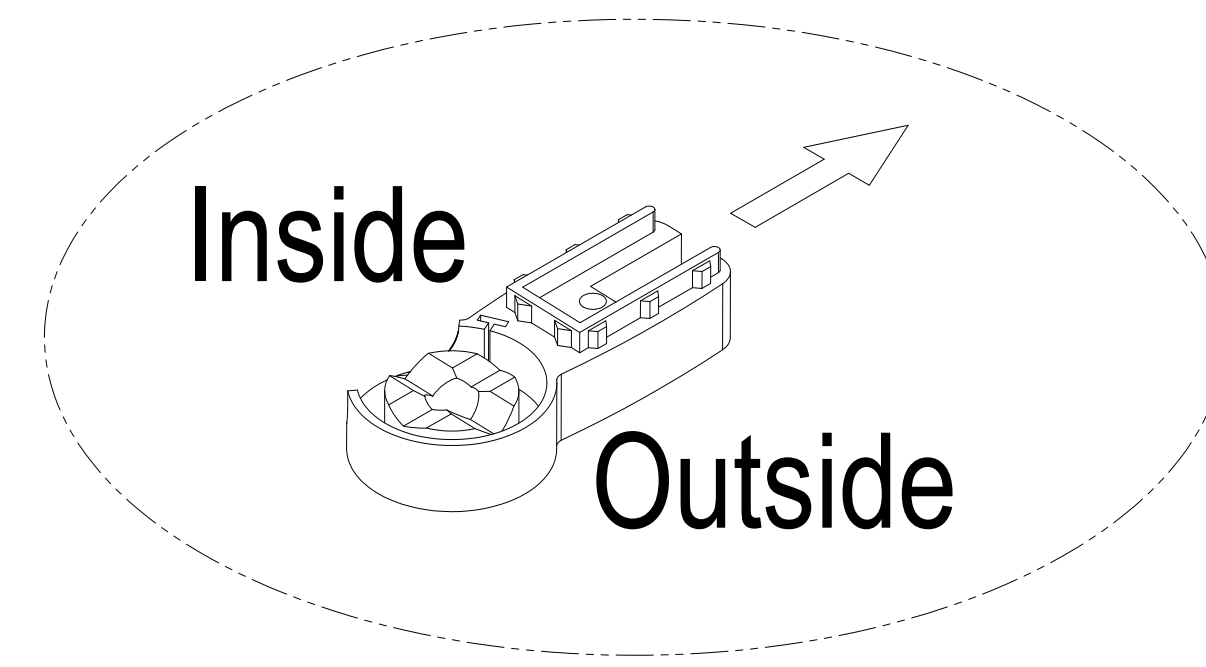
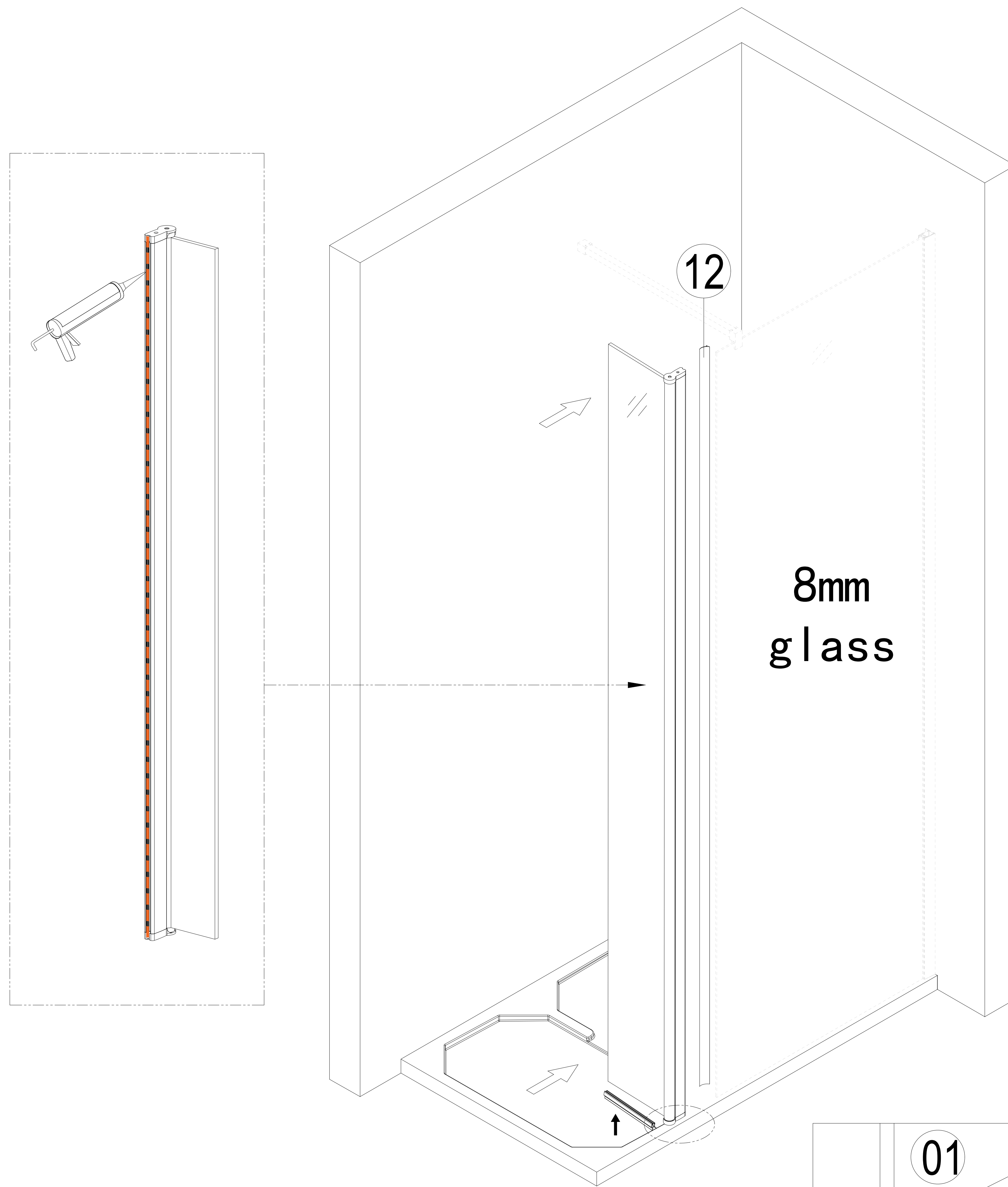

6R

Care Instructions:

Do not use your shower enclosure within 24 hours of assembly . Do not use caustic cleaning products or abrasive material whencleaning your shower enclosure.

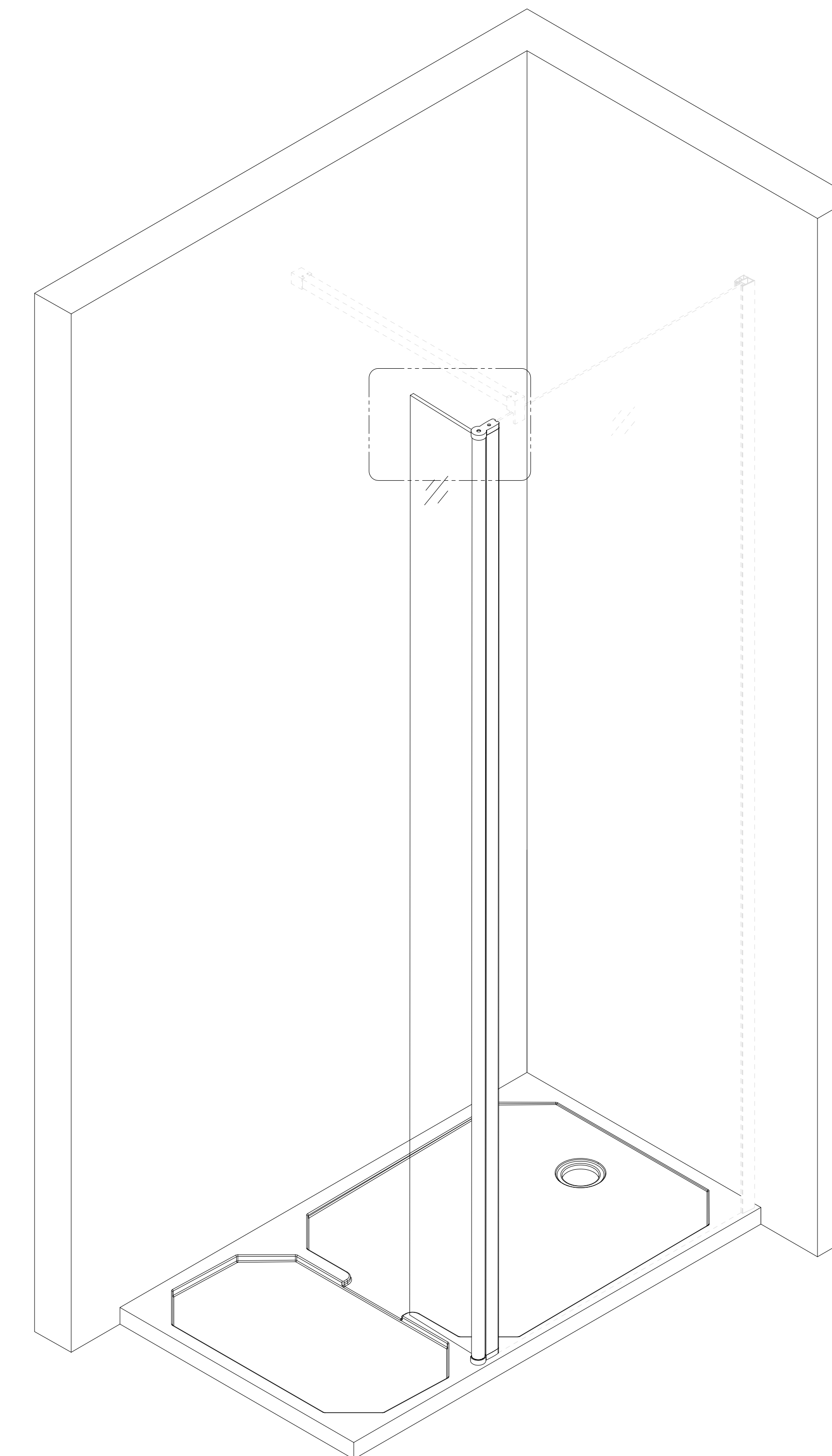
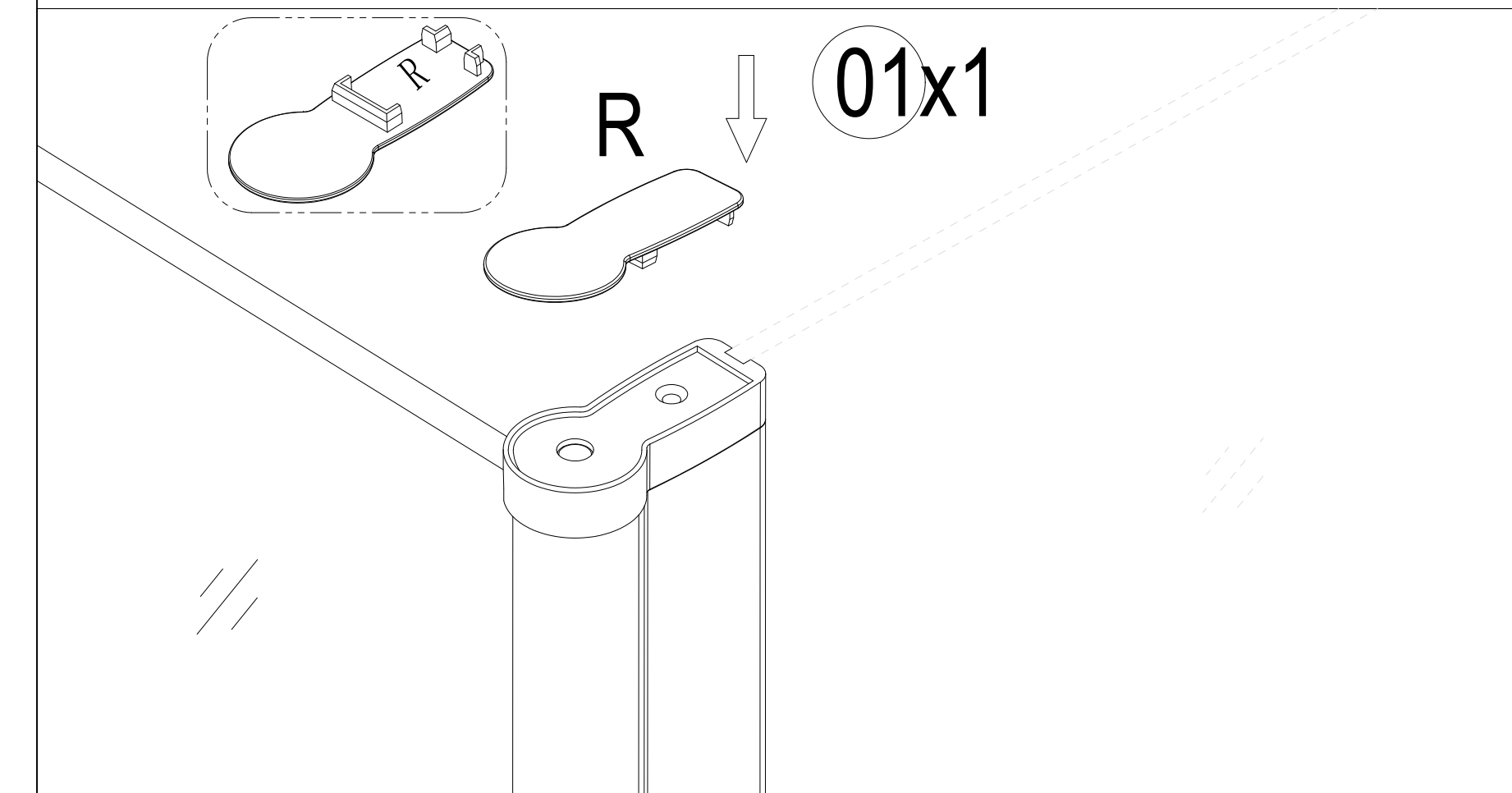



Eastbrook Road, Gloucester GL4 3DB

Technical Helpline: 01452 317890

Email: technical@eastbrookco.com

Cleaning and Maintenance of Shower Enclosures

Do not clean the shower enclosure with irritant detergents such as alcohol, bleach or other chemical cleaners.

Only clean with mild soapy water or a proprietary cleaner where the label advises it is suitable for the materials the enclosure is constructed from. Test on a small area first.

For treating limescale we would recommend distilled vinegar in a half and half solution with water.

Following installation should you find that there is a notable noise when the glass door moves you may add a small amount of silicon lubricant onto the roller wheels and tracks, hinges or clips.

It is the responsibility of the product owner to maintain the product as recommended above. Also, to check for parts which have broken or become loose to protect against failure of the enclosure.