

ASSEMBLY INSTRUCTIONS

1 Slide the mirror up.

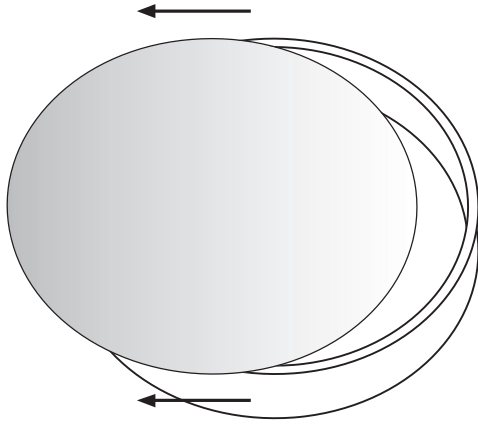

2 Screw the light box to the wall.

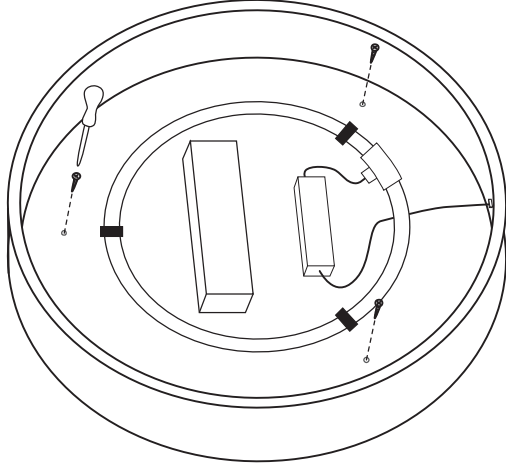

2A Changing of the bulb.

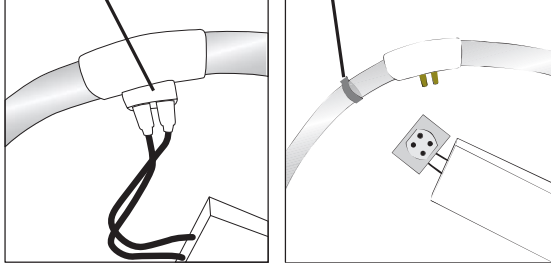

Disconnect switch

Switch out the hooks

3 Connecting instructions.

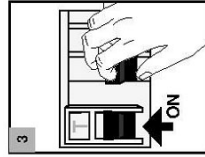
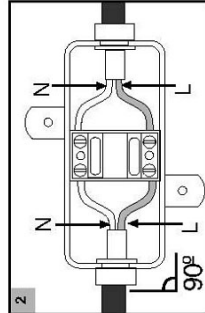
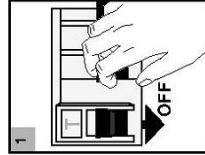
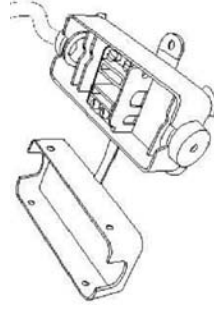

1. Turn off the general switch.
2. Connect the cables of the mains supply to the connecting set inside the box.
3. Turn on the general switch.

SECURITY VOLUMES

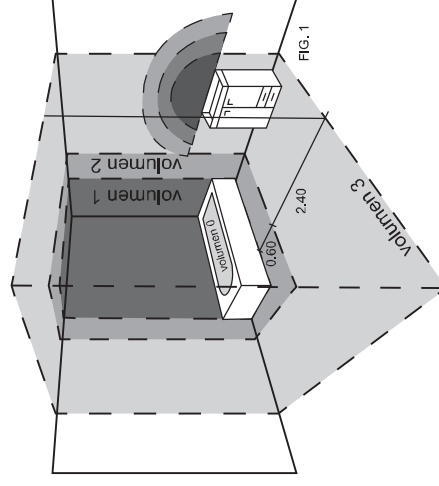

FIG. 1

The volumes shown in the figure are based on IEC-364-7-701.
 The measures may differ in accordance with the legislation currently in force in each country.