

# INSTALLATION MANUAL

| Eastbrook Code | Adjustment | Eastbrook Code | Adjustment |
|----------------|------------|----------------|------------|
| <b>69.0127</b> | 770-800    |                |            |
|                |            |                |            |
|                |            |                |            |
|                |            |                |            |

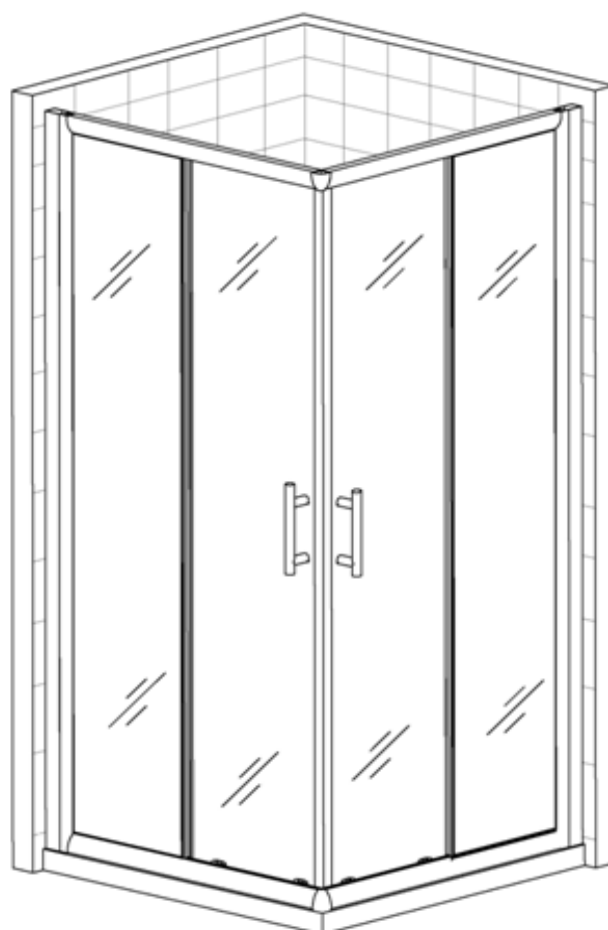

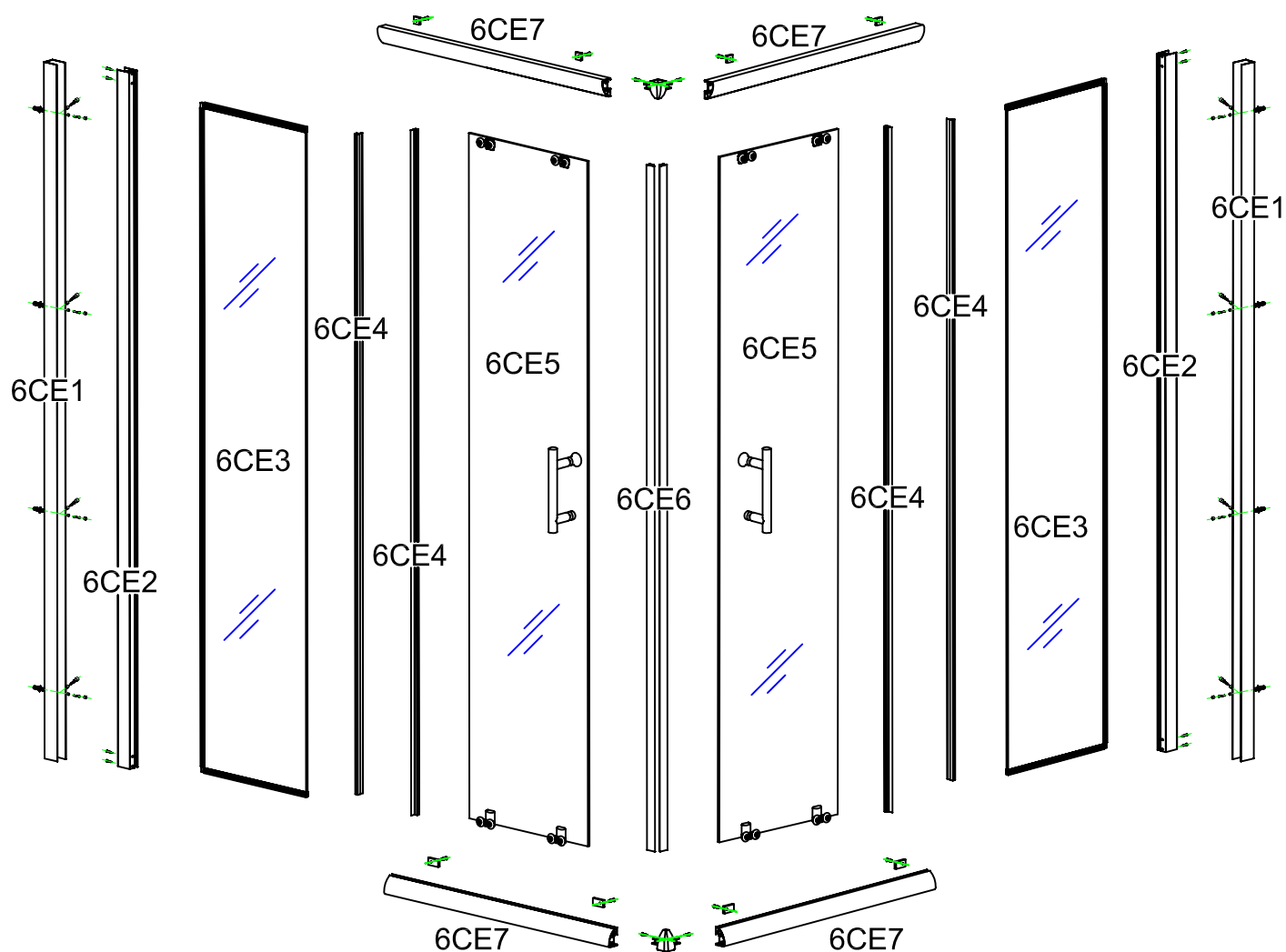

This product should only be fixed by a fully qualified installer

|   |  |   |   |                        |
|---|--|---|---|------------------------|
| <p>6CE8</p> <p>10</p> <p>ST4</p> <p>12X</p> | <p>6CE9</p> <p>30</p> <p>ST4</p> <p>8X</p> | <p>6CE10</p> <p>30</p> <p>ST4</p> <p>8X</p> | <p>6CE11</p> <p>8X</p>                      | <p>6CE12</p> <p>8X</p> |
| <p>6CE13</p> <p>2X</p>                      | <p>6CE14</p> <p>2X</p>                     | <p>6CE15</p> <p>8X</p>                      | <p>6CE16</p> <p>20</p> <p>ST4</p> <p>8X</p> |                        |

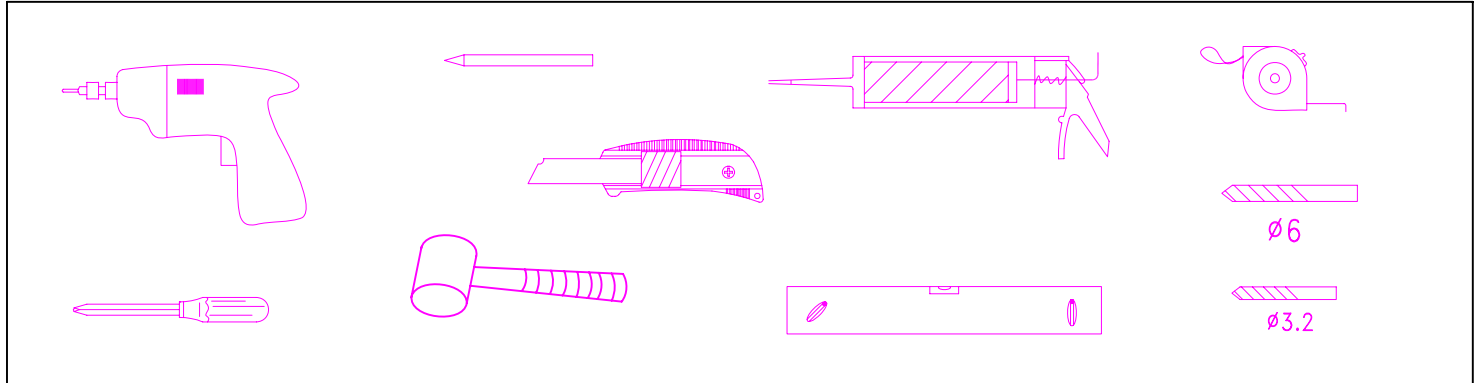

**1**

6CE1

1.1

1.1

1.2

1.2

2

6CE1

2.1

2.1

2.2

2.2

**3**

6CE1

3.1

3.1

**4**

6CE2 6CE2 6CE7 6CE7

4.1

4.1

4.2

4.2

**5**

6CE3 6CE4

5.1

5.1

5.2

5.2

**6**

6CE7 6CE7 6CE4 6CE4

6.1

6.1

6.2

6.2

6.3

6.3

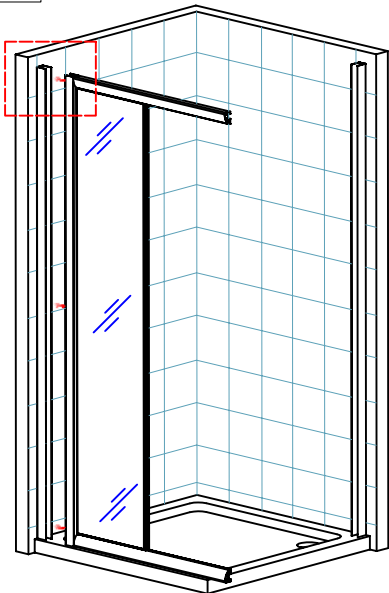
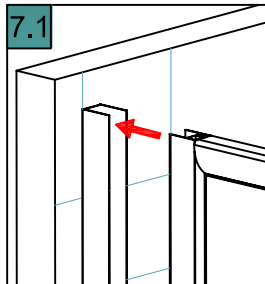
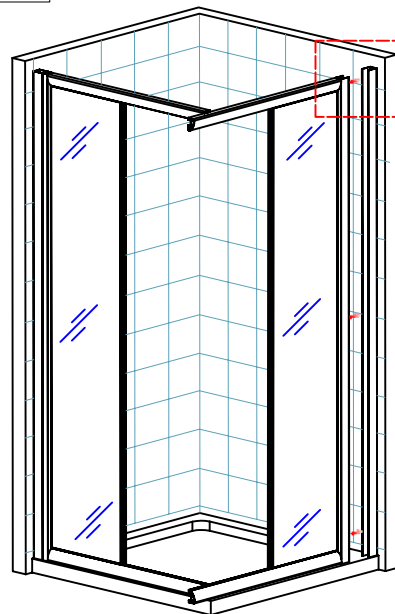
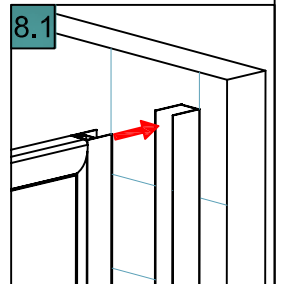
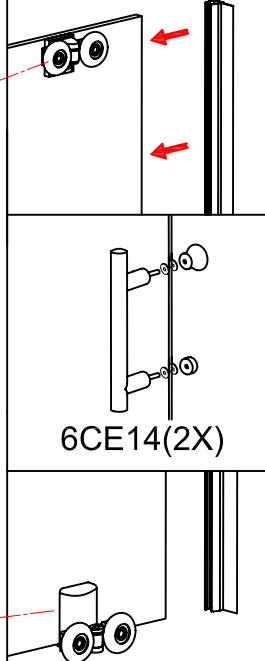
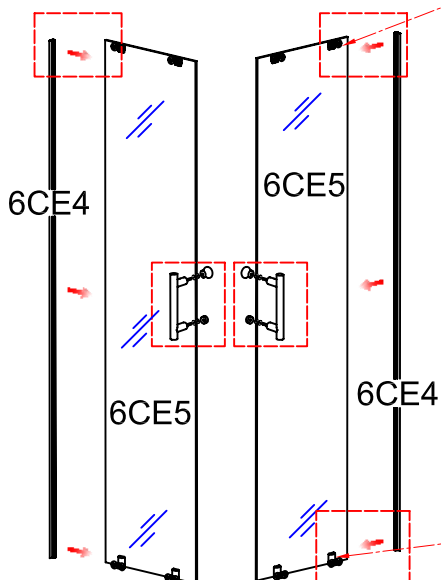
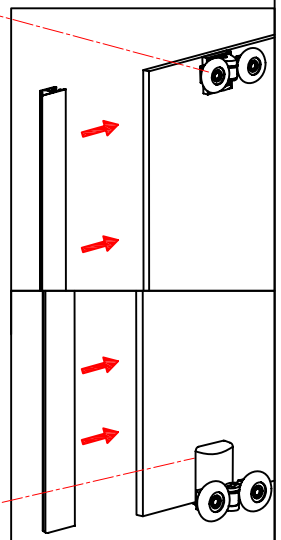
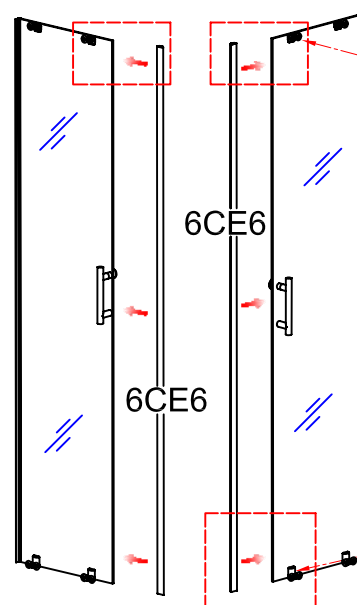
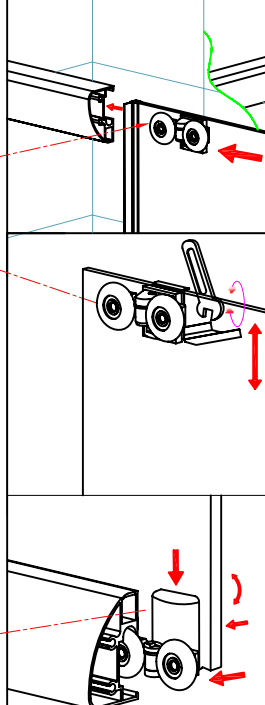
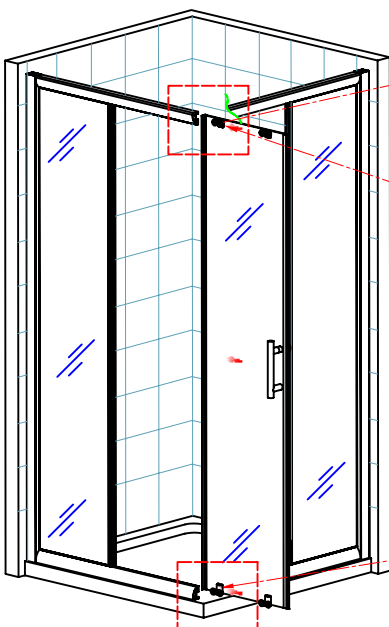
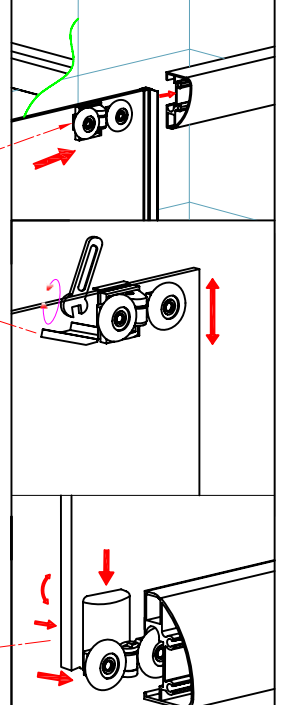
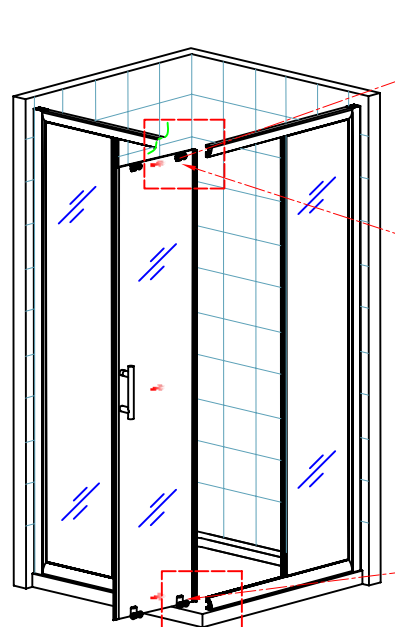
**7****7.1****8****8.1****9****10****11****12**

# 13

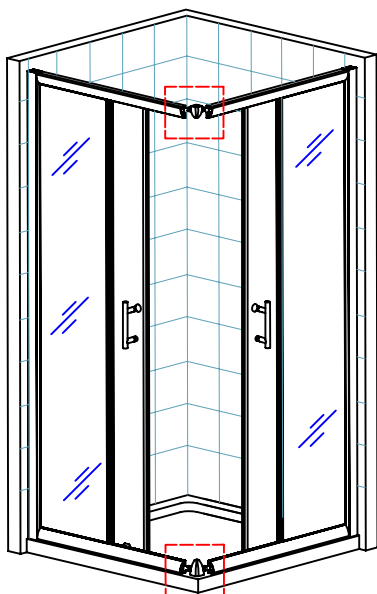

13.1

6CE13(2X)

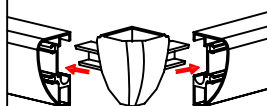

# 14

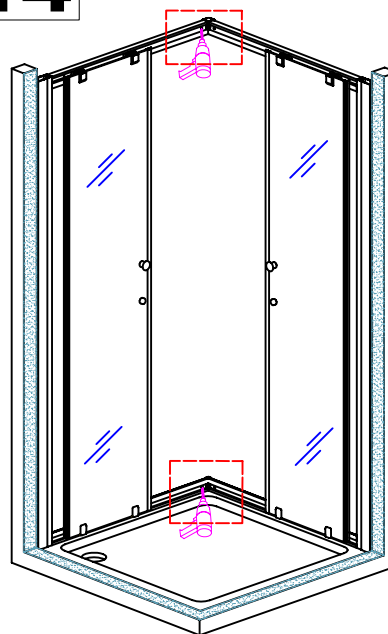

14.1

Ø3.2mm

14.2

6CE8(4X)

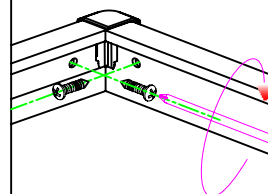

# 15

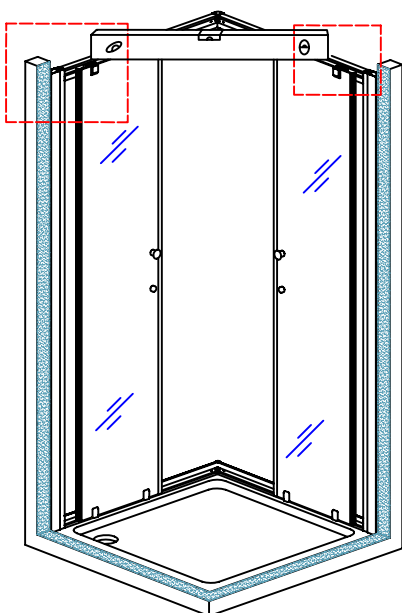

15.1

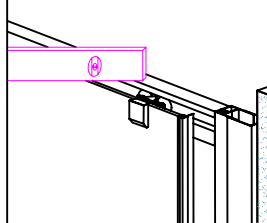

# 16

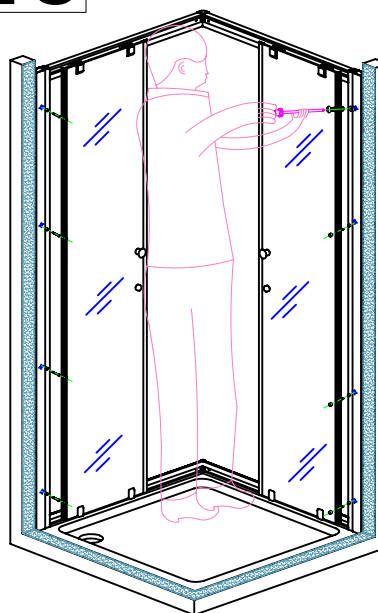

16.1

Ø3.2mm

16.2

6CE8(8X)  
6CE12(8X)

16.3

6CE12(8X)

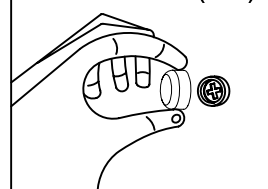

# 17

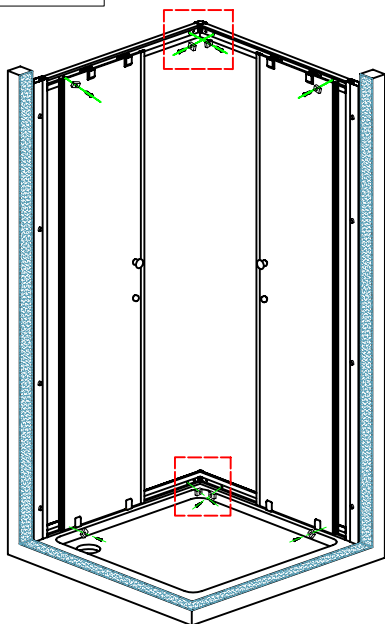

17.1

6CE15(4X)

17.2

6CE15(4X)

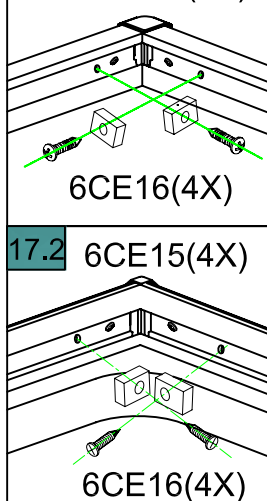

# 18

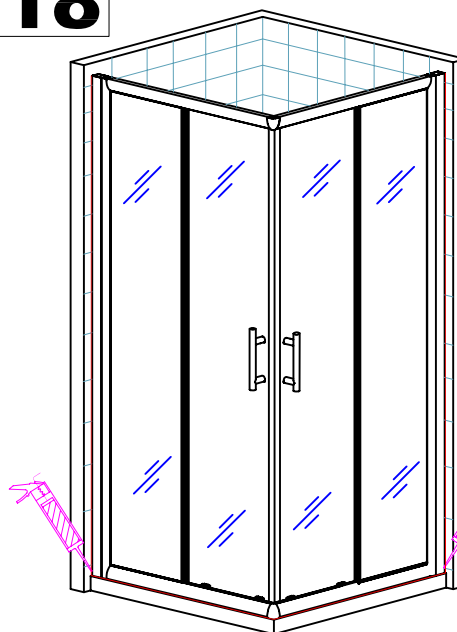

SILIKON

Silicone on the outside of the screen only



**Eastbrook Co**

Eastbrook Road  
Gloucester GL4 3DB

[www.eastbrooktrade.com](http://www.eastbrooktrade.com)

## **Cleaning and Maintenance of Shower Enclosures**

**Do not clean the shower enclosure with irritant detergents such as alcohol, bleach or other chemical cleaners.**

**Only clean with mild soapy water or a proprietary cleaner where the label advises it is suitable for the materials the enclosure is constructed from, test on a small area first.**

**For treating limescale we would recommend distilled vinegar in a half and half solution with water.**

**Following installation should you find that there is a notable noise when the glass door moves you may add a small amount of silicone lubricant onto the roller wheels and tracks, hinges or clips.**

**It is the responsibility of the product owner to maintain the product as recommended above. Also to check for parts which have broken or become loose to protect against future failure of the enclosure or screen.**

**Technical Helpline: 01452 317890**

**Open Mon-Fri 8am to 5pm**

**[technical@eastbrookco.com](mailto:technical@eastbrookco.com)**