

INSTALLATION INSTRUCTIONS

Applicable Products:

27.0541/27.0551 Belgravia WC Pan and Cistern
 27.0581/27.0591 Cheltenham WC Pan and Cistern
 27.0501/27.0511 Ferrara WC Pan and Cistern
 27.0301/27.0331 Kompact WC Pan and Cistern
 27.0011/27.0021 Loire WC Pan and Cistern
 27.0651/27.0671 Tamarind WC Pan and Cistern
 27.0431/27.0441 Tempo WC Pan and Cistern
 27.0811/27.0821 Cheverney WC Pan and Cistern
 27.0881 Type 55 Corner Cistern
 27.0861 Elysee Cistern
 27.0871 Courchevel Cistern

Please Note: Ensure these instructions are followed carefully. If you are unsure about any aspect of the installation, please consult a qualified installer. In the event of any problem with the performance of this equipment, please check installation before consulting your supplier. *** DO NOT USE CHLORINE (BLEACH) OR RELATED PRODUCTS**

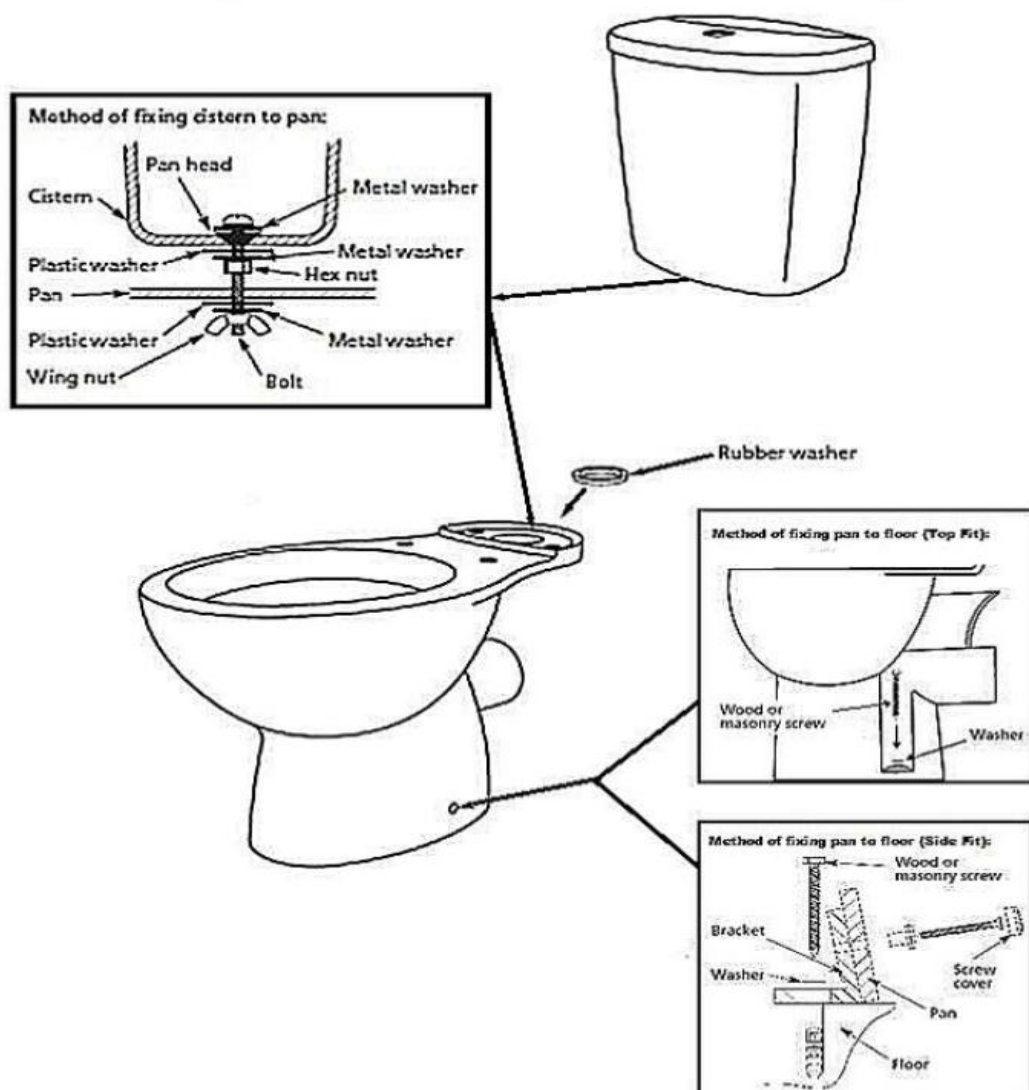

The above products are covered for 12 months warranty