

HOME

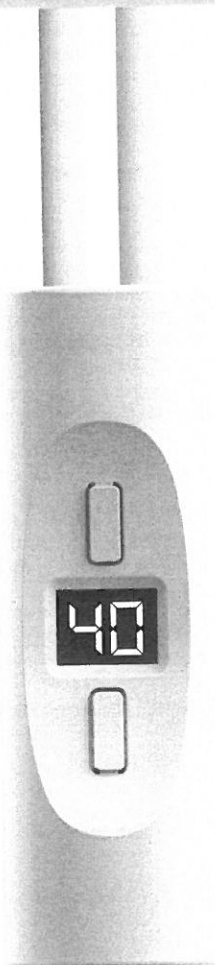

HEAT SYSTEM

HEATER
CONTROLLER
-
VERTICAL



+
REMOTE
CONTROLLER

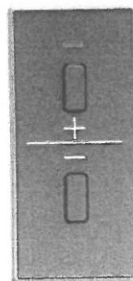

GUIDE & USER MANUAL

HEATER CONTROLLER H+ | REMOTE CONTROLLER H+R



SAFETY:

1. **The heater should be installed by a qualified person.**
2. Bathroom radiators fitted with electric heaters should be fixed not less than 60 cm from a bath, shower or wash basin, and never above a bath.
3. For the heater permanently connected (hard wire) there must be applied a cut-off device from the mains. Such a device must disconnect the heater from the supply mains in 2 poles, with contact separation of at least 3 mm.
4. This appliance can be used by children aged from 8 years and above and persons with reduced physical, sensory or mental capabilities or lack of experience and knowledge if they have been given supervision or instruction concerning use of the appliance in a safe way and understand the hazards involved
5. Children shall not play with the appliance. Cleaning and user maintenance shall not be made by children without supervision.
6. **The heater MUST BE DISCONNECTED before cleaning the casing. AVOID SOAKING THE CASING.**
7. One radiator valve must always be open when a heater is in use (liquid thermal expansion).

CAUTION: To avoid the risk of fire or electric shock the heater should be protected from water spray or flooding. This appliance is not intended for use by persons (including children) of limited physical, sensory or mental abilities, or persons inexperienced or not familiar with the appliance, unless supervised or instructed on the appliance use by persons responsible for their safety. Particular attention should be paid to children, to preclude playing with the appliance by them. Exclamation mark on triangular field signals:  **information important for the user.**

CAUTION: electric shock hazard!, lightning mark ended with arrow on triangular field 

CAUTION: in order to reduce electric shock hazard, do not remove the casing (nor its rear cover). There are no user-serviceable parts inside the appliance; the product must be returned to the manufacturer for repair via the distributor who sold the product.

GUARANTEE TERMS:

Guarantee is granted by manufacturer for 24 months period starting from date of sale, but no longer than 36 months from date of the heater manufacture. Defects revealed within this period, resulting from a fault of manufacturer will be repaired free of charge or the item replaced with new, equivalent one. Term of complaints' investigation up to 14 (fourteen) days from date of submission to the manufacturer.

Guarantee does not cover:

1. Using of product in a manner noncompliant with attached instructions.
2. Any visible damage to the heating element or controller due to improper use. Damaging of manufacturer's seals makes the guarantee null and void.

In the event that Heatpol are unable to repair or replace this product we reserve the right to refund the purchase price as an alternative.

GUARANTEE CARD

Serial No.:

Date of sale:

Stamp of retail outlet, signature of seller



Mników 322, 32-084 Morawica, Poland
Tel/fax: +48 12 656 44 91

MADE IN EU

Caution: The guarantee card should be legibly filled in retail outlet. Any corrections on the guarantee card will invalidate the guarantee. Guarantee card valid only with proof of purchase.

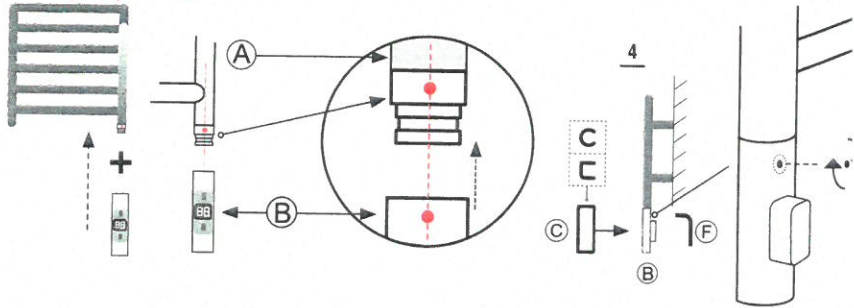

Electric radiators

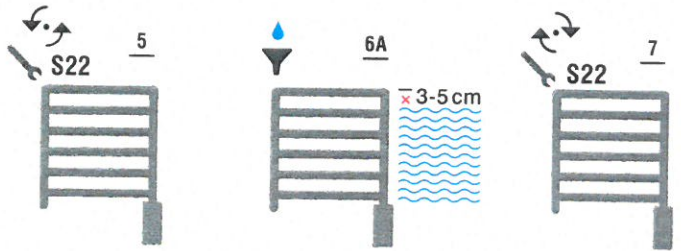

CH system

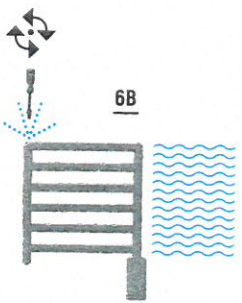

Finishing

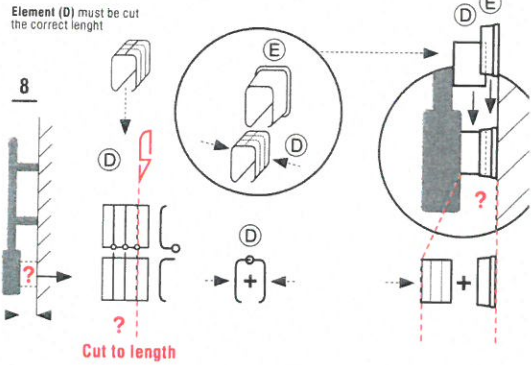

For the heater permanently connected (hard wire) there must be applied a cut-off device from the mains. Such a device must disconnect the heater from the supply mains in 2 poles, with contact separation of at least 3 mm

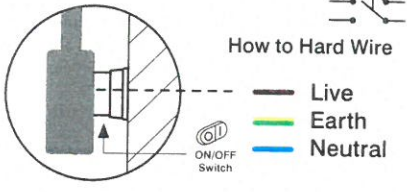
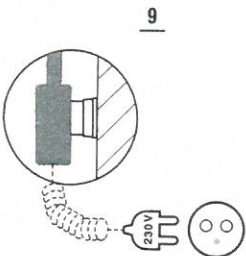

USER MANUAL: How to use heater controller (optional remote controller)

VIDEO available at www.homeplus-system.com

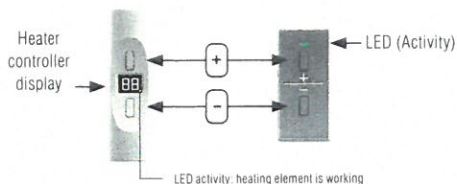

Heater controller

Remote controller

Heater controller



Remote controller

Push for pairing button using allen key to activate the controller. Locate suitable place to mount the

When switched to an ambient temperature control, a remote control is simultaneously a temperature sensor

Back

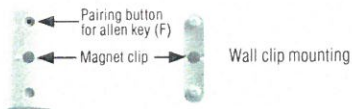

1



Run the controller

Hold upper button for 3 seconds

Switch off the controller

Hold lower button for 5 seconds

40°C
Standard heating temperature

2



20°C - 65°C
Select temperature

3

TURBO mode activation



TURBO mode activation - max heating temperature
Hold button for 3 seconds



b1-b2-b3 Max heating temperature, **selection for 1/2/3 hours**

b0 Off selection

USER MANUAL: How to use remote controller (to control the heater controller)



LED (Activity)

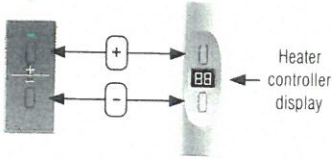

Heater controller display

Remote controller

Heater controller

Remote controller

Push for pairing button using allen key to activate the controller
Locate suitable place to mount the clip

When switched to an ambient temperature control, a remote controller is simultaneously a temperature sensor

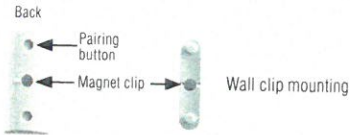

Heater controller



Turn ON the controller



1

START: Heater controller and remote controller pairing

If you bought a remote controller together with H+heater you do not need to pair it!

Prepare remote controller + allen key for use

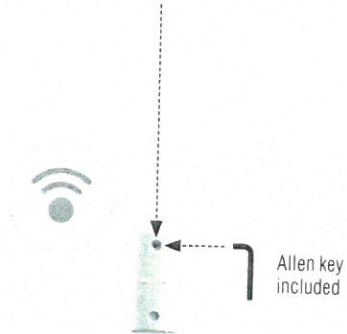
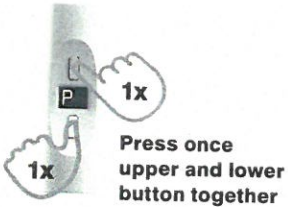

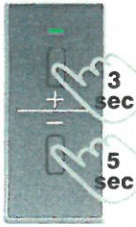

Run the heater controller via remote controller

Hold upper button for 3 seconds



Switch off the controller via remote controller

Hold lower button for 5 seconds

40°C

Standard heating temperature

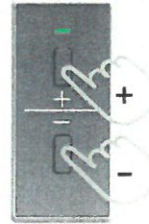

20°C - 65°C
Select temperature

TURBO mode activation



TURBO mode activation - max heating temperature
Hold button for 3 seconds

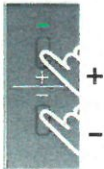

b1-b2-b3 Max heating temperature, **selection for 1/2/3 hours**

b0 Off selection

Settings water or ambient temperature

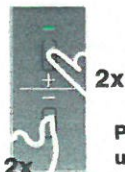

Press twice upper and lower button together



Temperature selection.

H Water temperature

A Ambient temperature

* Remote controller is an ambient temperature sensor

