

(Please leave this instruction leaflet with the end user)

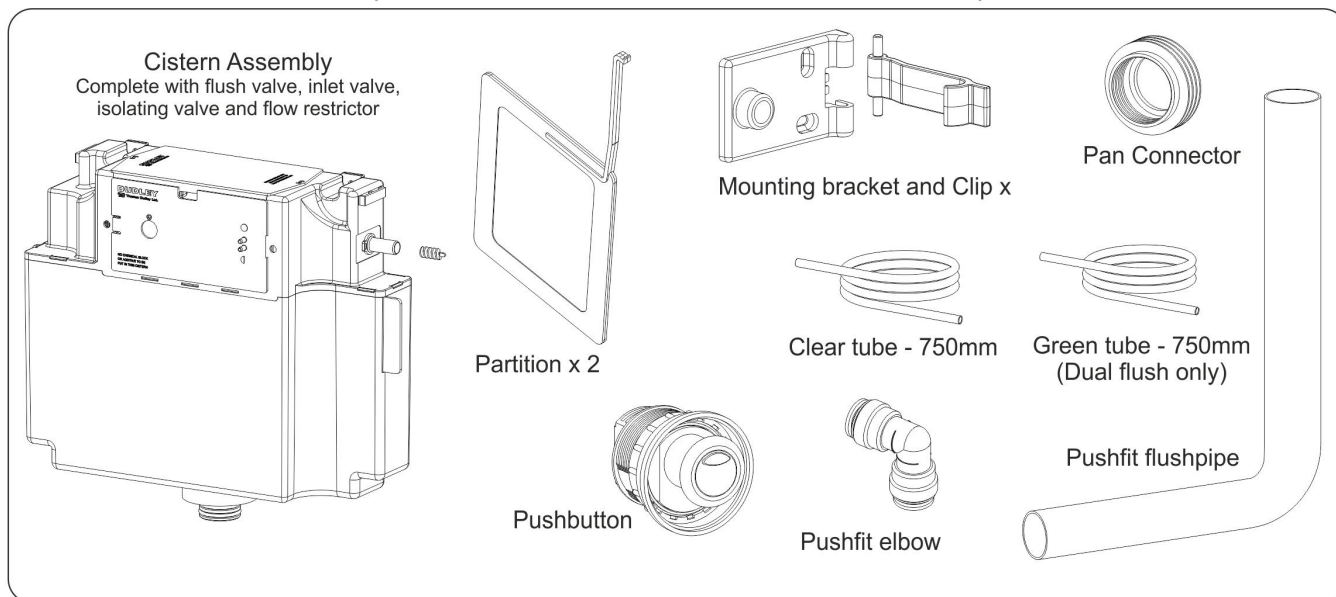

1 - Fitting the Cistern -

1.1 - Prior to installation ensure there is sufficient room for the cistern and any support frame, push button etc. to be fitted without interference.

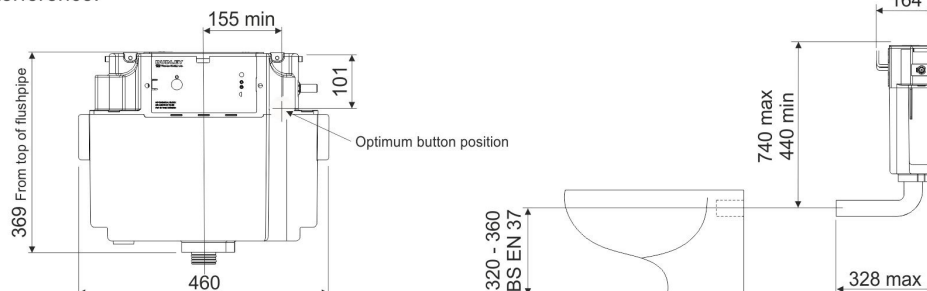

1.2. Changing the capacity of the cistern (if required)

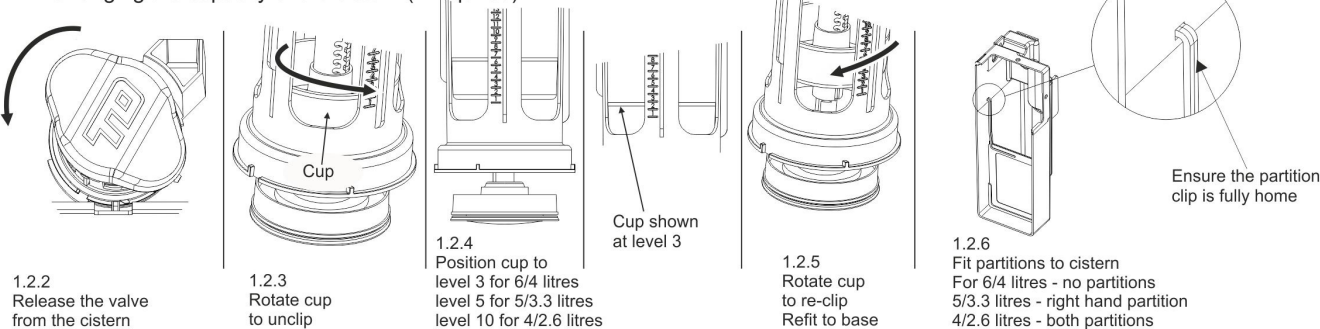

1.3 - Fitting the mounting brackets

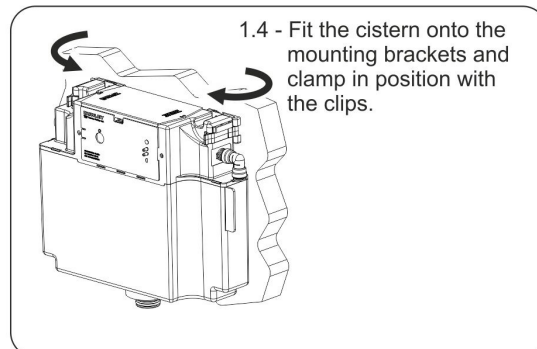
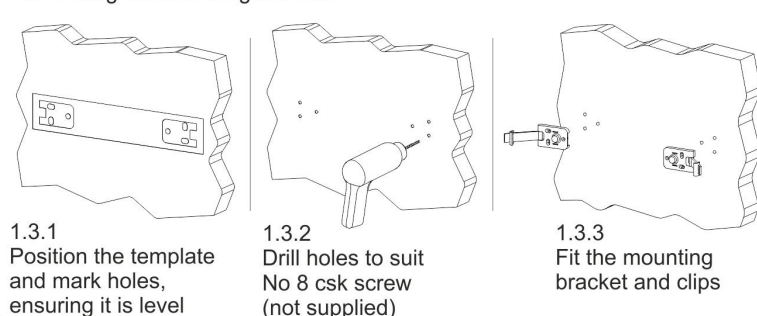

4.4 - Detach inlet valve from clip and pull to the right.

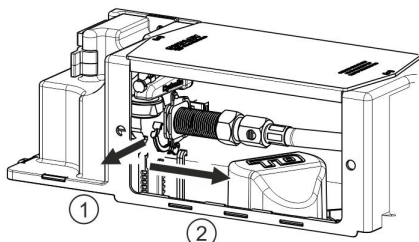

4.5 - Manoeuvre valve through service aperture.

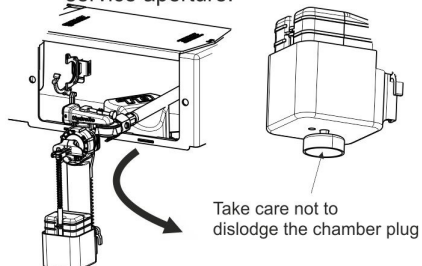

4.6 - Remove front nut.

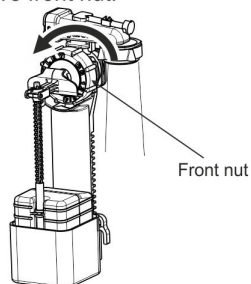

4.7- Remove filter from valve, wash with clean water and re-assemble.

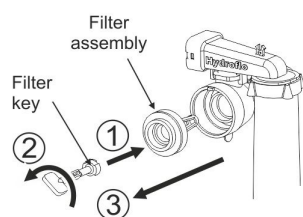

4.8- Ensure the float chamber is in position shown. If necessary press tabs to reposition

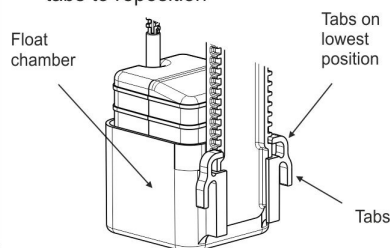

4.9 - Replace inlet valve, turn on water supply, and check water level.

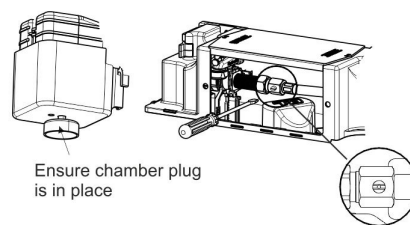

5 - Maintenance of the outlet valve -

5.1 - Turn off water supply.

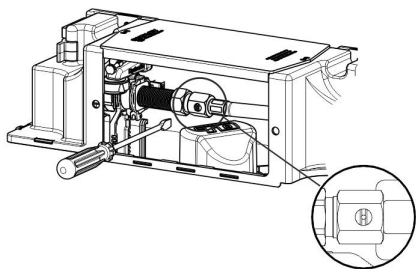

5.2 - Empty cistern.

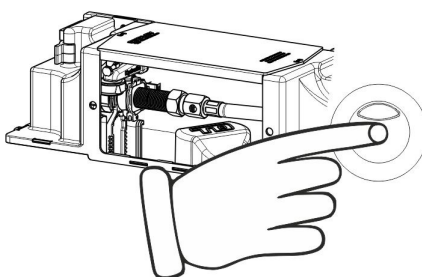

5.3 - Remove inlet valve as shown above.

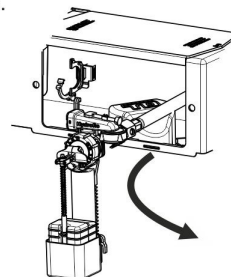

5.4 - Release flushvalve from base.

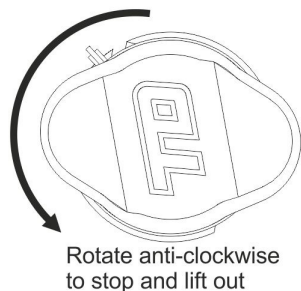

5.5 - Remove flush valve from cistern

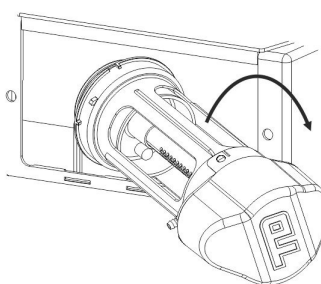

5.6 - Wash seal in clean water.

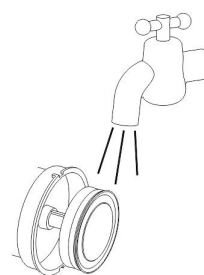

5.7 - Clean sealing face of valve body.

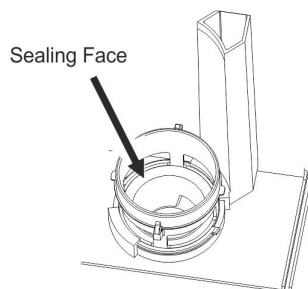

5.8 - Re-assemble and turn on water supply.

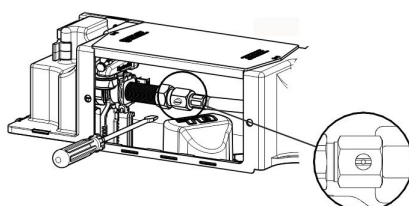

Eastbrook
Company

Eastbrook Co
Eastbrook Road
Gloucester
GL4 3DB

1 - Fitting -

1.1 Mark position of button ensuring there is no interference with cistern, support frame etc.

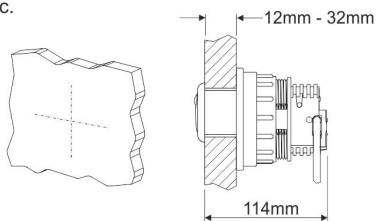

1.2 Cut hole.

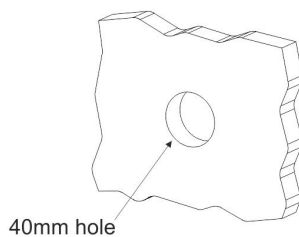

1.3 Fit button assembly into panel and attach surround.

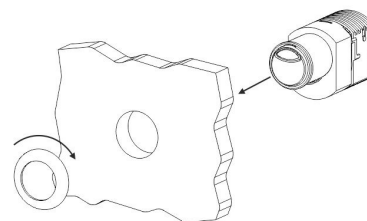

1.4 Screw collet into nut.

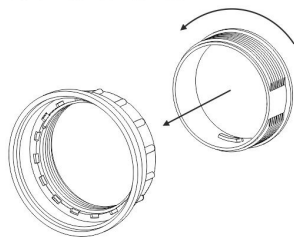

1.5 Locate collet and nut assembly into the slots on the button assembly.

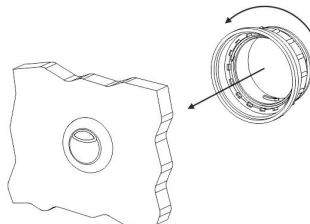

1.6 Tighten nut until assembly is clamped in position.

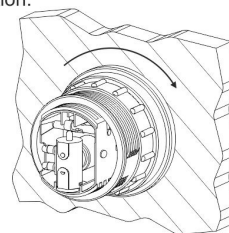

2 - Connecting pneumatic tubes -

Move to section 2.

2.1 Dual Flush - Cut pneumatic tubes to the minimum working length. Ensure tubes are not kinked or stretched.

Clear tube =
full flush.



Green tube =
partial flush.

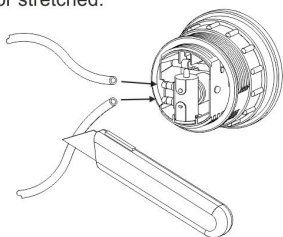

2.2 Single flush - Cut pneumatic tube to the minimum working length. Ensure tube is not kinked or stretched.

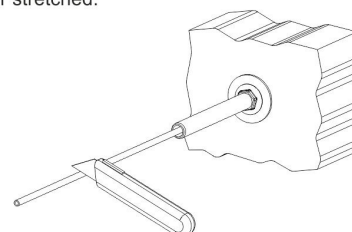
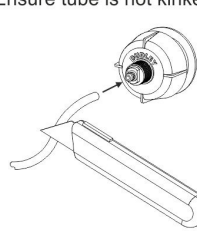

3 - Operation -

3.1 Dual Flush - On reduced flush the large button will also travel when the small button is pressed. Allow time for cistern to fill before flushing.

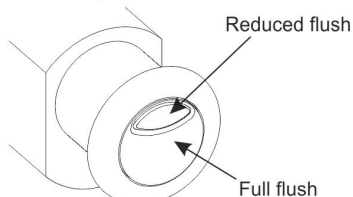

Note - the buttons may return slowly after operation, this is quite normal.



Eastbrook Co
Eastbrook Road
Gloucester
GL4 3DB

Pushbutton

DUAL FLUSH BUTTON

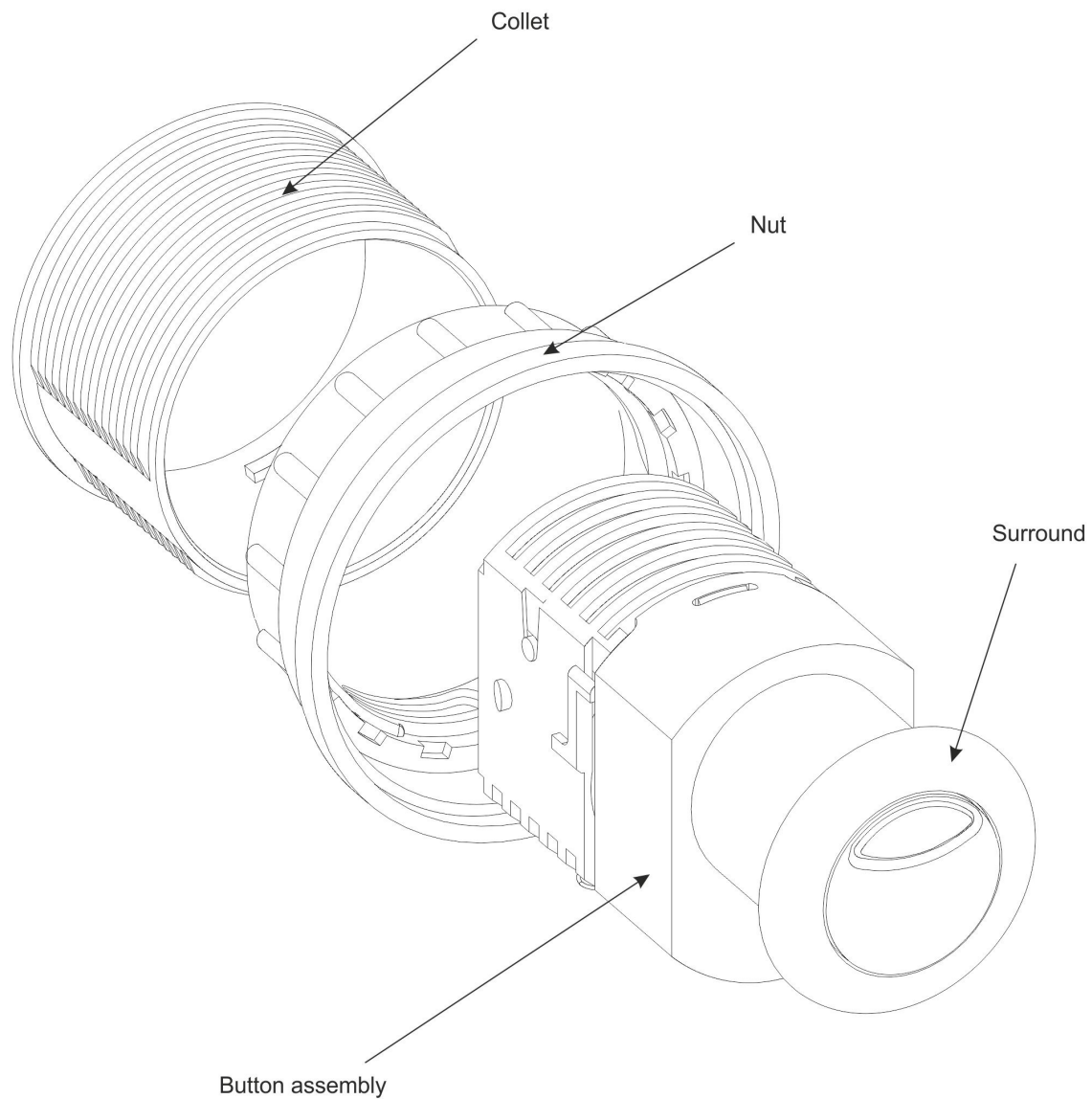



TROUBLE SHOOTING – (See reverse side for flush valve diagrams)

<u>Symptom</u>	<u>Possible Cause</u>	<u>Remedy</u>
(A) No water flow from inlet valve.	(i) Mains supply tap not open. (ii) Isolating valve not open. (iii) Filter blocked. (iv) Float arm not free to move. (v) Float stuck on float chamber.	Open supply tap. Open isolating valve. Remove filter and clean. Mount valve correctly, straighten bent float stem. Adjust float/float chamber height (ensure float remains inside float chamber at all times).
(B) Inlet valve not shutting off.	(i) Seal missing on float lever arm. (ii) Filter and 'O' ring missing. (iii) Float chamber fouling wall of cistern. (iv) Valve has become dislodged from mounting bracket. (v) Float chamber/float set too high. (vi) Float lever arm dislodged from mounting. (vii) Front nut loose. (viii) Blue restrictor not fitted at very high mains pressure. (ix) Monitoring pin seized. (x) Float adjustment stem bent.	Replace seal in arm. Replace filter and 'O' ring. Check mounting of valve. Re-engage valve in bracket. Adjust float chamber/float position. Refit lever arm or replace arm. Tighten nut. Fit blue restrictor. Replace diaphragm assembly. Straighten stem.
(C) Low flow from inlet valve.	(i) Blue restrictor fitted when water supply is tank fed. (ii) Filter blocked.	Remove blue restrictor. Clean filter.
(D) Turbulent and noisy flow from inlet valve.	(i) Blue restrictor not fitted when water supply is mains fed. (ii) Lay flat tube missing. (iii) Lay flat tube not hanging vertically.	Fit blue restrictor. Replace lay flat tube. Reposition tube.
(E) Internally overflowing.	(i) Inlet valve not shutting off. (iii) Water level set too high.	See (B) above. Lower float on inlet valve.
(F) Outlet valve not closing. (If water continually running into pan.)	(i) Bellows not evacuating all air. (ii) Build up of debris on seal face of housing or seal.	Relieve, by removing pipe to valve. Clean surfaces.
(G) Outlet valve closing before full volume delivered.	(i) Seal not clearing window. (ii) Lack of air to inflate bellows. (iii) Push button leaking. (iv) Bellows poorly fitted to lever mount.	Check for leaks on bellows and push button. Check for leaks in push button. Obtain new button Push fit bellows into lever mount.
(H) Outlet valve not operating with push button.	(i) Pneumatic pipes not connected. (ii) Bellows poorly fitted to lever mount. (iii) Bellows leaking. (iv) Push button leaking. (v) Check tubes are not crimped	Re-connect pipes. Trim back pipe to get tight fit. Push fit bellows into lever mount / replace bellows Obtain new button
(I) Leaking from flush pipe connection.	(i) Damaged 'O' rings on cistern outlet. (ii) Flush pipe seam protruding. (iv) Flush pipe cut at angle. (v) Flush pipe cracked	Replace 'O' rings. Trim seam with knife. Replace flush pipe and cut square. Replace flush pipe
(J) Partial flush volume when operating full flush button.	(i) Wrong position of pneumatic pipes.	Substitute pipes.
(K) Full flush volume when operating partial flush button.	(i) Adjustable weight not retained on locating studs. (ii) Wrong position of pneumatic pipes.	Re-connect weight. Substitute pipes.
(L) Button sticking on Vantage with Niagara valve.	(i) Collet not located correctly.	Ensure collet is fully engaged.



Eastbrook Co
Eastbrook Road
Gloucester
GL 3DB

SINGLE FLUSH PNEUMATIC VALVE

DUAL FLUSH PNEUMATIC VALVE

VIEWS SHOWN WITH CAPS
REMOVED

