

INSTALLATION MANUAL

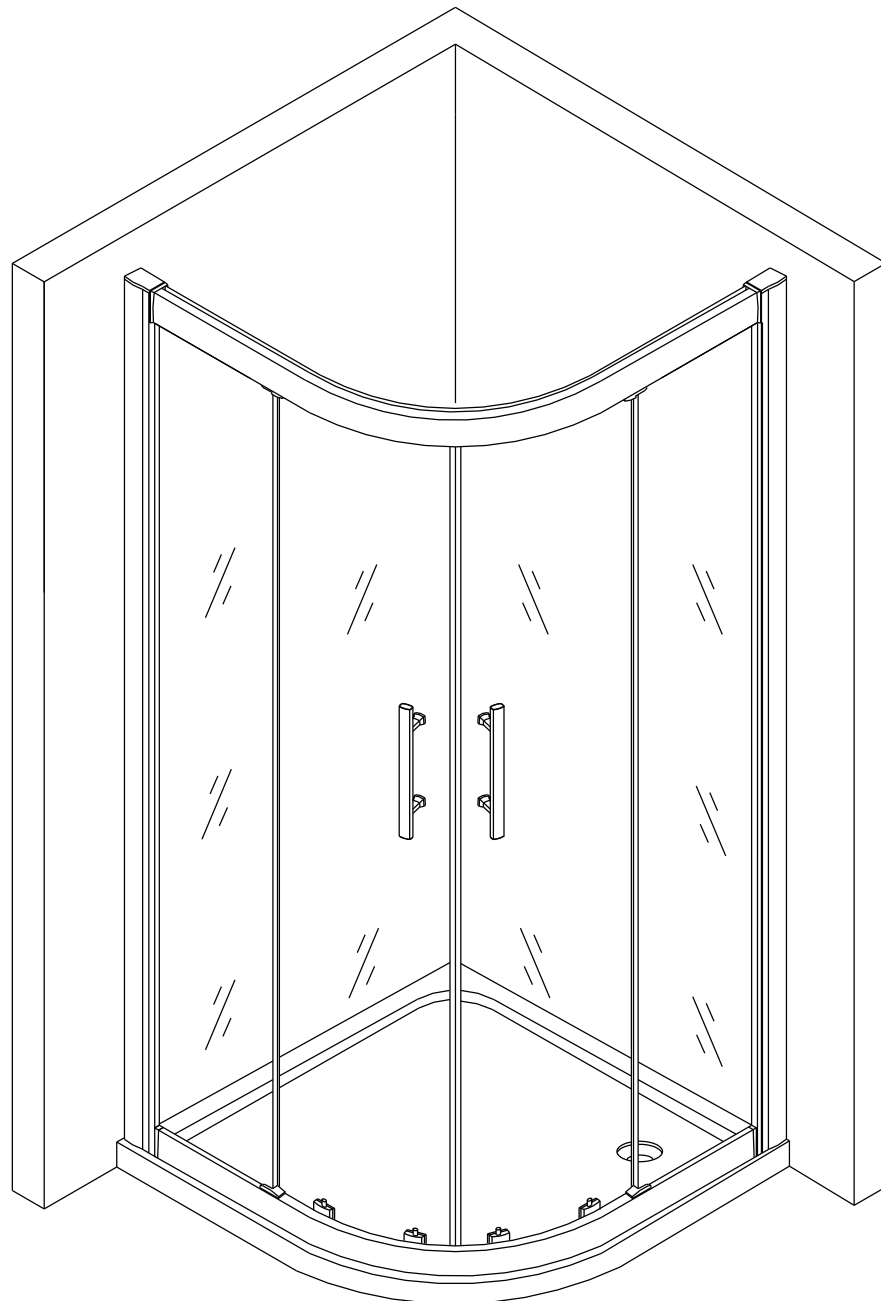

TOOLS REQUIRE

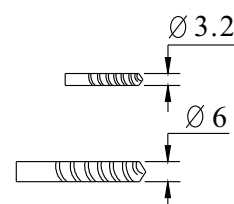
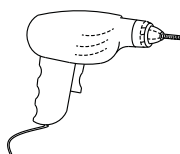
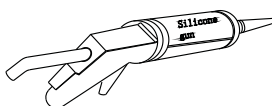
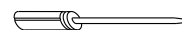
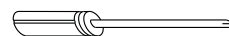
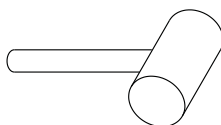
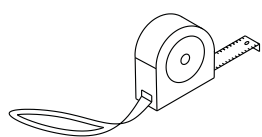

LIST OF SPARE PARTS

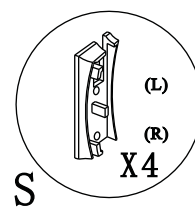
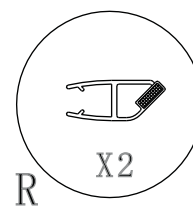
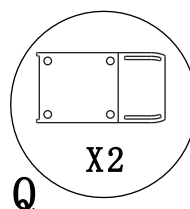
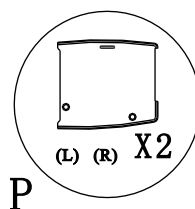
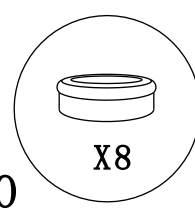
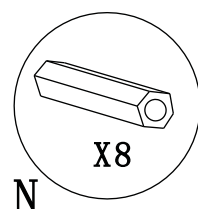
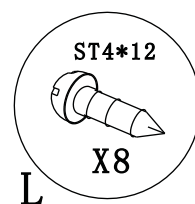
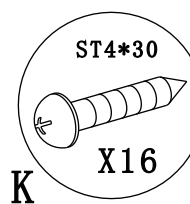
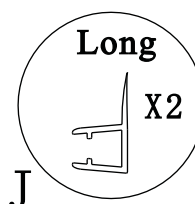
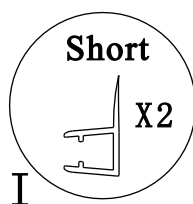
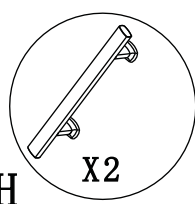
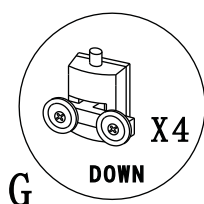
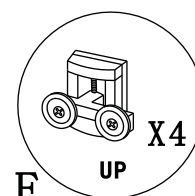
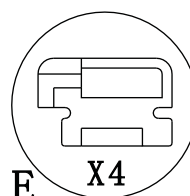
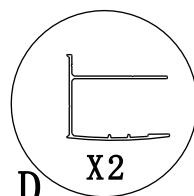
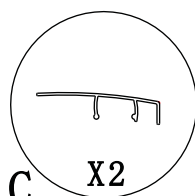
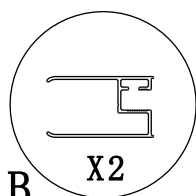
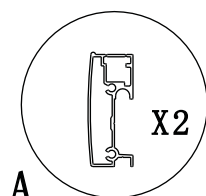

PRODUCT SCHEMATIC DIAGRAM

This exploded view schematic diagram illustrates the assembly of a product, likely a cabinet or shelving unit. The components are labeled with letters and numbers, and their assembly sequence is indicated by arrows and dashed lines. The parts include:

- P**: Top horizontal panel.
- Q**: Top horizontal panel.
- S**: Top horizontal panel.
- J**: Top horizontal panel.
- F**: Top horizontal panel.
- J**: Top horizontal panel.
- L**: Top horizontal panel.
- O**: Top horizontal panel.
- K**: Top horizontal panel.
- D**: Left vertical panel.
- C**: Left vertical panel.
- B**: Left vertical panel.
- I**: Left vertical panel.
- E**: Left vertical panel.
- G**: Left vertical panel.
- R**: Left vertical panel.
- A**: Left vertical panel.
- H**: Left vertical panel.
- I**: Left vertical panel.
- K**: Right vertical panel.
- N**: Right vertical panel.

The diagram shows the assembly of the top and side panels, with various screws and fasteners used to secure the components. The exploded view allows for a clear understanding of the assembly process and the relationship between the different parts.

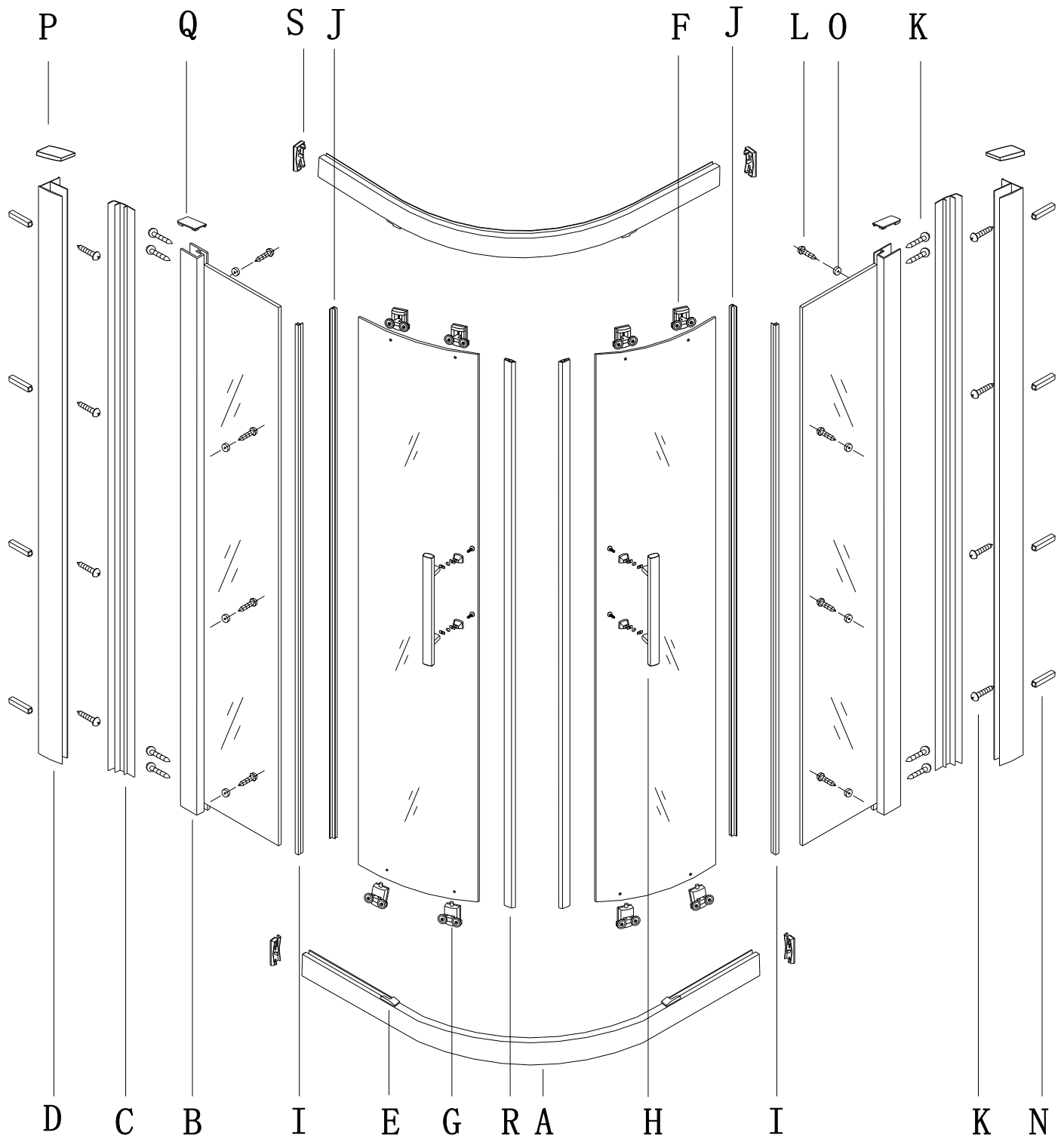

1

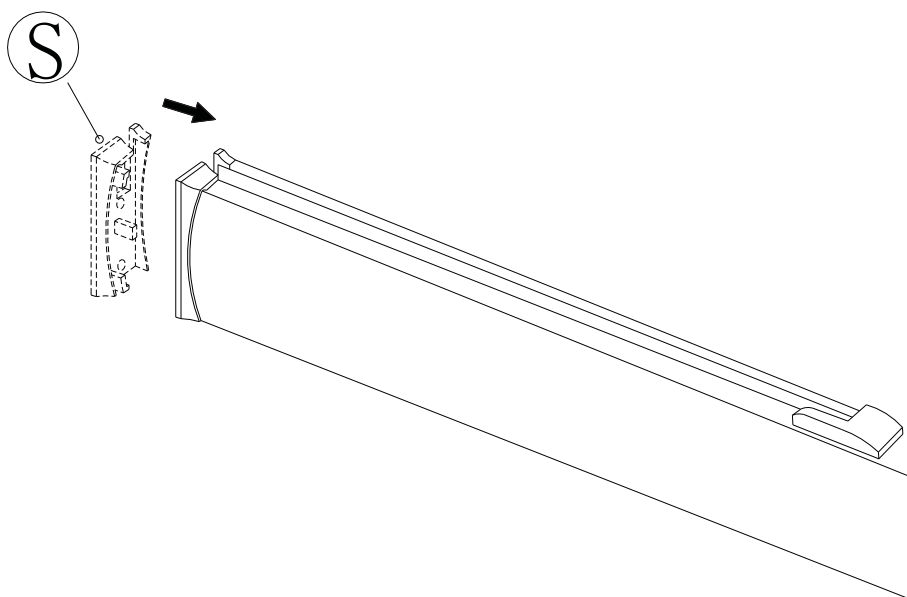

2

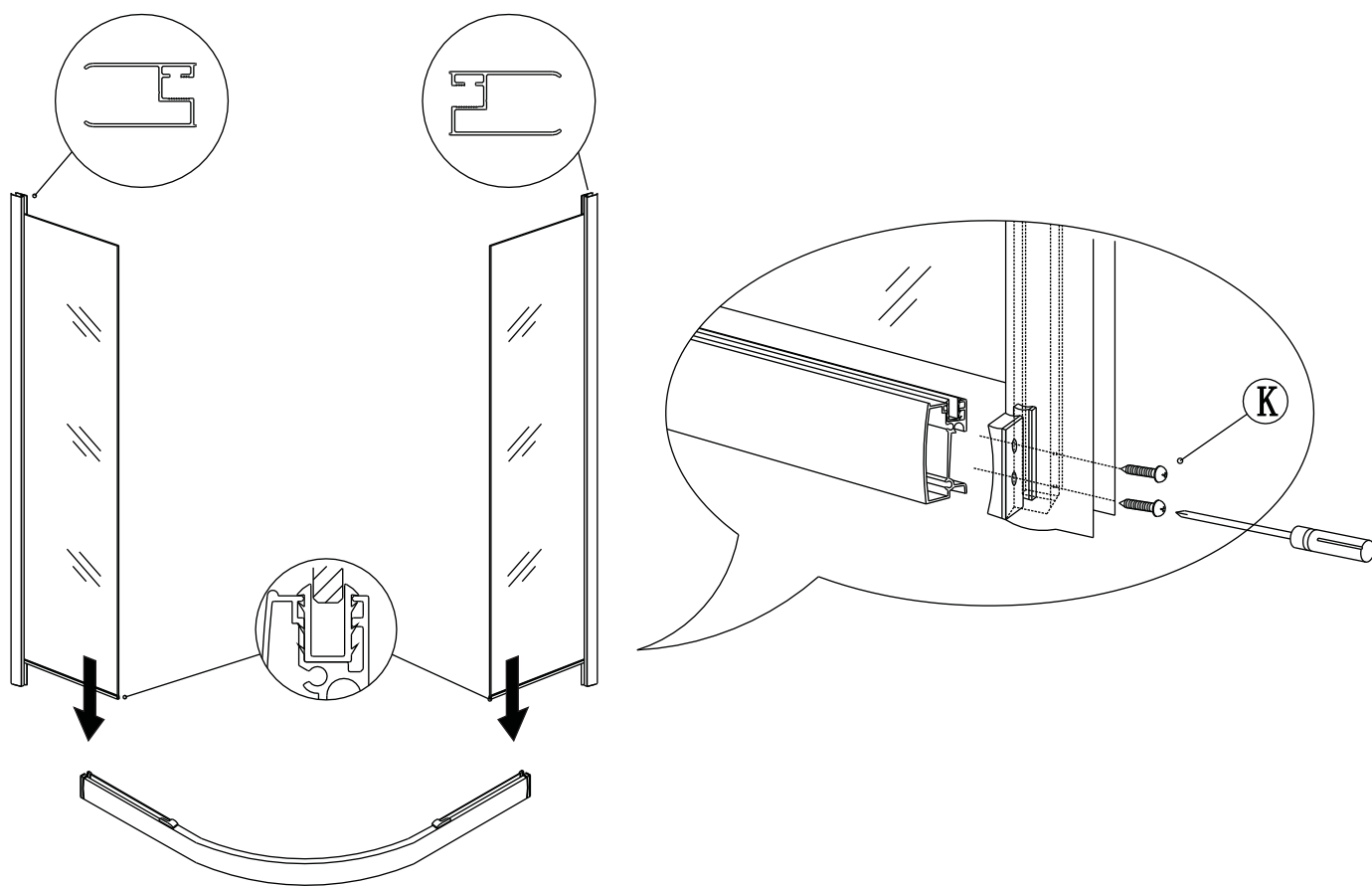

(1)

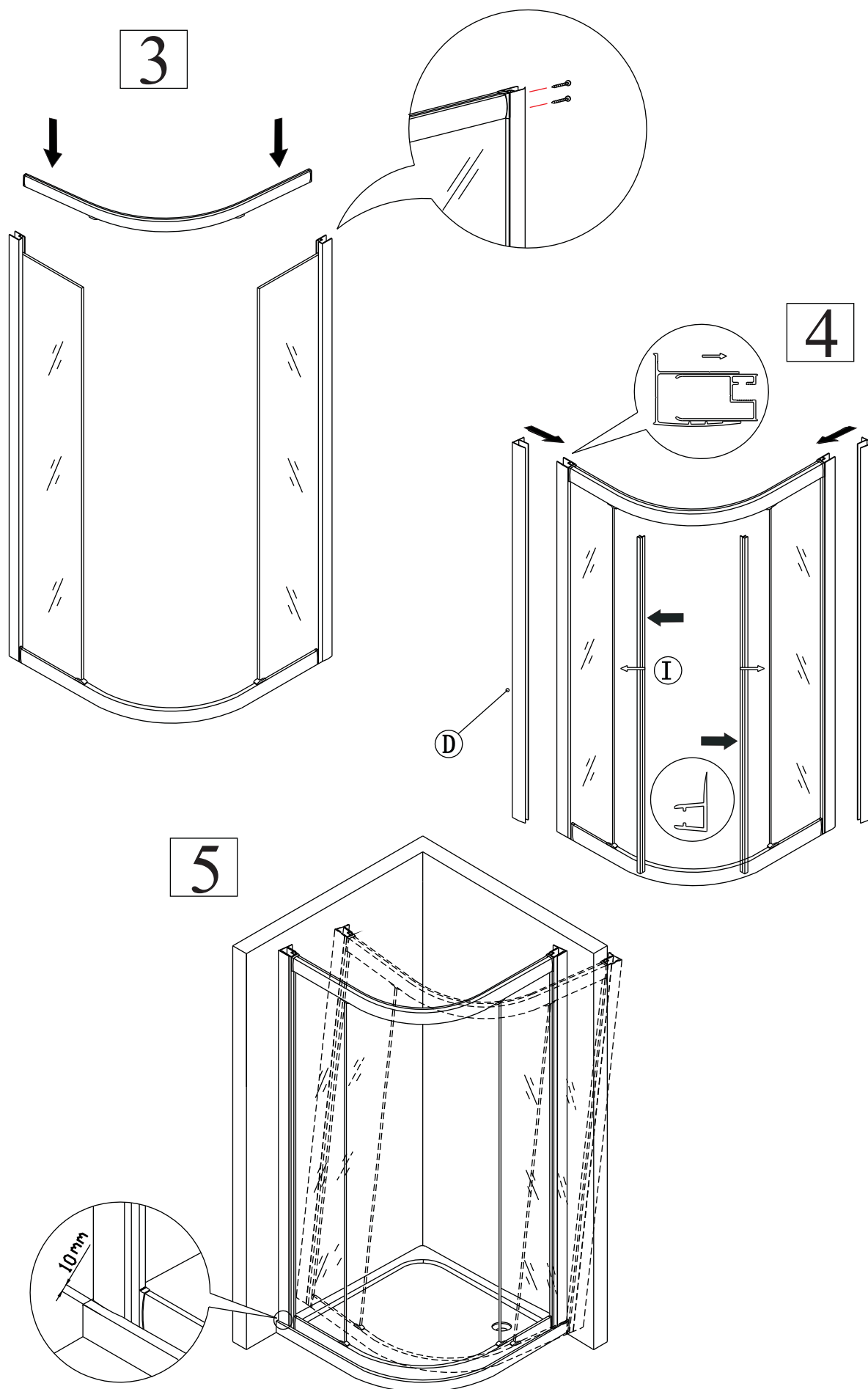

6

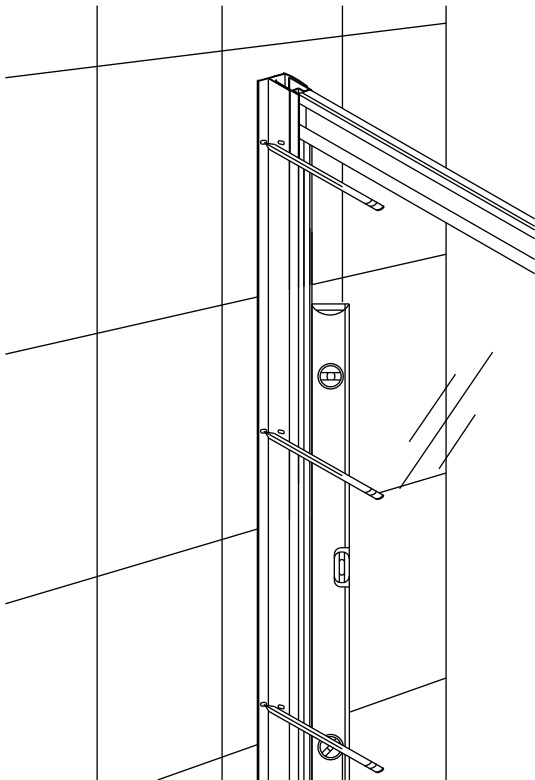

7

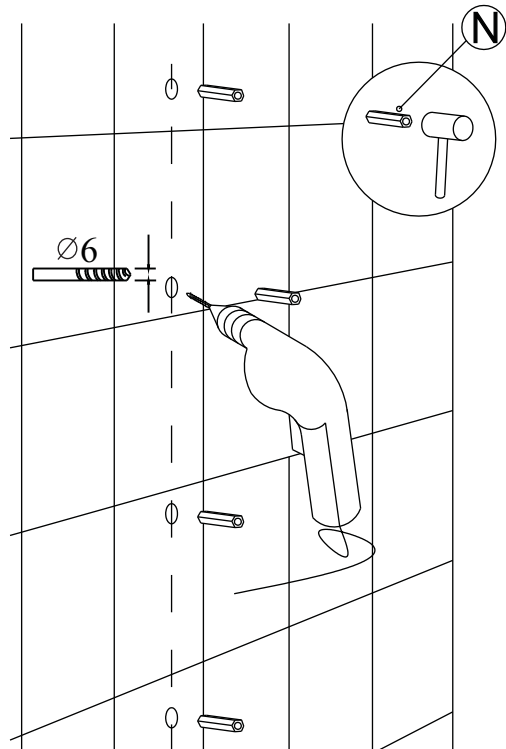

8

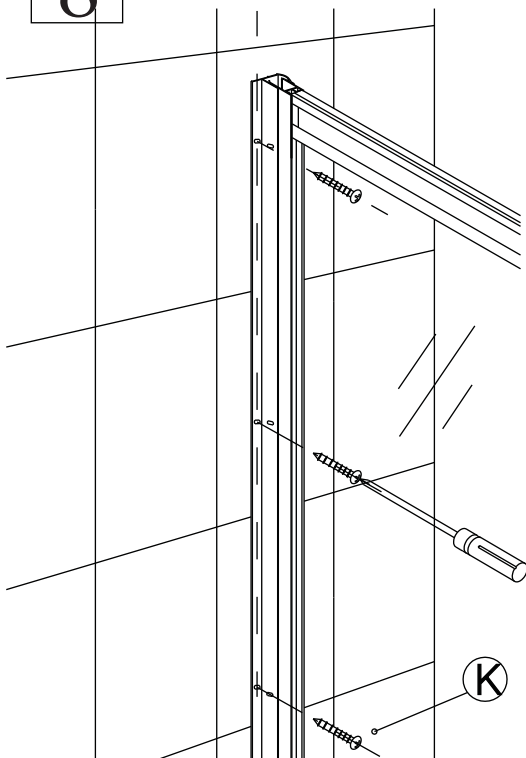

9

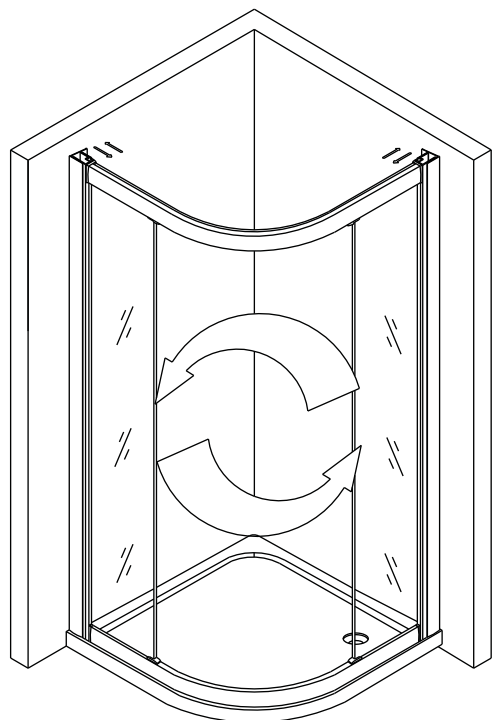

10

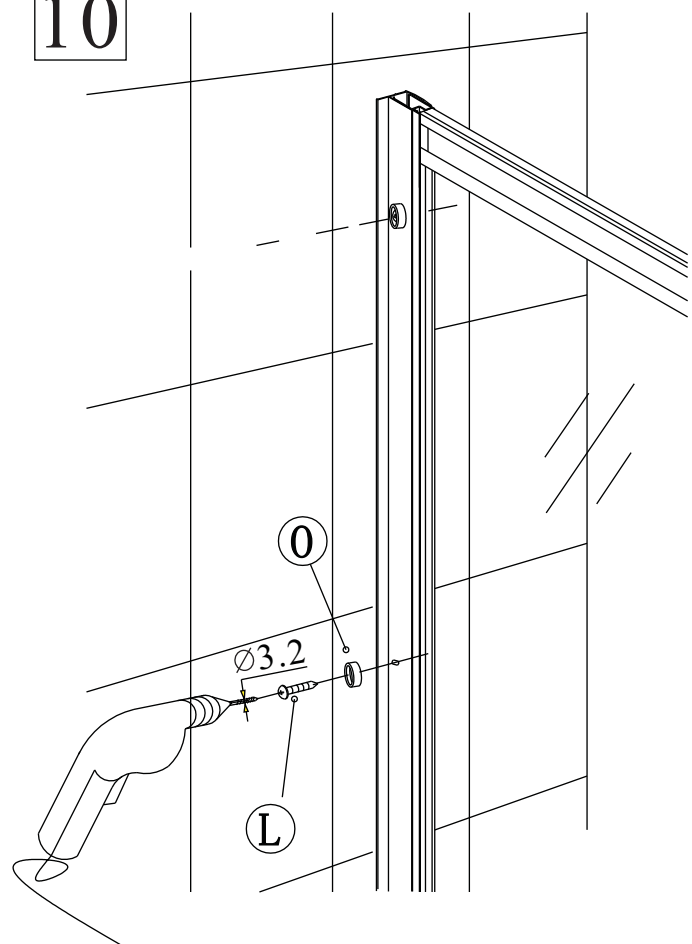

11

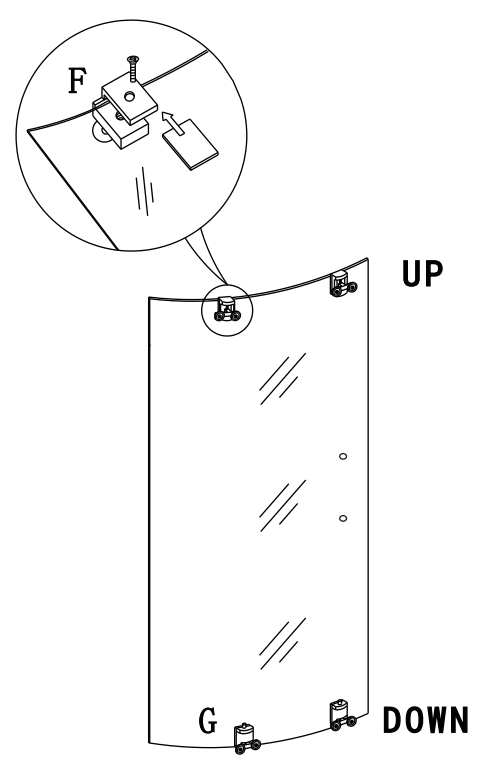

12

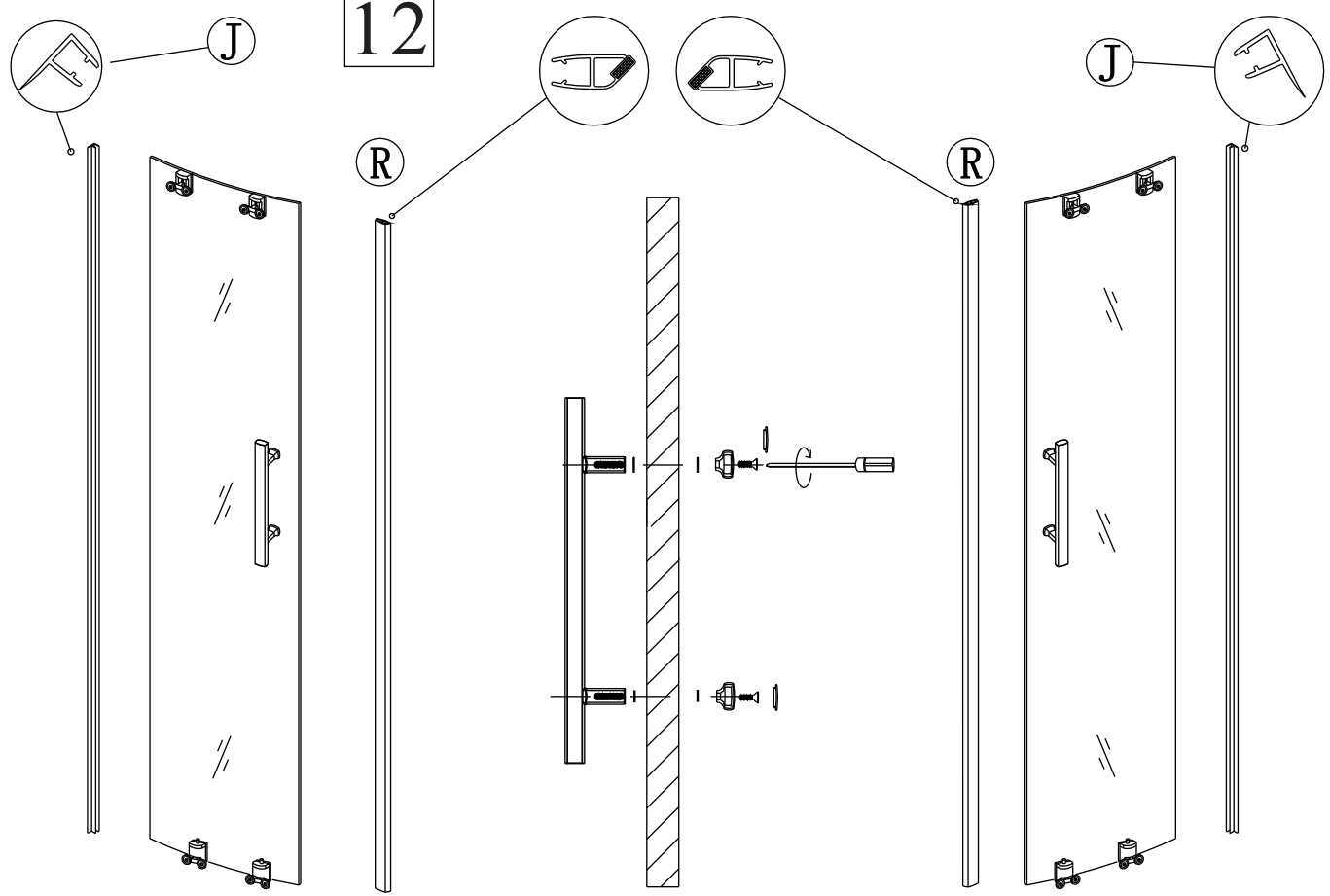

(4)

13

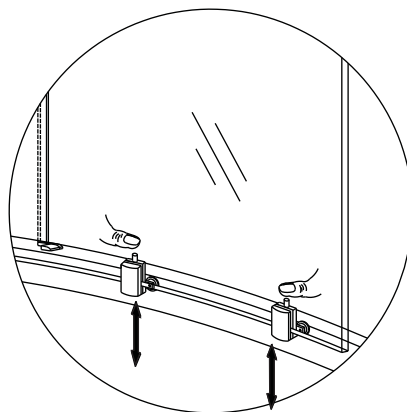
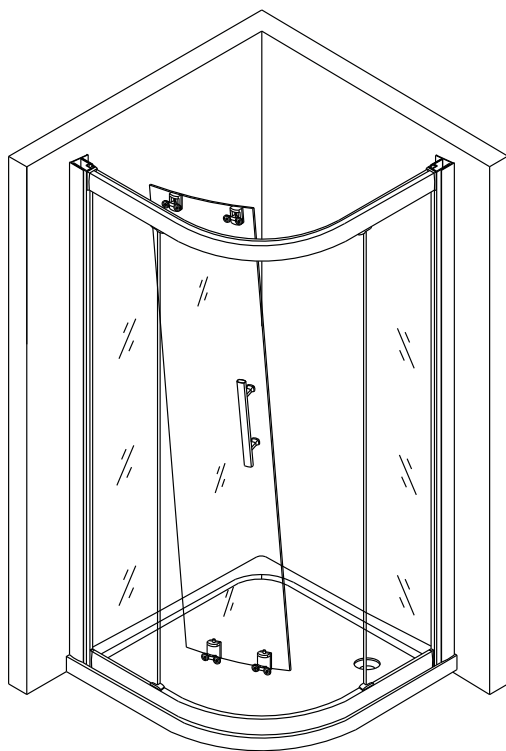

14

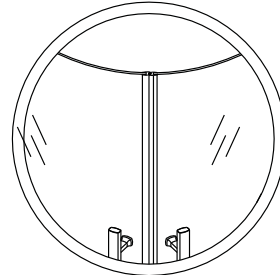
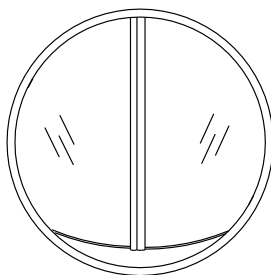
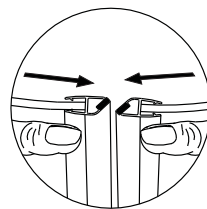
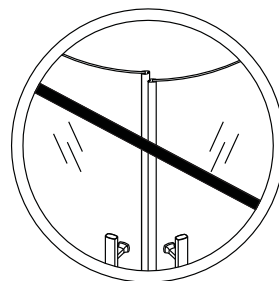
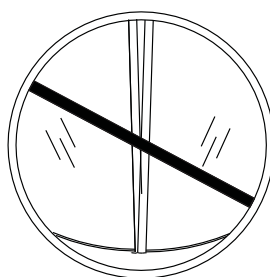
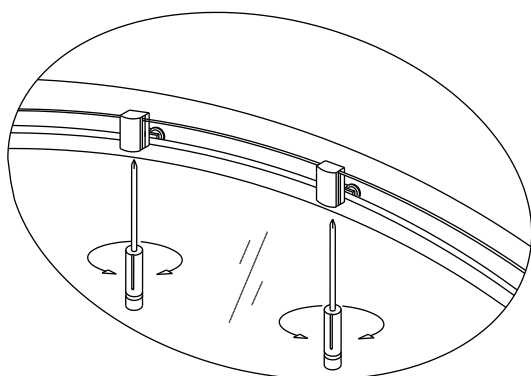

(5)

15

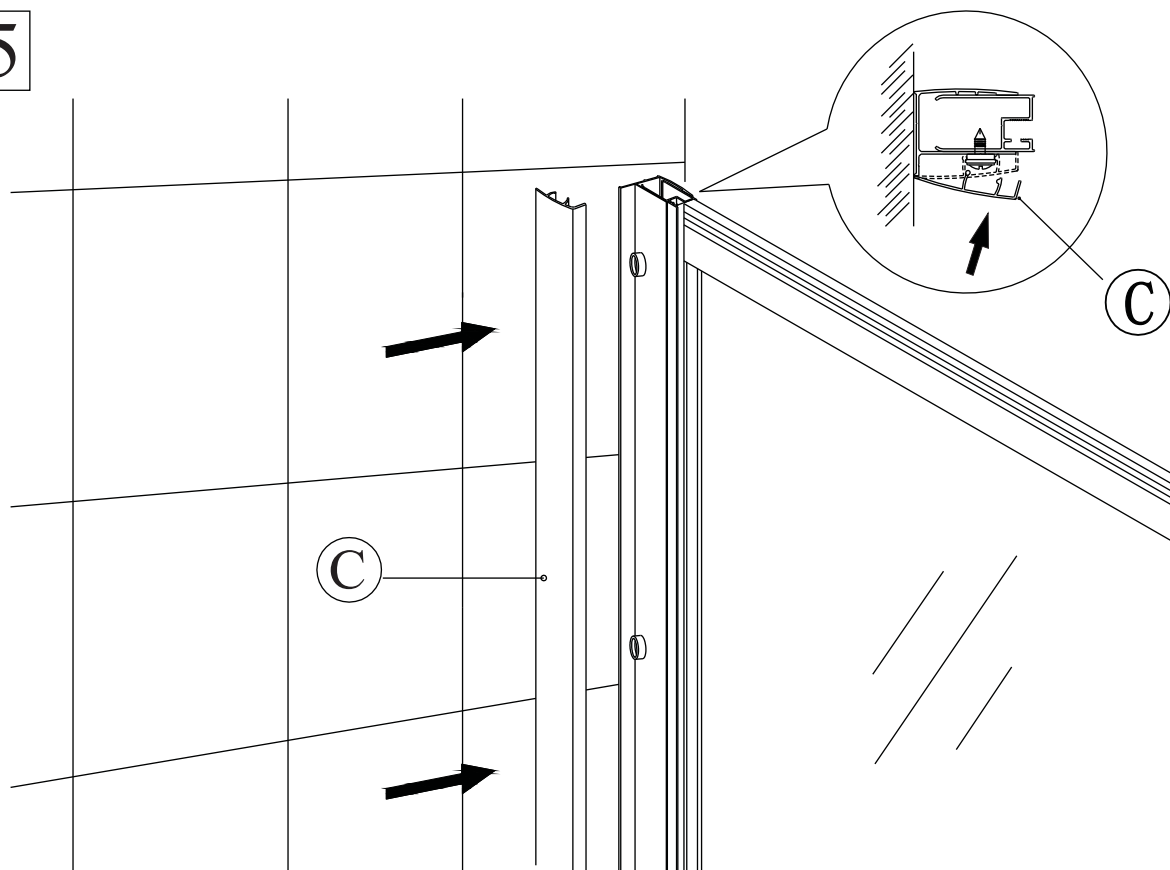

16

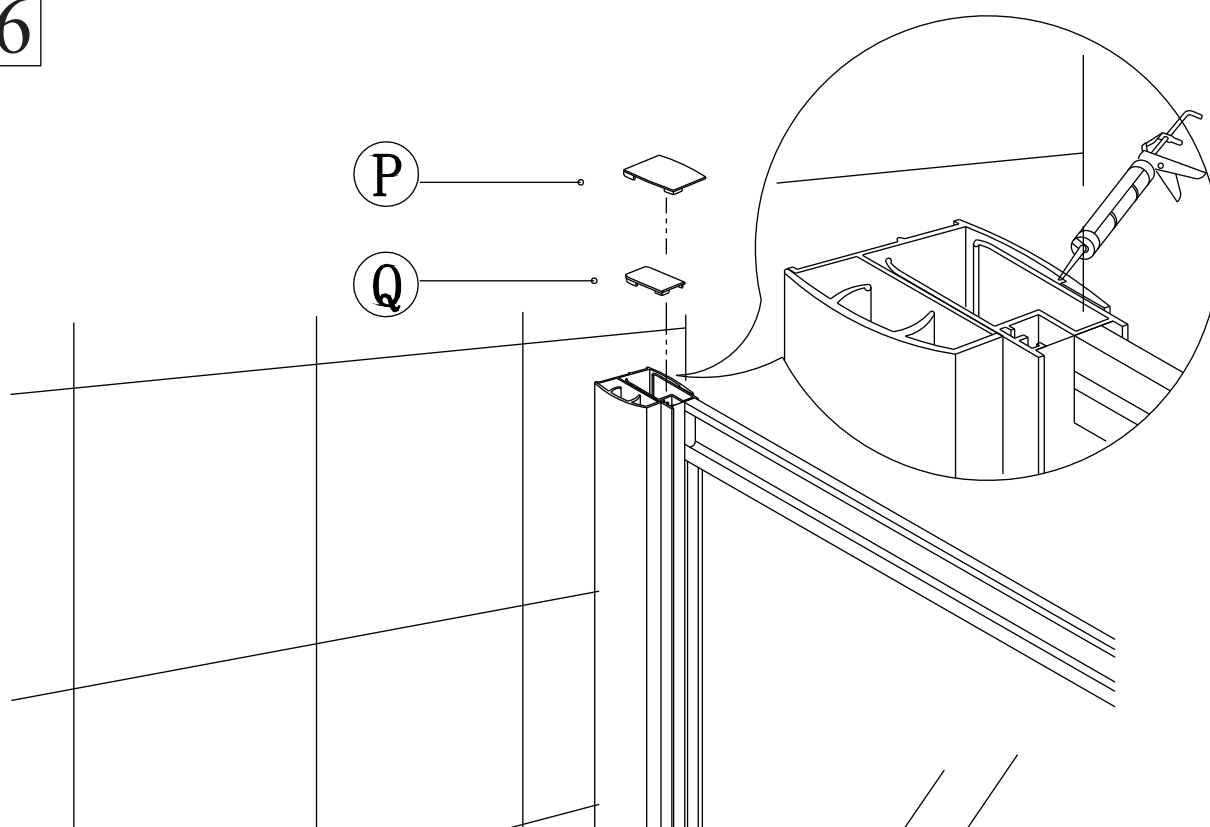

17

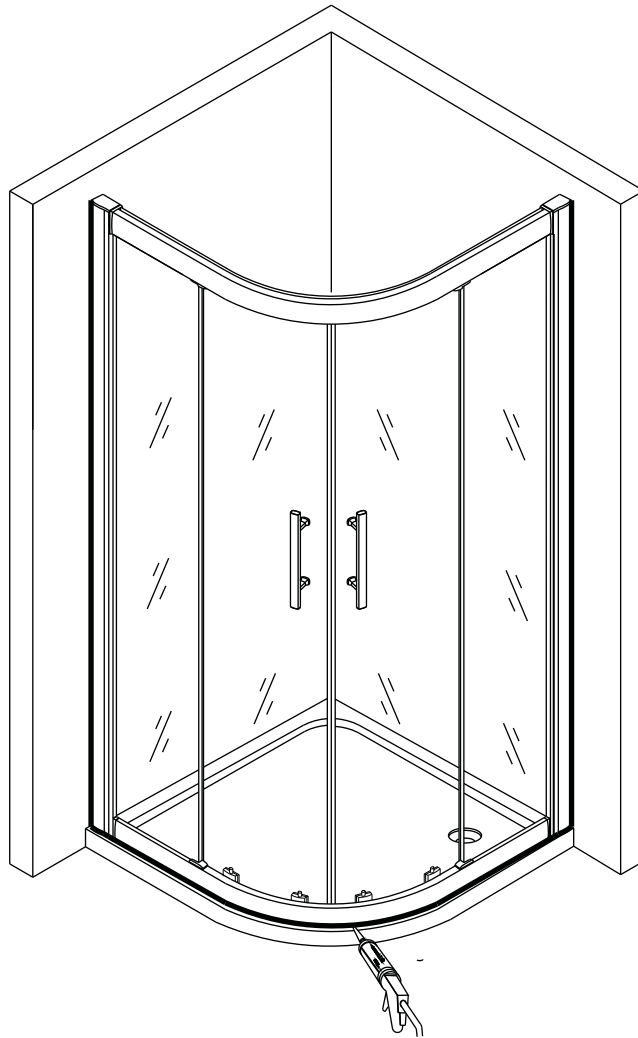

Cleaning & Maintenance

Don't clean the shower enclosure with irritant detergent such as alcohol, bleach or other chemical cleaners.

Only clean with warm soapy water.

After the installation is completed, should you find that there is notable noise when the glass door moves, you may add a small quantity of lubricant onto the roller wheel, slipping hook and the track.

Helpline: 01452 317890

Please ensure silicone sealant is on the outside only.