

Wall fixing set includes;

4	Bracket
4	Bracket Stem
4	Wall Screw
4	Wall Plug

DERWENT DRY ELEMENT ALUMINIUM RADIATOR INSTRUCTION MANUAL

1800mm. Height

Unit: mm

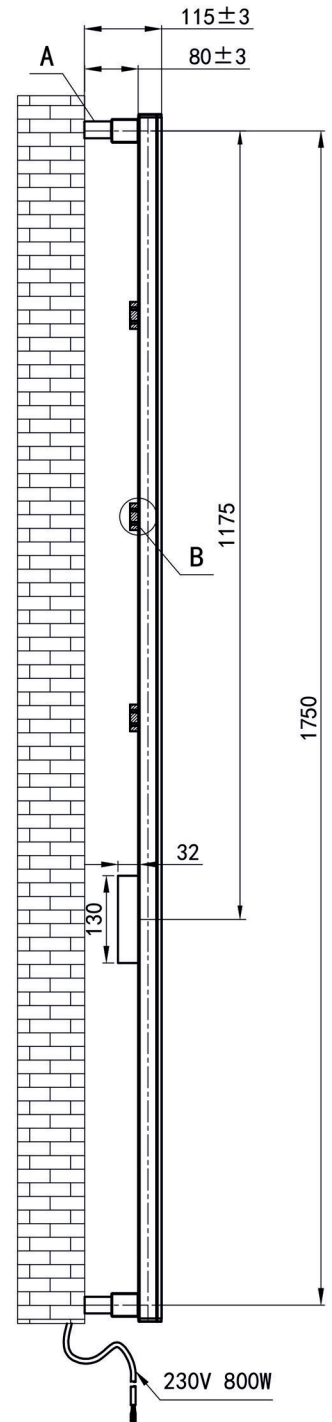
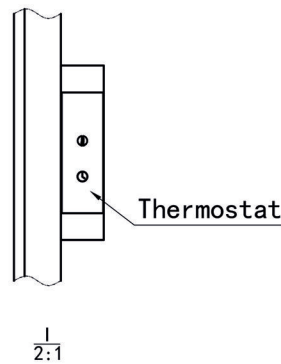
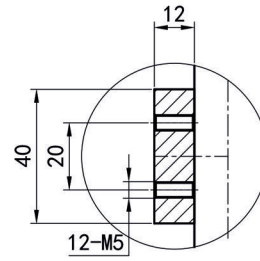
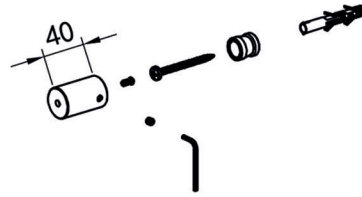
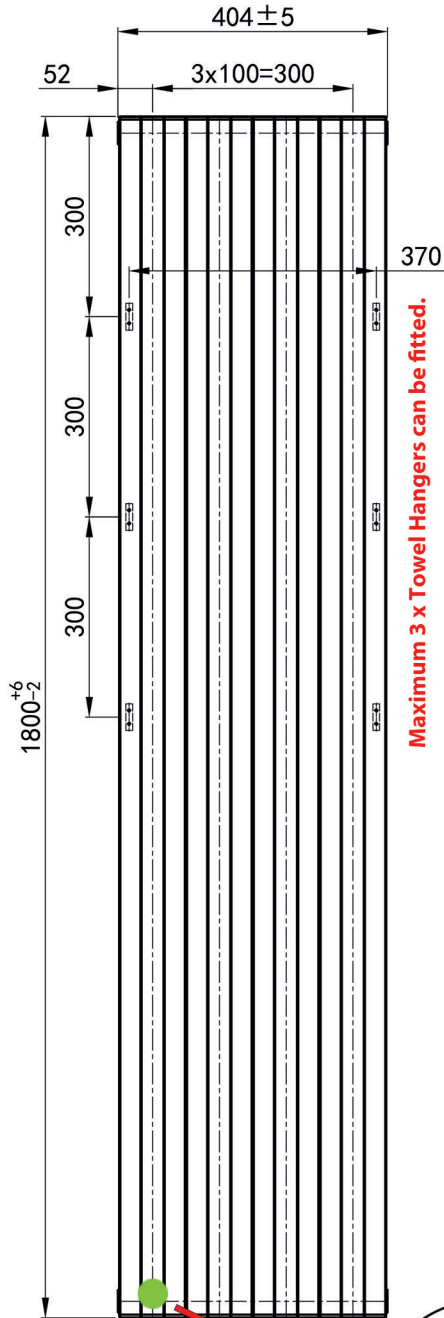

Cable outlet

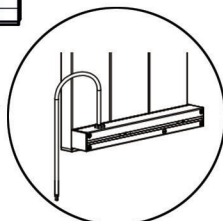

*Towel hangers are sold separately.

IMPORTANT NOTE

This radiator has built-in heating cables inside its body. Not suitable for use on central heating systems.

CONGRATULATIONS

You are the proud owner of an exclusive Derwent Dry Element Aluminium Radiator which has been specially produced by our craftsmen who would wish you to enjoy many years of satisfaction from it.

INSTALLATION

- This product must be installed by a fully qualified engineer / electrician.

MAINTENANCE

- From time to time it is advisable to clean your radiator with a warm damp cloth. Never use any form of abrasive cleaner or chemical.

IMPORTANT

- This radiator has built-in heating cables inside its bod.
- Not suitable for use on central heating systems.

WARRANTY

Your Derwent Dry Element Aluminium Radiator has a manufacturer's warranty for two years in respect of defective materials and workmanship and subject to installation being carried out by a qualified engineer / electrician in accordance with good practice.

REMEMBER... Excellence is worth looking after.

