

Warranty:

All Abode products are made using the highest quality materials and components, to ensure that they meet or exceed all UK or European Standards. All products are thoroughly tested, and quality checked.

All products are backed with a comprehensive warranty, and we are confident that they will give many years of trouble-free service.

The warranty applies to products used for normal domestic purposes and where the installation, care and maintenance instructions have been observed. The warranty extends to the original purchaser only.

Details of Warranty duration and Terms & Conditions for each product type can be found on our website (www.abodedesigns.co.uk).

Safety information

1. The safety of the final installation is the installer's responsibility. Contact an expert if you are in any doubt about the installation.
2. Use only as intended.
3. Disregarding of these assembly instructions voids the manufacturer's warranty.
4. Reservations are taken for technical changes.

Please leave these instructions for your customer.

Parts and Contents

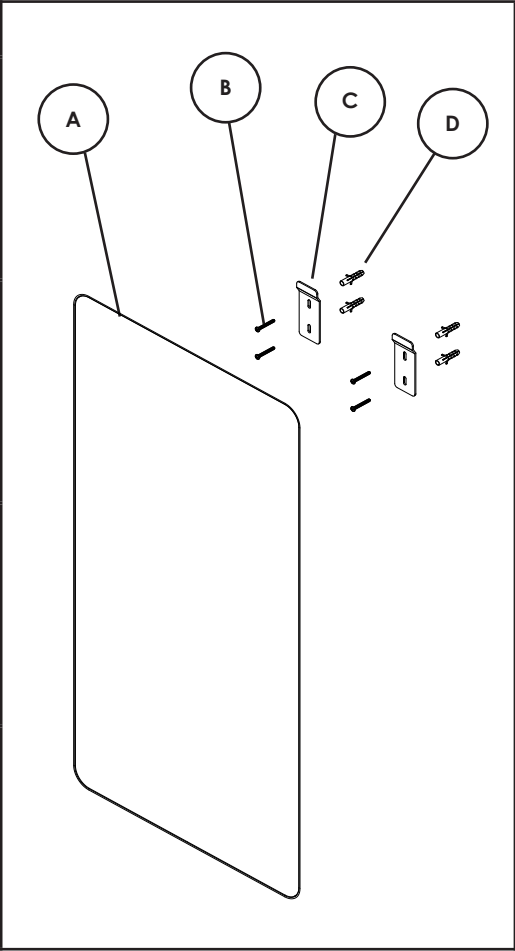
Key	Description	Qty	
A	Mirror	1	
B	50mm Dome head screw	4	
C	Fixing plate	2	
D	Raw plug	4	

Installation

- 1. Unpack inspect the product for any visible damage, especially on the mirror surface.
- 2. The enclosed raw plugs and screws are only suitable for fixing concrete or brick walls installations, for other types of wall constructions, please use your own suitable fixing.
- 3. Consider placement of the mirror. If necessary, please consult a qualified professional.
- 4. Make measurements for mounting brackets as illustrated below.

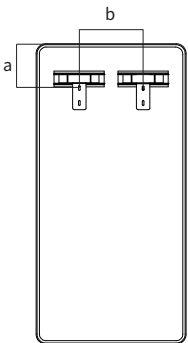
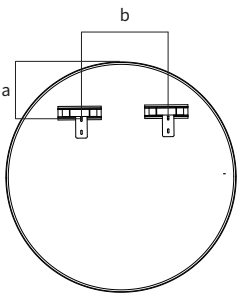
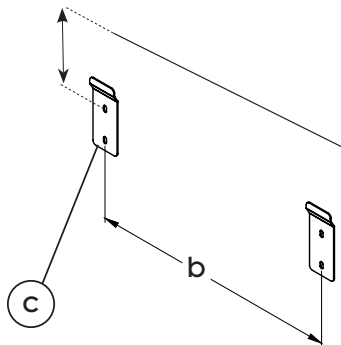

Dimensions (mm)		
Mirror	a	b
450x900	130	190
ø600	240	300

- 5. Mount brackets

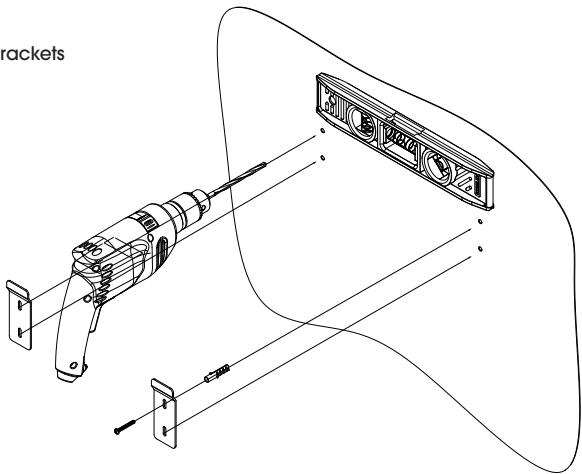

6. Place mirror on brackets. Make sure the mirror is secure.

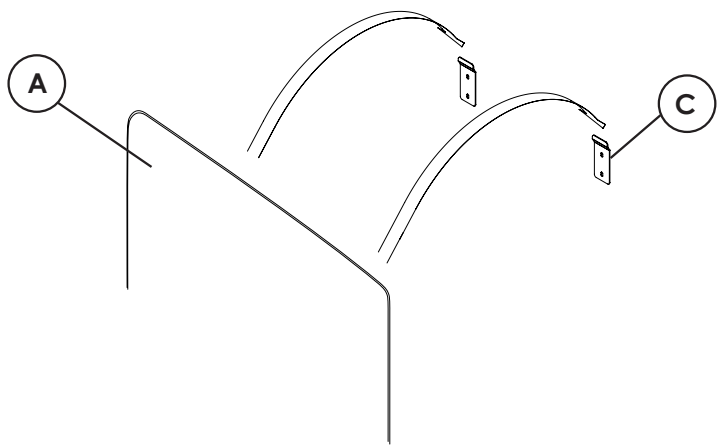

7. If required adjust the brackets to make sure the mirror is level.

User Instruction

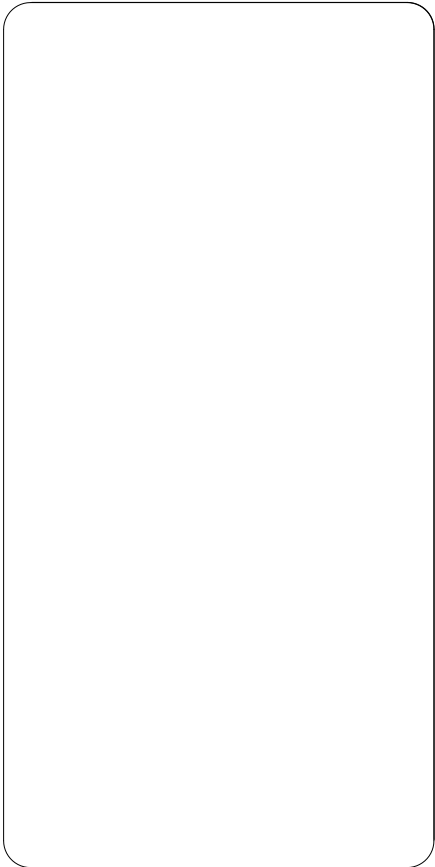

Important Care Instructions for your Product

To maintain the appearance of this product, ensure that it is regularly cleaned only using a clean, soft damp cloth. A solution of warm water and a mild liquid detergent may be used where necessary, and then the product must be wiped dry. Any other cleaning action or use of common domestic cleaning products will invalidate your warranty.

Abrasive cleaners, scouring cleaners and acidic cleaners must not be used on this product under any circumstances. Avoid contact with all solvents (including chlorinated solvents, ketones or acetones as these may result in surface deterioration or etching). Also avoid contact with any harsh household chemicals.

