

# Uno Universal Basin Waste



## Warranty:

All Abode products are made using the highest quality materials and components, to ensure that they meet or exceed all UK or European Standards. All products are thoroughly tested, and quality checked.

All products are backed with a comprehensive warranty and we are confident that they will give many years of trouble-free service.

The warranty applies to products used for normal domestic purposes and where the installation, care and maintenance instructions have been observed. The warranty extends to the original purchaser only.

Details of Warranty duration and Terms & Conditions for each product type can be found on our website ([www.abodedesigns.co.uk](http://www.abodedesigns.co.uk))

## Important Care Instructions for your Product:

To maintain the appearance of this product, ensure that it is regularly cleaned only using a clean, soft damp cloth. A solution of warm water and a mild liquid detergent may be used where necessary, and then the fitting rinsed thoroughly and wiped dry. Any other cleaning action or use of common domestic cleaning products will invalidate your warranty.

If the product has a plastic aerator insert at the end of the spout it should be unscrewed and the plastic internal insert only removed and cleaned or descaled to maintain flow performance. Do not use descaling solution on any decorative metal housing, rinse the insert thoroughly before reattaching in the reverse order.

Abrasive cleaners, scouring cleaners and acidic cleaners **must not be used on this product** under any circumstances. Avoid contact with all solvents (including chlorinated solvents, ketones or acetones as these may result in surface deterioration or etching). Also avoid contact with any harsh household chemicals such as oven cleaners, drain cleaners, rust removers, paint strippers and toilet bowl cleaners, bar keepers friend or Brasso.

**Please leave these instructions for your customer.**

## Important Technical Data:

**Basins without integral overflow must have the freeflow waste setup as described. This waste is suitable for both slotted and unslotted installation types.**

These installation guidelines have been prepared for your direction and you must exercise due care at all times. We do not accept responsibility for problems that may occur through improper installation. Whilst installing the product take care not to accidentally loosen any premade assembled assemblies or mark any decorative finishes.

**Manufacturers Product Reference:** ABX1010

©Abode - 12/2023

## Installation Preparation:

**Before installing the new product please remove all packaging and inspect all parts are undamaged and present.**

## Parts and Contents:

Key	Description	Qty
A	Waste underbody	1
B	Plastic washer	1
C	Underside seal (thick)	1
D	Basin waste hole	n/a
E	Upper foam seal (thin)	1
F	Waste flange	1
G	Freeflow adaptor (open position only)	1
H	Clicker adaptor (closable)	1
I	Waste cap	1
J	Fixing bolt	1

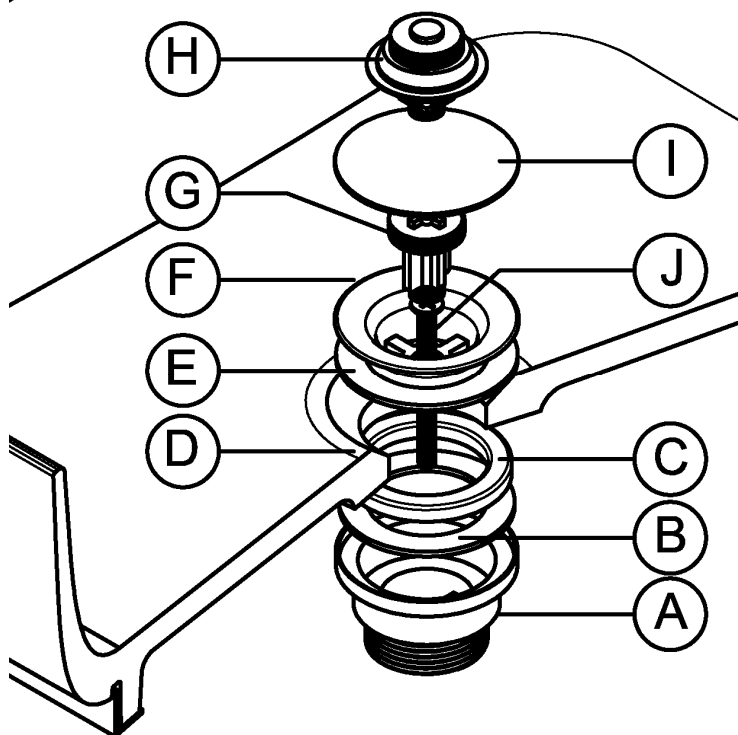

## Installation:

- Screw either the Freeflow adaptor (G) or clicker adaptor (H) into the waste cap (I).
  - If the basin has no overflow you must use the Freeflow adaptor (G).
  - If the basin has an overflow you can use either the Freeflow adaptor (G) or clicker adaptor (H).
  - If basin is supplied with a colour matched cap this can be used in place of part (I)
- Place the upper foam seal (E) centrally over the rear of waste flange (F).
- Place the plastic washer (B) in the waste underbody (A).
- Pass the fixing bolt (J) through the centre of the waste flange (F), now place the waste flange (F) and upper seal (E) centrally to the top of the waste hole (D).
- Place the underside seal (B) in the waste underbody (A), the curved face of the seal should face towards the basin, if the rear face of the basin (D) is uneven then silicone sealant should also be used on the rear of the basin.
- Screw the fixing bolt (J) into the waste underbody (A) and tighten fully using a screwdriver.
- Screw the plug assembly (G/H & I) into the waste flange (F) by hand.

## After Installation:

Test the waste upper and lower seals for any leaks.

Clean and dry the product of any marks from installation then cover the product to protect it until it is ready to use.