

John Guest MDPE Compression Reducing Coupling

Securely and quickly connects two MDPE pipes of differing diameters

Overview

John Guest MDPE Compression Reducing Coupling is designed to provide a secure and reliable connection between two lengths of MDPE pipe of differing diameters, enabling a size transition within a pipeline.

Manufactured with a compact and durable design, this fitting is suited for cold water service installations where system modification or lengthening of a system is required, including in-ground applications and confined spaces.

Supplied pre-assembled and installation-ready, it offers a quick and efficient solution without the need for specialist tools or heat-based joining methods. The demountable connection makes it easy to work with in the ground during maintenance or alteration of an existing setup.



Features & Benefits

- Durable MDPE Compression Reducing Coupling
- Reduces between two pipe sizes, allowing seamless and secure transition between MDPE pipes of different diameters.
- Strong compression connection for a leak-free joint without the need for heat or chemicals
- Quick and easy to install and demount without the need for specialist tools
- High-grade polypropylene body for durability and high impact resistance
- Corrosion-resistant and inhibits biological growth, making it suitable for outdoor and underground use
- Compatible with MDPE pipes only
- Suitable for cold water use only

Product code	Description	Bag QTY
UGCF202520	John Guest MDPE Compression Reducing Coupling - 25mm x 20mm	15
UGCF203220	John Guest MDPE Compression Reducing Coupling - 32mm x 20mm	10
UGCF203225	John Guest MDPE Compression Reducing Coupling - 32mm x 25mm	10



John Guest MDPE Compression Reducing Coupling

Operating Pressure & Temperature

Fittings are suitable for working pressures up to 16 bar at 20°C

Materials

Body	Polypropylene Copolymer (PP-B)
O-Ring	Nitrile rubber (NBR 70)
Insert Sleeve	Polypropylene Copolymer (PP-B)
Split Ring	Polyacetal (POM)
Compression Nut	Polypropylene Copolymer (PP-B)

Dimensions – All measurements in mm unless otherwise stated

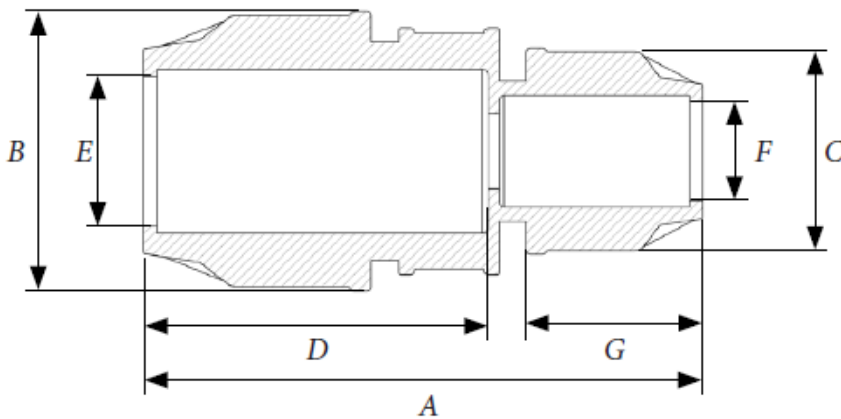

Product Code	Size	A	B	C	D	E	F	G
UGCF202520	25mm x 20mm	105.0	52.0	46.0	55.5	27.0	22.0	47.5
UGCF203220	32mm x 20mm	115.5	62.5	46.0	71.0	33.5	22.0	41.5
UGCF203225	32mm x 25mm	117.5	62.5	52.0	71.0	33.5	27.0	43.0