

John Guest MDPE Compression Female Threaded Branch Tee

Securely and quickly connects two equally sized MDPE pipes and a Female BSP threaded connection at a 90° angle

Overview

John Guest MDPE Compression Female Threaded Branch Tee is designed to provide a secure and reliable connection between two lengths of MDPE pipe, while incorporating a Female BSP threaded branch for integration with compatible components. This configuration supports the connection of threaded elements such as valves, pressure gauges, or adaptors for interfacing with other piping systems.

Manufactured with a compact and durable design, the fitting is suited for cold water service installations where directional changes are required within restricted spaces or structured layouts.

Supplied pre-assembled and installation-ready, it offers a quick and efficient solution without the need for specialist tools or heat-based joining methods. The demountable connection makes it easy to work with in the ground during maintenance or alteration of an existing setup.



Features & Benefits

- Durable MDPE Compression Female Threaded Branch Tee
- 3 way connection enables two MDPE pipes of the same diameter to join whilst offering added system versatility via the threaded branch connection
- Strong compression connection for a leak-free joint without the need for heat or chemicals
- Quick and easy to install and demount without the need for specialist tools
- High-grade polypropylene body for durability and high impact resistance
- Corrosion-resistant and inhibits biological growth, making it suitable for outdoor and underground use
- Compatible with MDPE pipes only
- Suitable for cold water use only

Product code	Description	Bag QTY
UGCF58F202012BSP	John Guest MDPE Compression Female Threaded Branch Tee - 20mm x 20mm x 1/2"	15
UGCF58F202034BSP	John Guest MDPE Compression Female Threaded Branch Tee - 20mm x 20mm x 3/4"	15
UGCF58F252512BSP	John Guest MDPE Compression Female Threaded Branch Tee - 25mm x 25mm x 1/2"	10
UGCF58F252534BSP	John Guest MDPE Compression Female Threaded Branch Tee - 25mm x 25mm x 3/4"	10
UGCF58F323234BSP	John Guest MDPE Compression Female Threaded Branch Tee - 32mm x 32mm x 3/4"	N/A
UGCF58F32321BSP	John Guest MDPE Compression Female Threaded Branch Tee - 32mm x 32mm x 1"	N/A



John Guest MDPE Compression Female Threaded Branch Tee

Operating Pressure & Temperature

Fittings are suitable for working pressures up to 16 bar at 20°C

Materials

Body	Polypropylene Copolymer (PP-B)
O-Ring	Nitrile rubber (NBR 70)
Insert Sleeve	Polypropylene Copolymer (PP-B)
Split Ring	Polyacetal (POM)
Compression Nut	Polypropylene Copolymer (PP-B)

Dimensions – All measurements in mm unless otherwise stated

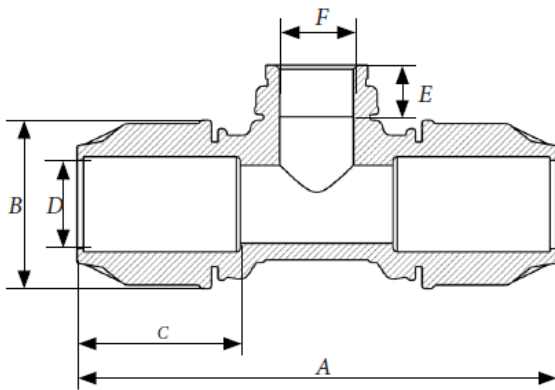

Product Code	Size	A	B	C	D	E	F
UGCF58F202012BSP	20mm x 20mm x 1/2"	124.5	46.0	48.5	22.0	20.5	1/2"
UGCF58F202034BSP	20mm x 20mm x 3/4"	125.0	46.0	48.5	22.0	22.5	3/4"
UGCF58F252512BSP	25mm x 25mm x 1/2"	138.0	52.0	52.0	27.0	16.0	1/2"
UGCF58F252534BSP	25mm x 25mm x 3/4"	137.5	52.0	51.5	27.0	18.5	3/4"
UGCF58F323234BSP	32mm x 32mm x 3/4"	158.5	62.5	62.0	33.5	18.0	3/4"
UGCF58F32321BSP	32mm x 32mm x 1"	159.0	62.5	62.5	33.5	21.5	1"