

John Guest MDPE Compression Equal Tee

Securely and quickly connects three equally sized MDPE pipes

Overview

John Guest MDPE Compression Equal Tee is designed to provide a secure and reliable connection between three lengths of MDPE pipe, enabling the formation of a 90° branch for flow division or combination.

Manufactured with a compact and durable design, the fitting is suited for cold water service installations where directional changes are required within restricted spaces or structured layouts.

Supplied pre-assembled and installation-ready, it offers a quick and efficient solution without the need for specialist tools or heat-based joining methods. The demountable connection makes it easy to work with in the ground during maintenance or alteration of an existing setup.



Features & Benefits

- Durable MDPE Compression Equal Tee
- 3-way connection enables three MDPE pipes of the same diameter to join together, combining or splitting flow
- Strong compression connection for a leak-free joint without the need for heat or chemicals
- Quick and easy to install and demount without the need for specialist tools
- High-grade polypropylene body for durability and high impact resistance
- Corrosion-resistant and inhibits biological growth, making it suitable for outdoor and underground use
- Compatible with MDPE pipes only
- Suitable for cold water use only

| Product code | Description | Bag QTY |
|--------------|--|---------|
| UGCF0220 | John Guest MDPE Compression Equal Tee - 20mm | 15 |
| UGCF0225 | John Guest MDPE Compression Equal Tee - 25mm | 10 |
| UGCF0232 | John Guest MDPE Compression Equal Tee - 32mm | N/A |



John Guest MDPE Compression Equal Tee

Operating Pressure & Temperature

Fittings are suitable for working pressures up to 16 bar at 20°C

Materials

| | |
|-----------------|--------------------------------|
| Body | Polypropylene Copolymer (PP-B) |
| O-Ring | Nitrile rubber (NBR 70) |
| Insert Sleeve | Polypropylene Copolymer (PP-B) |
| Split Ring | Polyacetal (POM) |
| Compression Nut | Polypropylene Copolymer (PP-B) |

Dimensions – All measurements in mm unless otherwise stated

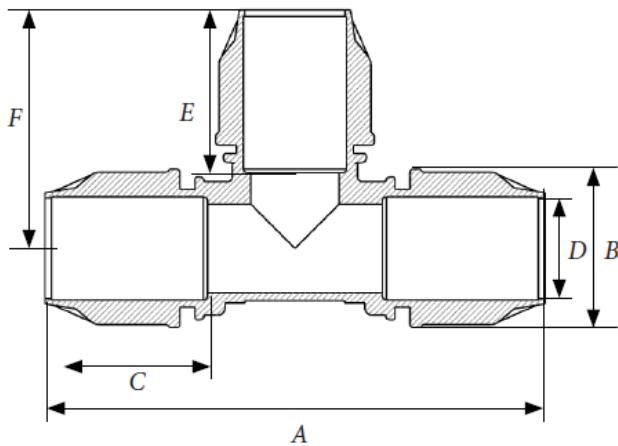

| Product Code | Size | A | B | C | D | E | F |
|--------------|--------------------|-------|------|------|------|------|------|
| UGCF0220 | 20mm x 20mm x 20mm | 131.0 | 46.0 | 49.5 | 22.0 | 49.5 | 64.5 |
| UGCF0225 | 25mm x 25mm x 25mm | 145.5 | 52.0 | 51.0 | 27.0 | 51.0 | 71.0 |
| UGCF0232 | 32mm x 32mm x 32mm | 174.0 | 62.5 | 62.0 | 33.5 | 61.5 | 58.5 |